

9. EXPLODED VIEWS AND PARTS LIST

- NOTES :**
- Parts marked by "*" are generally unavailable because they are not in our Master Spare Parts List.
 - The \triangle mark found on some component parts indicates the importance of the safety factor of the part. Therefore, when replacing, be sure to use parts of identical designation.
 - Screw adjacent to ∇ mark on the product are used for disassembly.
 - For the applying amount of lubricants or glue, follow the instructions in this manual.
(In the case of no amount instructions, apply as you think it appropriate.)

9.1 PACKING

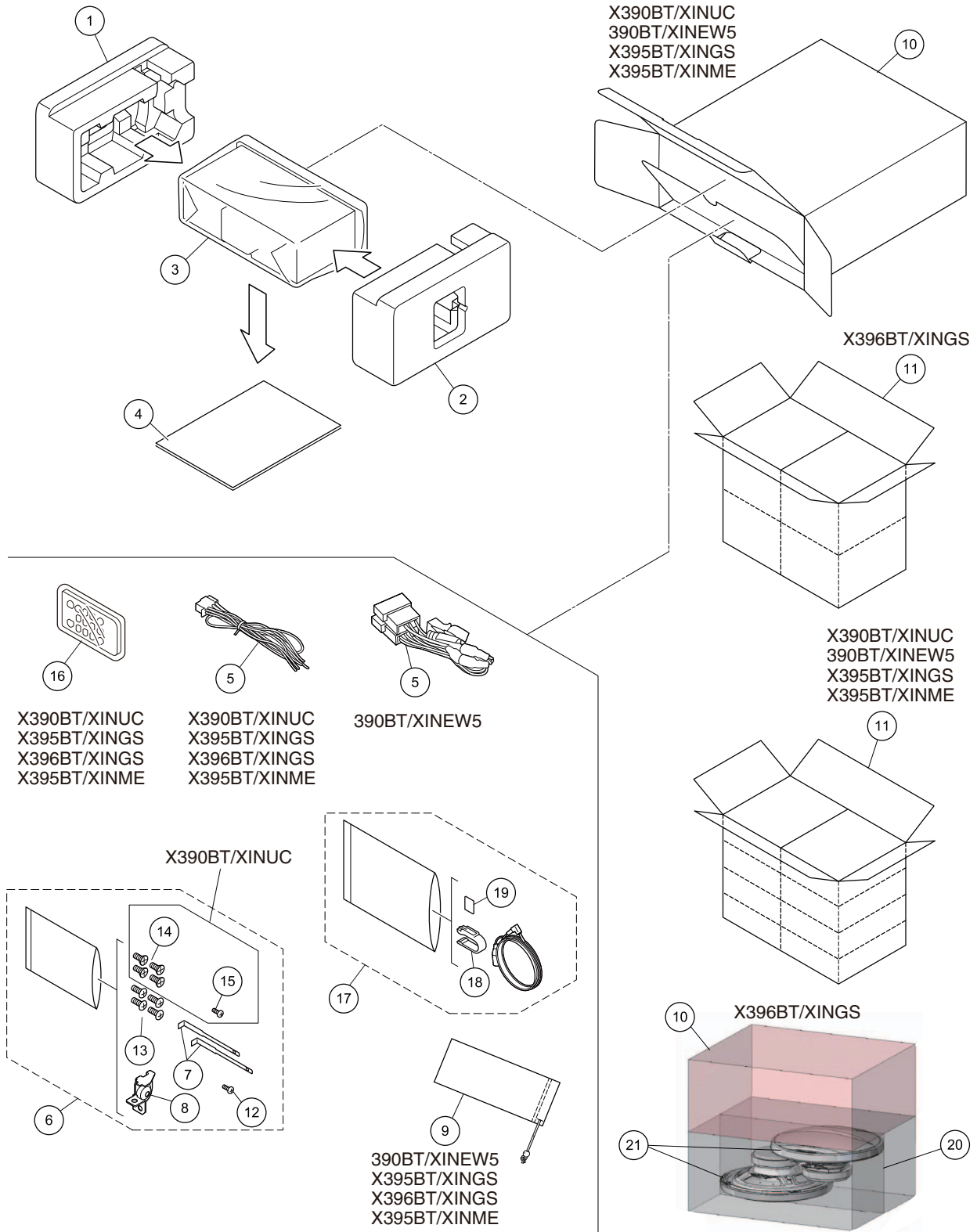

(1) PACKING SECTION PARTS LIST

Mark No.	Description	Part No.	Mark No.	Description	Part No.
A	1 Protector	QHP3051	11	Contain Box	See Contrast table (2)
	2 Protector	QHP3050	12	Screw	BSZ26P060FTC
	3 Polyethylene Bag	CEG1260	13	Screw	See Contrast table (2)
*	4-1 Warranty Card	See Contrast table (2)			
	4-2 Owner's Manual	See Contrast table (2)	14	Screw	See Contrast table (2)
			15	Screw	See Contrast table (2)
*	4-3 Service Network	See Contrast table (2)	16	Card Remote Control Unit	See Contrast table (2)
	5 Cord Assy	See Contrast table (2)	17	Microphone Assy	CPM1109
	6 Accessory Assy	See Contrast table (2)	18	Holder	CZN7192
	7 Handle	QNC3119			
	8 Bracket	QNC3086	19	Cushion	CZN7193
			20	Spacer	See Contrast table (2)
B	9 Detach Grille Case	See Contrast table (2)	* 21	Speaker Unit	See Contrast table (2)
	10 Unit Box	See Contrast table (2)			

(2) CONTRAST TABLE

MVH-X390BT/XINUC, MVH-390BT/XINEW5, MVH-X395BT/XINGS, MXT-X396BT/XINGS and MVH-X395BT/XINME are constructed the same except for the following:

Mark	No.	Description	MVH-X390BT/ XINUC	MVH-390BT/ XINEW5	MVH-X395BT/ XINGS	MXT-X396BT/ XINGS	MVH-X395BT/ XINME
*	4-1	Warranty Card	QRY3001	CRY1376	Not used	Not used	QRY3005
	4-2	Owner's Manual	QRD3395	QRD3394	QRD3409	QRD3410	QRD3408
*	4-3	Service Network	Not used	Not used	Not used	Not used	QRY3006
C	5	Cord Assy	CDP1480	QDP3071	CDP1480	CDP1480	CDP1480
	6	Accessory Assy	QEA3320	QEA3318	QEA3341	QEA3319	QEA3341
	9	Detach Grille Case	Not used	QEG3004	QEG3004	QEG3004	QEG3004
	10	Unit Box	QHG3942	QHG3958	QHG3943	QHG4093	QHG3953
	11	Contain Box	QHL3942	QHL3958	QHL3943	QHL4093	QHL3953
	13	Screw	CBA2384	Not used	CBA2384	CBA2384	CBA2384
	14	Screw	CBA2383	Not used	Not used	Not used	Not used
	15	Screw	BPZ20P060FTC	Not used	Not used	Not used	Not used
	16	Card Remote Control Unit	CXE9605	Not used	CXE9605	CXE9605	CXE9605
	20	Spacer	Not used	Not used	Not used	QHW3004	Not used
D	* 21	Speaker Unit	Not used	Not used	Not used	TS-165P/XIES	Not used

Owner's Manual, Installation Manual

Part No.	Language
QRD3395	English, French, Spanish(Espanol)
QRD3394	English, French, Italian, Spanish(Espanol), German, Dutch, Russian
QRD3409	English, Traditional Chinese, Arabic, Persian
QRD3410	English, Traditional Chinese, Arabic, Persian
QRD3408	English, French, Spanish(Espanol)

9.2 EXTERIOR

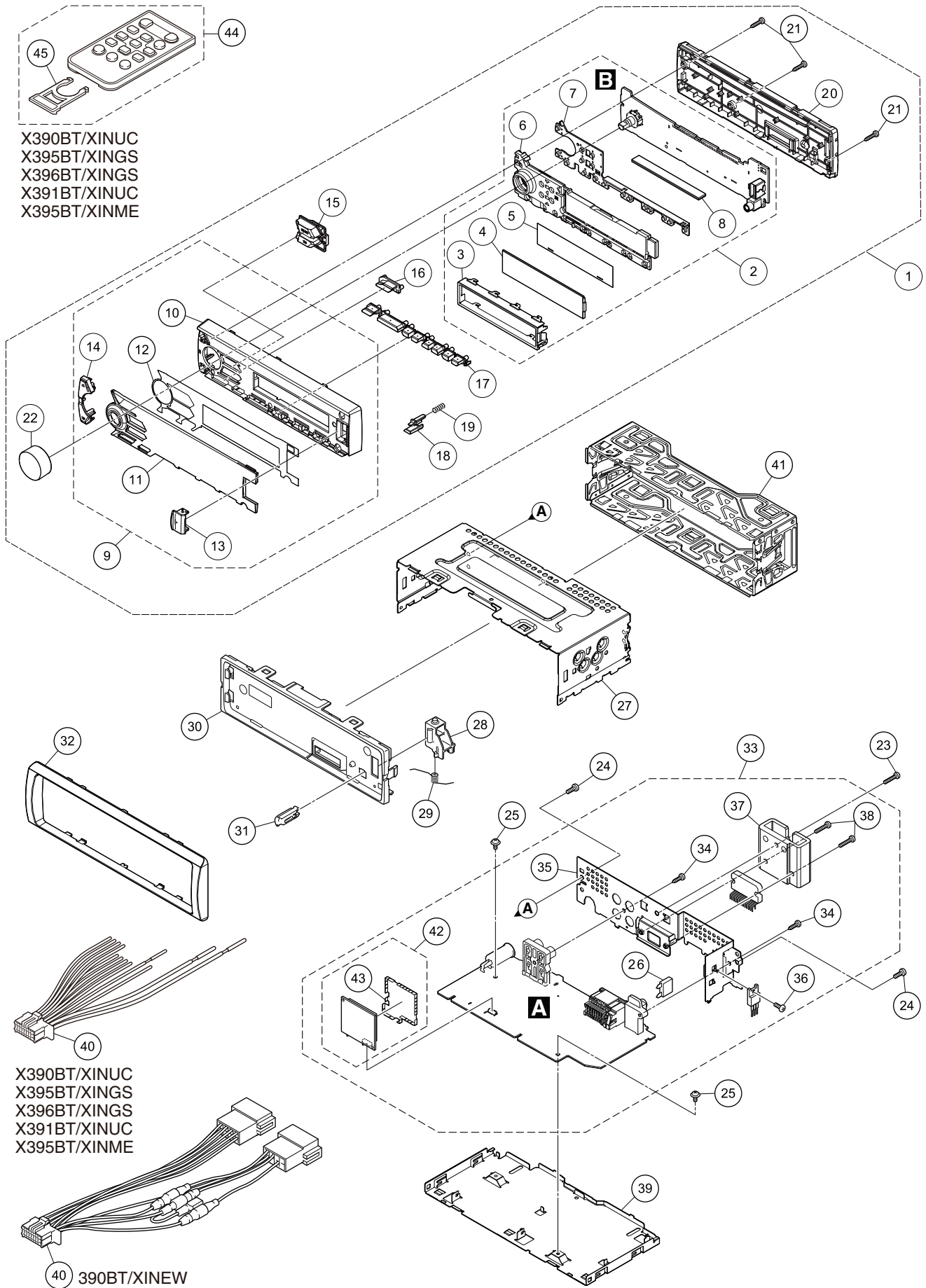

(1) EXTERIOR SECTION PARTS LIST

<u>Mark No.</u>	<u>Description</u>	<u>Part No.</u>	<u>Mark No.</u>	<u>Description</u>	<u>Part No.</u>
1	Detach Grille Assy	See Contrast table (2)	24	Screw	BSZ26P060FTC
2	Keyboard Unit	See Contrast table (2)	25	Screw	ASZ26P050FTC
3	Holder	QNC3130			
4	Segment LCD(V1801)	CAW2056	△ 26	Fuse(10 A)	YEK5001
5	Sheet	QNM3159	27	Chassis	QNA3027
			28	Arm	QNV3025
6	Lighting Conductor	QNV3130	29	Spring	QBH3001
7	Contact Rubber	QNV3131	30	Panel	QNS3289
8	Rubber Connector	QNV3129			
9	Grille Unit	See Contrast table (2)	31	Button	QNV3026
10	Grille	QNS4074	32	Panel	QNS3568
			33	Tuner Amp Unit	See Contrast table (2)
11	Plate	QNS4075	34	Screw	BPZ26P080FTC
12	DS Tape	QNM3163	35	Holder	See Contrast table (2)
13	Door	QAT3023			
14	Button(MUTE)	See Contrast table (2)	36	Screw	BSZ26P060FTC
15	Button(SRC)	QAC3243	37	Heat Sink	QNR3012
			38	Screw	BSZ26P160FTC
16	Button(PHONE)	QAC3246	39	Case	QNB3041
17	Button(TRACK, 1-6)	QAC3244	40	Cord Assy	See Contrast table (2)
18	Button(DETACH)	QAC3245			
19	Spring	CBH2210	41	Holder	QNC3118
20	Cover	QNS4077	42	BT Module	See Contrast table (2)
			43	Shield Case	YNC5123
21	Screw	BPZ20P100FTC	44	Card Remote Control Unit	See Contrast table (2)
22	Knob Unit	QXA4718	45	Cover	See Contrast table (2)
23	Screw	BSZ26P160FTC			

(2) CONTRAST TABLE

MVH-X390BT/XINUC, MVH-390BT/XINEW5, MVH-X395BT/XINGS, MXT-X396BT/XINGS and MVH-X395BT/XINME are constructed the same except for the following:

Mark	No.	Description	MVH-X390BT/ XINUC	MVH-390BT/ XINEW5	MVH-X395BT/ XINGS	MXT-X396BT/ XINGS	MVH-X395BT/ XINME
	1	Detach Grille Assy	QXA4812	QXA4811	QXA4813	QXA5008	QXA4813
	2	Keyboard Unit	QWM4382	QWM4381	QWM4382	QWM4382	QWM4382
	9	Grille Unit	QXA4792	QXA4791	QXA4793	QXA5012	QXA4793
	14	Button(MUTE)	QAC3259	QAC3259	QAC3261	QAC3261	QAC3261
	33	Tuner Amp Unit	QWM4354	QWM4353	QWM4357	QWM4451	QWM4402
	35	Holder	QNC3091	QNC3091	QNC3100	QNC3100	QNC3100
	40	Cord Assy	CDP1480	QDP3071	CDP1480	CDP1480	CDP1480
	42	BT Module	CWX4870	CWX4870	CWX4870	CWX4870	CWX4870
	44	Card Remote Control Unit	CXE9605	Not used	CXE9605	CXE9605	CXE9605
	45	Cover	CNU3681	Not used	CNU3681	CNU3681	CNU3681

12. ELECTRICAL PARTS LIST

NOTE:

- Parts whose parts numbers are omitted are subject to being not supplied.
- The part numbers shown below indicate chip components.

Chip Resistor

RS1/○S○○○○J,RS1/○○S○○○○J

Chip Capacitor (except for CQS.....)

CKS....., CCS....., CSZS.....

- Parts marked by " * " are generally unavailable because they are not in our Master Spare Parts List.
- The ⚠ mark found on some component parts indicates the importance of the safety factor of the part. Therefore, when replacing, be sure to use parts of identical designation.

- The expression of the unit in this manual is shown by u instead of μ. Please do not make a mistake.

	<u>Circuit Symbol and No.</u>	<u>Part No.</u>	<u>Circuit Symbol and No.</u>	<u>Part No.</u>
A:	MVH-X390BT/XINUC		IC 681	Flash ROM Unit(D) QWW4100
B:	MVH-390BT/XINEW5		IC 681	Flash ROM Unit(E) QWW4059
C:	MVH-X395BT/XINGS		IC 801	L-MOS And Gate TC7SET08FUS1
D:	MXT-X396BT/XINGS		IC 821	Regulator IC NJM2831F53
E:	MVH-X395BT/XINME		IC 881	Regulator IC S-1170B33UC-OTS
C	Unit Number: QWM4354(A)		IC 882	Regulator IC S-1155B12-U5
	Unit Number: QWM4353(B)		IC 941	Regulator IC MM3479A18P
	Unit Number: QWM4357(C)		IC 951	Regulator IC MM3411A33N
	Unit Number: QWM4451(D)		IC 991	Regulator IC BD00GA3EEFJ
	Unit Number: QWM4402(E)		Q 251	Transistor(A,B) EMH53
	Unit Name : Tuner Amp Unit		Q 252	Transistor EMH53
	Unit Number: QWM4382(A,C,D,E)		Q 301	Transistor EMD52
D	Unit Number: QWM4381(B)		Q 501	Bipolar Transistor LSAR523UB
	Unit Name : Keyboard Unit		Q 691	Chip Transistor HN1C01FU
	Unit Number: QWM4354(A)		Q 851	Transistor 2SCR514PGZE
	Unit Number: QWM4353(B)		Q 853	Transistor EMD52
	Unit Number: QWM4357(C)		Q 861	Bipolar Transistor KTD2092
	Unit Number: QWM4451(D)		Q 911	Bipolar Transistor(C,D,E) EMD53
	Unit Number: QWM4402(E)		Q 912	Bipolar Transistor(C,D,E) EMD53
	Unit Name : Tuner Amp Unit		Q 913	Bipolar Transistor(C,D,E) EMD53
	Unit Number: QWM4354(A)		Q 914	Bipolar Transistor(C,D,E) EMD53
	Unit Number: QWM4353(B)		Q 862	Transistor EMD52
	Unit Number: QWM4357(C)		Q 876	Transistor 2SAR502UB
	Unit Number: QWM4451(D)		Q 877	Transistor LTC143EUB
	Unit Number: QWM4402(E)		D 531	Diode RB056L-40
	Unit Name : Tuner Amp Unit		D 532	Schottky Diode CMS30I30A
E	MISCELLANEOUS		D 601	Schottky Diode(A,B) RB751SM-40
	IC 201	E-VOL System LSI PM9013A	D 602	Schottky Diode(A,B) RB751SM-40
	IC 301	Power Amp IC(A,B) PAL013B	D 691	Diode DZ2J075M0
	IC 301	Power Amp IC(C,D,E) PA2032A	D 692	Diode(Except B) DZ2J068M0
	IC 401	Tuner IC TEF6686HN-V102	D 692	Diode(B) DZ2J075M0
	IC 451	Regulator IC MM3571A33P	D 802	Diode DZ2S068C
	IC 501	IC 337S3959	D 803	Diode DZ2S068C
	IC 531	DC/DC Converter IC KBD9876EFJ	D 807	Diode DZ2S068C
	IC 532	Power supply IC BD2232G-G	D 808	Diode DZ2S068C
F	* IC601	Blank Flash IC R5S726A0D216FP	D 809	Diode DZ2S068C
	IC 671	IC S-80827CNMC-B8M	D 810	Diode DZ2S068C
	IC 681	Flash ROM Unit(A) QWW4014	D 851	Diode DZ2J100M0
	IC 681	Flash ROM Unit(B,C) QWW4013	D 861	Diode D1F60-5053
			D 862	Diode DZ2J068M0
			D 863	Diode RR264MM-400TF
			D 901	Diode D1F60-5053
			D 902	Diode D1F60-5053

5		6		7		8	
<u>Circuit Symbol and No.</u>		<u>Part No.</u>		<u>Circuit Symbol and No.</u>		<u>Part No.</u>	
D 913	Diode	DZ2S068C		R 504		RS1/16SS272J	
D 914	Diode	DZ2S068C		R 505		RS1/16SS472J	
D 981	Diode(A,B)	RR264MM-400TF					
				R 506		RS1/16SS472J	
D 982	Diode	RR264MM-400TF		R 507		RS1/16SS101J	A
L 202	Inductor	CTF1793		R 508		RS1/16SS101J	
L 402	Inductor(A,B,E)	LCTAW150J2520		R 531		RS1/16SS0R0J	
L 402	Inductor(C,D)	LCTAW3R3J2520		R 532		RS1/16SS1803D	
L 403	Inductor(C,D)	LCTAWR27J2520					
				R 533		RS1/16SS4302D	
L 404	Inductor(A,B,E)	CTF1389		R 534		RS1/10SR471J	
L 408	Inductor	LCMAR27J1608		R 535		RS1/16SS682J	
L 410	Inductor(C,D)	LCYAR82J2016		R 603		RS1/16SS473J	
L 531	SMD SPL Inductor	CTH1584		R 604		RS1/16SS473J	
L 801	Inductor	CTF1713					
				R 605		RS1/16SS473J	
L 901	Choke Coil	CTH1621		R 607		RS1/16SS152J	B
T 401	Variable Coil	CTC1215		R 608		RS1/16SS473J	
X 401	Crystal Resonator	CSS1867		R 609		RS1/16SS473J	
X 601	Crystal Resonator 12.000000 MHz	CSS1876		R 610		RS1/16SS103J	
X 603	Resonator 16.93 MHz	CSS1794					
				R 611		RS1/16SS103J	
△P253	Fuse 3.0 A	CEK1404		R 612	(A,B,E)	RS1/16SS473J	
P 401	Surge Absorber	IMSA-6803-01Y900		R 612	(C)	RS1/16SS103J	
VA801	SMD Varistor	MLV0402ES012V0010N		R 613	(C,D)	RS1/16SS473J	
VA802	SMD Varistor	MLV0402ES012V0010N		R 614		RS1/16SS473J	
CN801	Connector	CKS6452					
				R 615		RAB4CQ473J	
CN961	B to B Connector	CKS6346		R 616		RS1/16SS221J	
JA251	Jack(A,B)	CKB1109		R 617		RS1/16SS221J	C
JA251	Jack(C,D,E)	CKB1115		R 618		RS1/16SS221J	
JA401	Antenna Jack	CKX1104		R 619		RS1/16SS221J	
JA901	Plug	CKM1624					
				R 620		RS1/16SS221J	
JA912	Jack	CKN1103		R 621		RS1/16SS221J	
				R 622		RS1/16SS473J	
				R 623		RS1/16SS473J	
				R 624		RS1/16SS101J	
				R 625		RS1/16SS102J	
R 251	(A,B)	RS1/16SS821J		R 627		RS1/16SS473J	
R 252	(A,B)	RS1/16SS821J		R 628		RS1/16SS473J	
R 253	(A,B)	RS1/16SS223J		R 629		RS1/16SS473J	
R 254	(A,B)	RS1/16SS223J		R 631		RS1/16SS104J	D
R 255		RS1/16SS821J					
				R 632		RS1/16SS101J	
R 256		RS1/16SS821J		R 633		RS1/16SS101J	
R 257		RS1/16SS223J		R 635		RS1/16SS101J	
R 258		RS1/16SS223J		R 636		RS1/16SS102J	
R 305		RS1/16SS103J		R 637		RS1/16SS102J	
R 306		RS1/16SS221J					
				R 638		RS1/16SS102J	
R 307		RS1/16SS223J		R 639		RS1/16SS473J	
R 308		RS1/16SS103J		R 640		RS1/16SS222J	
R 403	(A,B,E)	RS1/16SS391J		R 641		RS1/16SS103J	
R 403	(C,D)	RS1/16SS101J		R 642		RS1/16SS473J	E
R 404		RS1/16SS105J					
				R 643		RS1/16SS473J	
R 405		RS1/16SS105J		R 644		RS1/16SS473J	
R 406		RS1/16SS101J		R 645		RS1/16SS473J	
R 407		RS1/16SS101J		R 646		RS1/16SS473J	
R 408		RS1/16SS103J		R 647		RS1/16SS473J	
R 410		RS1/16SS103J					
				R 648		RS1/16SS473J	
R 417		RS1/16SS0R0J		R 650		RS1/16SS473J	
R 430		RS1/10SR0R0J		R 651		RS1/16SS153J	
R 437		RS1/16SS472J		R 652		RS1/16SS153J	
R 438		RS1/16SS472J		R 653		RS1/16SS473J	
R 439		RS1/16SS0R0J					
				R 661		RS1/16SS222J	F
R 501		RS1/16SS473J		R 664		RS1/16SS473J	
R 502		RS1/16SS222J		R 665		RS1/16SS222J	
R 503		RS1/16SS222J					

RESISTORS

	1	2	3	4
	<u>Circuit Symbol and No.</u>	<u>Part No.</u>	<u>Circuit Symbol and No.</u>	<u>Part No.</u>
	R 667	RS1/16SS103J	<u>CAPACITORS</u>	
	R 668	RS1/16SS473J		
A	R 671	RS1/16SS104J	C 201	CCSSCH151J50
	R 681	RS1/16SS473J	C 202 10 uF	CCG1192
	R 682	RS1/16SS473J	C 203	CKSSYB104K10
	R 683	RS1/16SS473J	C 204	CKSSYB104K10
	R 684	RS1/16SS473J	C 205	CKSSYB104K10
	R 685	RS1/16SS473J	C 206	CEVW470M16
	R 691	RS1/16SS103J	C 207 10 uF	CCG1192
	R 692	RS1/16SS104J	C 210	CKSSYB104K16
	R 693	RS1/16SS473J	C 215	CKSRYB105K10
	R 694	RS1/16SS473J	C 216	CKSRYB105K10
	R 695 (Except B)	RS1/10SR682J	C 217	CKSRYB105K10
	R 695 (B)	RS1/10SR333J	C 218	CKSRYB105K10
B	R 696 (Except B)	RS1/4SA102J	C 220 10 uF	CCG1192
	R 696 (B)	RS1/4SA122J	C 221	CKSSYB104K10
	R 801	RS1/10SR222J	C 222 10 uF	CCG1192
	R 803	RS1/10SR222J	C 229	CKSRYB105K10
	R 805	RS1/10SR222J	C 230	CKSRYB105K10
	R 806	RS1/10SR222J	C 232	CKSSYB104K10
	R 807	RS1/10SR222J	C 233	CKSSYB104K10
	R 808	RS1/16SS822J	C 234 10 uF	CCG1192
	R 809	RS1/10SR222J	C 235	CCSSCH151J50
	R 810	RS1/10SR222J	C 239 1 uF	DCH1246
C	R 811	RS1/10SR223J	C 251 10 uF(A,B)	CCG1192
	R 812	RS1/10SR223J	C 252 10 uF(A,B)	CCG1192
	R 813	RS1/10SR101J	C 253 (A,B)	CCSSCH101J50
	R 814	RS1/10SR101J	C 254 (A,B)	CCSSCH101J50
	R 815	RS1/10SR101J	C 255 10 uF	CCG1192
	R 816	RS1/10SR220J	C 256 10 uF	CCG1192
	R 817	RS1/10SR220J	C 257	CCSSCH101J50
	R 852	RS1/10SR102J	C 258	CCSSCH101J50
	R 854	RS1/10SR473J	C 259	CCSRCH102J50
	R 861	RS1/10SR122J	C 260	CKSSYB104K10
	R 862	RS1/10SR223J	C 261	CKSSYB103K16
D	R 880	RS1/16SS103J	C 301	CKSRYB474K10
	R 881	RS1/16SS272J	C 302	CKSRYB474K10
	R 882	RS1/16SS473J	C 303	CKSRYB474K10
	R 883	RS1/16SS473J	C 304	CKSRYB474K10
	R 911	RS1/10SR102J	C 309 2.2 uF	CCG1205
	R 912	RS1/10SR102J	C 312 10 uF/16 V	DCH1263
	R 914 (C,D,E)	RS1/16SS681J	C 316	CKSRYB105K10
	R 915 (C,D,E)	RS1/16SS681J	C 324	CKSRYB104K16
	R 916 (C,D,E)	RS1/16SS822J	C 325 2 200 uF/16V	CCH1659
	R 917 (C,D,E)	RS1/16SS822J	C 405	CKSSYB102K50
E	R 918	RS1/16SS0R0J	C 409	CKSSYB224K6R3
	R 961	RS1/16SS221J	C 410	CCSSCH220J50
	R 962	RS1/16SS221J	C 411	CCSSCH331J50
	R 963	RS1/16SS221J	C 412	CCSSCH100D50
	R 964	RS1/16SS102J	C 414	CKSSYB102K50
	R 965	RS1/16SS102J	C 416 (C,D)	CCSSCH120J50
	R 966	RS1/16SS222J	C 417 (C,D)	CCSSCK1R0C50
	R 967	RS1/16SS101J	C 418 (C,D)	CCSSCK2R0C50
	R 968	RS1/16SS101J	C 419 (C,D)	CCSSCK1R0C50
	R 969	RS1/16SS102J	C 420	CCSSCH471J50
	R 970	RS1/16SS222J	C 422	CKSSYB152K50
F	R 991	RS1/16SS2702D	C 425	CCSSCH390J50
	R 992	RS1/16SS4301D	C 428	CKSSYB104K10
			C 430	CKSSYB102K50
			C 434	CCSSCH100D50

5		6		7		8	
<u>Circuit Symbol and No.</u>		<u>Part No.</u>		<u>Circuit Symbol and No.</u>		<u>Part No.</u>	
C 442	10 uF	CCG1192		C 841	10 uF	CCG1192	
C 452		CKSRYB104K16		C 842	10 uF	CCG1192	
C 453		CKSRYB105K10		C 852		CCSRCH101J50	A
C 458		CCSSCH102J50		C 853		CKSSYB104K16	
C 459		CKSRYB105K10		C 861		CEAT102M16	
C 501		CKSSYB104K10		C 862		CKSSYB104K16	
C 502		CKSSYB104K10		C 864	10 uF	CCG1192	
C 531		CKSSYB103K16		C 883	10 uF	CCG1192	
C 532		CEVQW221M6R3		C 884	10 uF	CCG1192	
C 534		CKSRYB105K10		C 885	10 uF	CCG1192	
C 535	10 uF	CCG1192		C 886	10 uF	CCG1192	
C 536		CKSSYB682K25		C 914		CKSSYB102K50	
C 539	4.7 uF	CCG1222		C 915		CKSSYB102K50	
C 540	1 uF	CCG1393		C 942	4.7 uF	CCG1212	
C 541		CEVW471M16		C 943	4.7 uF	CCG1212	B
C 542		CKSRYB105K10		C 946		CKSSYB104K10	
C 545		CKSRYB105K10		C 951	4.7 uF	CCG1212	
C 601		CKSSYB104K10		C 954	4.7 uF	CCG1212	
C 602		CKSSYB102K50		C 961		CEVW221M4	
C 603		CKSSYB104K10		C 962	1 uF	DCH1246	
C 604		CKSSYB102K50		C 963	1 uF	DCH1246	
C 605		CKSSYB104K10		C 966	4.7 uF	CCG1212	
C 606		CCSSCH120J50		C 968		CCSSCH270J50	
C 607		CCSSCH120J50		C 970		CKSSYB104K10	
C 608		CKSSYB104K10		C 991		CKSRYB105K16	C
C 609		CKSSYB104K10		C 992		CKSRYB105K16	
C 610		CKSSYB104K10		B Unit Number : QWM4382(A,C,D,E) Unit Number : QWM4381(B) Unit Name : Keyboard Unit			
C 611		CKSSYB104K10					
C 612		CKSSYB104K10					
C 613		CKSSYB104K10					
C 614		CKSSYB104K10					
C 615		CCSSCH220J50		MISCELLANEOUS			
C 616		CKSSYB104K10		IC 1801	IC	PD6586A8	
C 617		CKSSYB104K10		IC 1941	IC(Except B)	SIR8440B5	D
C 618		CKSSYB104K10		Q 1951	Transistor(Except B)	LTC014EEB	
C 619		CKSSYB104K10		Q 1952	Transistor(B)	LTC014EEB	
C 620		CKSSYB104K10		D 1951	White LED	CSL0401WBHCW1(A)	
C 621		CKSSYB104K10		D 1952	Blue LED(Except B)	FC-F1608BAK5	
C 628		CKSSYB104K10		D 1953	Blue LED(Except B)	FC-F1608BAK5	
C 629		CCSSCH220J50		D 1954	Blue LED(Except B)	FC-F1608BAK5	
C 630		CCSSCH220J50		D 1955	Blue LED(Except B)	FC-F1608BAK5	
C 631		CCSSCH220J50		D 1956	Blue LED(Except B)	FC-F1608BAK5	
C 632		CCSSCH120J50		D 1957	Blue LED(Except B)	FC-F1608BAK5	
C 633		CCSSCH120J50		D 1958	Blue LED(Except B)	FC-F1608BAK5	
C 638		CKSSYB104K10		D 1959	Blue LED(Except B)	FC-F1608BAK5	E
C 639		CCSRCH101J50		D 1960	Blue LED(Except B)	FC-F1608BAK5	
C 641		CCSSCH330J50		D 1961	Blue LED(Except B)	FC-F1608BAK5	
C 672		CKSRYB105K10		D 1962	Blue LED(Except B)	FC-F1608BAK5	
C 681		CKSSYB104K10		D 1963	Blue LED(Except B)	FC-F1608BAK5	
C 683		CCSSCJ3R0C50		D 1964	Blue LED(Except B)	FC-F1608BAK5	
C 691		CKSRYB104K50		D 1966	Blue LED(Except B)	FC-F1608BAK5	
C 693		CCSSCH101J50		D 1968	Red LED(B)	FC-1608SXX630D08	
C 801		CCSRCH102J50		D 1969	Red LED(B)	FC-1608SXX630D08	
C 805		CKSRYB104K16		D 1970	Red LED(B)	FC-1608SXX630D08	
C 806		CCSRCH221J50		D 1971	Red LED(B)	FC-1608SXX630D08	
C 807		CCSRCH221J50		D 1973	Red LED(B)	FC-1608SXX630D08	F
C 808		CKSRYB104K16		D 1974	Red LED(B)	FC-1608SXX630D08	
C 810		CKSRYB104K16		D 1975	Red LED(B)	FC-1608SXX630D08	
C 811		CKSRYB105K10					
C 813		CKSSYB104K10					

1

Circuit Symbol and No.

2

Part No.

3

Circuit Symbol and No.

4

Part No.

D 1976 Red LED(B) FC-1608SXX630D08
 D 1977 Red LED(B) FC-1608SXX630D08
 A D 1978 Red LED(B) FC-1608SXX630D08
 D 1979 Red LED(B) FC-1608SXX630D08
 D 1980 Red LED(B) FC-1608SXX630D08

D 1981 Red LED(B) FC-1608SXX630D08
 D 1982 Red LED(B) FC-1608SXX630D08
 D 1983 Blue LED(Except B) FC-F1608BAK5
 D 1984 Red LED(B) FC-1608SXX630D08
 X 1801 Ceramic Resonator 5.00 MHz CSS1547

S 1839 Encoder(MULTI-CONTROL) CSD1193
 CN1931 Connector CKS6451
 JA1911 Connector CKS6443
 B JA1921 Jack CKN1090
 V 1801 Segment LCD CAW2056

C 1807
 C 1808
 C 1912
 C 1941 10 uF(Except B)

CKSRYB105K10
 CCSRCH221J50
 CKSRYB102K50
 CCG1192

RESISTORS

R 1801 RS1/10SR473J
 R 1802 RS1/10SR473J
 R 1803 RS1/10SR222J
 R 1805 RS1/10SR473J
 R 1806 RS1/10SR473J

R 1807 RS1/10SR473J
 R 1808 RS1/10SR473J
 C R 1823 RS1/10SR273J
 R 1921 RS1/10SR0R0J
 R 1922 RS1/10SR0R0J

R 1923 RS1/10SR0R0J
 R 1931 RS1/10SR222J
 R 1932 RS1/10SR222J
 R 1941 (B) RS1/10SR473J
 R 1944 (Except B) RS1/10SR101J

R 1951 RS1/4SA181J
 R 1952 RS1/4SA101J
 D R 1954 (Except B) RS1/10SR681J
 R 1958 (Except B) RS1/10SR182J
 R 1960 (Except B) RS1/10SR272J

R 1962 (Except B) RS1/10SR392J
 R 1964 (Except B) RS1/10SR392J
 R 1966 (Except B) RS1/10SR392J
 R 1968 (Except B) RS1/10SR471J
 R 1969 (Except B) RS1/10SR272J

R 1972 (Except B) RS1/10SR0R0J
 R 1973 (B) RS1/10SR0R0J
 R 1975 (B) RS1/10SR182J
 E R 1978 (B) RS1/10SR182J
 R 1979 (B) RS1/4SA471J

R 1982 (B) RS1/10SR681J
 R 1984 (B) RS1/10SR821J
 R 1986 (B) RS1/10SR821J
 R 1988 (B) RS1/10SR821J
 R 1989 (B) RS1/4SA821J

R 1991 (Except B) RS1/10SR0R0J
 R 1996 (B) RS1/10SR0R0J
 R 1998 (Except B) RS1/10SR182J
 F R 2000 (B) RS1/10SR122J

CAPACITORS

C 1806 CKSRYB104K16