

KAC-X20

EXPLODED VIEW

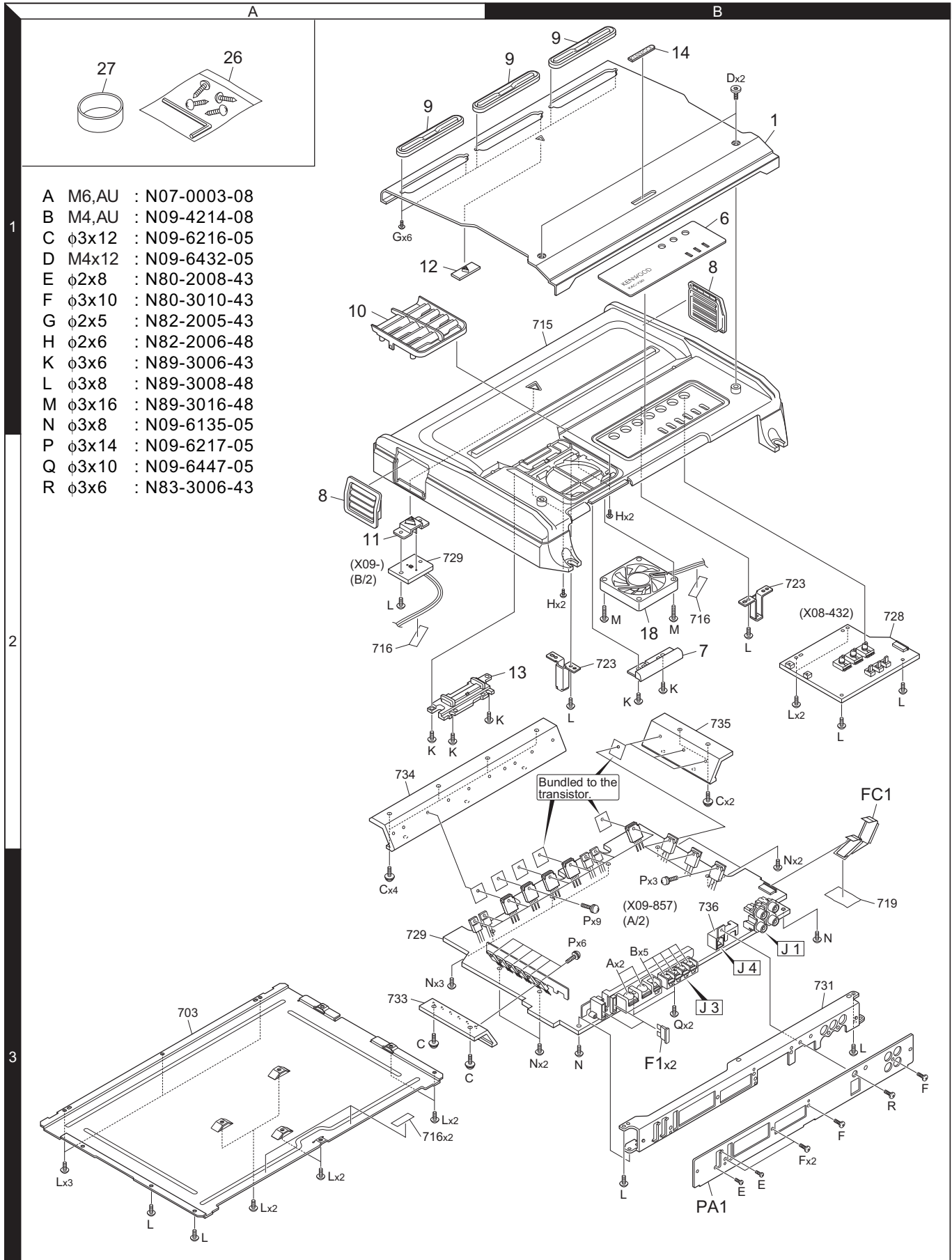

PARTS LIST

* New parts

Parts without **Parts No.** are not supplied.

Les articles non mentionnés dans le **Parts No.** ne sont pas fournis.

Teile ohne **Parts No.** werden nicht geliefert.

Ref. No.	Added	New	Parts No.	Description	Destination
KAC-X20					
1	1B	*	A21-6570-01	DRESSING PANEL	
PA1	3B	*	A64-4086-02	PANEL	
6	1B	*	B03-5087-12	DRESSING PLATE	
7	2B		B07-3194-03	ESCUTCHEON	
8	2A		B07-3197-02	ESCUTCHEON	
9	1B	*	B07-3207-03	ESCUTCHEON	
10	1A	*	B07-3208-12	ESCUTCHEON	
11	2A		B19-2324-03	LIGHTING BOARD	
12	1A	*	B19-2424-04	LIGHTING BOARD	
13	2A	*	B19-2431-02	LIGHTING BOARD	
14	1B		B43-0336-04	BADGE	
-		*	B64-3519-00	INSTRUCTION MANUAL (ENG.FRE.SPA)	
FC1	2B		E39-0699-15	FLAT CABLE	
18	2B		F09-1885-15	FAN	
△ F1	3B		F52-0015-05	FUSE(BLADE TYPE) 30A	
-		*	H54-3885-03	ITEM CARTON CASE	
26	1A		N99-1794-05	SCREW & WRENCH KEY SET	
A	3B		N07-0003-08	SCREW (M6, AU)	
B	3B		N09-4214-08	SCREW (M4, AU)	
C	3A		N09-6216-05	TAPTITE SCREW (3X12)	
D	1B	*	N09-6432-05	DRESSED SCREW (M4X12)	
E	3B		N80-2008-43	PAN HEAD TAPTITE SCREW	
F	3B		N80-3010-43	PAN HEAD TAPTITE SCREW	
G	1A		N82-2005-43	BINDING HEAD TAPTITE SCREW	
H	2B		N82-2006-48	BINDING HEAD TAPTITE SCREW	
K	2B		N89-3006-43	BINDING HEAD TAPTITE SCREW	
L	3A		N89-3008-48	BINDING HEAD TAPTITE SCREW	
M	2B		N89-3016-48	BINDING HEAD TAPTITE SCREW	
27	1A		W01-1606-05	ACCESSORIES	
PREAMPLIFIER UNIT (X08-4320-10)					
C1-6			CC73GCH1H070D	CHIP C 7.0PF D	
C7,8			CD04AS1V100M	ELECTRO 10UF 35WV	
C51-54			CD04BJ1H100M	ELECTRO 10UF 50WV	
C103-106			CK73GB1H104K	CHIP C 0.10UF K	
C107,108			CD04BJ1H100M	ELECTRO 10UF 50WV	
C109-112			CD04AS1V100M	ELECTRO 10UF 35WV	
C113-124			CD04AS1H010M	ELECTRO 1UF 50WV	
C153			CK73FB1E154K	CHIP C 0.15UF K	
C154			CK73GB1H333K	CHIP C 0.033UF K	
C156			CK73FB1E154K	CHIP C 0.15UF K	
C157			CK73GB1H333K	CHIP C 0.033UF K	
C158			CD04BJ1H100M	ELECTRO 10UF 50WV	
C602			CK73GB1H103K	CHIP C 0.010UF K	
C603			CD04BJ1E470M	ELECTRO 47UF 25WV	
C604			CD04BJ1H100M	ELECTRO 10UF 50WV	
CN1			E41-1699-05	PIN ASSY	
CN3			E41-1700-05	PIN ASSY	
CN8			E41-2277-05	FLAT CABLE CONNECTOR	
R1-10			RK73GB2A100J	CHIP R 10 J 1/10W	

Ref. No.	Added	New	Parts No.	Description	Destination
R11,12			RK73GB2A101J	CHIP R 100 J 1/10W	
R13,14			RK73GB2A100J	CHIP R 10 J 1/10W	
R15,16			RK73GB2A101J	CHIP R 100 J 1/10W	
R17,18			RK73GB2A472J	CHIP R 4.7K J 1/10W	
R105,106			RK73GB2A203J	CHIP R 20K J 1/10W	
R107,108			RK73GB2A133J	CHIP R 13K J 1/10W	
R110,111			RK73GB2A473J	CHIP R 47K J 1/10W	
R121			RK73GB2A103J	CHIP R 10K J 1/10W	
R122			RK73GB2A621J	CHIP R 620 J 1/10W	
R123,124			RK73GB2A473J	CHIP R 47K J 1/10W	
R126			RK73GB2A103J	CHIP R 10K J 1/10W	
R128			RK73GB2A623J	CHIP R 62K J 1/10W	
R129,130			RK73GB2A473J	CHIP R 47K J 1/10W	
R131,132			RK73GB2A103J	CHIP R 10K J 1/10W	
R133,134			RK73GB2A392J	CHIP R 3.9K J 1/10W	
R135,136			RK73GB2A273J	CHIP R 27K J 1/10W	
R137,138			RK73GB2A202J	CHIP R 2.0K J 1/10W	
R139,140			RK73GB2A183J	CHIP R 18K J 1/10W	
R141,142			RK73GB2A104J	CHIP R 100K J 1/10W	
R143,144			RK73GB2A822J	CHIP R 8.2K J 1/10W	
R145,146			RK73GB2A431J	CHIP R 430 J 1/10W	
R147,148			RK73GB2A473J	CHIP R 47K J 1/10W	
R152,153			RK73GB2A203J	CHIP R 20K J 1/10W	
R155,156			RK73GB2A103J	CHIP R 10K J 1/10W	
R157			RK73GB2A184J	CHIP R 180K J 1/10W	
R158			RK73GB2A752J	CHIP R 7.5K J 1/10W	
R160			RK73GB2A912J	CHIP R 9.1K J 1/10W	
R161			RK73GB2A104J	CHIP R 100K J 1/10W	
R162			RK73GB2A752J	CHIP R 7.5K J 1/10W	
R163			RK73GB2A473J	CHIP R 47K J 1/10W	
R601			RK73EB2E122J	CHIP R 1.2K J 1/4W	
R603			RK73EB2E100J	CHIP R 10 J 1/4W	
R630			RK73GB2A563J	CHIP R 56K J 1/10W	
R631			RK73GB2A103J	CHIP R 10K J 1/10W	
VR4			R31-0238-05	VARIABLE RESISTOR	
VR101			R31-0241-05	VARIABLE RESISTOR	
VR152			R31-0241-05	VARIABLE RESISTOR	
W301-303			R92-1252-05	CHIP R 0 OHM J 1/16W	
W304			R92-2053-05	CHIP R 0 OHM J 1/8W	
W305-307			R92-1252-05	CHIP R 0 OHM J 1/16W	
W308-314			R92-2053-05	CHIP R 0 OHM J 1/8W	
W315			R92-1252-05	CHIP R 0 OHM J 1/16W	
W316			R92-2053-05	CHIP R 0 OHM J 1/8W	
W317			R92-1252-05	CHIP R 0 OHM J 1/16W	
W318,319			R92-2053-05	CHIP R 0 OHM J 1/8W	
W320			R92-1252-05	CHIP R 0 OHM J 1/16W	
W321-328			R92-2053-05	CHIP R 0 OHM J 1/8W	
W329,330			R92-1252-05	CHIP R 0 OHM J 1/16W	
W331,332			R92-2053-05	CHIP R 0 OHM J 1/8W	
W333			R92-1252-05	CHIP R 0 OHM J 1/16W	
W334			R92-2053-05	CHIP R 0 OHM J 1/8W	
W335			R92-1252-05	CHIP R 0 OHM J 1/16W	
W336,337			R92-2053-05	CHIP R 0 OHM J 1/8W	
W338			R92-1252-05	CHIP R 0 OHM J 1/16W	
W339			R92-2053-05	CHIP R 0 OHM J 1/8W	

(North America)

△ Indicates safety critical components.

PARTS LIST

PREAMPLIFIER UNIT (X08-4320-10)

Ref. No.	Add	New	Parts No.	Description	Destination
W340,341			R92-1252-05	CHIP R 0 OHM J 1/16W	
W342			R92-2053-05	CHIP R 0 OHM J 1/8W	
W343			R92-1252-05	CHIP R 0 OHM J 1/16W	
W344			R92-2053-05	CHIP R 0 OHM J 1/8W	
S1		*	S62-0879-05	SLIDE SWITCH	
S6,7		*	S62-0880-05	SLIDE SWITCH	
D614			LM1MA142WK-G	DIODE	
IC1-5			BA4560RF	ANALOGUE IC	

AUDIO UNIT (X09-8570-10)

D609			B30-1743-05	LED (RED LED)	
C1			CD04AU1H100M	NP ELEC 10UF 50WV	
C2-4			CD04BJ1E470M	ELECTRO 47UF 25WV	
C5			CD04BJ1H100M	ELECTRO 10UF 50WV	
C6,7		*	C90-6841-05	ELECTR 4700UF 56WV	
C8,9			CK45FB1H102K	CERAMIC 1000PF K	
C10,11			C90-6816-05	ELECTR 3300UF 16WV	
C12			CD04BJ1H100M	ELECTRO 10UF 50WV	
C13			CD04AU1H2R2M	NP-ELEC 2.2UF 50WV	
C14			CK73GB1H104K	CHIP C 0.10UF K	
C15			CD04BJ1E470M	ELECTRO 47UF 25WV	
C16			CD04BJ1H100M	ELECTRO 10UF 50WV	
C17			CK45FB1H102K	CERAMIC 1000PF K	
C18			CK45FB1H222K	CERAMIC 2200PF K	
C19,20			CQ93FMG1H473J	MYLAR 0.047UF J	
C21,22			CK73GB1H103K	CHIP C 0.010UF K	
C23			CC73GCH1H070D	CHIP C 7.0PF D	
C24			CD04BJ1H100M	ELECTRO 10UF 50WV	
C39,40			CC73GCH1H070D	CHIP C 7.0PF D	
C41,42			CC73GCH1H100D	CHIP C 10PF D	
C43,44			CD04BJ1H100M	ELECTRO 10UF 50WV	
C53			CD04BJ1H100M	ELECTRO 10UF 50WV	
C54			CC73GCH1H100D	CHIP C 10PF D	
C55,56			CC73GCH1H070D	CHIP C 7.0PF D	
C57,58			CD04BJ1H100M	ELECTRO 10UF 50WV	
C101,102			CC73GCH1H471J	CHIP C 470PF J	
C103			CK73GB1H104K	CHIP C 0.10UF K	
C104,105			CD04BJ1H100M	ELECTRO 10UF 50WV	
C106,107			CC73GCH1H070D	CHIP C 7.0PF D	
C108,109			CK73GB1H103K	CHIP C 0.010UF K	
C110			CK73GB1H102K	CHIP C 1000PF K	
C111,112			CC73GCH1H150J	CHIP C 15PF J	
C113-116			CC73GCH1H101J	CHIP C 100PF J	
C117,118			CD04BJ1H220M	ELECTRO 22UF 50WV	
C125,126			CD04BJ1H100M	ELECTRO 10UF 50WV	
C127,128			CK73GB1H473K	CHIP C 0.047UF K	
C129			CD04BJ1H100M	ELECTRO 10UF 50WV	
C133,134			CK73GB1H473K	CHIP C 0.047UF K	
C135-137			CD04BJ1H100M	ELECTRO 10UF 50WV	
C138,139			CK73GB1H104K	CHIP C 0.10UF K	
C140,141			CC73GCH1H220J	CHIP C 22PF J	
C142-145			CD04BJ1H100M	ELECTRO 10UF 50WV	
C146-148			CC73GCH1H101J	CHIP C 100PF J	
C153			CC73GCH1H101J	CHIP C 100PF J	

Ref. No.	Add	New	Parts No.	Description	Destination
C156			CD04BJ1H100M	ELECTRO 10UF 50WV	
C201,202			CD04BJ1H100M	ELECTRO 10UF 50WV	
C203,204			CC73GCH1H221J	CHIP C 220PF J	
C205,206			CK73GB1H472K	CHIP C 4700PF K	
C207,208			CD04BJ1E470M	ELECTRO 47UF 25WV	
C209,210			CC45FCH1H150J	CERAMIC 15PF J	
C211,212			CC73GCH1H331J	CHIP C 330PF J	
C213,214			CC73GCH1H220J	CHIP C 22PF J	
C215,216			CD04BJ1H100M	ELECTRO 10UF 50WV	
C217,218			CC73GCH1H220J	CHIP C 22PF J	
C219-222			CK73GB1H102K	CHIP C 1000PF K	
C223			CD04BJ1J101M	ELECTRO 100UF 63WV	
C224			CD04BJ1A101M	ELECTRO 100UF 10WV	
C225,226			CC73GCH1H471J	CHIP C 470PF J	
C227,228			CC73GCH1H470J	CHIP C 47PF J	
C229			CD04BJ1J101M	ELECTRO 100UF 63WV	
C263,264			CC73GCH1H221J	CHIP C 220PF J	
C601			CD04BJ1V330M	ELECTRO 33UF 35WV	
C602-605			CD04BJ1H100M	ELECTRO 10UF 50WV	
C606			CD04BJ1E470M	ELECTRO 47UF 25WV	
C607			CK73GB1H103K	CHIP C 0.010UF K	
C608			CD04BJ1A101M	ELECTRO 100UF 10WV	
C609,610			CK73GB1H103K	CHIP C 0.010UF K	
C611			CD04BJ1H010M	ELECTRO 1.0UF 50WV	
C613,614			CK73GB1H103K	CHIP C 0.010UF K	
C616			CK73GB1H104K	CHIP C 0.10UF K	
C617,618			CD04BJ1H100M	ELECTRO 10UF 50WV	
C901,902			CC73GCH1H150J	CHIP C 15PF J	
CN1			E41-2277-05	FLAT CABLE CONNECTOR	
J1		*	E63-0948-05	PIN JACK	
J3			E70-0838-05	SCREW TERMINAL BOARD	
J4			E58-0966-15	RECTANGULAR RECEPTACLE	
WH1			E39-0710-05	WIRING HARNESS	
△ CN2			J13-0602-05	FUSE HOLDER	
L1,2		*	L33-2413-05	CHOKE COIL	
L3			L19-0771-05	TRANSFORMER FOR CONVERTER	
N	3B		N09-6135-05	TAPTITE SCREW (3X8 B-T)	
P	3B		N09-6217-05	TAPTITE SCREW (3X14)	
Q	3B		N09-6447-05	TAPTITE SCREW (3X10 P-T)	
R	3B		N83-3006-43	PAN HEAD TAPTITE SCREW	
R1			RK73GB2A183J	CHIP R 18K J 1/10W	
R2			RK73GB2A103J	CHIP R 10K J 1/10W	
R3			RK73GB2A821J	CHIP R 820 J 1/10W	
R4			RK73EB2E123J	CHIP R 12K J 1/4W	
R5,6			RD14BB2C333J	RD 33K J 1/6W	
R7,8			RD14DB2H100J	SMALL-RD 10 J 1/2W	
R9,10			RK73GB2A472J	CHIP R 4.7K J 1/10W	
R11-14			RK73GB2A470J	CHIP R 47 J 1/10W	
R15,16			RK73GB2A152J	CHIP R 1.5K J 1/10W	
R17			RK73GB2A273J	CHIP R 27K J 1/10W	
R18			RK73GB2A822J	CHIP R 8.2K J 1/10W	
R19			RK73GB2A103J	CHIP R 10K J 1/10W	
R20			RK73GB2A334J	CHIP R 330K J 1/10W	

(North America)

△ Indicates safety critical components.

PARTS LIST

AUDIO UNIT (X09-8570-10)

Ref. No.	Add	New	Parts No.	Description	Destination	Ref. No.	Add	New	Parts No.	Description	Destination
R21			RK73GB2A103J	CHIP R 10K J 1/10W		R211,212			RD14BB2C102J	RD 1.0K J 1/6W	
R22			RK73GB2A104J	CHIP R 100K J 1/10W		R213,214			RD14BB2C223J	RD 22K J 1/6W	
R23			RK73GB2A103J	CHIP R 10K J 1/10W		R215-218			RK73GB2A101J	CHIP R 100 J 1/10W	
R24			RK73GB2A203J	CHIP R 20K J 1/10W		R219-222			RK73EB2E472J	CHIP R 4.7K J 1/4W	
R25			RK73GB2A682J	CHIP R 6.8K J 1/10W		R223,224			RK73GB2A101J	CHIP R 100 J 1/10W	
R26			RK73GB2A104J	CHIP R 100K J 1/10W		R225,226			RK73GB2A331J	CHIP R 330 J 1/10W	
R27			RK73GB2A102J	CHIP R 1.0K J 1/10W		R227,228			RK73GB2A103J	CHIP R 10K J 1/10W	
R28-30			RD14DB2H100J	SMALL-RD 10 J 1/2W		R229-232			RK73GB2A222J	CHIP R 2.2K J 1/10W	
R31,32			RK73GB2A103J	CHIP R 10K J 1/10W		R233-236			RK73GB2A101J	CHIP R 100 J 1/10W	
R33			RK73GB2A101J	CHIP R 100 J 1/10W		R237,238			RK73GB2A222J	CHIP R 2.2K J 1/10W	
R34			RK73GB2A391J	CHIP R 390 J 1/10W		R239,240			RK73GB2A101J	CHIP R 100 J 1/10W	
R35			RK73GB2A103J	CHIP R 10K J 1/10W		R241,242			RK73GB2A472J	CHIP R 4.7K J 1/10W	
R36,37			RK73GB2A101J	CHIP R 100 J 1/10W		R243			R92-0205-05	METAL-PLATE 0.1 K 2W	
R38,39			RK73GB2A471J	CHIP R 470 J 1/10W		R244			RK73GB2A103J	CHIP R 10K J 1/10W	
R40,41			RK73GB2A101J	CHIP R 100 J 1/10W		R245-248			R92-0205-05	METAL-PLATE 0.1 K 2W	
R43,44			RK73GB2A243J	CHIP R 24K J 1/10W		R249,250			RK73GB2A222J	CHIP R 2.2K J 1/10W	
R45,46			RK73GB2A2R2J	CHIP R 2.2 J 1/10W		R251			RK73GB2A331J	CHIP R 330 J 1/10W	
R47,48			RK73GB2A101J	CHIP R 100 J 1/10W		R252			RK73GB2A473J	CHIP R 47K J 1/10W	
R49			RK73GB2A1R0J	CHIP R 1.0 J 1/10W		R253,254			RK73GB2A101J	CHIP R 100 J 1/10W	
R50			RK73GB2A100J	CHIP R 10 J 1/10W		R257,258			R92-0205-05	METAL-PLATE 0.1 K 2W	
R51,52			RK73GB2A2R2J	CHIP R 2.2 J 1/10W		R260			RK73GB2A331J	CHIP R 330 J 1/10W	
R53			RK73GB2A102J	CHIP R 1.0K J 1/10W		R261,262			RK73GB2A221J	CHIP R 220 J 1/10W	
R54-57			RK73GB2A470J	CHIP R 47 J 1/10W		R263,264			RK73GB2A152J	CHIP R 1.5K J 1/10W	
R101,102			RD14BB2C102J	RD 1.0K J 1/6W		R265,266			RK73GB2A103J	CHIP R 10K J 1/10W	
R103,104			RK73GB2A103J	CHIP R 10K J 1/10W		R267,268			RK73GB2A392J	CHIP R 3.9K J 1/10W	
R105,106			RK73GB2A152J	CHIP R 1.5K J 1/10W		R271,272			RK73GB2A221J	CHIP R 220 J 1/10W	
R107,108			RK73GB2A103J	CHIP R 10K J 1/10W		R273,274			RK73GB2A183J	CHIP R 18K J 1/10W	
R109,110			RK73GB2A123J	CHIP R 12K J 1/10W		R275,276			RK73GB2A103J	CHIP R 10K J 1/10W	
R111			RK73GB2A221J	CHIP R 220 J 1/10W		R280			RK73EB2E100J	CHIP R 10 J 1/4W	
R112-119			RK73GH2A103D	CHIP R 10K D 1/10W		R282			RK73GB2A103J	CHIP R 10K J 1/10W	
R120,121			RK73GB2A2R2J	CHIP R 2.2 J 1/10W		R284			RK73GB2A103J	CHIP R 10K J 1/10W	
R122			RK73GB2A221J	CHIP R 220 J 1/10W		R285			RK73GB2A223J	CHIP R 22K J 1/10W	
R132,133			RK73GB2A152J	CHIP R 1.5K J 1/10W		R286			RK73GB2A472J	CHIP R 4.7K J 1/10W	
R134,135			RK73GB2A472J	CHIP R 4.7K J 1/10W		R287			RK73GB2A223J	CHIP R 22K J 1/10W	
R136,137			RK73GB2A103J	CHIP R 10K J 1/10W		R288			RK73GB2A102J	CHIP R 1.0K J 1/10W	
R138,139			RK73GB2A472J	CHIP R 4.7K J 1/10W		R289,290			RK73GB2A101J	CHIP R 100 J 1/10W	
R140,141			RK73GB2A393J	CHIP R 39K J 1/10W		R406			RK73EB2E222J	CHIP R 2.2K J 1/4W	
R142,143			RK73GB2A303J	CHIP R 30K J 1/10W		R603			RK73GB2A102J	CHIP R 1.0K J 1/10W	
R149,150			RK73GB2A153J	CHIP R 15K J 1/10W		R604			RK73GB2A103J	CHIP R 10K J 1/10W	
R151,152			RK73GB2A331J	CHIP R 330 J 1/10W		R605			RK73GB2A333J	CHIP R 33K J 1/10W	
R155			R92-0205-05	METAL-PLATE 0.1 K 2W		R606			RK73GB2A103J	CHIP R 10K J 1/10W	
R157,158			RK73GB2A331J	CHIP R 330 J 1/10W		R607			RK73GB2A472J	CHIP R 4.7K J 1/10W	
R159,160			RK73GB2A302J	CHIP R 3.0K J 1/10W		R608			RK73EB2E103J	CHIP R 10K J 1/4W	
R161,162			RD14BB2C223J	RD 22K J 1/6W		R609			RK73GB2A333J	CHIP R 33K J 1/10W	
R163,164			RK73GB2A223J	CHIP R 22K J 1/10W		R610			RK73GB2A303J	CHIP R 30K J 1/10W	
R165,166			RK73GB2A473J	CHIP R 47K J 1/10W		R611,612			RK73GB2A362J	CHIP R 3.6K J 1/10W	
R167,168			RK73EB2E221J	CHIP R 220 J 1/4W		R613			RK73GB2A152J	CHIP R 1.5K J 1/10W	
R169			RD14BB2C103J	RD 10K J 1/6W		R614			RK73GB2A332J	CHIP R 3.3K J 1/10W	
R170			RD14BB2C223J	RD 22K J 1/6W		R615			RK73GB2A392J	CHIP R 3.9K J 1/10W	
R171			RD14BB2C103J	RD 10K J 1/6W		R616			RD14BB2C392J	RD 3.9K J 1/6W	
R179			RD14BB2C100J	RD 10 J 1/6W		R617			RK73GB2A123J	CHIP R 12K J 1/10W	
R201,202			RD14BB2C103J	RD 10K J 1/6W		R618			RK73GB2A332J	CHIP R 3.3K J 1/10W	
R203,204			RK73GB2A223J	CHIP R 22K J 1/10W		R619			RK73EB2E4R7J	CHIP R 4.7 J 1/4W	
R205-208			RK73GB2A152J	CHIP R 1.5K J 1/10W		R620,621			RK73GB2A473J	CHIP R 47K J 1/10W	
R209,210			RK73GB2A101J	CHIP R 100 J 1/10W		R622,623			RK73GB2A103J	CHIP R 10K J 1/10W	

(North America)

△ Indicates safety critical components.

PARTS LIST

AUDIO UNIT (X09-8570-10)

Ref. No.	A d d	N e w	Parts No.	Description	Desti- nation
R624			RK73GB2A332J	CHIP R 3.3K J 1/10W	
R625			RK73GB2A223J	CHIP R 22K J 1/10W	
R626			RK73GB2A681J	CHIP R 680 J 1/10W	
R627			RK73GB2A102J	CHIP R 1.0K J 1/10W	
R628			RK73GB2A332J	CHIP R 3.3K J 1/10W	
R629			RK73GB2A103J	CHIP R 10K J 1/10W	
R630			RK73GB2A473J	CHIP R 47K J 1/10W	
R631,632			RK73GB2A123J	CHIP R 12K J 1/10W	
R633			RK73GB2A622J	CHIP R 6.2K J 1/10W	
R634			RK73GB2A222J	CHIP R 2.2K J 1/10W	
R635			RK73GB2A103J	CHIP R 10K J 1/10W	
R636			RK73GB2A104J	CHIP R 100K J 1/10W	
R637			RK73GB2A154J	CHIP R 150K J 1/10W	
R638			RK73GB2A332J	CHIP R 3.3K J 1/10W	
R639			RK73GB2A103J	CHIP R 10K J 1/10W	
R643			RK73GB2A224J	CHIP R 220K J 1/10W	
R646			RK73GB2A272J	CHIP R 2.7K J 1/10W	
R647			RK73GB2A224J	CHIP R 220K J 1/10W	
R648			RK73GB2A472J	CHIP R 4.7K J 1/10W	
R649			RK73GB2A182J	CHIP R 1.8K J 1/10W	
R650			RK73GB2A104J	CHIP R 100K J 1/10W	
R651			RK73GB2A472J	CHIP R 4.7K J 1/10W	
R652,653			RK73GB2A332J	CHIP R 3.3K J 1/10W	
R656			RK73GB2A472J	CHIP R 4.7K J 1/10W	
R657			RK73GB2A103J	CHIP R 10K J 1/10W	
R658			RK73GB2A513J	CHIP R 51K J 1/10W	
R659			RK73GB2A562J	CHIP R 5.6K J 1/10W	
R660,661			RK73GB2A473J	CHIP R 47K J 1/10W	
R662,663			RK73GB2A103J	CHIP R 10K J 1/10W	
R664			RK73GB2A473J	CHIP R 47K J 1/10W	
R665,666			RK73GB2A682J	CHIP R 6.8K J 1/10W	
R667,668			RK73GB2A470J	CHIP R 47 J 1/10W	
R669			RK73GB2A332J	CHIP R 3.3K J 1/10W	
R901			RD14BB2C102J	RD 1.0K J 1/6W	
VR1-4			R32-0340-05	SEMI FIXED VARIABLE RESISTOR	
W301-303			R92-1252-05	CHIP R 0 OHM J 1/16W	
W304-307			R92-2053-05	CHIP R 0 OHM J 1/8W	
W308			R92-1252-05	CHIP R 0 OHM J 1/16W	
W309,310			R92-2053-05	CHIP R 0 OHM J 1/8W	
W311-316			R92-1252-05	CHIP R 0 OHM J 1/16W	
W317			R92-2053-05	CHIP R 0 OHM J 1/8W	
W318-324			R92-1252-05	CHIP R 0 OHM J 1/16W	
W325,326			R92-2053-05	CHIP R 0 OHM J 1/8W	
W327-339			R92-1252-05	CHIP R 0 OHM J 1/16W	
W340,341			R92-2053-05	CHIP R 0 OHM J 1/8W	
W342-345			R92-1252-05	CHIP R 0 OHM J 1/16W	
W346			R92-2053-05	CHIP R 0 OHM J 1/8W	
W347-350			R92-1252-05	CHIP R 0 OHM J 1/16W	
W351			R92-2053-05	CHIP R 0 OHM J 1/8W	
W352			R92-1252-05	CHIP R 0 OHM J 1/16W	
D1			RM4ZLF-J4NF	DIODE	
D2			1SS133	DIODE	
D3			UDZS5.1B	ZENER DIODE	
D4			1SS133	DIODE	
D5			FCH10A20	DIODE	

Ref. No.	A d d	N e w	Parts No.	Description	Desti- nation
D6			FRH10A20	DIODE	
D7-9			1SS133	DIODE	
D10			LM1MA142WK-G	DIODE	
D11			RM4ZLF-J4NF	DIODE	
D101			LM1MA142WK-G	DIODE	
D102			LM1MA142WA-G	DIODE	
D103			UMZ6.8N	ZENER DIODE	
D108			1SS133	DIODE	
D109			UDZS5.1B	ZENER DIODE	
D152			1SS133	DIODE	
D201			UDZS5.1B	ZENER DIODE	
D202-210			1SS133	DIODE	
D229			LM1MA142WA-G	DIODE	
D251			1SS133	DIODE	
D253			LM1MA142WK-G	DIODE	
D254			LM1MA142WA-G	DIODE	
D255			LM1MA142WK-G	DIODE	
D260,261			1SS133	DIODE	
D262			LM1MA142WA-G	DIODE	
D295			LM1MA142WA-G	DIODE	
D601-603			1SS133	DIODE	
D604			UDZS10B	ZENER DIODE	
D605			1SS133	DIODE	
D606			UDZS15B	ZENER DIODE	
D607			UDZS6.8B	ZENER DIODE	
D608			UDZS12B	ZENER DIODE	
D610-613			1SS133	DIODE	
D614			UDZS10B	ZENER DIODE	
D615-618			1SS133	DIODE	
IC5			TL494IDR	ANALOGUE IC	
IC6,7			BA4560RF	ANALOGUE IC	
IC8,9			NJM2172V-ZBTE2	ANALOGUE IC	
IC12,13			BA4560RF	ANALOGUE IC	
IC15,16			BA4560RF	ANALOGUE IC	
Q1			2SD2012-F	TRANSISTOR	
Q2			2SB1375-F	TRANSISTOR	
Q3-8			STP60NF06FP	FET	
Q9			2SC4097	TRANSISTOR	
Q10,11			2SA1577	TRANSISTOR	
Q12			2SC4097	TRANSISTOR	
Q13,14			DTA114EUA	DIGITAL TRANSISTOR	
Q15,16			2SC4081	TRANSISTOR	
Q17			2SA1576A	TRANSISTOR	
Q18			2SK246 (BL) -F	FET	
Q201-204			2SA992-A (F,E)	TRANSISTOR	
Q205-208			2SC3478AA (L,K)	TRANSISTOR	
Q209,210			2SA1376AA (L,K)	TRANSISTOR	
Q215,216			2SC1845-A (F,E)	TRANSISTOR	
Q217,218			2SA992-A (F,E)	TRANSISTOR	
Q219			2SA1576A	TRANSISTOR	
Q220			TRAIT9N	TRANSISTOR	
Q222			TRAIT9P	TRANSISTOR	
Q223,224			TRAIT9N	TRANSISTOR	
Q225,226			TRAIT9P	TRANSISTOR	
Q227			TRAIT9N	TRANSISTOR	

(North America)

△ Indicates safety critical components.

PARTS LIST

AUDIO UNIT (X09-8570-10)

Ref. No.	A d d	N e w	Parts No.	Description	Desti- nation	Ref. No.	A d d	N e w	Parts No.	Description	Desti- nation
Q229			TRAIT9P	TRANSISTOR							
Q241,242			2SC4081	TRANSISTOR							
Q243,244			2SA1576A	TRANSISTOR							
Q281-284			2SC4081	TRANSISTOR							
Q601			2SC1845-A (F,E)	TRANSISTOR							
Q602			2SC4081	TRANSISTOR							
Q603			2SA1576A	TRANSISTOR							
Q604			2SB1241	TRANSISTOR							
Q605,606			2SC4081	TRANSISTOR							
Q609			2SD1863	TRANSISTOR							
Q610			2SC1845-A (F,E)	TRANSISTOR							
Q611-613			2SC945AA (Q,P)	TRANSISTOR							
Q614,615			2SA1576A	TRANSISTOR							
Q616			2SC4081	TRANSISTOR							
Q617			2SA1576A	TRANSISTOR							
Q618			2SC4081	TRANSISTOR							
Q621			DTA114EUA	DIGITAL TRANSISTOR							
Q622			DTC114EUA	DIGITAL TRANSISTOR							
TH601,602			NCP18XH103J0S	THERMISTOR							
TH605			NCP18XH103J0S	THERMISTOR							

(North America)

△ Indicates safety critical components.