

KAC-8105D/8105DM

EXPLODED VIEW

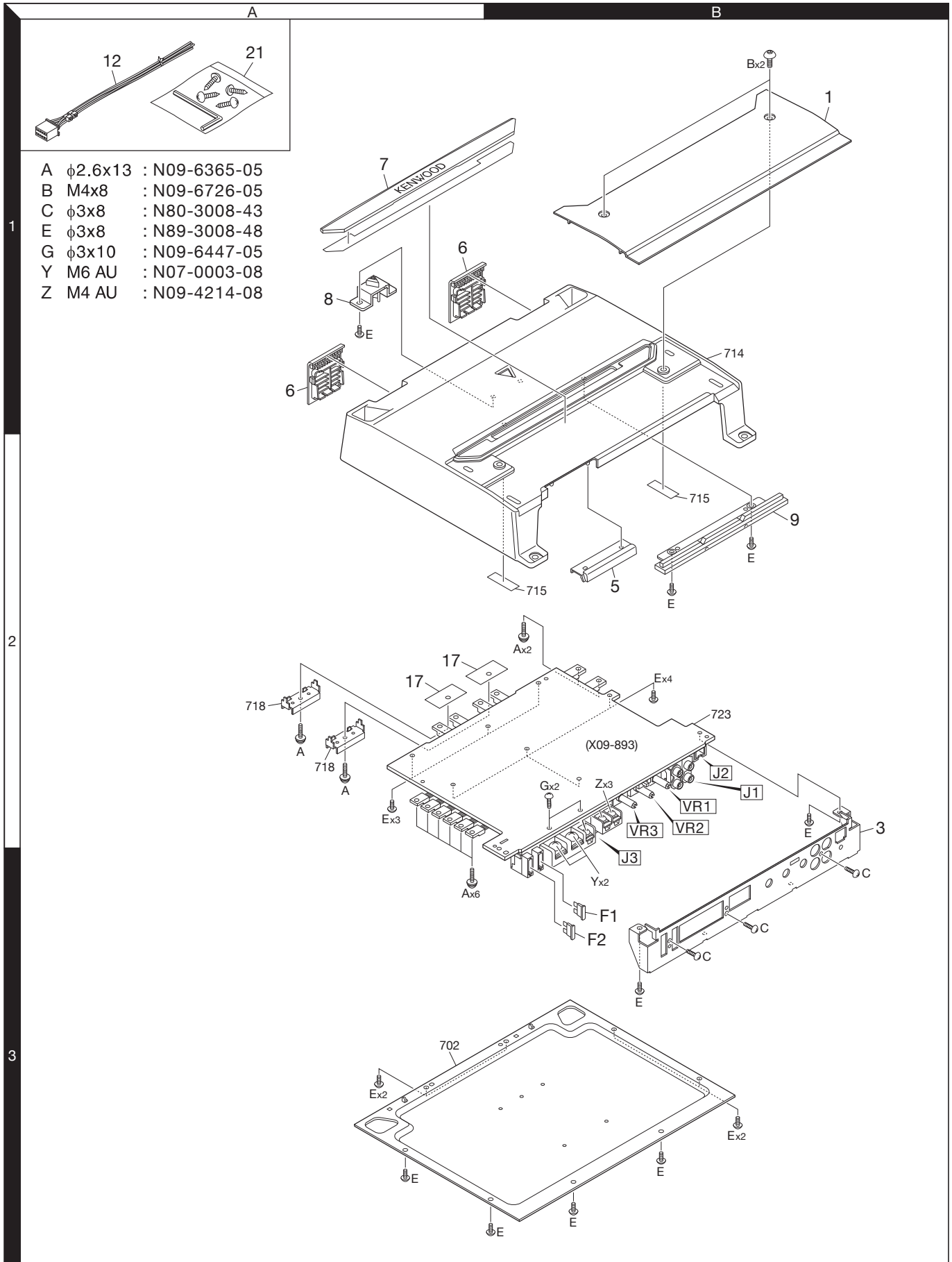

- A $\phi 2.6 \times 13$: N09-6365-05
- B M4x8 : N09-6726-05
- C $\phi 3 \times 8$: N80-3008-43
- E $\phi 3 \times 8$: N89-3008-48
- G $\phi 3 \times 10$: N09-6447-05
- Y M6 AU : N07-0003-08
- Z M4 AU : N09-4214-08

Parts with the exploded numbers larger than 700 are not supplied.

KAC-8105D/8105DM

PARTS LIST

* New parts

Parts without **Parts No.** are not supplied.

Les articles non mentionnés dans le **Parts No.** ne sont pas fournis.

Teile ohne **Parts No.** werden nicht geliefert.

Ref. No.	Ad	New	Parts No.	Description	Destination
KAC-8105D/8105DM					
1	1B	*	A21-6750-01	DRESSING PANEL	K
1	1B	*	A21-6751-01	DRESSING PANEL	M1M2
3	2B	*	A64-5023-12	PANEL	
5	2B	*	B07-3337-03	ESCUTCHEON	
6	1A	*	B07-3336-02	ESCUTCHEON	
7	1A	*	B10-5344-02	FRONT GLASS	
8	1A	*	B19-2324-03	LIGHTING BOARD	
9	2B	*	B19-2556-13	LIGHTING BOARD	
-		*	B64-4570-00	INSTRUCTION MANUA (ENG.FRE.SPA)	K
-		*	B64-4571-00	INSTRUCTION MANUAL (ENG.S-CHI)	M1M2
12	1A		E30-6145-05	CONNECTING CORD ASSY	
17	2A	*	F20-2518-04	INSULATING SHEET	
F1,2	3B		F52-0045-05	FUSE (BLADE TYPE) 30A	
-		*	H54-4807-03	ITEM CARTON CASE	K
-		*	H54-4808-03	ITEM CARTON CASE	M1
-		*	H54-4809-03	ITEM CARTON CASE	M2
21	1A		N99-1820-05	SCREW & WRENCH KEY SET	
A	2A		N09-6365-05	SEMS (2.6X13)	
B	1B		N09-6726-05	DRESSED SCREW (M4X8)	
C	3B		N80-3010-43	BINDING HEAD TAPTITE SCREW	
E	3B		N89-3008-48	BINDING HEAD TAPTITE SCREW	
Y	2B		N07-0003-08	TERMINAL SCREW (M6 AU)	
Z	2B		N09-4214-08	TERMINAL SCREW (M4 AU)	
AUDIO UNIT (X09-8930-10)					
D3		*	B30-3220-05	LED (ORG-630NM,80MCD)	
D14			B30-1770-05	LED (BLUE)	
D16			B30-1770-05	LED (BLUE)	
C1			CD04AU1H100M	NP-ELEC 10UF 50WV	
C2 ,3			CD04BN1H100M	ELECTRO 10UF 50WV	
C4			CK73GB1H103K	CHIP C 0.010UF K	
C5			CD04BN1H100M	ELECTRO 10UF 50WV	
C6			CK73GB1H103K	CHIP C 0.010UF K	
C7			CC73GCH1H101J	CHIP C 100PF J	
C8			CK73EB1E105K	CHIP C 1.0UF K	
C10			CK73GB1H104K	CHIP C 0.10UF K	
C11			CD04AU1H2R2M	NP-ELEC 2.2UF 50WV	
C12 ,13			CK73GB1H104K	CHIP C 0.10UF K	
C14			CD04BN1H470M	ELECTRO 47UF 50WV	
C15			CK73GB1H103K	CHIP C 0.010UF K	
C16			CK73GB1H102K	CHIP C 1000PF K	
C17 ,18		*	C90-6936-05	ELECTRO 3900UF 16WV	
C19			CK73GB1H682K	CHIP C 6800PF K	
C20 -23			CK73GB1H222K	CHIP C 2200PF K	
C24			CD04BN1H470M	ELECTRO 47UF 50WV	
C25 ,26		*	C90-6935-05	ELECTRO 1500UF 100WV	
C31 ,32			CD04BN1H470M	ELECTRO 47UF 50WV	
C35 ,36			CD04BN1H470M	ELECTRO 47UF 50WV	
C40			CK73GB1A105K	CHIP C 1.0UF K	
C42			CK73GB1H102K	CHIP C 1000PF K	
C50			CK73GB1H102K	CHIP C 1000PF K	

Ref. No.	Ad	New	Parts No.	Description	Destination
C51 ,52			CD04BN1H100M	ELECTRO 10UF 50WV	
C53			CK73GB1H103K	CHIP C 0.010UF K	
C100			CK73GB1H223K	CHIP C 0.022UF K	
C101,102			CK73GB1H102K	CHIP C 1000PF K	
C103-108			CD04BN1H100M	ELECTRO 10UF 50WV	
C109			CC73GCH1H330J	CHIP C 33PF J	
C110			CC73GCH1H470J	CHIP C 47PF J	
C111,112			CC73GCH1H101J	CHIP C 100PF J	
C113			CC73GCH1H330J	CHIP C 33PF J	
C114,115			CK73GB1H103K	CHIP C 0.010UF K	
C116			CK73GB1H223K	CHIP C 0.022UF K	
C117			CK73GB1H103K	CHIP C 0.010UF K	
C118,119			CK73GB1H223K	CHIP C 0.022UF K	
C121			CD04BN1H100M	ELECTRO 10UF 50WV	
C151			CD04BN1H010M	ELECTRO 1UF 50WV	
C152			CK73GB1H104K	CHIP C 0.10UF K	
C154			CC73GCH1H470J	CHIP C 47PF J	
C155			CK73GB1H332K	CHIP C 3300PF K	
C156			CK73GB1H102K	CHIP C 1000PF K	
C181			CD04BN1H470M	ELECTRO 47UF 50WV	
C182			CC73GCH1H560J	CHIP C 56PF J	
C183			CC73GCH1H470J	CHIP C 47PF J	
C184			CK73GB1H682K	CHIP C 6800PF K	
C195			C91-2295-05	MET P-F C 1500PF K	
C197-199			C91-2290-05	MET P-F C 4.7UF	
C200			CD04BN1H100M	ELECTRO 10UF 50WV	
C201,202			CD04BN1H010M	ELECTRO 1UF 50WV	
C205		*	CD04BN1H2R2M	ELECTRO 2.2UF 50WV	
C207,208			CK73GB1E154K	CHIP C 0.15UF K	
C209			CK73GB1H683K	CHIP C 0.068UF K	
C210			CK73GB1H103K	CHIP C 0.010UF K	
C211			CK73GB1H223K	CHIP C 0.022UF K	
C212			CK73GB1H683K	CHIP C 0.068UF K	
C213-215			CK73GB1H103K	CHIP C 0.010UF K	
C216			CK73GB1H333K	CHIP C 0.033UF K	
C217,218			CK73GB1H103K	CHIP C 0.010UF K	
C220			CK73GB1H104K	CHIP C 0.10UF K	
C221		*	CD04BN1H4R7M	ELECTRO 4.7UF 50WV	
C224			CC73GCH1H101J	CHIP C 100PF J	
C303			CC73GCH1H331J	CHIP C 330PF J	
C304-306			CK73GB1H103K	CHIP C 0.010UF K	
C401			C91-2292-05	MET P-F C 0.047UF	
C402-404			CD04BN1H470M	ELECTRO 47UF 50WV	
C511,512			CK73GB1H103K	CHIP C 0.010UF K	
C513			CD04BN1H010M	ELECTRO 1UF 50WV	
C541			CD04BJ1H220M	ELECTRO 22UF 50WV	
C600			CC73GCH1H151J	CHIP C 150PF J	
C602			CK73FB1C684K	CHIP C 0.68UF K	
C603			CK73GB1H103K	CHIP C 0.010UF K	
C604			CD04BN1H100M	ELECTRO 10UF 50WV	
C607			CD04BN1H100M	ELECTRO 10UF 50WV	
C608			CK73GB1H103K	CHIP C 0.010UF K	
C609			CK73GB1H333K	CHIP C 0.033UF K	
C610,611			CC73GCH1H471J	CHIP C 470PF J	
C612			CK73GB1H104K	CHIP C 0.10UF K	

K: KAC-8105D (North America)

M1: KAC-8105D M2: KAC-8105DM (Other Areas)

△ Indicates safety critical components.

PARTS LIST

AUDIO UNIT (X09-8930-10)

Ref. No.	Add	New	Parts No.	Description	Destination	Ref. No.	Add	New	Parts No.	Description	Destination
C613		*	CD04BN1C101M	ELECTRO 100UF 16WV		R37,38			RK73GB2A152J	CHIP R 1.5K J 1/10W	
C614,615			CK73GB1H103K	CHIP C 0.010UF K		R39,40			RK73GB2A560J	CHIP R 56 J 1/10W	
C616			CK73GB1H333K	CHIP C 0.033UF K		R41,42			RK73GB2A180J	CHIP R 18 J 1/10W	
C617			CK73GB1H103K	CHIP C 0.010UF K		R43,44			RK73GB2A472J	CHIP R 4.7K J 1/10W	
C618			CK73GB1H104K	CHIP C 0.10UF K		R45			RD14DB2H100J	SMALL-RD 10 J 1/2W	
C619			CK73GB1H332K	CHIP C 3300PF K		R46,47			RD14DB2H220J	SMALL-RD 22 J 1/2W	
C621			CK73GB1H332K	CHIP C 3300PF K		R48,49			RK73EB2E473J	CHIP R 47K J 1/4W	
C622			CD04BN1H470M	ELECTRO 47UF 50WV		R50			RK73GB2A2R2J	CHIP R 2.2 J 1/10W	
C623			CK73GB1H333K	CHIP C 0.033UF K		R51			RK73EB2E222J	CHIP R 2.2K J 1/4W	
C624			CK73GB1H223K	CHIP C 0.022UF K		R52			RD14BB2C303J	RD 30K J 1/6W	
C630,631			CK73GB1H103K	CHIP C 0.010UF K		R53			RK73EB2E100J	CHIP R 10 J 1/4W	
C635,636			CK73GB1H103K	CHIP C 0.010UF K		R54,55			RK73GB2A103J	CHIP R 10K J 1/10W	
C661			CK73GB1H102K	CHIP C 1000PF K		R56			RK73GB2A472J	CHIP R 4.7K J 1/10W	
C662			CK73GB1C224K	CHIP C 0.22UF K		R57			RD14BB2C303J	RD 30K J 1/6W	
C670			CC73GCH1H151J	CHIP C 150PF J		R58			RK73EB2E100J	CHIP R 10 J 1/4W	
J1			E63-0967-05	PIN JACK		R59			RK73GB2A104J	CHIP R 100K J 1/10W	
J2			E58-1120-05	RECTANGULAR RECEPTACLE		R61			RD14BB2C100J	RD 10 J 1/6W	
J3		*	E70-0865-05	SCREW TERMINAL BOARD		R64			RK73GB2A821J	CHIP R 820 J 1/10W	
L1		*	L33-2596-05	CHOKE COIL		R65			RK73GB2A472J	CHIP R 4.7K J 1/10W	
L2		*	L33-2458-15	CHOKE COIL		R66			RD14BB2C103J	RD 10K J 1/6W	
L3			L19-0779-05	TRANSFORMER FOR CONVERTER		R67			RK73GB2A153J	CHIP R 15K J 1/10W	
G	2B		N09-6447-05	TAPTITE SCREW (3X10 PT)		R73			RK73GB2A222J	CHIP R 2.2K J 1/10W	
R1			RD14BB2C392J	RD 3.9K J 1/6W		R74			RK73EB2E152J	CHIP R 1.5K J 1/4W	
R2			RK73GB2A682J	CHIP R 6.8K J 1/10W		R100			RK73GB2A562J	CHIP R 5.6K J 1/10W	
R3			RK73GB2A392J	CHIP R 3.9K J 1/10W		R101,102			RD14BB2C102J	RD 1.0K J 1/6W	
R4			RK73GB2A152J	CHIP R 1.5K J 1/10W		R103,104			RK73GB2A103J	CHIP R 10K J 1/10W	
R5			RK73GB2A103J	CHIP R 10K J 1/10W		R105,106			RK73GB2A273J	CHIP R 27K J 1/10W	
R6			RK73GB2A472J	CHIP R 4.7K J 1/10W		R107,108			RD14BB2C222J	RD 2.2K J 1/6W	
R7			RK73GB2A333J	CHIP R 33K J 1/10W		R109-112			RD14BB2C473J	RD 47K J 1/6W	
R8			RK73GB2A472J	CHIP R 4.7K J 1/10W		R113			RK73GB2A102J	CHIP R 1.0K J 1/10W	
R9			RD14BB2C333J	RD 33K J 1/6W		R114			RK73GB2A153J	CHIP R 15K J 1/10W	
R10			RK73EB2E223J	CHIP R 22K J 1/4W		R115			RK73GB2A103J	CHIP R 10K J 1/10W	
R11			RK73GB2A333J	CHIP R 33K J 1/10W		R116			RK73GB2A333J	CHIP R 33K J 1/10W	
R12			RK73GB2A753J	CHIP R 75K J 1/10W		R117			RK73GH2A103D	CHIP R 10K D 1/10W	
R13			RK73EB2E101J	CHIP R 100 J 1/4W		R119,120			RK73GH2A103D	CHIP R 10K D 1/10W	
R14			RK73GB2A103J	CHIP R 10K J 1/10W		R121,122			RK73GB2A753J	CHIP R 75K J 1/10W	
R15			RK73GB2A273J	CHIP R 27K J 1/10W		R123			RK73GH2A103D	CHIP R 10K D 1/10W	
R16			RK73GB2A823J	CHIP R 82K J 1/10W		R151			RK73GB2A392J	CHIP R 3.9K J 1/10W	
R17			RK73GB2A102J	CHIP R 1.0K J 1/10W		R152			RK73GB2A103J	CHIP R 10K J 1/10W	
R18			RK73GB2A684J	CHIP R 680K J 1/10W		R153			RK73GB2A202J	CHIP R 2.0K J 1/10W	
R19			RK73GB2A682J	CHIP R 6.8K J 1/10W		R154			RK73GB2A333J	CHIP R 33K J 1/10W	
R20			RK73GB2A103J	CHIP R 10K J 1/10W		R155			RK73GB2A102J	CHIP R 1.0K J 1/10W	
R21			RK73GB2A203J	CHIP R 20K J 1/10W		R156			RK73GB2A471J	CHIP R 470 J 1/10W	
R22			RK73GB2A682J	CHIP R 6.8K J 1/10W		R157			RK73GB2A102J	CHIP R 1.0K J 1/10W	
R23			RK73GB2A154J	CHIP R 150K J 1/10W		R158			RK73GB2A684J	CHIP R 680K J 1/10W	
R24			RK73GB2A103J	CHIP R 10K J 1/10W		R159			RK73GB2A103J	CHIP R 10K J 1/10W	
R25			RK73GB2A113J	CHIP R 11K J 1/10W		R160			RK73GB2A683J	CHIP R 68K J 1/10W	
R26			RK73GB2A621J	CHIP R 620 J 1/10W		R161			RD14BB2C123J	RD 12K J 1/6W	
R27			RK73GB2A103J	CHIP R 10K J 1/10W		R162			RK73GB2A103J	CHIP R 10K J 1/10W	
R28			RK73GB2A361J	CHIP R 360 J 1/10W		R163			RD14BB2C123J	RD 12K J 1/6W	
R29			RK73GB2A103J	CHIP R 10K J 1/10W		R164			RK73GB2A102J	CHIP R 1.0K J 1/10W	
R30 -33			RK73GB2A100J	CHIP R 10 J 1/10W		R181			RK73EB2E681J	CHIP R 680 J 1/4W	
R36			RK73GB2A2R2J	CHIP R 2.2 J 1/10W		R182			RK73GB2A112J	CHIP R 1.1K J 1/10W	
						R183,184			RK73GB2A103J	CHIP R 10K J 1/10W	
						R203			RS14KB3D4R7JP	FL-PROOF RS 4.7 J 2W	

K: KAC-8105D (North America)

M1: KAC-8105D M2: KAC-8105DM (Other Areas)

△ Indicates safety critical components.

KAC-8105D/8105DM

PARTS LIST

AUDIO UNIT (X09-8930-10)

Ref. No.	A d d	N e w	Parts No.	Description	Desti- nation
R204			RK73GB2A473J	CHIP R 47K J 1/10W	
R205			RK73GB2A303J	CHIP R 30K J 1/10W	
R206			RK73GB2A103J	CHIP R 10K J 1/10W	
R207			RK73GB2A332J	CHIP R 3.3K J 1/10W	
R208			RD14BB2C154J	RD 150K J 1/6W	
R209			RK73GB2A183J	CHIP R 18K J 1/10W	
R211			RK73GB2A392J	CHIP R 3.9K J 1/10W	
R213			RK73GB2A682J	CHIP R 6.8K J 1/10W	
R214			RK73GB2A243J	CHIP R 24K J 1/10W	
R216			RK73GB2A473J	CHIP R 47K J 1/10W	
R217			RK73GB2A431J	CHIP R 430 J 1/10W	
R218			RK73GB2A102J	CHIP R 1.0K J 1/10W	
R219			RK73GB2A153J	CHIP R 15K J 1/10W	
R220			RK73GB2A332J	CHIP R 3.3K J 1/10W	
R221			RK73GB2A153J	CHIP R 15K J 1/10W	
R222			RD14BB2C222J	RD 2.2K J 1/6W	
R223			RK73GB2A153J	CHIP R 15K J 1/10W	
R224			RK73GB2A123J	CHIP R 12K J 1/10W	
R225			RK73GB2A153J	CHIP R 15K J 1/10W	
R226			RK73GB2A222J	CHIP R 2.2K J 1/10W	
R230			RD14BB2C154J	RD 150K J 1/6W	
R231			RK73GB2A241J	CHIP R 240 J 1/10W	
R233			RD14BB2C222J	RD 2.2K J 1/6W	
R234			RK73GB2A103J	CHIP R 10K J 1/10W	
R235			RK73GB2A222J	CHIP R 2.2K J 1/10W	
R301,302			RK73GB2A103J	CHIP R 10K J 1/10W	
R303			RK73GB2A682J	CHIP R 6.8K J 1/10W	
R304			RD14BB2C622J	RD 6.2K J 1/6W	
R305			RK73GB2A392J	CHIP R 3.9K J 1/10W	
R306			RK73GB2A622J	CHIP R 6.2K J 1/10W	
R307,308			RK73GB2A103J	CHIP R 10K J 1/10W	
R309			RK73GB2A911J	CHIP R 910 J 1/10W	
R400			RK73EB2E510J	CHIP R 51 J 1/4W	
R401,402			RK73GB2A103J	CHIP R 10K J 1/10W	
R403,404			RK73GB2A272J	CHIP R 2.7K J 1/10W	
R405,406			RK73GB2A182J	CHIP R 1.8K J 1/10W	
R407			RK73GB2A681J	CHIP R 680 J 1/10W	
R408			RK73GB2A911J	CHIP R 910 J 1/10W	
R409			RK73GB2A471J	CHIP R 470 J 1/10W	
R410			RK73GB2A751J	CHIP R 750 J 1/10W	
R411			RK73GB2A510J	CHIP R 51 J 1/10W	
R412			RK73EB2E151J	CHIP R 150 J 1/4W	
R413			RK73EB2E510J	CHIP R 51 J 1/4W	
R414			RK73EB2E101J	CHIP R 100 J 1/4W	
R415,416			RK73GB2A473J	CHIP R 47K J 1/10W	
R417			RK73EB2E181J	CHIP R 180 J 1/4W	
R418,419			RK73EB2E100J	CHIP R 10 J 1/4W	
R420			RK73EB2E101J	CHIP R 100 J 1/4W	
R421			RK73GB2A562J	CHIP R 5.6K J 1/10W	
R422			RK73GB2A563J	CHIP R 56K J 1/10W	
R423,424			RK73EB2E100J	CHIP R 10 J 1/4W	
R425,426		*	R92-5416-05	METAL P-R 0.02 5W	
R427,428			RK73EB2E820J	CHIP R 82 J 1/4W	
R440			RK73GB2A681J	CHIP R 680 J 1/10W	
R441			RK73GB2A202J	CHIP R 2.0K J 1/10W	

Ref. No.	A d d	N e w	Parts No.	Description	Desti- nation
R442			RD14BB2C202J	RD 2.0K J 1/6W	
R501			RK73GB2A100J	CHIP R 10 J 1/10W	
R502			RK73GB2A103J	CHIP R 10K J 1/10W	
R503			RK73GB2A223J	CHIP R 22K J 1/10W	
R504			RK73GB2A473J	CHIP R 47K J 1/10W	
R505			RK73GB2A471J	CHIP R 470 J 1/10W	
R506			RK73GB2A223J	CHIP R 22K J 1/10W	
R511,512			RD14BB2C101J	RD 100 J 1/6W	
R513			RK73GB2A470J	CHIP R 47 J 1/10W	
R514			RK73GB2A103J	CHIP R 10K J 1/10W	
R515			RK73GB2A470J	CHIP R 47 J 1/10W	
R516			RK73GB2A163J	CHIP R 16K J 1/10W	
R517			RK73GB2A272J	CHIP R 2.7K J 1/10W	
R518-520			RK73GB2A103J	CHIP R 10K J 1/10W	
R521			RK73GB2A272J	CHIP R 2.7K J 1/10W	
R522			RK73GB2A163J	CHIP R 16K J 1/10W	
R523			RK73GB2A103J	CHIP R 10K J 1/10W	
R525			RK73GB2A473J	CHIP R 47K J 1/10W	
R526			RK73GB2A103J	CHIP R 10K J 1/10W	
R531			RK73GB2A103J	CHIP R 10K J 1/10W	
R532			RK73GB2A104J	CHIP R 100K J 1/10W	
R535			RK73GB2A472J	CHIP R 4.7K J 1/10W	
R536			RK73GB2A153J	CHIP R 15K J 1/10W	
R537			RK73GB2A472J	CHIP R 4.7K J 1/10W	
R538			RK73GB2A683J	CHIP R 68K J 1/10W	
R540			RK73GB2A123J	CHIP R 12K J 1/10W	
R541			RK73EB2E103J	CHIP R 10K J 1/4W	
R542,543			RK73GB2A103J	CHIP R 10K J 1/10W	
R544			RK73GB2A680J	CHIP R 68 J 1/10W	
R600			RK73GB2A393J	CHIP R 39K J 1/10W	
R601			RK73GB2A222J	CHIP R 2.2K J 1/10W	
R602			RK73GB2A153J	CHIP R 15K J 1/10W	
R603			RK73GB2A472J	CHIP R 4.7K J 1/10W	
R604			RK73GB2A224J	CHIP R 220K J 1/10W	
R605			RK73GB2A103J	CHIP R 10K J 1/10W	
R606			RK73GB2A243J	CHIP R 24K J 1/10W	
R607			RK73GB2A104J	CHIP R 100K J 1/10W	
R608			RK73GB2A102J	CHIP R 1.0K J 1/10W	
R609			RK73GB2A203J	CHIP R 20K J 1/10W	
R610			RK73GB2A123J	CHIP R 12K J 1/10W	
R611,612			RK73GB2A103J	CHIP R 10K J 1/10W	
R613,614			RK73GB2A203J	CHIP R 20K J 1/10W	
R615			RK73GB2A272J	CHIP R 2.7K J 1/10W	
R616			RK73GB2A203J	CHIP R 20K J 1/10W	
R617			RK73GB2A104J	CHIP R 100K J 1/10W	
R619			RK73GB2A223J	CHIP R 22K J 1/10W	
R621			RK73GB2A103J	CHIP R 10K J 1/10W	
R622			RK73GB2A222J	CHIP R 2.2K J 1/10W	
R623			RK73GB2A472J	CHIP R 4.7K J 1/10W	
R624			RK73GB2A514J	CHIP R 510K J 1/10W	
R625			RK73GB2A222J	CHIP R 2.2K J 1/10W	
R626,627			RK73GB2A332J	CHIP R 3.3K J 1/10W	
R628			RK73GB2A102J	CHIP R 1.0K J 1/10W	
R631			RK73GB2A104J	CHIP R 100K J 1/10W	
R632			RK73GB2A473J	CHIP R 47K J 1/10W	

K: KAC-8105D (North America)

M1: KAC-8105D M2: KAC-8105DM (Other Areas)

△ Indicates safety critical components.

PARTS LIST

AUDIO UNIT (X09-8930-10)

Ref. No.	Add	New	Parts No.	Description	Destination	Ref. No.	Add	New	Parts No.	Description	Destination
R633			RK73GB2A392J	CHIP R 3.9K J 1/10W		D104			LM1MA142WA-G	DIODE	
R638			RK73GB2A222J	CHIP R 2.2K J 1/10W		D107			LM1MA142WK-G	DIODE	
R639			RK73GB2A823J	CHIP R 82K J 1/10W		D108			LM1MA142WA-G	DIODE	
R640,641			RK73GB2A223J	CHIP R 22K J 1/10W		D151			HSS4148	DIODE	
R642			RK73GB2A103J	CHIP R 10K J 1/10W		D181	*		RKZ5.1KG(B2)	ZENER DIODE	
R643			RK73GB2A222J	CHIP R 2.2K J 1/10W		D182,183			HSU119TRF-E	DIODE	
R644			RK73GB2A103J	CHIP R 10K J 1/10W		D186			HSU119TRF-E	DIODE	
R647			RK73GB2A472J	CHIP R 4.7K J 1/10W		D201	*		RKZ27KG(B)	ZENER DIODE	
R648			RK73GB2A104J	CHIP R 100K J 1/10W		D303			HSS4148	DIODE	
R649			RK73GB2A472J	CHIP R 4.7K J 1/10W		D304,305	*		RKZ5.6KG(B2)	ZENER DIODE	
R650			RK73GB2A103J	CHIP R 10K J 1/10W		D400			HSS4148	DIODE	
R651			RK73GB2A223J	CHIP R 22K J 1/10W		D403-406			HSS4148	DIODE	
R654			RK73GB2A203J	CHIP R 20K J 1/10W		D407	*		RKZ15KG(B2)	ZENER DIODE	
R655			RK73GB2A103J	CHIP R 10K J 1/10W		D511,512			HSS4148	DIODE	
R656,657			RK73GB2A102J	CHIP R 1.0K J 1/10W		D531			LM1MA142WK-G	DIODE	
R661,662			RK73GB2A103J	CHIP R 10K J 1/10W		D532			HSS4148	DIODE	
R663			RK73GB2A823J	CHIP R 82K J 1/10W		D541,542			HSS4148	DIODE	
R664			RK73GB2A153J	CHIP R 15K J 1/10W		D543			LM1MA142WK-G	DIODE	
R665			RK73GB2A103J	CHIP R 10K J 1/10W		D601-604			HSU119TRF-E	DIODE	
R667			RK73GB2A102J	CHIP R 1.0K J 1/10W		D605	*		RKZ10KG(B2)	ZENER DIODE	
R668,669			RK73GB2A103J	CHIP R 10K J 1/10W		D607,608	*		RKZ10KG(B2)	ZENER DIODE	
R670			RK73GB2A102J	CHIP R 1.0K J 1/10W		D609			HSU119TRF-E	DIODE	
R671			RK73GB2A684J	CHIP R 680K J 1/10W		D610			LM1MA142WA-G	DIODE	
R902			RK73EB2E152J	CHIP R 1.5K J 1/4W		D611			HSS4148	DIODE	
VR1			R31-0253-05	VARIABLE RESISTOR 10K, A		D612			MTZJ6.2(B)	ZENER DIODE	
VR2			R31-0255-05	VARIABLE RESISTOR 50K, C		D613			HSU119TRF-E	DIODE	
VR3			R31-0254-05	VARIABLE RESISTOR 10K, C		D661			HSU119TRF-E	DIODE	
W201			RK73EB2E000J	CHIP R 0.0 J 1/4W		IC1			TL494IDR	ANALOGUE IC	
W202			RK73GB2A000J	CHIP R 0.0 J 1/10W		IC11			BA4560RF	ANALOGUE IC	
W203,204			RK73EB2E000J	CHIP R 0.0 J 1/4W		IC12	*		TC74HC00AFN-F	MOS-IC	
W205-207			RK73GB2A000J	CHIP R 0.0 J 1/10W		IC13			74HC3GU04DP	MOS-IC	
W209			RK73GB2A000J	CHIP R 0.0 J 1/10W		IC14,15			BA4560RF	ANALOGUE IC	
W210,211			RK73EB2E000J	CHIP R 0.0 J 1/4W		IC18			BA4560RF	ANALOGUE IC	
W212			RK73GB2A000J	CHIP R 0.0 J 1/10W		IC31			BA2903F	ANALOGUE IC	
W214,215			RK73GB2A000J	CHIP R 0.0 J 1/10W		IC32			BA4560RF	ANALOGUE IC	
W216			RK73EB2E000J	CHIP R 0.0 J 1/4W		IC61			BA4560RF	ANALOGUE IC	
W217			RK73GB2A000J	CHIP R 0.0 J 1/10W		IC62,63			BA2903F	ANALOGUE IC	
S3			S31-2630-05	SLIDE SWITCH		IC64			BA4560RF	ANALOGUE IC	
D4			RKZ6.8KG(B2)	ZENER DIODE		Q1 ,2	*		2SC4154(F)	TRANSISTOR	
D5	*		RKZ15KG(B2)	ZENER DIODE		Q3			2SB1241	TRANSISTOR	
D6 ,7			HSS4148	DIODE		Q4	*		ISA1602AM1(F)	TRANSISTOR	
D8	*		RKZ10KG(B2)	ZENER DIODE		Q5 ,6	*		2SC4154(F)	TRANSISTOR	
D9 ,10			HSS4148	DIODE		Q8 ,9	*		2SC6120	TRANSISTOR	
D11			HSU119TRF-E	DIODE		Q10 ,11			2SA1577	TRANSISTOR	
D12 ,13			HSS4148	DIODE		Q12 ,13			STP60NF06FP	FET	
D17			LM1MA142WK-G	DIODE		Q19 ,20			STP60NF06FP	FET	
D18			FCH10A20	DIODE		Q25			KTC3200-P	TRANSISTOR	
D19			FRH10A20	DIODE		Q26			2SC4883ANF	TRANSISTOR	
D23	*		RKZ16KG(B2)	ZENER DIODE		Q28			2SA1859ANF	TRANSISTOR	
D25	*		RKZ16KG(B2)	ZENER DIODE		Q29 ,30	*		ISA1602AM1(F)	TRANSISTOR	
D51 -53			HSS4148	DIODE		Q37 ,38	*		RT1P141M-T111	TRANSISTOR	
D101	*		HZB6.8MWA	ZENER DIODE		Q42	*		KTA1268-P	TRANSISTOR	
D103			LM1MA142WK-G	DIODE		Q51	*		ISA1602AM1(F)	TRANSISTOR	
						Q52	*		2SC4154(F)	TRANSISTOR	
						Q151	*		2SC4154(F)	TRANSISTOR	

K: KAC-8105D (North America)

M1: KAC-8105D M2: KAC-8105DM (Other Areas)

△ Indicates safety critical components.

KAC-8105D/8105DM

PARTS LIST

AUDIO UNIT (X09-8930-10)

Ref. No.	A d d	N e w	Parts No.	Description	Desti- nation	Ref. No.	A d d	N e w	Parts No.	Description	Desti- nation
Q400		*	2SC4154(F)	TRANSISTOR							
Q401		*	ISA1602AM1(F)	TRANSISTOR							
Q402			2SA1689(E,F)	TRANSISTOR							
Q403		*	RT1P141M-T111	TRANSISTOR							
Q404			2SC4449(E,F)	TRANSISTOR							
Q405			2SA1370	TRANSISTOR							
Q406			2SC3902	TRANSISTOR							
Q407			2SB1427	TRANSISTOR							
Q408			2SC3415S	TRANSISTOR							
Q409			2SB1427	TRANSISTOR							
Q410-413			IRFB31N20DPBF	FET							
Q414			2SC3902	TRANSISTOR							
Q415			2SC3415S	TRANSISTOR							
Q416			2SD1863	TRANSISTOR							
Q417			2SA1689(E,F)	TRANSISTOR							
Q501		*	ISA1602AM1(F)	TRANSISTOR							
Q502,503		*	2SC4154(F)	TRANSISTOR							
Q504			DTA124EUA	DIGITAL TRANSISTOR							
Q511		*	2SC4154(F)	TRANSISTOR							
Q512-514		*	ISA1602AM1(F)	TRANSISTOR							
Q515		*	2SC4154(F)	TRANSISTOR							
Q531		*	ISA1602AM1(F)	TRANSISTOR							
Q534		*	ISA1602AM1(F)	TRANSISTOR							
Q535		*	2SC4154(F)	TRANSISTOR							
Q536		*	RT1N141M-T111	TRANSISTOR							
Q541		*	2SC4154(F)	TRANSISTOR							
Q600		*	ISA1602AM1(F)	TRANSISTOR							
Q601		*	2SC4154(F)	TRANSISTOR							
Q602		*	RT1P141M-T111	TRANSISTOR							
Q604		*	2SC4449(E,F)	TRANSISTOR							
Q605,606			2SA1689(E,F)	TRANSISTOR							
Q607			2SC4449(E,F)	TRANSISTOR							
Q608		*	ISA1602AM1(F)	TRANSISTOR							
Q609-611		*	2SC4154(F)	TRANSISTOR							
Q612		*	DTA124EUA	DIGITAL TRANSISTOR							
Q661,662		*	2SC4154(F)	TRANSISTOR							
TH1			NCP18XH103J0S	THERMISTOR							
TH532			NCP18WB473J0S	THERMISTOR							

K: KAC-8105D (North America)

M1: KAC-8105D M2: KAC-8105DM (Other Areas)

△ Indicates safety critical components.