

ELECTRICAL PARTS LIST

MAIN PWB(B1) section

REF No.	PART No.	DESCRIPTION	REF No.	PART No.	DESCRIPTION	REF No.	PART No.	DESCRIPTION
C101	168-2222-55	2200pF K	C348	046-1042-78	16V 0.1uF	C536	168-6822-55	6800pF K
C122	166-1201-50	12pF CH	C349	046-1042-78	16V 0.1uF	C537	168-6822-55	6800pF K
C128	045-2201-50	22pFJ CH	C350	046-1042-78	16V 0.1uF	C538	168-6822-55	6800pF K
C129	046-1022-58	50V 1000pF	C351	046-1042-78	16V 0.1uF	C539	168-6822-55	6800pF K
C130	046-1022-58	50V 1000pF	C352	043-0552-90	6.3V 47uF M	C540	168-6822-55	6800pF K
C131	045-3901-50	39pFJ CH	C353	043-0559-90	6.3V 22uF	C541	168-6822-55	6800pF K
C132	045-1211-50	120pFJ CH	C354	168-1052-78	16V 1uF K	C542	168-6822-55	6800pF K
C133	045-4796-50	4.7pFJ CH	C355	046-1042-78	16V 0.1uF	C543	168-1042-78	16V 0.1uF K
C134	045-1501-50	15pFJ CH	C356	046-1042-78	16V 0.1uF	C544	168-2232-55	0.022uF K
C135	045-2211-50	220pFJ CH	C357	046-1042-78	16V 0.1uF	C545	043-0604-90	25V 10uF B
C136	046-3922-58	3900pF K B	C358	045-2201-50	22pFJ CH	C546	046-1022-58	50V 1000pF
C137	046-1022-58	50V 1000pF	C360	046-1042-78	16V 0.1uF	C547	043-7503-90	4.7uF
C138	046-1032-78	16V 0.01uF	C361	046-1042-78	16V 0.1uF	C548	043-6400-90	16V 4.7uF K
C139	046-1032-78	16V 0.01uF	C362	046-1042-78	16V 0.1uF	C553	043-0603-90	16V 10uF
C141	046-3322-58	3300pF K B	C364	046-1042-78	16V 0.1uF	C554	043-0603-90	16V 10uF
C142	046-2232-78	0.022uF K B	C365	045-4711-50	470pFJ CH	C555	046-1042-78	16V 0.1uF
C143	046-1022-58	50V 1000pF	C366	046-1022-58	50V 1000pF	C556	043-0552-90	6.3V 47uF M
C144	046-2232-78	0.022uF K B	C367	046-1042-78	16V 0.1uF	C557	043-6400-90	16V 4.7uF K
C145	046-2232-78	0.022uF K B	C368	046-3322-58	3300pF K B	C558	043-0570-90	16V 2.2uF K
C146	046-2232-78	0.022uF K B	C369	046-3322-58	3300pF K B	C559	043-0570-90	16V 2.2uF K
C147	046-2232-78	0.022uF K B	C370	042-4033-90	6.3V 220uF	C562	046-1022-58	50V 1000pF
C148	043-0562-90	10V 0.22uF	C371	046-3322-58	3300pF K B	C564	168-4752-98	4.7uF K
C149	046-2232-78	0.022uF K B	C372	046-3322-58	3300pF K B	C565	043-0603-90	16V 10uF
C150	043-0563-90	16V 47uF	C373	046-1042-78	16V 0.1uF	C568	046-1022-58	50V 1000pF
C161	043-0604-90	25V 10uF B	C375	046-3322-58	3300pF K B	C569	043-7503-90	4.7uF
C162	046-1042-78	16V 0.1uF	C376	046-3322-58	3300pF K B	C570	043-6400-90	16V 4.7uF K
C202	046-2222-58	2200pF K B	C377	046-1522-58	1500pF K B	C571	043-0604-90	25V 10uF B
C203	046-1042-78	16V 0.1uF	C378	046-1522-58	1500pF K B	C572	043-7701-90	2.2uF
C204	046-2222-58	2200pF K B	C379	046-1522-58	1500pF K B	C574	045-4701-50	47pF CH
C206	165-3363-25	10V 33uF	C380	046-1522-58	1500pF K B	C575	168-4742-78	0.47uF K
C219	168-4722-55	4700pF K	C381	043-0559-90	6.3V 22uF	C576	168-1042-38	50V 0.1uF K
C220	168-1022-55	1000pF K	C382	178-1052-78	25V 1uF	C577	046-1522-58	1500pF K B
C221	168-1022-55	1000pF K	C383	178-1052-78	25V 1uF	C578	045-2201-50	22pFJ CH
C301	043-0570-90	16V 2.2uF K	C386	178-1052-78	25V 1uF	C579	178-2242-38	0.22uF B
C302	043-0570-90	16V 2.2uF K	C387	178-1052-78	25V 1uF	C580	042-4000-90	16V 470uF
C303	043-0570-90	16V 2.2uF K	C401	046-1042-78	16V 0.1uF	C581	165-4763-35	16V 47uF
C304	043-0570-90	16V 2.2uF K	C402	046-1042-78	16V 0.1uF	C601	165-1073-35	16V 100uF
C305	045-2201-50	22pFJ CH	C403	166-2201-50	22pF CH	C602	045-2201-50	22pFJ CH
C306	045-2201-50	22pFJ CH	C404	166-2201-50	22pF CH	C606	046-1042-78	16V 0.1uF
C309	046-1042-78	16V 0.1uF	C405	168-4722-55	4700pF K	C607	043-4306-90	1uF
C310	168-1052-78	16V 1uF K	C406	168-2242-58	0.22uF K	C620	043-6400-90	16V 4.7uF K
C312	046-1042-78	16V 0.1uF	C407	168-4752-98	4.7uF K	C621	043-7503-90	4.7uF
C314	045-2201-50	22pFJ CH	C408	004-1580-14	45pF	C622	043-4306-90	1uF
C315	045-2201-50	22pFJ CH	C410	046-1042-78	16V 0.1uF	C623	045-2201-50	22pFJ CH
C316	046-1042-78	16V 0.1uF	C411	165-4763-15	6.3V 47uF	C626	046-1022-58	50V 1000pF
C317	046-1042-78	16V 0.1uF	C412	045-2701-50	27pFJ CH	D104	001-9013-90	BA891
C318	046-1042-78	16V 0.1uF	C413	046-1042-78	16V 0.1uF	D105	001-0580-90	1SS352
C319	046-1042-78	16V 0.1uF	C414	046-1032-78	16V 0.01uF	D106	001-9013-90	BA891
C320	043-0570-90	16V 2.2uF K	C415	046-1022-58	50V 1000pF	D401	001-2630-90	1SS420-TPL3,F
C321	043-0570-90	16V 2.2uF K	C416	046-1022-58	50V 1000pF	D501	001-2412-90	RR264M-400
C322	168-4752-98	4.7uF K	C417	046-1022-58	50V 1000pF	D502	001-0580-90	1SS352
C323	168-4752-98	4.7uF K	C418	042-2273-25	10V 220uF M	D503	001-2412-90	RR264M-400
C324	046-1042-78	16V 0.1uF	C419	042-2273-25	10V 220uF M	D504	001-2412-90	RR264M-400
C325	046-1042-78	16V 0.1uF	C420	045-1011-50	100pFJ CH	D505	001-2639-90	RSX201L-30
C326	046-1042-78	16V 0.1uF	C517	168-1542-58	0.15uF K	D506	001-2628-90	RB160M-40
C327	046-1042-78	16V 0.1uF	C518	168-1542-58	0.15uF K	IC101	-----	TEF7000
C328	046-1042-78	16V 0.1uF	C519	168-1542-58	0.15uF K			(thermal pad type)
C329	045-1007-50	10 +/-0.5pF CH	C520	168-1542-58	0.15uF K			(402590-051)
C330	045-1007-50	10 +/-0.5pF CH	C521	168-1542-58	0.15uF K	IC301	051-3034-90	NJM4558V
C331	046-1042-78	16V 0.1uF	C522	168-1542-58	0.15uF K	IC302	-----	SAF7741HV/N125
C333	168-4752-98	4.7uF K	C523	168-1542-58	0.15uF K			(DSP)
C335	046-1042-78	16V 0.1uF	C524	168-1542-58	0.15uF K			(thermal pad type)
C336	046-1042-78	16V 0.1uF	C525	168-1052-78	16V 1uF K			(674700-051)
C337	046-1042-78	16V 0.1uF	C526	042-1760-90	16V 10uF M	IC303	051-7106-90	CD4052B-PWR
C338	042-4033-90	6.3V 220uF	C527	178-2742-78	0.27uF	IC401	-----	S-24C16CI-T8T5U3
C339	046-1042-78	16V 0.1uF	C528	168-1052-78	16V 1uF K			(E2P-ROM)
C340	168-4752-98	4.7uF K	C530	043-0574-90	25V 1.0uF			(Software should be
C341	045-2201-50	22pFJ CH	C532	168-1832-55	0.018uF K			written on production)
C342	046-1042-78	16V 0.1uF	C533	043-5600-90	0.10uF			(942650-051)
C345	046-1042-78	16V 0.1uF	C534	042-1717-00	16V 3300uF	IC402	-----	R5F64177PFB
C347	168-1052-78	16V 1uF K	C535	168-6822-55	6800pF K			(Micro computer)

REF No.	PART No.	DESCRIPTION	REF No.	PART No.	DESCRIPTION	REF No.	PART No.	DESCRIPTION
		(Software should be written on production) (033320-052)	Q510	125-2032-93	RN1303	R359	119-2201-15	1/10W 22 ohm
IC403	051-6647-80	TJA1051T,118	Q511	192-4081-00	2SC4081	R360	032-0150-54	1/16W 1k ohm F
IC404	051-5481-90	S-1009N30I-M5T1U	Q512	191-1197-50	2SB1197K Q,R	R361	032-0150-54	1/16W 1k ohm F
IC502	051-2067-00	TB2946HQ	Q513	125-2046-91	DTC114EUBTL	R362	032-0150-54	1/16W 1k ohm F
IC504	051-5443-08	BD4850G-TR	Q514	192-4116-51	2SC4116 G,L	R363	032-0150-54	1/16W 1k ohm F
IC505	051-3582-90	BD00C0AWFP	Q515	191-1197-50	2SB1197K Q,R	R364	033-3331-15	1/16W 33k ohm J
IC507	051-3034-90	NJM4558V	Q516	125-2046-91	DTC114EUBTL	R365	033-3331-15	1/16W 33k ohm J
IC508	051-3579-90	S1112B15MCL6ATF G	R102	119-0000-05	1/10W 0 ohm JW	R366	032-0150-51	1/16W 15k ohm F
IC509	051-3708-90	S-1112B33MC-L6STF G	R115	033-0000-05	1/16W 0 ohm	R367	032-0150-51	1/16W 15k ohm F
IC511	051-3582-90	BD00C0AWFP	R124	033-1811-15	1/16W 180 ohm J	R368	032-0150-51	1/16W 15k ohm F
IC513	051-3709-90	BD00D0AWHFP-TR	R125	033-3311-15	1/16W 330 ohm J	R369	032-0150-51	1/16W 15k ohm F
IC514	-----	LT3481EDD#TRPBF (SW-REGULATOR) (thermal pad type) (361280-051)	R126	033-4741-15	1/16W 470k ohm J	R405	033-0000-05	1/16W 0 ohm
IC601	051-3553-90	NJM2865F3-05	R127	033-1201-15	1/16W 12 ohm	R411	033-1011-15	1/16W 100 ohm J
IC604	051-3034-90	NJM4558V	R128	033-4741-15	1/16W 470k ohm J	R412	033-1011-15	1/16W 100 ohm J
IC605	051-3709-90	BD00D0AWHFP-TR	R129	033-5601-15	1/16W 56 ohm J	R413	119-4711-15	1/10W 470 ohm
J201	074-2260-88	38P	R134	033-2231-15	1/16W 22k ohm J	R414	119-4711-15	1/10W 470 ohm
J203	074-1302-16	16P	R135	033-3921-15	1/16W 3.9k ohm J	R415	119-4711-15	1/10W 470 ohm
J204	074-1302-08	8P	R136	033-0000-05	1/16W 0 ohm	R416	119-4711-15	1/10W 470 ohm
J501	074-4009-20	20P	R137	033-0000-05	1/16W 0 ohm	R418	033-1041-15	1/16W 100k ohm J
L110	010-3062-54	290nH	R138	033-0000-05	1/16W 0 ohm	R419	033-3311-15	1/16W 330 ohm J
L111	010-3406-56	3.3uH J	R139	033-0000-05	1/16W 0 ohm	R420	033-3311-15	1/16W 330 ohm J
L112	010-3062-56	0.5uH	R140	033-0000-05	1/16W 0 ohm	R421	033-1041-15	1/16W 100k ohm J
L113	010-3062-53	0.215uH	R143	033-0000-05	1/16W 0 ohm	R422	033-2221-15	1/16W 2.2k ohm J
L114	010-3439-51	1.8uH	R144	033-0000-05	1/16W 0 ohm	R423	033-2221-15	1/16W 2.2k ohm J
L115	010-2290-52	330uH	R146	116-1091-15	1/4W 1 ohm	R424	119-1031-15	1/10W 10k ohm
L116	010-2290-52	330uH	R147	116-1221-15	1/4W 1.2k ohm	R425	119-1031-15	1/10W 10k ohm
L117	010-3104-54	600 ohm/100MHz	R151	033-1031-15	1/16W 10k ohm J	R426	119-1031-15	1/10W 10k ohm
L301	010-3104-54	600 ohm/100MHz	R152	033-0000-05	1/16W 0 ohm	R427	119-1031-15	1/10W 10k ohm
L302	010-3104-54	600 ohm/100MHz	R156	119-0000-05	1/10W 0 ohm JW	R428	033-1031-15	1/16W 10k ohm J
L303	010-3104-54	600 ohm/100MHz	R157	033-1051-15	1/16W 1M ohm J	R429	033-1031-15	1/16W 10k ohm J
L304	010-3104-54	600 ohm/100MHz	R158	033-1051-15	1/16W 1M ohm J	R430	033-1011-15	1/16W 100 ohm J
L305	010-3104-54	600 ohm/100MHz	R203	033-1011-15	1/16W 100 ohm J	R431	033-1011-15	1/16W 100 ohm J
L306	010-3104-54	600 ohm/100MHz	R220	116-6201-15	1/4W 62 ohm	R432	116-6201-15	1/4W 62 ohm
L307	010-3104-54	600 ohm/100MHz	R221	116-6201-15	1/4W 62 ohm	R433	116-6201-15	1/4W 62 ohm
L308	010-3104-54	600 ohm/100MHz	R225	119-0000-05	1/10W 0 ohm JW	R434	033-0000-05	1/16W 0 ohm
L309	010-3104-54	600 ohm/100MHz	R226	119-0000-05	1/10W 0 ohm JW	R435	033-4731-15	1/16W 47k ohm J
L310	010-3104-54	600 ohm/100MHz	R301	119-1031-15	1/10W 10k ohm	R436	033-4731-15	1/16W 47k ohm J
L311	010-3104-54	600 ohm/100MHz	R302	119-1031-15	1/10W 10k ohm	R437	033-1031-15	1/16W 10k ohm J
L312	010-3104-54	600 ohm/100MHz	R303	032-0140-89	1/10W 47k ohm F	R440	033-4731-15	1/16W 47k ohm J
L313	010-3104-54	600 ohm/100MHz	R304	032-0140-89	1/10W 47k ohm F	R442	119-4791-15	1/10W 4.7 ohm
L314	010-3104-54	600 ohm/100MHz	R305	032-0140-89	1/10W 47k ohm F	R445	033-0000-05	1/16W 0 ohm
L315	010-3104-54	600 ohm/100MHz	R306	032-0140-89	1/10W 47k ohm F	R446	033-4721-15	1/16W 4.7k ohm J
L316	010-3104-54	600 ohm/100MHz	R307	033-1031-15	1/16W 10k ohm J	R447	033-4731-15	1/16W 47k ohm J
L317	010-3104-54	600 ohm/100MHz	R308	032-0140-89	1/10W 47k ohm F	R448	033-1031-15	1/16W 10k ohm J
L318	010-3104-54	600 ohm/100MHz	R309	032-0140-89	1/10W 47k ohm F	R449	033-4731-15	1/16W 47k ohm J
L319	010-3104-54	600 ohm/100MHz	R310	032-0140-89	1/10W 47k ohm F	R450	033-1021-15	1/16W 1k ohm J
L320	010-3105-70	240ohm/100MHz	R311	032-0140-89	1/10W 47k ohm F	R451	033-1011-15	1/16W 100 ohm J
L321	010-3104-54	600 ohm/100MHz	R313	033-1031-15	1/16W 10k ohm J	R454	033-1011-15	1/16W 100 ohm J
L322	010-3104-54	600 ohm/100MHz	R318	033-1811-15	1/16W 180 ohm J	R456	033-1021-15	1/16W 1k ohm J
L323	010-3104-54	600 ohm/100MHz	R319	033-1811-15	1/16W 180 ohm J	R457	033-4721-15	1/16W 4.7k ohm J
L401	010-3406-54	2.2uH J	R320	033-1031-15	1/16W 10k ohm J	R458	033-1011-15	1/16W 10k ohm J
L501	010-8049-00	145uH	R321	033-1031-15	1/16W 10k ohm J	R459	033-1011-15	1/16W 100 ohm J
L507	010-3104-54	600 ohm/100MHz	R322	033-1031-15	1/16W 10k ohm J	R460	033-4731-15	1/16W 47k ohm J
L508	010-3414-93	4.7uH	R323	033-1011-15	1/16W 100 ohm J	R462	033-6831-15	1/16W 68k ohm J
P101	092-2210-01	ANT-RECEPT	R324	033-1031-15	1/16W 10k ohm J	R463	033-6831-15	1/16W 68k ohm J
P401	076-6000-59	9P	R325	032-0221-56	1/16W 22k ohm F	R466	033-2231-15	1/16W 22k ohm J
P410	076-3011-76	26P	R326	033-1031-15	1/16W 10k ohm J	R467	033-4721-15	1/16W 4.7k ohm J
P601	076-6000-56	6P	R327	032-0221-56	1/16W 22k ohm F	R468	033-4721-15	1/16W 4.7k ohm J
P602	076-3060-26	26P	R329	032-0221-56	1/16W 22k ohm F	R475	033-4731-15	1/16W 47k ohm J
Q107	190-2060-00	2SA2060	R331	032-0221-56	1/16W 22k ohm F	R479	033-3321-15	1/16W 3.3k ohm J
Q108	125-2046-95	DTC143ZUB	R332	119-2201-15	1/10W 22 ohm	R480	033-3321-15	1/16W 3.3k ohm J
Q301	125-2046-95	DTC143ZUB	R334	033-1041-15	1/16W 100k ohm J	R481	033-2221-15	1/16W 2.2k ohm J
Q302	125-7021-90	RQ1A060ZPTR	R335	033-1041-15	1/16W 100k ohm J	R488	033-1021-15	1/16W 1k ohm J
Q505	191-1197-50	2SB1197K Q,R	R338	033-4731-15	1/16W 47k ohm J	R489	033-1021-15	1/16W 1k ohm J
Q506	192-4116-00	2SC4116	R344	033-1011-15	1/16W 100 ohm J	R490	033-1021-15	1/16W 1k ohm J
Q507	125-2046-91	DTC114EUBTL	R348	033-1031-15	1/16W 10k ohm J	R491	033-1021-15	1/16W 1k ohm J
Q509	125-2046-91	DTC114EUBTL	R349	033-1011-15	1/16W 100 ohm J	R492	033-0000-05	1/16W 0 ohm
			R350	033-1011-15	1/16W 100 ohm J	R493	033-0000-05	1/16W 0 ohm
			R352	033-1011-15	1/16W 100 ohm J	R495	033-3321-15	1/16W 3.3k ohm J
			R354	033-1011-15	1/16W 100 ohm J	R496	033-3321-15	1/16W 3.3k ohm J
			R355	033-1031-15	1/16W 10k ohm J	R497	033-1031-15	1/16W 10k ohm J
			R356	119-0000-05	1/10W 0 ohm JW	R521	033-1031-15	1/16W 10k ohm J
			R357	119-0000-05	1/10W 0 ohm JW	R522	033-3331-15	1/16W 33k ohm J
			R358	033-1011-15	1/16W 100 ohm J	R527	033-1821-15	1/16W 1.8k ohm J

REF No.	PART No.	DESCRIPTION	REF No.	PART No.	DESCRIPTION	REF No.	PART No.	DESCRIPTION
R528	033-1031-15	1/16W 10k ohm J	R577	032-0148-63	1/10W 130k ohm D	RN406	050-0140-63	1/32W 47k ohm x4J
R529	119-5611-15	1/10W 560 ohm	R578	033-1841-15	1/16W 180k ohm J	RN407	050-0140-54	1/32W 1k ohm x4J
R530	119-1031-15	1/10W 10k ohm	R579	033-3341-15	1/16W 330k ohm J	RN408	050-0140-54	1/32W 1k ohm x4J
R531	032-0208-51	1/4W 15k ohm	R581	033-1031-15	1/16W 10k ohm J	RN409	050-0140-54	1/32W 1k ohm x4J
R533	AQZ0457	1/16W 150k ohm 1%	R582	032-0150-51	1/16W 15k ohm F	T101	010-4100-50	0.215uH
R534	AQZ0461	1/16W 270k ohm 1%	R583	033-5611-15	1/16W 560 ohm J	TH101	002-0229-00	PTH8L05BAIR8M1B
R535	033-4731-15	1/16W 47k ohm J	R584	033-1031-15	1/16W 10k ohm J	VR213	001-9210-50	AVR-M1608C270MTA AD
R536	033-1031-15	1/16W 10k ohm J	R585	119-0000-05	1/10W 0 ohm JW	VR214	001-9210-50	AVR-M1608C270MTA AD
R537	119-4731-15	1/10W 47k ohm	R588	033-0000-05	1/16W 0 ohm	VR215	001-9210-50	AVR-M1608C270MTA AD
R538	119-2731-15	1/10W 27k ohm	R589	033-0000-05	1/16W 0 ohm	VR216	001-9210-50	AVR-M1608C270MTA AD
R539	119-3321-15	1/10W 3.3k ohm	R590	033-0000-05	1/16W 0 ohm	VR217	001-9210-50	AVR-M1608C270MTA AD
R540	119-0000-05	1/10W 0 ohm JW	R591	033-0000-05	1/16W 0 ohm	VR218	001-9210-50	AVR-M1608C270MTA AD
R541	119-0000-05	1/10W 0 ohm JW	R592	116-3991-15	1/4W 3.9 ohm	VR502	001-9210-50	AVR-M1608C270MTA AD
R542	119-0000-05	1/10W 0 ohm JW	R593	116-3991-15	1/4W 3.9 ohm	VR503	001-9210-50	AVR-M1608C270MTA AD
R543	116-4721-15	1/4W 4.7k ohm	R605	116-2201-15	1/4W 22 ohm	VR504	001-9210-50	AVR-M1608C270MTA AD
R544	119-2221-15	1/10W 2.2k ohm	R615	033-2231-15	1/16W 22k ohm J	X301	061-3589-90	41.6MHz
R546	116-1531-15	1/4W 15k ohm	R616	033-1041-15	1/16W 100k ohm J	X401	061-3567-90	8.000MHz AT-41CD2
R547	116-4791-15	1/4W 4.7 ohm	R618	033-2231-15	1/16W 22k ohm J	ZD101	060-8107-50	SURGE PROTECTO R
R548	116-4791-15	1/4W 4.7 ohm	R621	032-0221-65	1/16W 68k ohm F	ZD501	001-4312-34	02DZ6.2X TPH3-F
R550	032-0221-65	1/16W 68k ohm F	R622	032-0221-80	1/16W 6.2k ohm F	ZD503	001-4305-25	UDZSTE-17 9.1B
R551	032-0221-80	1/16W 6.2k ohm F	R623	033-1041-15	1/16W 100k ohm J	ZD507	001-4912-90	SM5S22A-HE3/2D
R555	032-0221-51	1/16W 4.7k ohm F	R624	033-2231-15	1/16W 22k ohm J	ZD508	001-4312-47	02DZ9.1Y TPH3-F
R556	032-0221-51	1/16W 4.7k ohm F	R625	119-0000-05	1/10W 0 ohm JW	PWB	039-3869-00	PWB(WITHOUT COMPONENTS)
R557	033-5611-15	1/16W 560 ohm J	R629	033-0000-05	1/16W 0 ohm			
R558	033-1031-15	1/16W 10k ohm J	R630	033-0000-05	1/16W 0 ohm			
R560	032-0221-76	1/16W 24k ohm	R632	033-0000-05	1/16W 0 ohm			
R561	032-0221-61	1/16W 6.8k ohm F	R635	119-0000-05	1/10W 0 ohm JW			
R562	033-0000-05	1/16W 0 ohm	R636	033-1001-15	1/16W 10 ohm J			
R563	033-0000-05	1/16W 0 ohm	R637	033-1001-15	1/16W 10 ohm J			
R564	033-0000-05	1/16W 0 ohm	R638	033-1041-15	1/16W 100k ohm J			
R565	033-0000-05	1/16W 0 ohm	R639	033-0000-05	1/16W 0 ohm			
R567	032-0221-65	1/16W 68k ohm F	R640	033-0000-05	1/16W 0 ohm			
R568	032-0221-61	1/16W 6.8k ohm F	RN401	050-0140-52	1/32W 100 ohm x4J			
R575	033-0000-05	1/16W 0 ohm	RN402	050-0140-52	1/32W 100 ohm x4J			
R576	032-0148-64	1/10W 390k ohm D	RN405	050-0140-63	1/32W 47k ohm x4J			

SW PWB(B2) section

REF No.	PART No.	DESCRIPTION	REF No.	PART No.	DESCRIPTION	REF No.	PART No.	DESCRIPTION
C601	043-0568-90	25V 2.2uF			P4R2	R624	116-1511-15	1/4W 150 ohm
C602	043-0568-90	25V 2.2uF	D634	001-7148-90	NSSB064-EE7-TKML	R625	116-1511-15	1/4W 150 ohm
C603	043-0552-90	6.3V 47uF M			P4R2	R626	116-1511-15	1/4W 150 ohm
C604	046-4712-58	470pF K B	D635	001-7148-90	NSSB064-EE7-TKML	R627	116-1511-15	1/4W 150 ohm
C605	043-0568-90	25V 2.2uF			P4R2	R635	032-0150-55	1/16W 2.7k ohm F
C606	046-1022-58	50V 1000pF	D636	001-7148-90	NSSB064-EE7-TKML	R636	032-0150-55	1/16W 2.7k ohm F
C607	046-1022-58	50V 1000pF			P4R2	R637	032-0150-55	1/16W 2.7k ohm F
C608	046-1022-58	50V 1000pF	D637	001-7148-90	NSSB064-EE7-TKML	R638	032-0150-55	1/16W 2.7k ohm F
C609	043-0552-90	6.3V 47uF M			P4R2	R651	032-0140-72	1/10W 470 ohm F
C610	043-6400-90	16V 4.7uF K	D638	001-7148-90	NSSB064-EE7-TKML	SW601	013-6202-52	SKPMBJE010
D601	001-7109-90	SML-311DTT86 ORG			P4R2	SW602	013-6201-53	SKPMAPE010
D602	001-7109-90	SML-311DTT86 ORG	D639	001-7148-90	NSSB064-EE7-TKML	SW603	013-6201-53	SKPMAPE010
D603	001-7109-90	SML-311DTT86 ORG			P4R2	SW604	016-7006-00	ROTARY SW
D604	001-7109-90	SML-311DTT86 ORG	D640	001-7148-90	NSSB064-EE7-TKML	SW605	016-7006-00	ROTARY SW
D605	001-7109-90	SML-311DTT86 ORG			P4R2	SW606	013-6202-52	SKPMBJE010
D606	001-7109-90	SML-311DTT86 ORG	D641	001-7148-90	NSSB064-EE7-TKML	SW607	013-6202-52	SKPMBJE010
D607	001-7109-90	SML-311DTT86 ORG			P4R2	SW608	013-6202-52	SKPMBJE010
D608	001-7109-90	SML-311DTT86 ORG	D642	001-7148-90	NSSB064-EE7-TKML	SW609	013-6202-52	SKPMBJE010
D609	001-7109-90	SML-311DTT86 ORG			P4R2	SW610	013-6202-52	SKPMBJE010
D610	001-7109-90	SML-311DTT86 ORG	IC601	051-6105-00	LC75818PHT-8561-H	SW611	013-6202-52	SKPMBJE010
D611	001-7109-90	SML-311DTT86 ORG	J601	075-0395-01	JACK	SW612	013-6201-53	SKPMAPE010
D612	001-7109-90	SML-311DTT86 ORG	J602	074-3055-26	26P	SW613	013-6201-53	SKPMAPE010
D613	001-7109-90	SML-311DTT86 ORG	R601	033-0000-05	1/16W 0 ohm	SW614	013-6201-53	SKPMAPE010
D614	001-7109-90	SML-311DTT86 ORG	R602	033-1031-15	1/16W 10k ohm J	SW615	013-6201-53	SKPMAPE010
D615	001-7109-90	SML-311DTT86 ORG	R603	116-1521-15	1/4W 1.5k ohm	SW616	013-6202-52	SKPMBJE010
D616	001-7109-90	SML-311DTT86 ORG	R604	116-1021-15	1/4W 1k ohm	SW617	013-6202-52	SKPMBJE010
D617	001-7109-90	SML-311DTT86 ORG	R605	116-1521-15	1/4W 1.5k ohm	SW618	013-6202-52	SKPMBJE010
D618	001-7109-90	SML-311DTT86 ORG	R606	116-1521-15	1/4W 1.5k ohm	SW619	013-6202-52	SKPMBJE010
D619	001-7109-90	SML-311DTT86 ORG	R607	116-1021-15	1/4W 1k ohm	SW620	013-6202-52	SKPMBJE010
D620	001-7109-90	SML-311DTT86 ORG	R608	116-1021-15	1/4W 1k ohm	VR601	001-9210-50	AVR-M1608C270MTA AD
D621	001-7109-90	SML-311DTT86 ORG	R609	116-1021-15	1/4W 1k ohm	VR602	001-9210-50	AVR-M1608C270MTA AD
D622	001-7109-90	SML-311DTT86 ORG	R610	116-3321-15	1/4W 3.3k ohm	VR603	001-9210-50	AVR-M1608C270MTA AD
D623	001-7109-90	SML-311DTT86 ORG	R611	116-3321-15	1/4W 3.3k ohm	VR604	001-9210-50	AVR-M1608C270MTA AD
D624	001-7109-90	SML-311DTT86 ORG	R612	116-3321-15	1/4W 3.3k ohm	ZD601	001-4312-32	02DZ5.6Y TPH3-F
D625	001-7109-90	SML-311DTT86 ORG	R613	116-3321-15	1/4W 3.3k ohm	ZD602	001-4312-32	02DZ5.6Y TPH3-F
D626	001-7109-90	SML-311DTT86 ORG	R614	116-3321-15	1/4W 3.3k ohm	ZD606	001-4312-32	02DZ5.6Y TPH3-F
D627	001-7109-90	SML-311DTT86 ORG	R615	116-3321-15	1/4W 3.3k ohm	ZD608	001-4312-32	02DZ5.6Y TPH3-F
D628	001-7109-90	SML-311DTT86 ORG	R616	116-1521-15	1/4W 1.5k ohm	ZD610	001-4312-32	02DZ5.6Y TPH3-F
D629	001-7109-90	SML-311DTT86 ORG	R617	116-1521-15	1/4W 1.5k ohm	ZD611	001-4312-32	02DZ5.6Y TPH3-F
D630	001-7109-90	SML-311DTT86 ORG	R618	116-1521-15	1/4W 1.5k ohm	PWB	039-3797-00	PWB(WITHOUT COMPONENTS)
D631	001-7148-90	NSSB064-EE7-TKML	R619	116-1521-15	1/4W 1.5k ohm			
		P4R2	R620	116-1821-15	1/4W 1.8k ohm			
D632	001-7148-90	NSSB064-EE7-TKML	R621	116-1821-15	1/4W 1.8k ohm			
		P4R2	R622	116-1511-15	1/4W 150 ohm			
D633	001-7148-90	NSSB064-EE7-TKML	R623	116-1511-15	1/4W 150 ohm			

CONNECTOR PWB(B3) section

REF No.	PART No.	DESCRIPTION	REF No.	PART No.	DESCRIPTION	REF No.	PART No.	DESCRIPTION
C101	168-4752-98	4.7uF K	IC101	060-8141-00	BT-MODULE	R104	032-0221-65	1/16W 68k ohm F
C102	043-0603-90	16V 10uF	IC102	051-3709-90	BD00D0AWHFP-TR	R105	032-0221-62	1/16W 8.2k ohm F
C103	046-1022-58	50V 1000pF	IC103	051-3709-90	BD00D0AWHFP-TR	PWB	039-3888-00	PWB(WITHOUT COMPONENTS)
C104	043-6400-90	16V 4.7uF K	J101	074-3055-26	26P			
C105	043-0603-90	16V 10uF	R101	032-0221-76	1/16W 24k ohm			
C106	046-1022-58	50V 1000pF	R102	032-0221-61	1/16W 6.8k ohm F			

EXPLODED VIEW / PARTS LIST

NO.	PART NO.	DESCRIPTION	QTY	NO.	PART NO.	DESCRIPTION	QTY
1	-----	PANEL-ASSY(3379A0-45)	1	2-8	331-5153-00	SOCKET HOLDER	1
1-1	940-8624-01	ESCUTCHEON-ASSY	1	2-9	331-4676-00	ANT-HOLDER	1
1-2	-----	SW-A-PWB-ASSY(3379A9-77)	1	2-10	-	(SOCKET) *N/A	-
1-2-1	-----	SW PWB(379700-039)	1	2-11	-	(SOCKET HOLDER) *N/A	-
1-2-2	001-7109-90	DIODE	30	2-12	074-1302-08	OUTLET SOCKET	1
1-2-3	001-7148-90	LED	12	2-13	778-3006-00	TAP-SCREW	4
1-2-4	013-6202-52	TACT SWITCH	12	2-14	331-5269-00	BT-BRKT	1
1-2-5	013-6201-53	SWITCH	6	2-15	076-3060-26	PLUG	1
1-2-6	016-7006-00	ROTARY ENCODER	2	3	311-1969-91	LOWER CASE	1
1-2-7	075-0395-01	JACK	1	4	313-2070-20	HEAT SINK	1
1-2-8	074-3055-26	OUTLET SOCKET	1	5	309-1948-00	ES PLATE	1
1-2-9	335-9150-00	LCD HOLDER	1	6	310-1889-00	UPPER CASE	1
1-2-10	335-9151-00	LCD REFLECTOR	1	7	929-5150-80	CD-MECH-MODULE	1
1-2-11	379-1462-53	LCD	1	8	331-5138-00	CD BRKT	1
1-2-12	331-5137-00	LCD COVER	1	9	714-2603-89	MACHINE SCREW	2
1-3	335-9147-00	ILLUMI RING(L)	1	10	816-3064-05	FLAT WIRE	1
1-4	335-9148-00	ILLUMI RING(R)	1	11	716-0878-50	SPECIAL SCREW	9
1-5	947-0787-00	KNOB-ASSY	2	12	735-2614-1B	D-SEMS SCREW	2
1-6	947-0788-02	ASSY-PART L	1	13	714-2606-8B	MACHINE SCREW	17
1-7	947-0789-02	ASSY-PART R	1	14	716-3718-00	SPECIAL SCREW	1
1-8	345-8090-00	CUSHION RUBBER	1	15	716-1468-01	SPECIAL SCREW	2
1-9	716-0778-52	SPECIAL SCREW	11	16	060-8122-10	BLUETOOTH-ANT	1
2	-----	MAIN-PWB-ASSY(3378A7-75)	1	17	335-9220-00	ANT-GUIDE	1
2-1	-----	MAIN-PWB(386900-039)	1	18	-----	CONN-PWB-ASSY(3378A7-79)	1
2-2	074-2260-88	OUTLET SOCKET	1	18-1	-----	CONNECTOR-PWB(388800-039)	1
2-3	076-3011-76	PLUG	1	18-2	060-8141-00	BLUETOOTH MODUL	1
2-4	074-4009-20	OUTLET SOCKET	1	18-3	074-3055-26	OUTLET SOCKET	1
2-5	051-2067-00	IC	1	19	276-1042-00	SETPLATE	1
2-6	092-2210-01	ANT-RECEPT	1	20	345-6653-00	RUBBER SHHET	1
2-7	074-1302-16	OUTLET SOCKET	1				

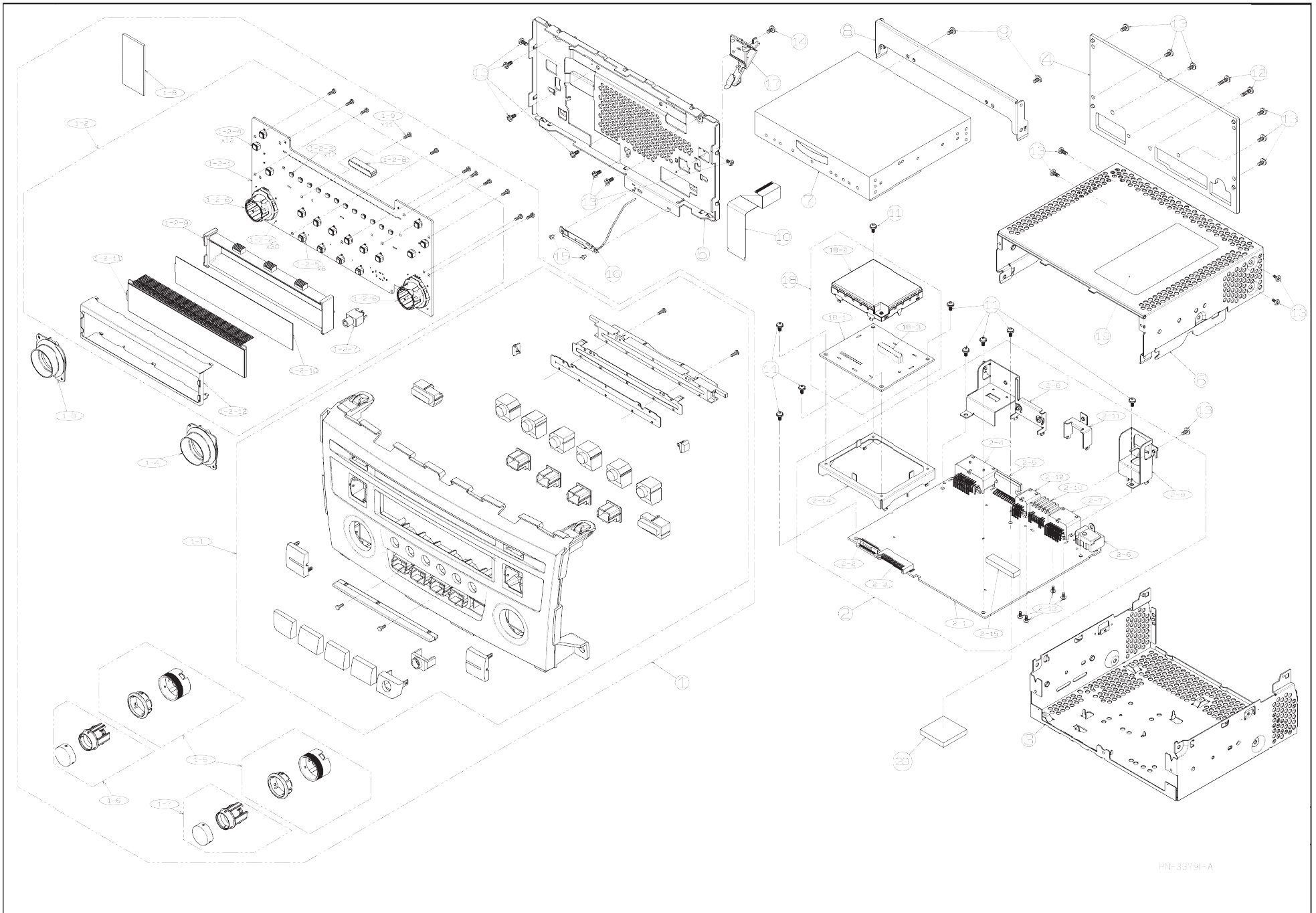

PN-33781-A

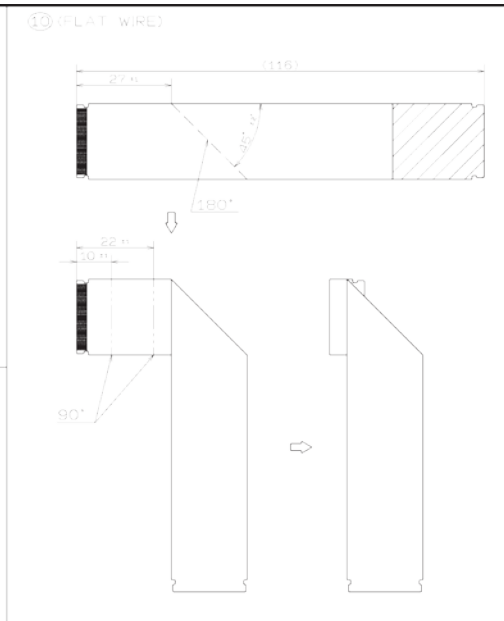
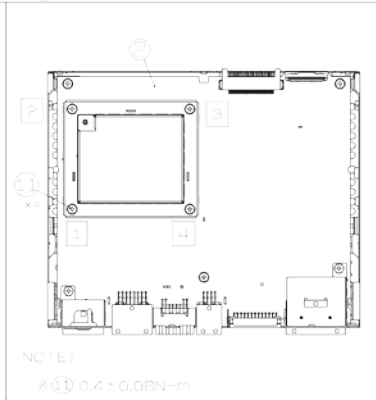
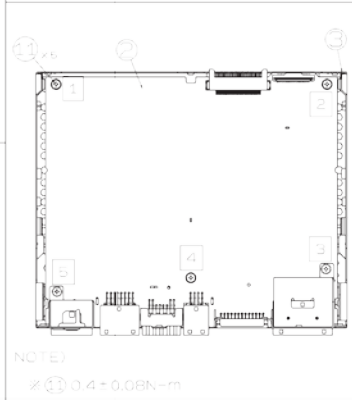
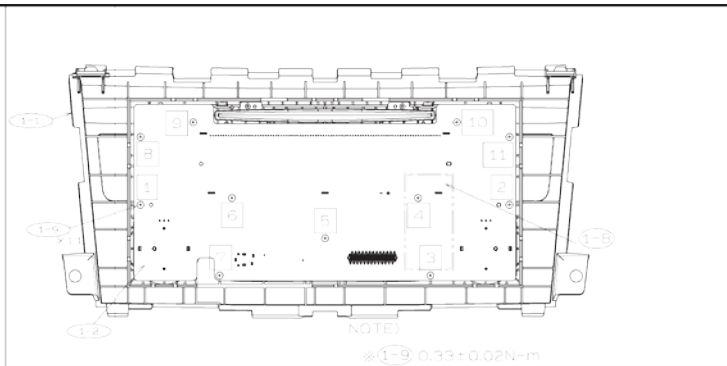
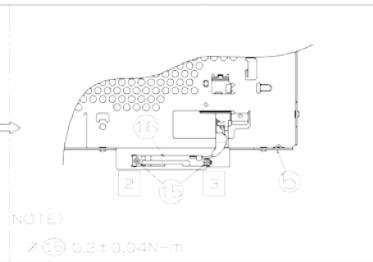
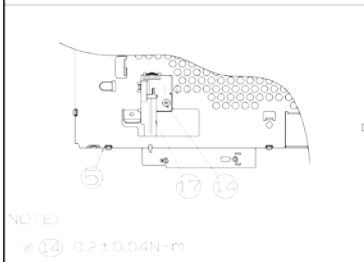
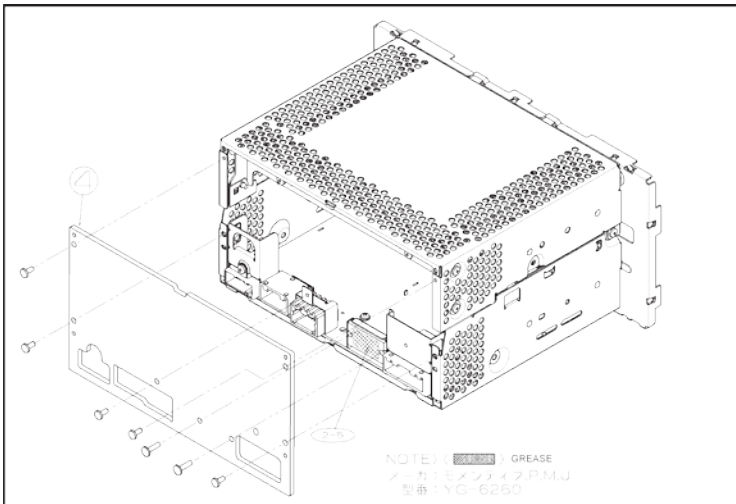

- ⑭ : $0.4 \pm 0.08\text{N}\cdot\text{m}$
- ⑮ : $0.4 \pm 0.08\text{N}\cdot\text{m}$
- ⑯ : $0.4 \pm 0.08\text{N}\cdot\text{m}$

ELECTRICAL PARTS LIST

MAIN PWB(B1) section

REF No.	PART No.	DESCRIPTION	REF No.	PART No.	DESCRIPTION	REF No.	PART No.	DESCRIPTION
C2	168-1052-78	16V 1uF K	C51	045-1201-50	12pFJ CH	R17	033-4731-15	1/16W 47k ohm J
C4	046-1042-78	16V 0,1uF	C57	046-1042-78	16V 0,1uF	R18	033-3341-15	1/16W 330k ohm J
C5	168-1052-78	16V 1uF K	C59	165-4763-15	6,3V 47uF	R19	033-0000-05	1/16W 0 ohm
C7	042-0560-85	6,3V 100uF	C62	046-1042-78	16V 0,1uF	R20	033-3331-15	1/16W 33k ohm J
C10	168-1052-78	16V 1uF K	C63	046-1042-78	16V 0,1uF	R21	033-4731-15	1/16W 47k ohm J
C11	046-1042-78	16V 0,1uF	C64	168-1052-78	16V 1uF K	R22	033-1011-15	1/16W 100 ohm J
C12	165-1073-35	16V 100uF	C66	046-1042-78	16V 0,1uF	R27	033-1051-15	1/16W 1M ohm J
C14	046-1042-78	16V 0,1uF	C67	042-0560-85	6,3V 100uF	R28	033-2221-15	1/16W 2,2k ohm J
C15	046-1042-78	16V 0,1uF	C68	046-1042-78	16V 0,1uF	R30	033-2211-15	1/16W 220 ohm J
C17	046-4722-58	4700pF K B	C70	046-1032-78	16V 0,01uF	R32	033-2211-15	1/16W 220 ohm J
C18	046-1042-78	16V 0,1uF	C76	165-4763-15	6,3V 47uF	R35	033-1031-15	1/16W 10k ohm J
C19	046-1042-78	16V 0,1uF	C79	045-1011-50	100pFJ CH	R36	033-2211-15	1/16W 220 ohm J
C20	168-1052-78	16V 1uF K	C80	045-6097-50	6 +/0,5pF CH	R37	033-2211-15	1/16W 220 ohm J
C21	046-1522-58	1500pF K B	D1	001-0367-91	1SS226	R43	033-2211-15	1/16W 220 ohm J
C22	046-1042-78	16V 0,1uF	ET1	073-0792-90	TERMINAL	R45	033-1031-15	1/16W 10k ohm J
C23	046-1532-78	0,015uF K B	IC1	051-6101-90	BD8226EFV	R46	033-2211-15	1/16W 220 ohm J
C25	046-2222-58	2200pF K B	IC2	051-6752-00	TC94A92FG-301	R47	033-2211-15	1/16W 220 ohm J
C26	046-4712-58	470pF K B	IC3	051-3598-90	BU15TA2WHFV	R50	033-1031-15	1/16W 10k ohm J
C27	046-1032-78	16V 0,01uF	IC4	-----	BH433MAWHFV (Regulator) (Bottom pad type) (350990-051)	R51	033-2211-15	1/16W 220 ohm J
C28	046-3332-78	0,033uF K B	J1	074-2215-65	15P	R52	033-2211-15	1/16W 220 ohm J
C29	046-4712-58	470pF K B	J2	074-2504-10	OUTLET SOCKET	R56	033-1031-15	1/16W 10k ohm J
C30	168-1532-55	0,015uF K	J3	074-2259-38	38P	R58	033-1011-15	1/16W 100 ohm J
C31	046-1042-78	16V 0,1uF	L1	010-3105-69	80 ohm/100MHz	R59	033-2211-15	1/16W 220 ohm J
C32	045-4701-50	47pF CH	Q1	190-1365-50	2SA1365 AF,AG	R63	033-1011-15	1/16W 100 ohm J
C33	046-6822-58	6800pF K B	R1	033-2211-15	1/16W 220 ohm J	R65	119-0000-05	1/10W 0 ohm JW
C34	046-1042-78	16V 0,1uF	R2	033-4721-15	1/16W 4,7k ohm J	R66	033-2731-15	1/16W 27k ohm J
C35	045-6801-50	68pFJ CH	R3	033-4721-15	1/16W 4,7k ohm J	R67	033-0000-05	1/16W 0 ohm
C36	046-1042-78	16V 0,1uF	R4	117-1821-15	1/8W 1,8k ohm	R69	119-2201-15	1/10W 22 ohm
C37	046-5622-58	5600pF K B	R5	033-1831-15	1/16W 18k ohm J	R70	119-2201-15	1/10W 22 ohm
C38	046-4732-78	16V 0,047uF	R6	033-1231-15	1/16W 12k ohm J	R72	119-0000-05	1/10W 0 ohm JW
C39	046-4732-78	16V 0,047uF	R7	116-1001-15	1/4W 10 ohm	R73	119-0000-05	1/10W 0 ohm JW
C40	046-1042-78	16V 0,1uF	R8	033-1541-15	1/16W 150k ohm J	R74	119-0000-05	1/10W 0 ohm JW
C41	046-1042-78	16V 0,1uF	R9	033-1031-15	1/16W 10k ohm J	R75	119-0000-05	1/10W 0 ohm JW
C45	046-1042-78	16V 0,1uF	R15	033-2211-15	1/16W 220 ohm J	R81	119-0000-05	1/10W 0 ohm JW
C46	043-0570-90	16V 2,2uF K	R16	033-2231-15	1/16W 22k ohm J	X1	061-3586-90	DSX321G(F) 16,920MHz
C47	046-1042-78	16V 0,1uF				PWB	039-3731-20	PWB(WITHOUT COMPONENTS)
C48	046-1042-78	16V 0,1uF						
C50	045-1201-50	12pFJ CH						

SENSOR PWB(B2) section

REF No.	PART No.	DESCRIPTION	REF No.	PART No.	DESCRIPTION	REF No.	PART No.	DESCRIPTION
D1	001-7138-91	SML-S13RT T86	Q1	060-4025-90	SML-H10TBT86	PWB	039-3732-20	PWB(WITHOUT COMPONENTS)
D2	001-7138-91	SML-S13RT T86	Q2	060-4025-90	SML-H10TBT86			
J1	074-2504-10	OUTLET SOCKET	S2	013-7414-50	SPV6220100			

EXPLODED VIEW / PARTS LIST

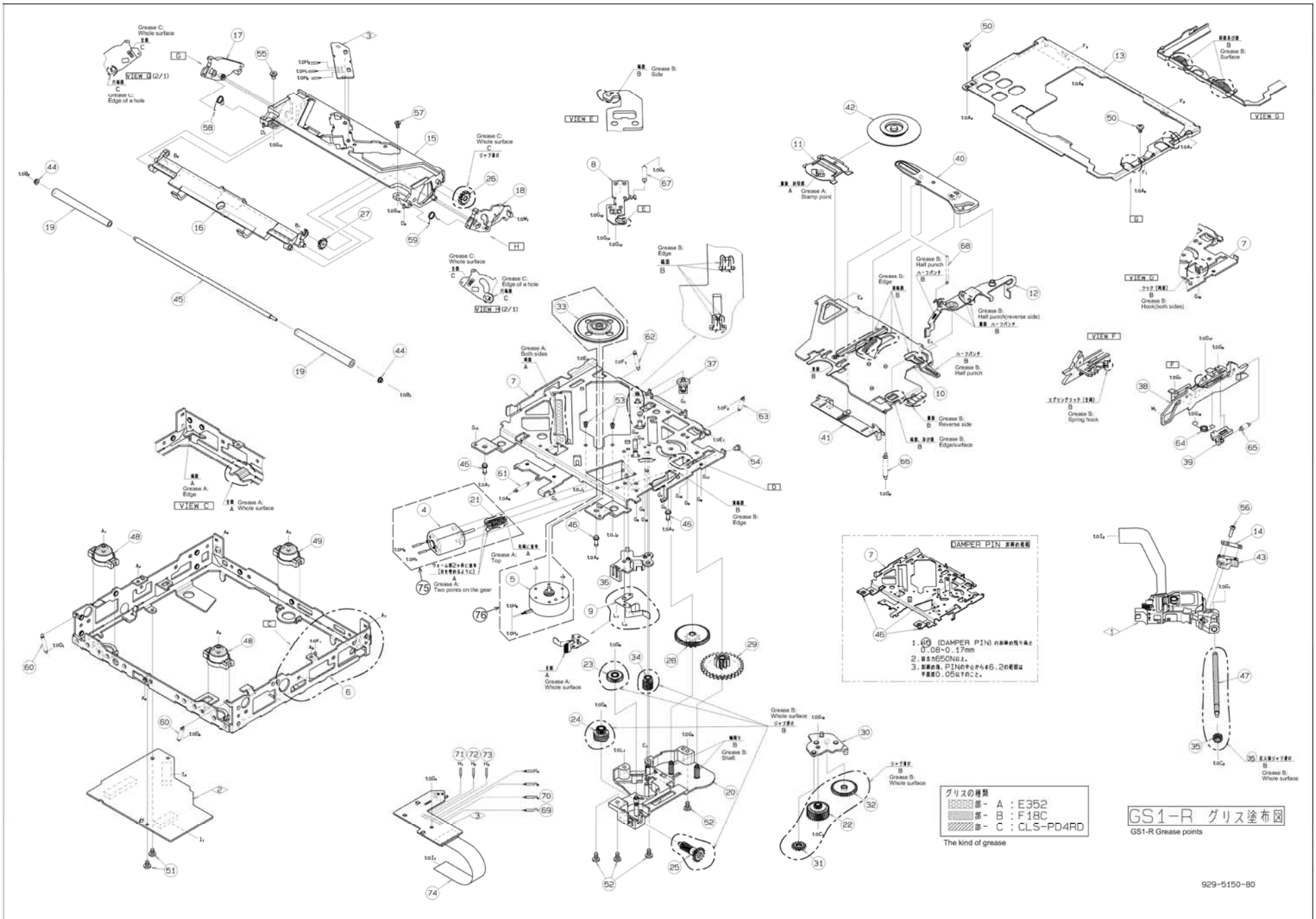

グリスの種類

▨	部 - A	: E352
▨	部 - B	: F18C
▨	部 - C	: CLS-PD4RD

The kind of grease

GS1-R グリス塗布図
GS1-R Grease points

NO.	PART NO.	DESCRIPTION	Q'TY	NO.	PART NO.	DESCRIPTION	Q'TY
1	969-0080-30	PICKUP-ASSY	1	39	621-1869-21	RACK	1
2	-----	MAIN-PWB-ASSY(5150BH-97)	1	40	621-1870-21	STOPPER LINK	1
3	-----	SENS-PWB-ASSY(5100BH-95)	1	41	621-1871-21	DISC STOPPER	1
4	-----	DC-MOTOR PWR(154000-020)	1	42	621-1872-21	CLAMPER RING	1
5	-----	DC-MOTOR SPN(154100-020)	1	43	621-1873-21	LS-RACK	1
6	620-1910-21	LOWER CHASSIS	1	44	621-1726-21	ROLLER SLEEVE	2
7	620-1911-20	DRIVE PLATE	1	45	622-1885-20	ROLLER SHAFT	1
8	620-1912-21	ID-LOCK PLATE	1	46	622-1886-20	DAMPER PIN	3
9	620-1913-20	SPRING PLATE	1	47	624-3062-20	LEAD SCREW	1
10	620-1914-21	CLAMPER ARM	1	48	629-0138-21	DAMPER F	2
11	620-1915-22	CLAMPER PLATE	1	49	629-0139-21	DAMPER R	1
12	620-1916-21	SENSOR ARM	1	50	714-2003-8B	MACHIN SCREW	2
13	620-1928-20	UPPER CHASSIS	1	51	716-3718-00	SPECIAL SCREW	2
14	620-1918-21	LS-RACK PLATE	1	52	716-3719-00	SPECIAL SCREW	4
15	621-1845-22	UPPER GUIDE	1	53	716-3720-00	SPECIAL SCREW	2
16	621-1846-22	ROLLER GUIDE	1	54	716-3721-00	SPECIAL SCREW	1
17	621-1847-20	LOCK ARM L	1	55	716-3722-00	SPECIAL SCREW	1
18	621-1848-22	LOCK ARM R	1	56	716-3723-02	SPECIAL-SCREW	1
19	621-1849-20	LOADING ROLLER	2	57	716-3724-00	SPECIAL SCREW	1
20	621-1850-21	GEAR BOX	1	58	750-7924-21	ROLLER SPRING L	1
21	-----	M-GEAR PWR(185121-621)	1	59	750-7925-21	ROLLER SPRING R	1
22	621-1852-20	SECOND GEAR	1	60	750-7926-20	DR-SPRING F	2
23	621-1853-20	ROLLER GEAR A	1	61	750-7927-20	DR-SPRING C	1
24	621-1854-20	ROLLER GEAR B	1	62	750-7928-20	DR-SPRING RA	1
25	621-1855-20	ROLLER GEAR C	1	63	750-7929-20	DR-SPRING RB	1
26	621-1856-20	ROLLER GEAR D	1	64	750-7930-20	SHIFT SPRING	1
27	621-1857-20	ROLLER GEAR E	1	65	750-7931-20	RACK SPRING	1
28	621-1858-20	POWER GEAR A	1	66	750-7932-20	CLAMPER SPRING	1
29	621-1859-20	POWER GEAR B	1	67	750-7933-20	ID-LOCK SPRING	1
30	621-1860-21	IDLE CASE	1	68	750-7934-20	SENSOR SPRING	1
31	621-1861-20	IDLE GEAR A	1	69	803-4906-60	VINYL-COAT-WIRE	1
32	621-1862-20	IDLE GEAR B	1	70	816-2590-00	SPECIAL LEAD	1
33	-----	TURN TABLE(186320-621)	1	71	816-2591-00	SPECIAL LEAD	1
34	621-1864-20	THREAD GEAR A	1	72	816-2592-00	SPECIAL LEAD	1
35	621-1865-20	THREAD GEAR B	1	73	816-2593-00	SPECIAL LEAD	1
36	621-1866-20	LS-HOLDER A	1	74	816-4070-50	FLAT WIRE	1
37	621-1867-20	LS-HOLDER B	1	75	HBS-668-100	POWER MOTOR ASSY	1
38	621-1868-23	SHIFT LEVER	1	76	HBS-669-100	SLED MOTOR ASSY	1