

# KDC-3028/328

## EXPLODED VIEW (CD MECHANISM)

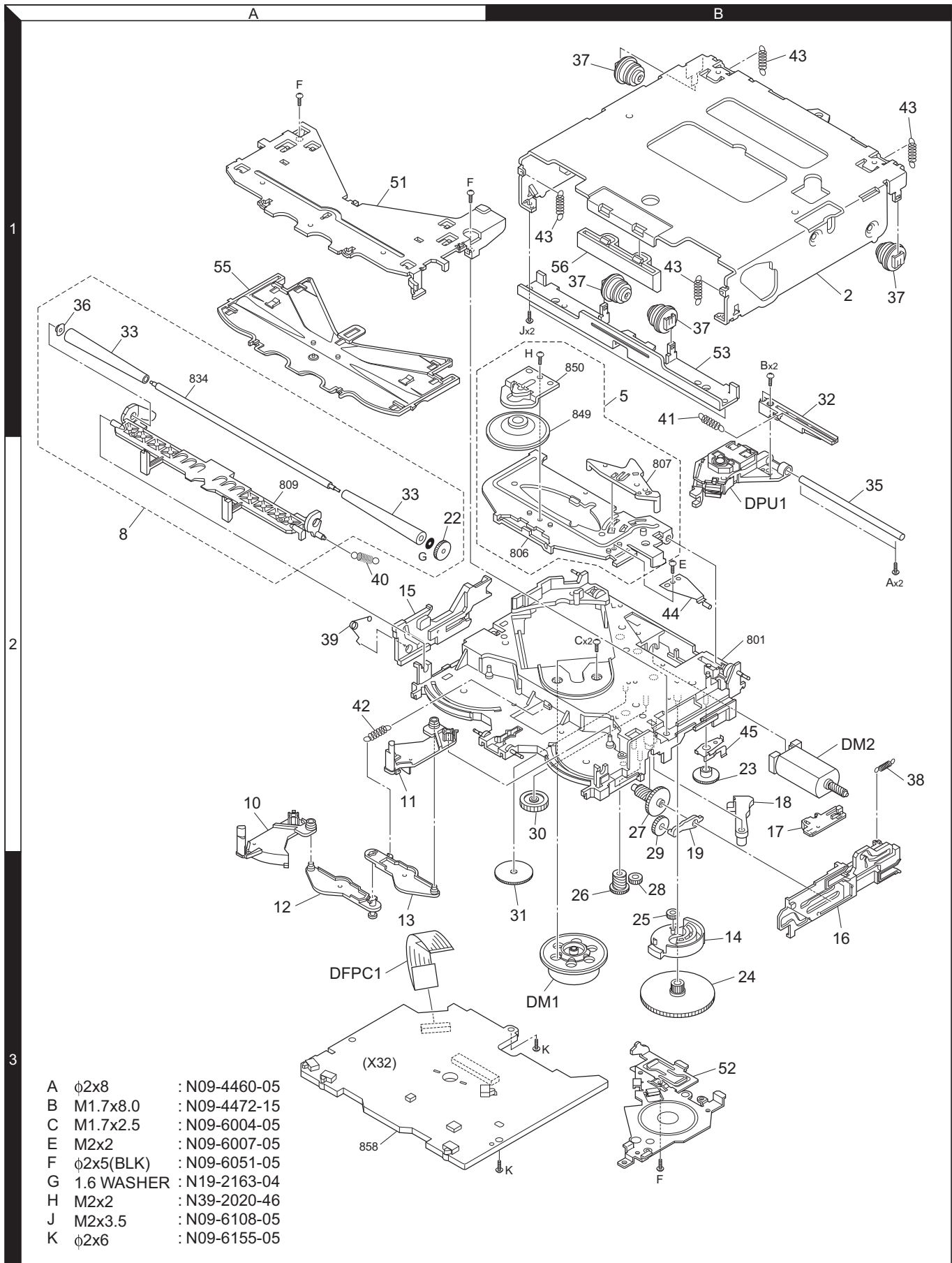

# KDC-3028/328

## EXPLODED VIEW (UNIT)

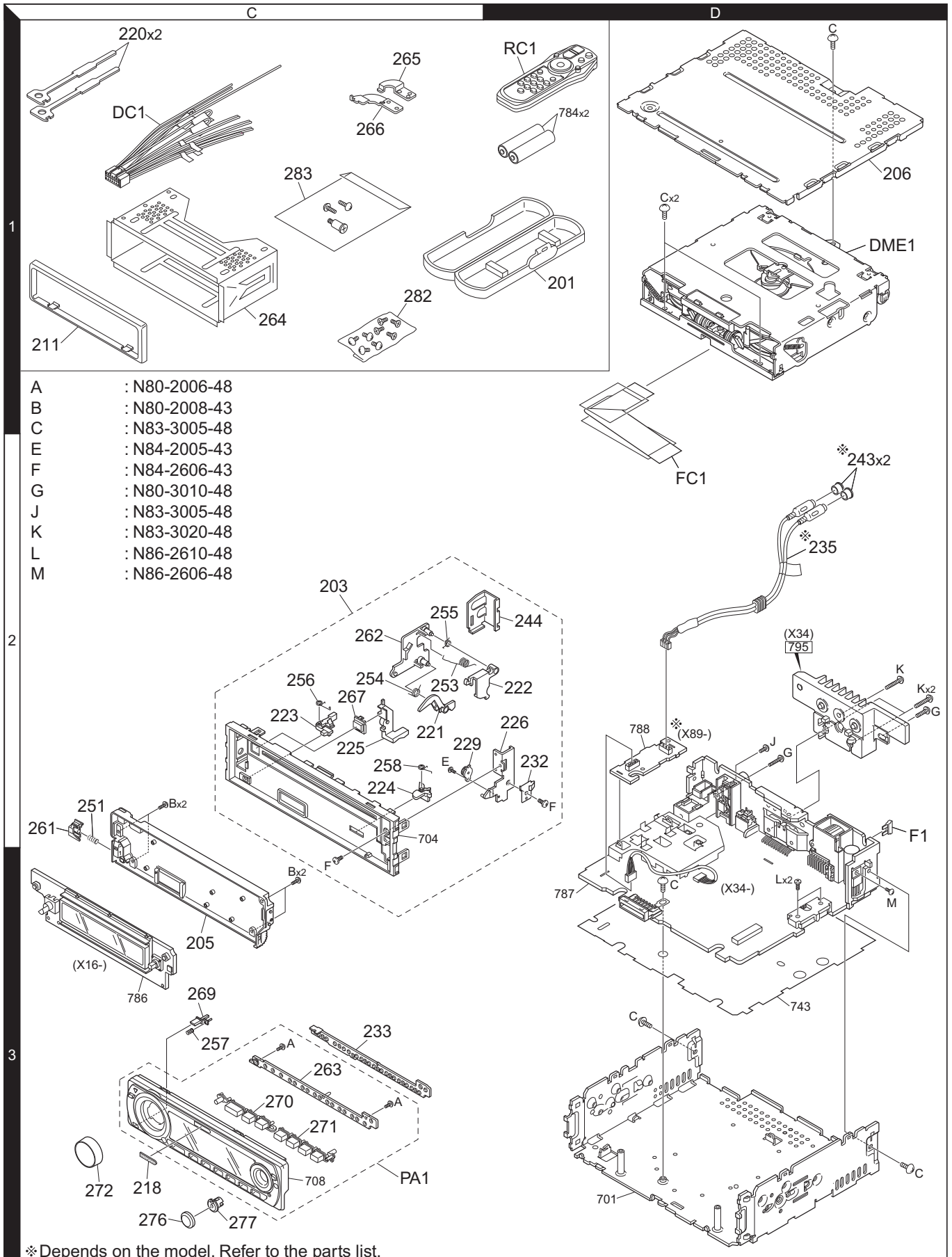

- A : N80-2006-48
- B : N80-2008-43
- C : N83-3005-48
- E : N84-2005-43
- F : N84-2606-43
- G : N80-3010-48
- J : N83-3005-48
- K : N83-3020-48
- L : N86-2610-48
- M : N86-2606-48

\* Depends on the model. Refer to the parts list.

Parts with the exploded numbers larger than 700 are not supplied.

# KDC-3028/328

## PARTS LIST

\* New parts

Parts without **Parts No.** are not supplied.

Les articles non mentionnés dans le **Parts No.** ne sont pas fournis.

Teile ohne **Parts No.** werden nicht geliefert.

Ref. No.	A d d	N e w	Parts No.	Description	Desti- nation
<b>KDC-3028/328</b>					
201	1D	*	A02-2743-03	PLASTIC CABINET ASSY	
203	2C	*	A22-3059-12	SUB PANEL ASSY	
205	3C	*	A46-1816-01	REAR COVER	
206	1D		A52-0804-12	TOP PLATE	
PA1	3C	*	A64-3486-12	PANEL ASSY	K2
PA1	3C	*	A64-3630-12	PANEL ASSY	K3
RC1	1D		A70-2069-05	REMOTE CONTROLLER ASSY (RC-517)	
-			B46-0100-50	WARRANTY CARD	
-			B46-0606-04	ID CARD	
-		*	B58-1426-04	CAUTION CARD	
-		*	B64-2949-00	INST. MANUAL (ENG, FRE, SPA)	
211	1C	*	B07-3124-01	ESCUTCHEON	K3
211	1C	*	B07-3126-01	ESCUTCHEON	K2
218	3C		B43-1518-04	BADGE	
220	1C		D10-4589-04	LEVER	
221	2C	*	D10-4865-03	LEVER	
222	2D	*	D10-4866-03	LEVER	
223	2C	*	D10-4867-04	LEVER	
224	2C	*	D10-4868-04	LEVER	
225	2C	*	D10-4869-03	LEVER	
226	2D	*	D10-4870-04	ARM ASSY	
229	2C		D39-0255-05	DAMPER	
232	2D	*	E29-2028-04	LEAD PLATE	
233	3C	*	E29-2029-03	CONDUCTIVE RUBBER	
235	2D		E30-6229-05	CORD WITH PINPLUG	K3
DC1	1C		E30-6415-15	DC CORD	
FC1	2D		E39-0718-05	FLAT CABLE	
243	2D		F29-0626-04	INSULATING COVER	K3
244	2D	*	F31-0716-04	REINFORCING HARDWARE	
F1	2D		F52-0006-05	FUSE (MINI BLADE TYPE) (10A)	
251	2C		G01-3173-04	COMPRESSION SPRING	
253	2C	*	G01-3246-04	TORSION COIL SPRING	
254	2C	*	G01-3247-04	TORSION COIL SPRING	
255	2C	*	G01-3248-04	TORSION COIL SPRING	
256	2C	*	G01-3249-04	TORSION COIL SPRING	
257	3C	*	G01-3250-04	COMPRESSION SPRING	
258	2C	*	G01-3270-04	TORSION COIL SPRING	
-			H10-4919-12	POLYSTYRENE FOAMED FIXTURE	
-			H25-0329-04	PROTECTION BAG (280X450X0.03)	
-			H25-0337-04	PROTECTION BAG (180X300X0.03)	
-		*	H54-3363-13	ITEM CARTON CASE (KDC-328)	K2
-		*	H54-3417-13	ITEM CARTON CASE (KDC-3028)	K3
261	2C		J19-5205-03	HOLDER	
262	2C	*	J19-7049-03	HOLDER	
263	3C	*	J19-7050-02	HOLDER	
264	1C		J22-0011-03	MOUNTING HARDWARE ASSY	
265	1C	*	J22-0258-04	MOUNTING HARDWARE (L)	
266	1C	*	J22-0259-04	MOUNTING HARDWARE (R)	
267	2C	*	K24-4282-04	PUSH KNOB (EJECT)	
269	3C	*	K24-4285-04	PUSH KNOB (RELEASE)	

Ref. No.	A d d	N e w	Parts No.	Description	Desti- nation
270	3C	*	K25-1692-03	PUSH KNOB (Q, SRC, 1, 2)	K3
270	3C	*	K25-1755-03	PUSH KNOB (Q, SRC, 1, 2)	K2
271	3C	*	K25-1694-03	PUSH KNOB (3, 4, 5, 6)	K3
271	3C	*	K25-1756-03	PUSH KNOB (3, 4, 5, 6)	K2
272	3C		K29-7132-03	KNOB ASSY (VOL)	
276	3C		K29-7139-03	KEY TOP (FM/AM)	
277	3C	*	K29-7141-03	KNOB BASE (FM/AM)	
282	1C		N99-1757-05	SCREW SET	
283	1C	*	N99-1763-05	SCREW SET	
A	3C		N80-2006-48	PAN HEAD TAPTITE SCREW	
B	2C		N80-2008-43	PAN HEAD TAPTITE SCREW	
C	1D		N83-3005-48	PAN HEAD TAPTITE SCREW	
E	2C		N84-2005-43	PAN HEAD TAPTITE SCREW	
F	2C		N84-2606-43	PAN HEAD TAPTITE SCREW	
L	3D		N86-2610-48	BINDING HEAD TAPTITE SCREW	
DME1	1D		X92-5090-00	MECHANISM ASSY	
<b>SWITCH UNIT (X16-2910-11)</b>					
D1-3			B30-1566-05	LED (RED)	
D7-9			B30-1566-05	LED (RED)	
D13-15			B30-1566-05	LED (RED)	
D19			B30-1566-05	LED (RED)	
D20-24			B30-1729-05	LED (BLUE)	
D25			B30-1566-05	LED (RED)	
C8			CK73FB1A225K	CHIP C 2.2UF K	
C10			CK73GB1H103K	CHIP C 0.010UF K	
C11			CC73GCH1H470J	CHIP C 47PF J	
C13-17			CK73GB1H103K	CHIP C 0.010UF K	
C19,20			CK73GB1H103K	CHIP C 0.010UF K	
J1			E59-0840-05	RECTANGULAR PLUG	
CP10,11			RK74HB1J102J	CHIP-COM 1.0K J 1/16W	
CP12,13			RK74GA1J102J	CHIP-COM 1.0K J 1/16W	
R1			RK73EB2E472J	CHIP R 4.7K J 1/4W	
R2			RK73EB2E102J	CHIP R 1.0K J 1/4W	
R3-8			RK73EB2E101J	CHIP R 100 J 1/4W	
R9			RK73EB2E472J	CHIP R 4.7K J 1/4W	
R10			RK73GB2A203J	CHIP R 20K J 1/10W	
R11			RK73GB2A4R7J	CHIP R 4.7 J 1/10W	
R12			RK73GB2A472J	CHIP R 4.7K J 1/10W	
R13			RK73GB2A102J	CHIP R 1.0K J 1/10W	
R15			RK73GB2A102J	CHIP R 1.0K J 1/10W	
R20			RK73GB2A101J	CHIP R 100 J 1/10W	
R51-53			RK73FB2B471J	CHIP R 470 J 1/8W	
R54			RK73EB2E681J	CHIP R 680 J 1/4W	
R55,56			RK73FB2B301J	CHIP R 300 J 1/8W	
R57			RK73EB2E681J	CHIP R 680 J 1/4W	
R58			RK73GB2A222J	CHIP R 2.2K J 1/10W	
R70			RK73GB2A473J	CHIP R 47K J 1/10W	
R73			RK73SB3A330J	CHIP R 33 J 1W	
R74,75			RK73SB3A220J	CHIP R 22 J 1W	
S2			S70-0106-05	TACT SWITCH	
S10			S70-0051-15	TACT SWITCH	
S27			S70-0051-15	TACT SWITCH	

E : Europe K : North America  
M : Other Areas W : Without Europe

K2 : KDC-328  
K3 : KDC-3028

△ Indicates safety critical components.

## PARTS LIST

### SWITCH UNIT (X16-2910-11)

Ref. No.	Add	New	Parts No.	Description	Destination
S1			T99-0457-05	ROTARY ENCODER	
D101,102			02DZ6.8F-Y	ZENER DIODE	
D103			FTZ6.8E	ZENER DIODE	
D104,105			02DZ6.8F-Y	ZENER DIODE	
D106		*	02DZ12F-X	ZENER DIODE	
D107-109			02DZ6.8F-Y	ZENER DIODE	
D110			DA204U	DIODE	
ED1		*	3-BT-225N	FLUORESCENT INDICATOR TUBE	
IC1			LC75756W	MOS-IC	
IC2			PNA4S22M	ANALOGUE IC	
Q4			DTA114EE	DIGITAL TRANSISTOR	
Q4			KRA302E-P	DIGITAL TRANSISTOR	
Q4			RT1P141U	DIGITAL TRANSISTOR	
Q10			KTC4075EP(Y,GR)	TRANSISTOR	
Q10			2SC4617	TRANSISTOR	
Q10			2SC5383(E,F)	TRANSISTOR	

### CD PLAYER UNIT (X32-5750-00)

C1			C93-1215-05	CERAMIC	10UF	K
C2			CK73FB1A225K	CHIP C	2.2UF	K
C3			CK73GB0J105K	CHIP C	1.0UF	K
C5			CC73GCH1H020C	CHIP C	2.0PF	C
C6			CC73GCH1H390J	CHIP C	39PF	J
C7			CK73GB1C104K	CHIP C	0.10UF	K
C8			CK73GB0J105K	CHIP C	1.0UF	K
C9			CK73GB1H472K	CHIP C	4700PF	K
C10			CK73GB1C333K	CHIP C	0.033UF	K
C11			CK73GB1H682K	CHIP C	6800PF	K
C12			CK73GB1H332K	CHIP C	3300PF	K
C13			CC73GCH1H271J	CHIP C	270PF	J
C14			CK73GB1H472K	CHIP C	4700PF	K
C15			CK73GB1H222K	CHIP C	2200PF	K
C16			CC73GCH1H331J	CHIP C	330PF	J
C17,18			CK73GB1C104K	CHIP C	0.10UF	K
C31-34			CK73GB1C104K	CHIP C	0.10UF	K
C36			CK73FB1A225K	CHIP C	2.2UF	K
C37-39			CK73GB1H103K	CHIP C	0.010UF	K
C40			CK73GB1H153K	CHIP C	0.015UF	K
C41			CK73GB1H102K	CHIP C	1000PF	K
C42			CK73GB1E473K	CHIP C	0.047UF	K
C43			CK73GB1H222K	CHIP C	2200PF	K
C44			CK73GB1H102K	CHIP C	1000PF	K
C45-47			CK73GB1C104K	CHIP C	0.10UF	K
C48			CK73GB1H682K	CHIP C	6800PF	K
C49			CK73GB1H152K	CHIP C	1500PF	K
C50			CK73GB1H472K	CHIP C	4700PF	K
C51			CK73GB1H681K	CHIP C	680PF	K
C52			CK73GB1C104K	CHIP C	0.10UF	K
C61			CK73FB1A225K	CHIP C	2.2UF	K
C62			CK73GB1C104K	CHIP C	0.10UF	K
C71,72			CK73GB1H471K	CHIP C	470PF	K
C73,74			CC73GCH1H680J	CHIP C	68PF	J
C75,76			CK73GB1H222K	CHIP C	2200PF	K
C77,78			CK73GB1C104K	CHIP C	0.10UF	K
C100-102			CK73GB1H102K	CHIP C	1000PF	K

Ref. No.	Add	New	Parts No.	Description	Destination
CN1			E41-2068-05	FLAT CABLE CONNECTOR	
CN1			E41-2297-05	FLAT CABLE CONNECTOR	
CN2			E41-2083-05	FLAT CABLE CONNECTOR	
X1			L78-0851-05	RESONATOR (16.934MHZ)	
CP1			RK74GA1J101J	CHIP-COM	100 J 1/16W
CP2			RK74GB1J101J	CHIP-COM	100 J 1/16W
CP3			RK74GB1J182J	CHIP-COM	1.8K J 1/16W
CP4			RK74GB1J472J	CHIP-COM	4.7K J 1/16W
CP5			RK74GB1J104J	CHIP-COM	100K J 1/16W
R1			RK73GB2A910J	CHIP R	91 J 1/10W
R2,3			RK73GB2A562J	CHIP R	5.6K J 1/10W
R4			RK73FB2B100J	CHIP R	10 J 1/8W
R5,6			RK73GB2A332J	CHIP R	3.3K J 1/10W
R7			RK73GB2A362J	CHIP R	3.6K J 1/10W
R8			RK73GB2A273J	CHIP R	27K J 1/10W
R9			RK73GB2A392J	CHIP R	3.9K J 1/10W
R10			RK73GB2A104J	CHIP R	100K J 1/10W
R11			RK73GB2A333J	CHIP R	33K J 1/10W
R12			RK73GB2A244J	CHIP R	240K J 1/10W
R13			RK73GB2A914J	CHIP R	910K J 1/10W
R14			RK73GB2A104J	CHIP R	100K J 1/10W
R15			RK73GB2A472J	CHIP R	4.7K J 1/10W
R31			RK73GB2A273J	CHIP R	27K J 1/10W
R32			RK73GB2A103J	CHIP R	10K J 1/10W
R33			RK73GB2A183J	CHIP R	18K J 1/10W
R34			RK73GB2A103J	CHIP R	10K J 1/10W
R35			RK73GB2A393J	CHIP R	39K J 1/10W
R36			RK73GB2A103J	CHIP R	10K J 1/10W
R37			RK73GB2A622J	CHIP R	6.2K J 1/10W
R38			RK73GB2A224J	CHIP R	220K J 1/10W
R39			RK73GB2A104J	CHIP R	100K J 1/10W
R40			RK73GB2A821J	CHIP R	820 J 1/10W
R41			RK73GB2A473J	CHIP R	47K J 1/10W
R42			RK73GB2A472J	CHIP R	4.7K J 1/10W
R43			RK73GB2A102J	CHIP R	1.0K J 1/10W
R44,45			RK73GB2A103J	CHIP R	10K J 1/10W
R46			RK73GB2A273J	CHIP R	27K J 1/10W
R47			RK73GB2A222J	CHIP R	2.2K J 1/10W
R48			RK73GB2A103J	CHIP R	10K J 1/10W
R49			RK73GB2A473J	CHIP R	47K J 1/10W
R50			RK73GB2A392J	CHIP R	3.9K J 1/10W
R51			RK73GB2A103J	CHIP R	10K J 1/10W
R52,53			RK73GB2A472J	CHIP R	4.7K J 1/10W
R71			RK73GB2A133J	CHIP R	13K J 1/10W
R72			RK73FB2B201J	CHIP R	200 J 1/8W
R81,82			RK73FB2B183J	CHIP R	18K J 1/8W
R83,84			RK73FB2B203J	CHIP R	20K J 1/8W
R85,86			RK73FB2B123J	CHIP R	12K J 1/8W
R87,88			RK73FB2B331J	CHIP R	330 J 1/8W
R89,90			RK73GB2A392J	CHIP R	3.9K J 1/10W
R91,92			RK73GB2A562J	CHIP R	5.6K J 1/10W
R100			RK73GB2A100J	CHIP R	10 J 1/10W
S1,2			S68-0863-05	PUSH SWITCH	

E : Europe K : North America  
M : Other Areas W : Without Europe

K2 : KDC-328  
K3 : KDC-3028

△ Indicates safety critical components.

## PARTS LIST

### CD PLAYER UNIT (X32-5750-00)

Ref. No.	A d d	N e w	Parts No.	Description	Desti- nation
S3			S68-0862-05	PUSH SWITCH	
D1			DAN202U	DIODE	
D2			MAZS0510L	ZENER DIODE	
D3			DA204U	DIODE	
IC1			AN22002A-V	ANALOGUE IC	
IC2			MN6627771KP	MOS-IC	
IC3			BA5824FP	ANALOGUE IC	
IC4			NJM4580M1-ZB	ANALOGUE IC	
Q1			2SB0970	TRANSISTOR	
Q2			2SA1362(Y)	TRANSISTOR	
Q3			DTC124EUA	DIGITAL TRANSISTOR	
Q4			DTA143XUA	DIGITAL TRANSISTOR	
Q5			2SC4081	TRANSISTOR	
Q6			2SA1576A	TRANSISTOR	
<b>ELECTRIC UNIT (X34-3390-1x)</b>					
D166		*	B30-1710-05	LED (RED)	
C1,2			CD04AT1HR47M	ELECTRO 0.47UF 50WV	
C3-6			C90-5684-05	NP-ELECT 0.22UF 50WV	
C3-6			C90-6735-05	NP-ELECT 0.22UF 50WV	
C20			C90-5686-05	ELECTRO 100UF 16WV	
C51			C90-6746-05	ELECTRO 3300UF 16WV	
C52,53			CK73GB1H102K	CHIP C 1000PF K	
C54,55			CK73GB1H103K	CHIP C 0.010UF K	
C69			CK73GB1A474K	CHIP C 0.47UF K	
C71			CD04AS1C470M	ELECTRO 47UF 16WV	
C72,73			CD04AS1E100M	ELECTRO 10UF 25WV	
C74,75			CD04AS1C100M	ELECTRO 10UF 16WV	
C76			CD04BH1A100M	ELECTRO 10UF 10WV	
C77			CD04AT1H100M	ELECTRO 10UF 50WV	
C78			CD04BF1C221M	ELECTRO 220UF 16WV	
C79			CD04AS1C100M	ELECTRO 10UF 16WV	
C80			CD04BF1C221M	ELECTRO 220UF 16WV	
C81,82			CK73GB1H103K	CHIP C 0.010UF K	
C96			CD04AS1HR47M	ELECTRO 0.47UF 50WV	
C97			CD04BF1C220M	ELECTRO 22UF 16WV	
C151			CK73GB1H103K	CHIP C 0.010UF K	
C153			CK73GB0J105K	CHIP C 1.0UF K	
C201			CK73GB1H103K	CHIP C 0.010UF K	
C255			CD04AS1A330M	ELECTRO 33UF 10WV	
C256			CD04AS1H010M	ELECTRO 1UF 50WV	
C257			C90-5663-05	ELECTRO 1UF 50WV	
C258			CD04AS1H010M	ELECTRO 1UF 50WV	
C301,302			CK73FB1C474K	CHIP C 0.47UF K	
C303			CD04AT1A470M	ELECTRO 47UF 10WV	
C331,332			CD04AT1C100M	ELECTRO 10UF 16WV	
C407			CC73GCH1H220J	CHIP C 22PF J	
C408			CC73GCH1H180J	CHIP C 18PF J	
C409			CD04AS0J470M	ELECTRO 47UF 6.3WV	
C410			CK73GB1H103K	CHIP C 0.010UF K	
C411			CK73GB1A224K	CHIP C 0.22UF K	
C420			CC73GCH1H102J	CHIP C 1000PF J	
C422			CC73GCH1H101J	CHIP C 100PF J	
C502			CK73GB1H152K	CHIP C 1500PF K	

Ref. No.	A d d	N e w	Parts No.	Description	Desti- nation
C503			CK73GB1C104K	CHIP C 0.10UF K	
C504			CK73GB1H103K	CHIP C 0.010UF K	
C505			CD04AT1C4R7M	ELECTRO 4.7UF 16WV	
C506			CK73GB1A684K	CHIP C 0.68UF K	
C507,508			CD04AT1A220M	ELECTRO 22UF 10WV	
C509			CC73GCH1H680J	CHIP C 68PF J	
C510			CC73GCH1H101J	CHIP C 100PF J	
C511			CK73GB1H103K	CHIP C 0.010UF K	
C512			CD04AT1C100M	ELECTRO 10UF 16WV	
C513,514			CK73GB1H103K	CHIP C 0.010UF K	
C515			CD04AT1H010M	ELECTRO 1UF 50WV	
C516			CC73GCH1H100D	CHIP C 10PF D	
C517,518			CK73GB1A105K	CHIP C 1.0UF K	
C519,520			CK73GB1A474K	CHIP C 0.47UF K	
C521,522			CC73GCH1H102J	CHIP C 1000PF J	
C524			CC73GCH1H180J	CHIP C 18PF J	
C525			CC73GCH1H150J	CHIP C 15PF J	
C527			CC73GCH1H102J	CHIP C 1000PF J	
C531			CK73GB1A105K	CHIP C 1.0UF K	
C541			CC73GCH1H271J	CHIP C 270PF J	
C542			CC73GCH1H050C	CHIP C 5.0PF C	
C543			CC73GCH1H080D	CHIP C 8.0PF D	
C544			CC73GCH1H150J	CHIP C 15PF J	
C545			CK73GB1H682K	CHIP C 6800PF K	
C547			CD04AT1A220M	ELECTRO 22UF 10WV	
C548			CK73GB1E223K	CHIP C 0.022UF K	
C548			CK73GB1H223K	CHIP C 0.022UF K	
C549			CK73GB1H222K	CHIP C 2200PF K	
C550			CK73GB1E333K	CHIP C 0.033UF K	
C550			CK73GB1H333K	CHIP C 0.033UF K	
C551			CK73GB1H103K	CHIP C 0.010UF K	
C552			CK73GB1H222K	CHIP C 2200PF K	
C553			CK73GB1C104K	CHIP C 0.10UF K	
C554			CK73GB1A334K	CHIP C 0.33UF K	
C556			CK73GB1H103K	CHIP C 0.010UF K	
C559			CK73GB1H332K	CHIP C 3300PF K	
C561			CK73GB1C104K	CHIP C 0.10UF K	
C562			CD04AT1A100M	ELECTRO 10UF 10WV	
C563			CD04AT1HR47M	ELECTRO 0.47UF 50WV	
C564			CK73GB1A474K	CHIP C 0.47UF K	
C565			CK73FB1C105K	CHIP C 1.0UF K	
C568			CC73GCH1H271J	CHIP C 270PF J	
C579			CK73GB1H103K	CHIP C 0.010UF K	
C580			CC73GCH1H470J	CHIP C 47PF J	
C581			CC73GCH1H101J	CHIP C 100PF J	
C582			CK73GB1E223K	CHIP C 0.022UF K	
C582			CK73GB1H223K	CHIP C 0.022UF K	
C583			CK73GB1C683K	CHIP C 0.068UF K	
C583			CK73GB1H683K	CHIP C 0.068UF K	
C584,585			CK73GB1A105K	CHIP C 1.0UF K	
C586			CK73GB0J105K	CHIP C 1.0UF K	
C587			CK73GB1C104K	CHIP C 0.10UF K	
C588			CK73GB1A474K	CHIP C 0.47UF K	
C589			CK73GB1C104K	CHIP C 0.10UF K	
C590			CK73GB1H392K	CHIP C 3900PF K	

E : Europe K : North America  
M : Other Areas W : Without Europe

K2 : KDC-328  
K3 : KDC-3028

△ Indicates safety critical components.

## PARTS LIST

### ELECTRIC UNIT (X34-3390-1x)

Ref. No.	Add	New	Parts No.	Description	Destination	Ref. No.	Add	New	Parts No.	Description	Destination
C600			CD04AT1A101M	ELECTRO 100UF 10WV		R54			RK73FB2B203J	CHIP R 20K J 1/8W	
C601			CK73GB1E223K	CHIP C 0.022UF K		R55,56			RK73GB2A103J	CHIP R 10K J 1/10W	
C601			CK73GB1H223K	CHIP C 0.022UF K		R57			RK73GB2A223J	CHIP R 22K J 1/10W	
C602			CC73GCH1H151J	CHIP C 150PF J		R58			RD14DB2H332J	SMALL-RD 3.3K J 1/2W	
C603			CC73GCH1H030C	CHIP C 3.0PF C		R59			RD14BB2C333J	RD 33K J 1/6W	
C604			CC73GCH1H470J	CHIP C 47PF J		R60			RK73GB2A103J	CHIP R 10K J 1/10W	
C605,606			CC73GCH1H010C	CHIP C 1.0PF C		R61			RK73GB2A223J	CHIP R 22K J 1/10W	
C610			CC73GCH1H010C	CHIP C 1.0PF C		R62			RK73GB2A473J	CHIP R 47K J 1/10W	
C620			CK73GB1A105K	CHIP C 1.0UF K		R63			RK73GB2A562J	CHIP R 5.6K J 1/10W	
C623,624			CK73GB1H103K	CHIP C 0.010UF K		R72,73			RD14BB2C472J	RD 4.7K J 1/6W	
C625-627			CC73GCH1H101J	CHIP C 100PF J		R75-78			RK73GB2A103J	CHIP R 10K J 1/10W	
C628			CK73GB1A105K	CHIP C 1.0UF K		R81			RD14BB2C103J	RD 10K J 1/6W	
C632			CK73GB1H102K	CHIP C 1000PF K		R82			RK73GB2A223J	CHIP R 22K J 1/10W	
CN2			E41-2244-05	FLAT CABLE CONNECTOR		R83			RK73GB2A473J	CHIP R 47K J 1/10W	
△ J1			E58-0991-05	RECTANGULAR RECEPTACLE		R84-90			RK73GB2A1R0J	CHIP R 1.0 J 1/10W	
J2			E56-0855-05	CYLINDRICAL RECEPTACLE		R96			RK73GH2A273D	CHIP R 27K D 1/10W	
J4			E04-0326-05	RF COAXIAL CABLE RECEPTACLE		R97			RK73GH2A332D	CHIP R 3.3K D 1/10W	
J5			E58-0992-05	RECTANGULAR RECEPTACLE		R98			RK73GB2A102J	CHIP R 1.0K J 1/10W	
J6			E63-0898-05	PIN JACK		R100			RK73GB2A272J	CHIP R 2.7K J 1/10W	
WH1			E39-0717-05	WIRING HARNESS	K3	R130-141			RK73EB2E2R2J	CHIP R 2.2 J 1/4W	
CF51-53			L72-0805-05	CERAMIC FILTER		R151			RK73GB2A102J	CHIP R 1.0K J 1/10W	
CF54			L72-0804-05	CERAMIC FILTER		R152			RK73EB2E100J	CHIP R 10 J 1/4W	
L2			L33-1983-05	CHOKE COIL (27UH)		R153			RK73EB2E471J	CHIP R 470 J 1/4W	
L4			L33-2260-05	CHOKE COIL		R156,157			RK73EB2E102J	CHIP R 1.0K J 1/4W	
L51			L33-1988-05	CHOKE COIL ASSY (140UH)		R158			RK73EB2E101J	CHIP R 100 J 1/4W	
L61			L40-4795-91	SMALL FIXED INDUCTOR (4.7UH)		R159			RK73EB2E102J	CHIP R 1.0K J 1/4W	
L301			L92-0337-05	CHIP FERRITE		R160,161			RK73EB2E471J	CHIP R 470 J 1/4W	
L501			L40-6891-58	SMALL FIXED INDUCTOR (6.8UH)		R162			RK73EB2E102J	CHIP R 1.0K J 1/4W	
L502			L40-3301-58	SMALL FIXED INDUCTOR (33UH)		R163			RK73EB2E471J	CHIP R 470 J 1/4W	
L503			L40-1021-56	SMALL FIXED INDUCTOR (1000UH)		R164			RK73EB2E102J	CHIP R 1.0K J 1/4W	
L504			L40-1011-58	SMALL FIXED INDUCTOR (100UH)		R172			RK73EB2E102J	CHIP R 1.0K J 1/4W	
L505			L40-3381-58	SMALL FIXED INDUCTOR (0.33UH)		R178			RK73GB2A471J	CHIP R 470 J 1/10W	
L506			L31-0977-15	FM-RF COIL		R180-182			RK73GB2A222J	CHIP R 2.2K J 1/10W	
L507			L32-0941-15	FM OSCILLATING COIL		R183,184			RK73GB2A102J	CHIP R 1.0K J 1/10W	
L508			L30-0776-15	FM IFT		R185			RK73GB2A473J	CHIP R 47K J 1/10W	
L509			L30-0777-15	AM IFT		R186			RK73GB2A241J	CHIP R 240 J 1/10W	
L518			L31-0976-15	FM-RF COIL		R190			RK73GB2A104J	CHIP R 100K J 1/10W	
L520			L40-3381-58	SMALL FIXED INDUCTOR (0.33UH)		R191			RK73GB2A225J	CHIP R 2.2M J 1/10W	
L521			L40-1073-72	SMALL FIXED INDUCTOR (10NH)		R193,194			RK73GB2A474J	CHIP R 470K J 1/10W	
L600			L92-0607-05	CHIP FERRITE		R195			RK73GB2A152J	CHIP R 1.5K J 1/10W	
L601,602			L92-0397-05	CHIP FERRITE		R196			RK73GB2A472J	CHIP R 4.7K J 1/10W	
L604,605			L92-0609-05	CHIP FERRITE		R197			RK73GB2A102J	CHIP R 1.0K J 1/10W	
X1			L78-0879-05	RESONATOR (10.0MHZ)		R198			RK73GB2A474J	CHIP R 470K J 1/10W	
X2			L77-2793-05	CRYSTAL RESONATOR (32.768KHZ)		R251			RK73GB2A333J	CHIP R 33K J 1/10W	
X501			L77-2077-05	CRYSTAL RESONATOR (10.250MHZ)		R252			RK73GB2A473J	CHIP R 47K J 1/10W	
G	2D		N80-3010-48	PAN HEAD TAPTITE SCREW		R253			RK73GB2A432J	CHIP R 4.3K J 1/10W	
J	2D		N83-3005-48	PAN HEAD TAPTITE SCREW		R254			RK73GB2A100J	CHIP R 10 J 1/10W	
K	2D		N83-3020-48	PAN HEAD TAPTITE SCREW		R255			RK73GB2A221J	CHIP R 220 J 1/10W	
M	3D		N86-2606-48	BINDING HEAD TAPTITE SCREW		R256			RK73GB2A223J	CHIP R 22K J 1/10W	
R1,2			RK73GB2A101J	CHIP R 100 J 1/10W		R257			RK73GB2A303J	CHIP R 30K J 1/10W	
R21			RD14BB2C152J	RD 1.5K J 1/6W		R271			RK73GB2A101J	CHIP R 100 J 1/10W	
R51			RK73FB2B683J	CHIP R 68K J 1/8W		R272			RK73GB2A103J	CHIP R 10K J 1/10W	
R52			RK73GB2A393J	CHIP R 39K J 1/10W		R273			RK73GB2A474J	CHIP R 470K J 1/10W	
R53			RK73GB2A104J	CHIP R 100K J 1/10W		R301,302			RK73EB2E100J	CHIP R 10 J 1/4W	
						R303			RK73EB2E101J	CHIP R 100 J 1/4W	

E : Europe K : North America  
M : Other Areas W : Without Europe

K2 : KDC-328  
K3 : KDC-3028

△ Indicates safety critical components.

## PARTS LIST

### ELECTRIC UNIT (X34-3390-1x)

Ref. No.	A d d	N e w	Parts No.	Description	Desti- nation
R304,305			RK73EB2E472J	CHIP R 4.7K J 1/4W	
R306			RK73EB2E4R7J	CHIP R 4.7 J 1/4W	
R307-309			RK73EB2E472J	CHIP R 4.7K J 1/4W	
R310,311			RK73EB2E101J	CHIP R 100 J 1/4W	
R312			RK73GB2A104J	CHIP R 100K J 1/10W	
R313			RD14BB2C104J	RD 100K J 1/6W	
R331,332			RK73GB2A271J	CHIP R 270 J 1/10W	
R335,336			RK73GB2A303J	CHIP R 30K J 1/10W	
R338,339			RD14BB2C101J	RD 100 J 1/6W	
R351,352			RK73GB2A222J	CHIP R 2.2K J 1/10W	
R353			RK73GB2A102J	CHIP R 1.0K J 1/10W	
R355,356			RK73GB2A102J	CHIP R 1.0K J 1/10W	
R358			RK73GB2A222J	CHIP R 2.2K J 1/10W	
R359			RK73GB2A101J	CHIP R 100 J 1/10W	
R360			RK73GB2A222J	CHIP R 2.2K J 1/10W	
R363			RK73GB2A472J	CHIP R 4.7K J 1/10W	
R365			RK73GB2A472J	CHIP R 4.7K J 1/10W	
R366			RK73EB2E472J	CHIP R 4.7K J 1/4W	
R367			RK73GB2A104J	CHIP R 100K J 1/10W	
R368,369			RK73GB2A471J	CHIP R 470 J 1/10W	
R370,371			RK73GB2A472J	CHIP R 4.7K J 1/10W	
R411			RK73GB2A223J	CHIP R 22K J 1/10W	
R413			RK73GB2A223J	CHIP R 22K J 1/10W	
R415			RK73GB2A223J	CHIP R 22K J 1/10W	
R417,418			RK73GB2A223J	CHIP R 22K J 1/10W	
R432			RK73GB2A472J	CHIP R 4.7K J 1/10W	
R433			RK73GB2A222J	CHIP R 2.2K J 1/10W	
R435,436			RK73GB2A103J	CHIP R 10K J 1/10W	
R437,438			RK73GB2A102J	CHIP R 1.0K J 1/10W	
R439			RK73GB2A222J	CHIP R 2.2K J 1/10W	
R440,441			RK73GB2A473J	CHIP R 47K J 1/10W	
R450-452			RK73GB2A471J	CHIP R 470 J 1/10W	
R453			RK73GB2A473J	CHIP R 47K J 1/10W	
R454			RK73GB2A472J	CHIP R 4.7K J 1/10W	
R456			RK73GB2A104J	CHIP R 100K J 1/10W	
R457			RK73GB2A103J	CHIP R 10K J 1/10W	
R471			RK73GB2A103J	CHIP R 10K J 1/10W	
R480			RK73GB2A104J	CHIP R 100K J 1/10W	
R501			RK73GB2A682J	CHIP R 6.8K J 1/10W	
R502,503			RK73GB2A222J	CHIP R 2.2K J 1/10W	
R504			RK73GB2A4R7J	CHIP R 4.7 J 1/10W	
R505			RK73GB2A102J	CHIP R 1.0K J 1/10W	
R506			RK73GB2A105J	CHIP R 1.0M J 1/10W	
R507			RK73GB2A102J	CHIP R 1.0K J 1/10W	
R520			RK73GB2A221J	CHIP R 220 J 1/10W	
R521			RK73GB2A152J	CHIP R 1.5K J 1/10W	
R522			RK73GB2A223J	CHIP R 22K J 1/10W	
R523			RK73GB2A100J	CHIP R 10 J 1/10W	
R543			RK73GB2A562J	CHIP R 5.6K J 1/10W	
R544			RD14BB2C222J	RD 2.2K J 1/6W	
R545			RK73GB2A333J	CHIP R 33K J 1/10W	
R546			RK73GB2A432J	CHIP R 4.3K J 1/10W	
R561			RK73GB2A472J	CHIP R 4.7K J 1/10W	
R562			RK73GB2A106J	CHIP R 10M J 1/10W	
R565			RK73GB2A394J	CHIP R 390K J 1/10W	

Ref. No.	A d d	N e w	Parts No.	Description	Desti- nation
R566,567			RK73GB2A102J	CHIP R 1.0K J 1/10W	
R589			RK73GB2A473J	CHIP R 47K J 1/10W	
R590			RK73GB2A103J	CHIP R 10K J 1/10W	
R591			RK73GB2A513J	CHIP R 51K J 1/10W	
R592			RK73GB2A223J	CHIP R 22K J 1/10W	
R594			RK73EB2E100J	CHIP R 10 J 1/4W	
R596-598			RD14BB2C100J	RD 10 J 1/6W	
R599			RK73GB2A220J	CHIP R 22 J 1/10W	
R600			RD14BB2C2R2J	RD 2.2 J 1/6W	
R601			RD14BB2C1R0J	RD 1.0 J 1/6W	
R602			RK73GB2A122J	CHIP R 1.2K J 1/10W	
R603			RK73GB2A560J	CHIP R 56 J 1/10W	
R605,606			RK73GB2A100J	CHIP R 10 J 1/10W	
W52			R92-2053-05	CHIP R 0 OHM J 1/8W	
W53			R92-1252-05	CHIP R 0 OHM J 1/16W	
W54			R92-2053-05	CHIP R 0 OHM J 1/8W	
W56			R92-2053-05	CHIP R 0 OHM J 1/8W	
W58-60			R92-1252-05	CHIP R 0 OHM J 1/16W	
W62,63			R92-2053-05	CHIP R 0 OHM J 1/8W	
W64			R92-1252-05	CHIP R 0 OHM J 1/16W	
W65,66			R92-2053-05	CHIP R 0 OHM J 1/8W	
W71			R92-1252-05	CHIP R 0 OHM J 1/16W	
W72			R92-2053-05	CHIP R 0 OHM J 1/8W	
W73			R92-1252-05	CHIP R 0 OHM J 1/16W	
W75			R92-2053-05	CHIP R 0 OHM J 1/8W	
W76			R92-1252-05	CHIP R 0 OHM J 1/16W	
W78			R92-2053-05	CHIP R 0 OHM J 1/8W	
W79			R92-1252-05	CHIP R 0 OHM J 1/16W	
W82			R92-2053-05	CHIP R 0 OHM J 1/8W	
W83			R92-1252-05	CHIP R 0 OHM J 1/16W	
W91			R92-2053-05	CHIP R 0 OHM J 1/8W	
W93			R92-2053-05	CHIP R 0 OHM J 1/8W	
W96,97			R92-1252-05	CHIP R 0 OHM J 1/16W	
W98			R92-2053-05	CHIP R 0 OHM J 1/8W	
W99,100			R92-1252-05	CHIP R 0 OHM J 1/16W	
W102,103			R92-2053-05	CHIP R 0 OHM J 1/8W	
W252			R92-1252-05	CHIP R 0 OHM J 1/16W	
W506			R92-2053-05	CHIP R 0 OHM J 1/8W	
W604,605			R92-1252-05	CHIP R 0 OHM J 1/16W	
W611			R92-1252-05	CHIP R 0 OHM J 1/16W	
W802			R92-1252-05	CHIP R 0 OHM J 1/16W	
W803			R92-2053-05	CHIP R 0 OHM J 1/8W	
W804-807			R92-1252-05	CHIP R 0 OHM J 1/16W	
W808			R92-2053-05	CHIP R 0 OHM J 1/8W	
W810			R92-1252-05	CHIP R 0 OHM J 1/16W	
W812			R92-2053-05	CHIP R 0 OHM J 1/8W	
W814			R92-2053-05	CHIP R 0 OHM J 1/8W	
W820			R92-2053-05	CHIP R 0 OHM J 1/8W	
W823			R92-1252-05	CHIP R 0 OHM J 1/16W	
W826,827			R92-2053-05	CHIP R 0 OHM J 1/8W	
W831			R92-1252-05	CHIP R 0 OHM J 1/16W	
W832			R92-2053-05	CHIP R 0 OHM J 1/8W	
W838			R92-1252-05	CHIP R 0 OHM J 1/16W	
S151		*	S74-0822-05	MICRO SWITCH	

E : Europe K : North America  
M : Other Areas W : Without Europe

K2 : KDC-328  
K3 : KDC-3028

△ Indicates safety critical components.

## PARTS LIST

### ELECTRIC UNIT (X34-3390-1x)

Ref. No.	Add	New	Parts No.	Description	Destination
S152		*	S70-0931-05	TACT SWITCH	
D3			IMSA-6801-E	SURGE ABSORBER	
D52			MAZ4068N-M	ZENER DIODE	
D53			UDZS6.8B	ZENER DIODE	
D53			02DZ6.8F-Y	ZENER DIODE	
D54			MAZ4068N-M	ZENER DIODE	
D55			1SS355	DIODE	
D57			S2V60*A	DIODE	
D71			MAZ4082N-L	ZENER DIODE	
D72			D1F60-5063	DIODE	
D72			1SR154-400	DIODE	
D73			AM01ZNF	DIODE	
D73			10EDA20	DIODE	
D74,75			D1F60-5063	DIODE	
D74,75			1SR154-400	DIODE	
D76			DAN202U	DIODE	
D76			KDS121-P	DIODE	
D76			MC2848	DIODE	
D81			UDZS4.7B	ZENER DIODE	
D81			02DZ4.7F-Y	ZENER DIODE	
D162			STZ6.2N	ZENER DIODE	
D203			1SS133	DIODE	
D251-253			D1F60-5063	DIODE	
D251-253			1SR154-400	DIODE	
D254			AM01ZNF	DIODE	
D254			10EDA20	DIODE	
D255-258			D1F60-5063	DIODE	
D255-258			1SR154-400	DIODE	
D259,260			1SS133	DIODE	
D261			1SS355	DIODE	
D301-304			MAZ4062-L	ZENER DIODE	
D305,306			MAZ4068N-M	ZENER DIODE	
D402,403			DAN202U	DIODE	
D402,403			KDS121-P	DIODE	
D402,403			MC2848	DIODE	
D501			RN739F	DIODE	
D502,503			KP2311ETR-G	DIODE	
D504			KV1430STL-G	VARIABLE CAPACITANCE DIODE	
D506			HVC383B-E	VARIABLE CAPACITANCE DIODE	
IC1			784225GC255A	MICROCONTROLLER IC	
IC3			BA4911-V4	ANALOGUE IC	
IC4			E-TDA7560A	ANALOGUE IC	
IC6			TC7W02FU-F	MOS-IC	
IC8			S-80836CNNB-J	MOS-IC	
IC10			E-TDA7516	ANALOGUE IC	
IC11			BR24L04FV-W	ROM IC	
IC15			BA00CCWT	ANALOGUE IC	
Q51-53			2SC4081	TRANSISTOR	
Q54			2SA1036K	TRANSISTOR	
Q71			UMC2N	DIGITAL TRANSISTOR	
Q72			2SB1565(E,F)	TRANSISTOR	
Q73			2SD1858	TRANSISTOR	
Q74			UMC2N	DIGITAL TRANSISTOR	
Q151			DTA114YUA	DIGITAL TRANSISTOR	

Ref. No.	Add	New	Parts No.	Description	Destination
Q151			KRA307-P	DIGITAL TRANSISTOR	
Q151			RT1P144M	DIGITAL TRANSISTOR	
Q152			2SA1577	TRANSISTOR	
Q153			DTC114YUA	DIGITAL TRANSISTOR	
Q153			KRC407-P	DIGITAL TRANSISTOR	
Q153			RT1N144M	DIGITAL TRANSISTOR	
Q156			2SC4081	TRANSISTOR	
Q252			KTA2014P(Y,GR)	TRANSISTOR	
Q252			2SA1576A	TRANSISTOR	
Q252			2SA1603A	TRANSISTOR	
Q330			DTA124EUA	DIGITAL TRANSISTOR	
Q330			KRA303-P	DIGITAL TRANSISTOR	
Q330			RT1P241M	DIGITAL TRANSISTOR	
Q351,352			DTC143TUA	DIGITAL TRANSISTOR	
Q351,352			KRC410-P	DIGITAL TRANSISTOR	
Q351,352			RT1N430M	DIGITAL TRANSISTOR	
Q501			HN3G01J(BL)-F	DIGITAL TRANSISTOR	
TH1			PRF21BE471QB2	POSITIVE RESISTOR	
<b>DAUGHTER UNIT (X89-2690-10)</b>					
C221,222			CD04AS1C100M	ELECTRO 10UF 16WV	K3
CN90			E41-0956-05	PIN ASSY	K3
CN91			E41-0930-05	PIN ASSY	K3
W101			E31-0001-00	JUMPER WIRE	K3
R221,222			RK73GB2A271J	CHIP R 270 J 1/10W	K3
R225,226			RK73GB2A303J	CHIP R 30K J 1/10W	K3
R229,230			RD14BB2C101J	RD 100 J 1/6W	K3
Q221,222			DTC143TUA	DIGITAL TRANSISTOR	K3
Q221,222			KRC410-P	DIGITAL TRANSISTOR	K3
Q221,222			RT1N430M	TRANSISTOR	K3
Q225			DTA124EUA	DIGITAL TRANSISTOR	K3
Q225			KRA303-P	DIGITAL TRANSISTOR	K3
Q225			RT1P241M	TRANSISTOR	K3
<b>MECHANISM ASSY (X92-5090-00)</b>					
2	1B		A10-4827-32	CHASSIS	
5	1B		D10-4576-83	ARM ASSY	
8	2A		D10-4579-23	LEVER ASSY	
10	2A		D10-4581-13	ARM	
11	2A		D10-4582-13	ARM	
12	3A		D10-4583-03	ARM	
13	3A		D10-4584-03	ARM	
14	3B		D10-4585-03	ARM	
15	2A		D10-4586-13	SLIDER	
16	3B		D10-4587-52	SLIDER	
17	2B		D10-4588-13	SLIDER	
18	2B		D10-4595-04	ARM	
19	2B		D10-4596-24	ARM	
22	2A		D13-2151-04	GEAR	
23	2B		D13-2152-04	GEAR	
24	3B		D13-2153-04	GEAR	
25	3B		D13-2154-04	GEAR	
26	3B		D13-2155-04	WORM	
27	2B		D13-2156-14	GEAR	

E : Europe K : North America  
M : Other Areas W : Without Europe

K2 : KDC-328  
K3 : KDC-3028

△ Indicates safety critical components.



CD RECEIVER

KDC-3028/328/MP4028/MP428  
/MP5029/MP6029  
/W5031/W5031Y/W531Y

# SERVICE MANUAL

# KENWOOD

Kenwood Corporation

© 2005-4 PRINTED IN JAPAN  
B53-0272-00 (N) 1708

## SWITCH UNIT (X16) TYPE 2

Illustration is KDC-3028

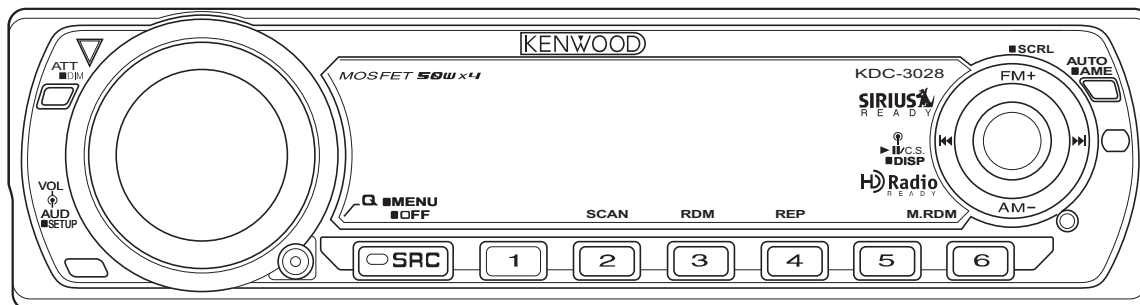

This service manual handles only switch unit (X16) for type 2.  
Besides, please refer to the service manual of each model.  
Switch unit (X16) has been changed from the following serial number to type 2.  
Following system microcomputer (IC1: X34) also changes at the same time as changing switch unit (X16).

MODEL	SERIAL No.	SWITCH UNIT (TYPE2 UNIT)	ELECTRIC UNIT	MCU IC (IC1:X34)	TDF NAME	TDF PANEL No.
KDC-328	50200001~	X16-3320-11	X34-3390-11	784225GC280A	TDF-53D/O	Y33-2230-66
KDC-3028	50100501~	X16-3320-11	X34-3390-12	784225GC280A	TDF-53DB/O	Y33-2230-67
KDC-MP4028	50200001~	X16-3320-10	X34-3380-10	30624MGPA44GP	TDF-MP54DB/O	Y33-2230-60
KDC-MP428	50200001~	X16-3320-10	X34-3380-11	30624MGPA44GP	TDF-MP54D/O	Y33-2230-62
KDC-MP5029	T0200001~	X16-3320-22	X34-3390-21	784225GC279A	TDF-MP5029/O	Y33-2230-63
KDC-MP6029	T0200001~	X16-3320-21	X34-3380-21	30624MGPA44GP	TDF-MP6029/O	Y33-2230-61
KDC-W5031	T0104001~	X16-3322-71	X34-3392-71	784225GC279A	TDF-W5031/O	Y33-2230-64
KDC-W5031Y	T0200001~	X16-3322-71	X34-3392-71	784225GC279A	TDF-W5031/O	Y33-2230-64
KDC-W531Y	T0200001~	X16-3322-72	X34-3392-72	784225GC279A	TDF-W531Y/O	Y33-2230-65

# PARTS LIST (KDC-3028/328/MP4028/MP428/MP5029/MP6029)

\* New parts

Parts without **Parts No.** are not supplied.

Les articles non mentionnés dans le **Parts No.** ne sont pas fournis.

Teile ohne **Parts No.** werden nicht geliefert.

Ref. No.	A d d	N e w	Parts No.	Description	Desti- nation
<b>SWITCH UNIT (X16-3320-xx)</b>					
D1-3			B30-1566-05	LED (1608, RED)	KK1M1
D4-6			B30-1565-05	LED (1608, PG)	M1M2
D7-9			B30-1566-05	LED (1608, RED)	KK1M1
D10-12			B30-1565-05	LED (1608, PG)	M1M2
D13-15			B30-1566-05	LED (1608, RED)	KK1M1
D16-18			B30-1565-05	LED (1608, PG)	M1M2
D19			B30-1566-05	LED (1608, RED)	
D20-24			B30-1729-05	LED (1608, BLUE)	
D25			B30-1566-05	LED (1608, RED)	KK1M1
D26			B30-1565-05	LED (1608, PG)	M1M2
C8			CK73FB1A225K	CHIP C 2.2UF K	
C10			CK73GB1H103K	CHIP C 0.010UF K	
C11			CC73GCH1H270J	CHIP C 27PF J	
C13-17			CK73GB1H103K	CHIP C 0.010UF K	
C19,20			CK73GB1H103K	CHIP C 0.010UF K	K1M2
C20			CK73GB1H104K	CHIP C 0.10UF K	KM1
C21			CK73FB1C105K	CHIP C 1.0UF K	M1M2
C22			CK73FB1C105K	CHIP C 1.0UF K	KK1M1
C27			CC73GCH1H471J	CHIP C 470PF J	
C28			CK73GB1H102K	CHIP C 1000PF K	
C29			CC73GCH1H471J	CHIP C 470PF J	
C30			CK73GB1A105K	CHIP C 1.0UF K	
C31			CC73GCH1H471J	CHIP C 470PF J	
J1			E59-0840-05	RECTANGULAR PLUG (15PIN)	
CP10,11			RK74HB1J102J	CHIP-COM 1.0K J 1/16W	
CP12			RK74GA1J101J	CHIP-COM 100 J 1/16W	KM1
CP12,13			RK74GA1J102J	CHIP-COM 1.0K J 1/16W	K1M2
CP901			RK74HB1J101J	CHIP-COM 100 J 1/16W	
R1			RK73EB2E101J	CHIP R 100 J 1/4W	KM1
R1			RK73EB2E472J	CHIP R 4.7K J 1/4W	K1M2
R2			RK73EB2E102J	CHIP R 1.0K J 1/4W	
R3-8			RK73EB2E101J	CHIP R 100 J 1/4W	
R9			RK73EB2E101J	CHIP R 100 J 1/4W	KM1
R9			RK73EB2E472J	CHIP R 4.7K J 1/4W	K1M2
R10			RK73GB2A103J	CHIP R 10K J 1/10W	
R11			RK73GB2A4R7J	CHIP R 4.7 J 1/10W	
R13			RK73GB2A102J	CHIP R 1.0K J 1/10W	
R14			RK73GB2A102J	CHIP R 1.0K J 1/10W	KM1
R15			RK73GB2A102J	CHIP R 1.0K J 1/10W	K1M2
R16			RK73GB2A102J	CHIP R 1.0K J 1/10W	
R20			RK73GB2A101J	CHIP R 100 J 1/10W	
R23			RK73GB2A473J	CHIP R 47K J 1/10W	
R24			RK73GB2A222J	CHIP R 2.2K J 1/10W	
R25,26			RK73GB2A473J	CHIP R 47K J 1/10W	
R27			RK73GB2A222J	CHIP R 2.2K J 1/10W	
R28,29			RK73GB2A473J	CHIP R 47K J 1/10W	
R30			RK73GB2A222J	CHIP R 2.2K J 1/10W	
R31			RK73GB2A473J	CHIP R 47K J 1/10W	
R51-53			RK73FB2B471J	CHIP R 470 J 1/8W	
R54			RK73EB2E681J	CHIP R 680 J 1/4W	
R55,56			RK73FB2B301J	CHIP R 300 J 1/8W	
R57			RK73EB2E681J	CHIP R 680 J 1/4W	

Ref. No.	A d d	N e w	Parts No.	Description	Desti- nation
R58			RK73GB2A473J	CHIP R 47K J 1/10W	M1M2
R59			RK73GB2A223J	CHIP R 22K J 1/10W	M1M2
R60			RK73GB2A222J	CHIP R 2.2K J 1/10W	M1M2
R61			RK73GB2A473J	CHIP R 47K J 1/10W	M1M2
R62			RK73GB2A223J	CHIP R 22K J 1/10W	KK1M1
R63			RK73GB2A473J	CHIP R 47K J 1/10W	KK1M1
R64			RK73GB2A222J	CHIP R 2.2K J 1/10W	KK1M1
R65			RK73GB2A473J	CHIP R 47K J 1/10W	KK1M1
R66			RK73GB2A223J	CHIP R 22K J 1/10W	M1M2
R67			RK73GB2A223J	CHIP R 22K J 1/10W	KK1M1
R73			RK73PB2H2R2J	CHIP R 2.2 J 1/2W	KM1
R73			RK73PB2H330J	CHIP R 33 J 1/2W	K1M2
R74,75			RK73PB2H220J	CHIP R 22 J 1/2W	K1M2
R76			RK73GB2A473J	CHIP R 47K J 1/10W	
R80			RK73GB2A222J	CHIP R 2.2K J 1/10W	
R81			RK73GB2A223J	CHIP R 22K J 1/10W	
R101			RK73GB2A473J	CHIP R 47K J 1/10W	
R102,103			RK73EB2E101J	CHIP R 100 J 1/4W	
W4			R92-1252-05	CHIP R 0 OHM J 1/16W	K1M2
W5			R92-1252-05	CHIP R 0 OHM J 1/16W	KM1
S2			S70-0106-05	TACT SWITCH	
S10			S70-0051-15	TACT SWITCH	
S27			S70-0051-15	TACT SWITCH	
S1			T99-0457-15	ROTARY ENCODER	
D101,102			AVRM1608180M6A	VARIATOR	
D104,105			AVRM1608180M6A	VARIATOR	
D107-109			AVRM1608180M6A	VARIATOR	
D111-114			AVRM1608180M6A	VARIATOR	
ED1			3-BT-225NM	FLUORESCENT INDICATOR TUBE	
IC2			PNA4S22M	ANALOGUE IC	
IC3		*	ML9228GAZ-A	MOS-IC	
Q4			RT1P141U	TRANSISTOR	
Q5			2SC4617	TRANSISTOR	K1M2
Q5			2SC5383(E,F)	TRANSISTOR	KM1
Q10			2SC4617	TRANSISTOR	M2
Q10			2SC5383(E,F)	TRANSISTOR	M1
Q11-14			2SA1774	TRANSISTOR	M2
Q11-14			2SA1989(Q,R,S)	TRANSISTOR	M1
Q12-14			2SA1774	TRANSISTOR	K1
Q12-14			2SA1989(Q,R,S)	TRANSISTOR	K
Q15			2SC4617	TRANSISTOR	K1
Q15			2SC5383(E,F)	TRANSISTOR	KM1
Q16			2SA1774	TRANSISTOR	K1
Q16			2SA1989(Q,R,S)	TRANSISTOR	KM1
<b>ELECTRIC UNIT (X34-3380-xx)</b>					
IC1		*	30624MGPA44GP	MCU IC	#
<b>ELECTRIC UNIT (X34-3390-xx)</b>					
IC1		*	784225GC280A	MCU IC	#

K : KDC-MP4028/MP428 K1 : KDC-3028/328 M1 : KDC-MP6029  
M2 : KDC-MP5029 # : Refer to cover page

△ Indicates safety critical components.