

## EXPLODED VIEW

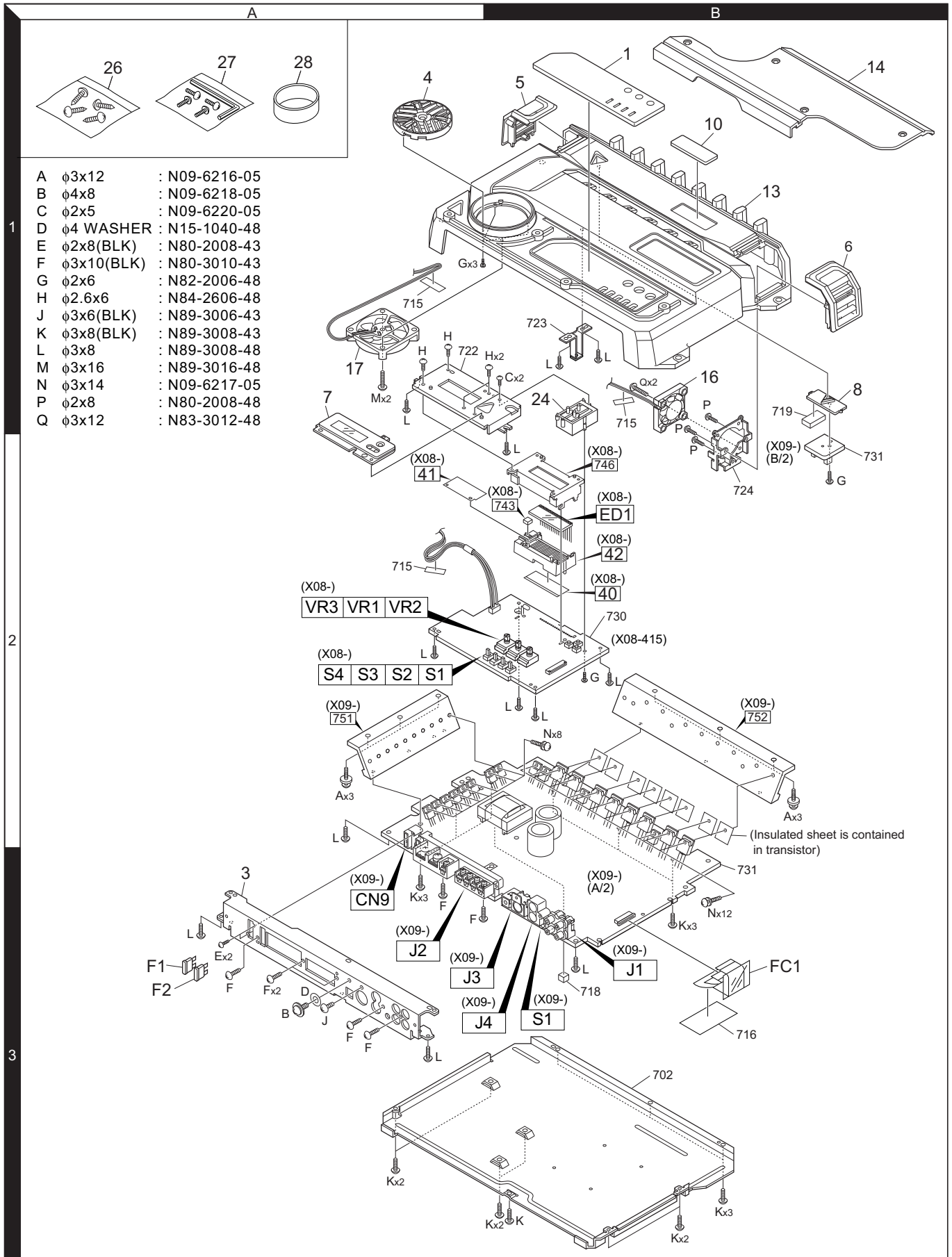

- |   |            |               |
|---|------------|---------------|
| A | φ3x12      | : N09-6216-05 |
| B | φ4x8       | : N09-6218-05 |
| C | φ2x5       | : N09-6220-05 |
| D | φ4 WASHER  | : N15-1040-48 |
| E | φ2x8(BLK)  | : N80-2008-43 |
| F | φ3x10(BLK) | : N80-3010-43 |
| G | φ2x6       | : N82-2006-48 |
| H | φ2.6x6     | : N84-2606-48 |
| J | φ3x6(BLK)  | : N89-3006-43 |
| K | φ3x8(BLK)  | : N89-3008-43 |
| L | φ3x8       | : N89-3008-48 |
| M | φ3x16      | : N89-3016-48 |
| N | φ3x14      | : N09-6217-05 |
| P | φ2x8       | : N80-2008-48 |
| Q | φ3x12      | : N83-3012-48 |

Parts with the exploded numbers larger than 700 are not supplied.

## PARTS LIST

\* New parts

Parts without **Parts No.** are not supplied.

Les articles non mentionnés dans le **Parts No.** ne sont pas fournis.

Teile ohne **Parts No.** werden nicht geliefert.

Ref. No.	Add	New	Parts No.	Description	Destination
<b>KAC-X522</b>					
1	1B	*	A21-6505-02	DRESSING PANEL	
3	3A	*	A64-3924-02	PANEL	
4	1A	*	B07-3176-03	ESCUTCHEON	
5	1B	*	B07-3177-02	ESCUTCHEON	
6	1B	*	B07-3178-02	ESCUTCHEON	
7	1A		B10-4717-03	FRONT GLASS	
8	1B		B19-2257-03	LIGHTING BOARD	
10	1B	*	B43-1537-04	BADGE	
-			B46-0682-00	WARRANTY CARD	
-		*	B64-3394-00	INST. MANUAL (ENG.FRE.SPA)	
FC1	3B		E39-0642-05	FLAT CABLE	
13	1B	*	F01-3533-01	HEAT SINK	
14	1B	*	F07-1177-02	COVER (TERMINAL COVER)	
16	1B	*	F09-1846-15	FAN (SIDE) (40X40X10)	
17	1A		F09-1885-15	FAN (TOP) (60X60X11.5)	
F1,2	3A		F52-0015-05	FUSE (BLADE TYPE) (30A)	
-			H10-4894-13	POLYSTYRENE FOAMED FIXTURE	
-			H13-2055-04	CARTON BOARD	
-			H25-1199-04	PROTECTION BAG	
-		*	H25-1200-04	PROTECTION BAG (250X350X0.03)	
-		*	H54-3782-03	ITEM CARTON CASE	
24	1B		K24-4146-03	PUSH KNOB (VR CAP)	
26	1A		N99-1577-15	SCREW SET	
27	1A		N99-1770-15	SCREW & WRENCH KEY SET	
A	2A		N09-6216-05	TAPTITE SCREW (3X12)	
B	3A		N09-6218-05	TAPTITE SCREW (4X8)	
C	1B		N09-6220-05	MACHINE SCREW (2X5)	
D	3A		N15-1040-48	FLAT WASHER	
E	3A		N80-2008-43	PAN HEAD TAPTITE SCREW	
F	3A		N80-3010-43	PAN HEAD TAPTITE SCREW	
G	1A		N82-2006-48	BINDING HEAD TAPTITE SCREW	
H	1A		N84-2606-48	PAN HEAD TAPTITE SCREW	
J	3A		N89-3006-43	BINDING HEAD TAPTITE SCREW	
K	3A		N89-3008-43	BINDING HEAD TAPTITE SCREW	
L	3A		N89-3008-48	BINDING HEAD TAPTITE SCREW	
M	1A		N89-3016-48	BINDING HEAD TAPTITE SCREW	
P	1B		N80-2008-48	PAN HEAD TAPTITE SCREW	
Q	1B		N83-3012-48	PAN HEAD TAPTITE SCREW	
28	1A		W01-1606-05	ACCESSORY	
<b>PREAMPLIFIER UNIT (X08-4150-11)</b>					
40	2B		B11-1446-04	REFLECTION SHEET	
41	2A		B11-1447-04	OPTICAL DIFFUSER	
42	2B		B19-2258-12	LIGHTING BOARD	
D2			B30-1641-05	LED	
ED1	2B		B38-1150-05	LCD ASSY	
C3-6			CK73FB1H224K	CHIP C 0.22UF K	
C9,10			CD04AS1H010M	ELECTRO 1UF 50WV	
C11-13			CK73GB1H103K	CHIP C 0.010UF K	
C15-20			CD04AS1V100M	ELECTRO 10UF 35WV	
C21,22			CK73GB1H104K	CHIP C 0.10UF K	

Ref. No.	Add	New	Parts No.	Description	Destination
C23,24			CK73FB1H224K	CHIP C 0.22UF K	
C25,26			CD04AS1V100M	ELECTRO 10UF 35WV	
C27,28			CK73GB1H103K	CHIP C 0.010UF K	
C29,30			CK73GB1H102K	CHIP C 1000PF K	
C31,32			CD04AS1V100M	ELECTRO 10UF 35WV	
C33			CK73GB1H104K	CHIP C 0.10UF K	
C34			CK73FB1E154K	CHIP C 0.15UF K	
C35			CK73GB1H223K	CHIP C 0.022UF K	
C37,38			CK73GB1H103K	CHIP C 0.010UF K	
C39			CD04AS1V100M	ELECTRO 10UF 35WV	
C40-45			CK73GB1H103K	CHIP C 0.010UF K	
C48,49			CK73GB1H103K	CHIP C 0.010UF K	
C61			CD04AS1V100M	ELECTRO 10UF 35WV	
C63-66			CK73FB1H224K	CHIP C 0.22UF K	
C67,68			CD04AS1V100M	ELECTRO 10UF 35WV	
C73			CK73GB1H104K	CHIP C 0.10UF K	
C74			CK73FB1E154K	CHIP C 0.15UF K	
C75			CK73GB1H333K	CHIP C 0.033UF K	
C101			CK73GB1H821K	CHIP C 820PF K	
C102,103			CK73GB1H473K	CHIP C 0.047UF K	
C104			CK73GB1H103K	CHIP C 0.010UF K	
C105			CD04AS1V100M	ELECTRO 10UF 35WV	
C107			CK73GB1H102K	CHIP C 1000PF K	
CN1			E41-2178-05	FLAT CABLE CONNECTOR (22P)	
CN2			E41-0941-05	PIN ASSY (2P)	
WH2			E39-0655-05	WIRING HARNESS	
R1,2			RK73GB2A473J	CHIP R 47K J 1/10W	
R3,4			RK73GB2A134J	CHIP R 130K J 1/10W	
R5,6			RK73GB2A223J	CHIP R 22K J 1/10W	
R7-12			RK73GB2A473J	CHIP R 47K J 1/10W	
R13			RD14BB2C391J	RD 390 J 1/6W	
R14-16			RK73GB2A101J	CHIP R 100 J 1/10W	
R17-20			RK73GB2A102J	CHIP R 1.0K J 1/10W	
R21,22			RK73GB2A103J	CHIP R 10K J 1/10W	
R23,24			RK73GB2A473J	CHIP R 47K J 1/10W	
R25,26			RK73GB2A563J	CHIP R 56K J 1/10W	
R27,28			RK73GB2A912J	CHIP R 9.1K J 1/10W	
R29,30			RK73GB2A822J	CHIP R 8.2K J 1/10W	
R31-33			RK73GB2A473J	CHIP R 47K J 1/10W	
R34			RK73GB2A103J	CHIP R 10K J 1/10W	
R38			RK73GB2A203J	CHIP R 20K J 1/10W	
R39,40			RK73GB2A471J	CHIP R 470 J 1/10W	
R41,42			RK73GB2A153J	CHIP R 15K J 1/10W	
R43			RK73GB2A332J	CHIP R 3.3K J 1/10W	
R44			RK73GB2A222J	CHIP R 2.2K J 1/10W	
R45			RK73GB2A153J	CHIP R 15K J 1/10W	
R46			RK73GB2A473J	CHIP R 47K J 1/10W	
R52			RK73GB2A473J	CHIP R 47K J 1/10W	
R55,56			RK73GB2A102J	CHIP R 1.0K J 1/10W	
R63,64			RK73GB2A563J	CHIP R 56K J 1/10W	
R65,66			RK73GB2A393J	CHIP R 39K J 1/10W	
R69,70			RK73GB2A103J	CHIP R 10K J 1/10W	
R72			RK73GB2A752J	CHIP R 7.5K J 1/10W	
R73			RK73GB2A103J	CHIP R 10K J 1/10W	

E : Europe K : North America M : Other Areas E : Without Europe

△ Indicates safety critical components.

## PARTS LIST

### PREAMPLIFIER UNIT (X08-4150-11)

Ref. No.	Add	New	Parts No.	Description	Destination
R74			RK73GB2A222J	CHIP R 2.2K J 1/10W	
R76			RK73GB2A224J	CHIP R 220K J 1/10W	
R77			RK73GB2A123J	CHIP R 12K J 1/10W	
R78			RK73GB2A101J	CHIP R 100 J 1/10W	
R79			RK73GB2A103J	CHIP R 10K J 1/10W	
R101-104			RK73GB2A471J	CHIP R 470 J 1/10W	
R105			RK73GB2A683J	CHIP R 68K J 1/10W	
R106			RK73GB2A472J	CHIP R 4.7K J 1/10W	
R107,108			RK73GB2A471J	CHIP R 470 J 1/10W	
R109-111			RK73GB2A102J	CHIP R 1.0K J 1/10W	
R112			RK73GB2A104J	CHIP R 100K J 1/10W	
R114,115			RK73GB2A103J	CHIP R 10K J 1/10W	
R116			RD14BB2C391J	RD 390 J 1/6W	
R117			RD14BB2C6R8J	RD 6.8 J 1/6W	
VR1	2A		R31-0241-05	VARIABLE RESISTOR 50K (C)	
VR2	2A		R31-0238-05	VARIABLE RESISTOR 10K (A)	
VR3	2A		R31-0241-05	VARIABLE RESISTOR 50K (C)	
S1-3	2A		S62-0873-05	SLIDE SWITCH	
S4	2A		S62-0874-05	SLIDE SWITCH	
S7-9			S70-0922-05	TACT SWITCH	
D1		*	02CZ8.2-F(Y)	ZENER DIODE	
IC1			NJM2058M-ZB	ANALOGUE IC	
IC3			E-TDA7409DTR	ANALOGUE IC	
IC4			NJM4565MD-ZB	ANALOGUE IC	
IC5			NJM2058M-ZB	ANALOGUE IC	
IC6			NJM4565MD-ZB	ANALOGUE IC	
IC7			LC75853NE-E	MOS-IC	
<b>AUDIO UNIT (X09-5760-11)</b>					
D13		*	B30-1743-05	LED (RED LED)	
C1,2			CK73GB1H471K	CHIP C 470PF K	
C3,4		*	CD04BJ1V100M	ELECTRO 10UF 35WV	
C5,6			CC73GCH1H150J	CHIP C 15PF J	
C11-14			CC73GCH1H150J	CHIP C 15PF J	
C15,16			CD04BJ1H220M	ELECTRO 22UF 50WV	
C17,18		*	CD04BJ1V100M	ELECTRO 10UF 35WV	
C19			CQ93FMG1H102J	MYLAR 1000PF J	
C21			CK73FB1H104K	CHIP C 0.10UF K	
C23,24			CK73FB1H104K	CHIP C 0.10UF K	
C51			C90-5557-05	ELECTRO 10UF 25WV	
C52			CD04BJ1E470M	ELECTRO 47UF 25WV	
C53			CK73GB1H102K	CHIP C 1000PF K	
C54			CD04BJ1E470M	ELECTRO 47UF 25WV	
C55,56			CD04BC1C392M	ELECTRO 3900UF 16WV	
C61		*	CD04BJ1V100M	ELECTRO 10UF 35WV	
C62			CK73GB1H103K	CHIP C 0.010UF K	
C63,64			CD04BJ1E470M	ELECTRO 47UF 25WV	
C65,66			CK73GB1H103K	CHIP C 0.010UF K	
C67,68		*	CD04BJ1V100M	ELECTRO 10UF 35WV	
C69			CD04BJ1H010M	ELECTRO 1.0UF 50WV	
C70			CD04BJ1E470M	ELECTRO 47UF 25WV	
C71			CK73GB1H104K	CHIP C 0.10UF K	
C72			CQ93FMG1H152J	MYLAR 1500PF J	
C73			CQ93FMG1H182J	MYLAR 1800PF J	

Ref. No.	Add	New	Parts No.	Description	Destination
C74			CD04BJ1E221M	ELECTRO 220UF 25WV	
C76		*	CD04BJ1V100M	ELECTRO 10UF 35WV	
C89			CQ93FMG1H152J	MYLAR 1500PF J	
C90,91			C90-5690-05	ELECTRO 4700UF 56WV	
C97,98			CK73GB1H221K	CHIP C 220PF K	
C99,100			CC73GCH1H220J	CHIP C 22PF J	
C101,102			CD04BJ1H220M	ELECTRO 22UF 50WV	
C103,104			CK45FB1H471K	CERAMIC 470PF K	
C105,106			CK73GB1H472K	CHIP C 4700PF K	
C107,108			CD04BJ1H010M	ELECTRO 1.0UF 50WV	
C109,110		*	CD04BJ1V100M	ELECTRO 10UF 35WV	
C111,112			CD04BJ1E470M	ELECTRO 47UF 25WV	
C115,116			CC45FSL1H331J	CERAMIC 330PF J	
C117-120			CC45FSL1H220J	CERAMIC 22PF J	
C121,122			CK45FB1H102K	CERAMIC 1000PF K	
C123,124			CC45FSL1H220J	CERAMIC 22PF J	
C125-128			CK73GB1H471K	CHIP C 470PF K	
C129-136			CK45FB1H471K	CERAMIC 470PF K	
C137			CD04BJ1J101M	ELECTRO 100UF 63WV	
C138			CD04BJ1H2R2M	ELECTRO 2.2UF 50WV	
C139		*	CD04BJ1A330M	ELECTRO 33UF 10WV	
C140			CD04BJ1E470M	ELECTRO 47UF 25WV	
C141			CD04BJ1A101M	ELECTRO 100UF 10WV	
C142			CK73GB1H103K	CHIP C 0.010UF K	
C143			CD04BJ1A101M	ELECTRO 100UF 10WV	
C145,146			CQ93FMG1H473J	MYLAR 0.047UF J	
C251,252			CK73GB1H103K	CHIP C 0.010UF K	
C301			C90-5557-05	ELECTRO 10UF 25WV	
C302,303			CK73GB1H104K	CHIP C 0.10UF K	
C306,307			CK73GB1H103K	CHIP C 0.010UF K	
C308		*	CD04BJ1V100M	ELECTRO 10UF 35WV	
C309-311			CK73GB1H103K	CHIP C 0.010UF K	
C313,314			CC73GCH1H101J	CHIP C 100PF J	
C343			CK73GB1H103K	CHIP C 0.010UF K	
C349,350		*	CD04BJ1V100M	ELECTRO 10UF 35WV	
C351			CD04BJ1E470M	ELECTRO 47UF 25WV	
C352		*	CD04BJ1V100M	ELECTRO 10UF 35WV	
C353,354			CK73GB1H103K	CHIP C 0.010UF K	
C358		*	CD04BJ1V100M	ELECTRO 10UF 35WV	
C401			CD04BJ1A101M	ELECTRO 100UF 10WV	
C402			CK73GB1H103K	CHIP C 0.010UF K	
C403			CD04BJ1H2R2M	ELECTRO 2.2UF 50WV	
C404,405			CC73GCH1H120J	CHIP C 12PF J	
C406			CK73GB1H103K	CHIP C 0.010UF K	
C451-453			CC73GCH1H101J	CHIP C 100PF J	
C454			CK73GB1H102K	CHIP C 1000PF K	
C458-461			CK73GB1H103K	CHIP C 0.010UF K	
CN1			E41-0928-05	PIN ASSY (3P)	
CN2			E41-0927-05	PIN ASSY (2P)	
CN10			E41-2202-05	FLAT CABLE CONNECTOR (22P)	
J1	3B		E63-0921-05	PIN JACK (4P)	
J2	3A		E70-0838-05	SCREW TERMINAL BOARD (7P)	
J3	3B		E56-0856-05	CYLINDRICAL RECEPTACLE (13P)	
J4	3B		E56-0853-05	CYLINDRICAL RECEPTACLE (4PX2)	

E : Europe K : North America M : Other Areas E : Without Europe

△ Indicates safety critical components.

## PARTS LIST

### AUDIO UNIT (X09-5760-11)

Ref. No.	Added	New	Parts No.	Description	Destination
△ CN9	3A		J13-0602-05	FUSE HOLDER	
L2			L33-1972-05	CHOKE COIL (25UH)	
L4			L19-0764-05	TRANSFORMER FOR CONVERTER	
L5			L19-0758-05	TRANSFORMER FOR CONVERTER	
L9			L41-4795-33	SMALL FIXED INDUCTOR (4.7UH)	
X1			L77-2844-05	CRYSTAL RESONATOR (12.288MHZ)	
F	3A		N80-3010-43	PAN HEAD TAPTITE SCREW	
K	3A		N89-3008-43	BINDING HEAD TAPTITE SCREW	
N	2B		N09-6217-05	TAPTITE SCREW (3X14)	
R1,2			RD14BB2C102J	RD 1.0K J 1/6W	
R3,4			RK73GB2A103J	CHIP R 10K J 1/10W	
R5,6			RK73GB2A102J	CHIP R 1.0K J 1/10W	
R7-10			RK73GB2A103J	CHIP R 10K J 1/10W	
R11-18			RK73GH2A103D	CHIP R 10K D 1/10W	
R21-23			RK73GB2A102J	CHIP R 1.0K J 1/10W	
R51			RK73GB2A104J	CHIP R 100K J 1/10W	
R52			RK73GB2A333J	CHIP R 33K J 1/10W	
R53			RK73GB2A682J	CHIP R 6.8K J 1/10W	
R54			RK73GB2A153J	CHIP R 15K J 1/10W	
R55,56			RK73GB2A152J	CHIP R 1.5K J 1/10W	
R57,58			RK73GB2A560J	CHIP R 56 J 1/10W	
R59,60			RK73GB2A100J	CHIP R 10 J 1/10W	
R61,62			RK73GB2A472J	CHIP R 4.7K J 1/10W	
R65,66			RD14NB2E100J	RD 10 J 1/4W	
R67			RK73GB2A821J	CHIP R 820 J 1/10W	
R69			RK73GB2A103J	CHIP R 10K J 1/10W	
R70			RK73GB2A101J	CHIP R 100 J 1/10W	
R71			RK73GB2A103J	CHIP R 10K J 1/10W	
R72			RK73GB2A472J	CHIP R 4.7K J 1/10W	
R73			RD14DB2H100J	SMALL-RD 10 J 1/2W	
R74			RK73GB2A104J	CHIP R 100K J 1/10W	
R76			RK73GB2A102J	CHIP R 1.0K J 1/10W	
R77			RK73GB2A511J	CHIP R 510 J 1/10W	
R79			RK73GB2A103J	CHIP R 10K J 1/10W	
R80			RK73GB2A473J	CHIP R 47K J 1/10W	
R81			RK73GB2A472J	CHIP R 4.7K J 1/10W	
R82			RK73GB2A392J	CHIP R 3.9K J 1/10W	
R83			RK73GB2A332J	CHIP R 3.3K J 1/10W	
R84			RK73GB2A152J	CHIP R 1.5K J 1/10W	
R85			RK73GB2A392J	CHIP R 3.9K J 1/10W	
R86			RK73GB2A103J	CHIP R 10K J 1/10W	
R88,89			RD14DB2H100J	SMALL-RD 10 J 1/2W	
R90,91			RD14BB2C563J	RD 56K J 1/6W	
R92			RK73GB2A103J	CHIP R 10K J 1/10W	
R93			RK73GB2A113J	CHIP R 11K J 1/10W	
R95,96			RK73GB2A152J	CHIP R 1.5K J 1/10W	
R97,98			RK73GB2A102J	CHIP R 1.0K J 1/10W	
R99-104			RK73GB2A472J	CHIP R 4.7K J 1/10W	
R105,106			RD14BB2C333J	RD 33K J 1/6W	
R107-110			RK73GB2A102J	CHIP R 1.0K J 1/10W	
R111,112			RK73GB2A101J	CHIP R 100 J 1/10W	
R113,114			RK73GB2A473J	CHIP R 47K J 1/10W	
R115,116			RK73GB2A272J	CHIP R 2.7K J 1/10W	
R117,118			RK73GB2A242J	CHIP R 2.4K J 1/10W	

Ref. No.	Added	New	Parts No.	Description	Destination
R119,120			RD14BB2C102J	RD 1.0K J 1/6W	
R121-124			RD14BB2C221J	RD 220 J 1/6W	
R125-128			RD14BB2C682J	RD 6.8K J 1/6W	
R129,130			RD14BB2C151J	RD 150 J 1/6W	
R131,132			RD14BB2C333J	RD 33K J 1/6W	
R133,134			RD14BB2C182J	RD 1.8K J 1/6W	
R135,136			RD14BB2C561J	RD 560 J 1/6W	
R137,138			RD14BB2C330J	RD 33 J 1/6W	
R139-142			RK73GB2A102J	CHIP R 1.0K J 1/10W	
R143,144			RK73GB2A112J	CHIP R 1.1K J 1/10W	
R145,146			RD14NB2E471J	RD 470 J 1/4W	
R147,148			RK73GB2A112J	CHIP R 1.1K J 1/10W	
R151-154			RD14NB2E101J	RD 100 J 1/4W	
R155,156			RD14NB2E471J	RD 470 J 1/4W	
R157-164			RD14NB2E4R7J	RD 4.7 J 1/4W	
R165-172			R92-0205-05	METAL-PLATE 0.1 K 2W	
R173			RD14DB2H100J	SMALL-RD 10 J 1/2W	
R174			RK73GB2A333J	CHIP R 33K J 1/10W	
R175			RK73GB2A153J	CHIP R 15K J 1/10W	
R176			RK73GB2A331J	CHIP R 330 J 1/10W	
R177			RK73GB2A223J	CHIP R 22K J 1/10W	
R178,179			RK73GB2A470J	CHIP R 47 J 1/10W	
R180,181			RK73GB2A682J	CHIP R 6.8K J 1/10W	
R182,183			RK73GB2A103J	CHIP R 10K J 1/10W	
R184-186			RK73GB2A473J	CHIP R 47K J 1/10W	
R187,188			RK73GB2A103J	CHIP R 10K J 1/10W	
R189			RK73GB2A102J	CHIP R 1.0K J 1/10W	
R190			RK73GB2A103J	CHIP R 10K J 1/10W	
R191			RK73GB2A562J	CHIP R 5.6K J 1/10W	
R192			RK73GB2A123J	CHIP R 12K J 1/10W	
R193			RK73GB2A223J	CHIP R 22K J 1/10W	
R194			RK73GB2A822J	CHIP R 8.2K J 1/10W	
R195			RK73GB2A103J	CHIP R 10K J 1/10W	
R196			RK73GB2A104J	CHIP R 100K J 1/10W	
R197,198			RK73GB2A473J	CHIP R 47K J 1/10W	
R199			RK73GB2A562J	CHIP R 5.6K J 1/10W	
R200			RK73GB2A332J	CHIP R 3.3K J 1/10W	
R201,202			RD14DB2H100J	SMALL-RD 10 J 1/2W	
R203			RK73GB2A273J	CHIP R 27K J 1/10W	
R241			RK73GB2A512J	CHIP R 5.1K J 1/10W	
R301,302			RD14BB2C271J	RD 270 J 1/6W	
R303,304			RK73GB2A432J	CHIP R 4.3K J 1/10W	
R305			RK73GB2A102J	CHIP R 1.0K J 1/10W	
R306,307			RK73GH2A103D	CHIP R 10K D 1/10W	
R308,309			RK73GB2A470J	CHIP R 47 J 1/10W	
R310			RK73GB2A123J	CHIP R 12K J 1/10W	
R311			RK73GB2A203J	CHIP R 20K J 1/10W	
R312,313			RK73GB2A152J	CHIP R 1.5K J 1/10W	
R314			RK73GB2A203J	CHIP R 20K J 1/10W	
R315			RK73GB2A123J	CHIP R 12K J 1/10W	
R316,317			RK73GB2A152J	CHIP R 1.5K J 1/10W	
R318			RD14BB2C153J	RD 15K J 1/6W	
R319			RD14BB2C104J	RD 100K J 1/6W	
R320			RD14BB2C153J	RD 15K J 1/6W	
R321,322			RD14BB2C102J	RD 1.0K J 1/6W	

E : Europe K : North America M : Other Areas E : Without Europe

△ Indicates safety critical components.

## PARTS LIST

### AUDIO UNIT (X09-5760-11)

Ref. No.	Add	New	Parts No.	Description	Destination	Ref. No.	Add	New	Parts No.	Description	Destination
R323			RK73GB2A392J	CHIP R 3.9K J 1/10W		S2		*	S79-0853-05	DIP SWITCHES	
R324			RK73GB2A272J	CHIP R 2.7K J 1/10W		D1			STZ6.8N	ZENER DIODE	
R325,326			RK73GB2A105J	CHIP R 1.0M J 1/10W		D2			LM1MA142WK-G	DIODE	
R327			RK73GB2A100J	CHIP R 10 J 1/10W		D3			LM1MA142WA-G	DIODE	
R328,329			RK73GB2A472J	CHIP R 4.7K J 1/10W		D51,52			RM4ZLF-J1NF	DIODE	
R330			RK73GB2A470J	CHIP R 47 J 1/10W		D54			S5566B-Q	DIODE	
R331			RK73GB2A220J	CHIP R 22 J 1/10W		D55			UDZS4.7B	ZENER DIODE	
R332			RK73GB2A202J	CHIP R 2.0K J 1/10W		D60			RD16JS-AZ(B)	ZENER DIODE	
R333			RK73GB2A103J	CHIP R 10K J 1/10W		D68			FCH10A20	DIODE	
R334,335			RD14BB2C470J	RD 47 J 1/6W		D69			FRH10A20	DIODE	
R336			RK73GB2A104J	CHIP R 100K J 1/10W		D70			UDZS6.8B	ZENER DIODE	
R337-339			RK73GB2A103J	CHIP R 10K J 1/10W		D71			RD15JS-AZ(B)	ZENER DIODE	
R341,342			RK73GB2A472J	CHIP R 4.7K J 1/10W		D81			LM1MA142WK-G	DIODE	
R344			RK73GB2A473J	CHIP R 47K J 1/10W		D103			LM1MA142WA-G	DIODE	
R345			RD14BB2C473J	RD 47K J 1/6W		D105,106			RD5.1JS-AZ(B2)	ZENER DIODE	
R347			RK73GB2A104J	CHIP R 100K J 1/10W		D107			1SS133	DIODE	
R348,349			RK73GB2A182J	CHIP R 1.8K J 1/10W		D108			RD5.1JS-AZ(B2)	ZENER DIODE	
R350,351			RK73GB2A103J	CHIP R 10K J 1/10W		D109-118			1SS133	DIODE	
R352			RK73GB2A302J	CHIP R 3.0K J 1/10W		D127-130			1SS133	DIODE	
R353			RK73GB2A561J	CHIP R 560 J 1/10W		D131-133			1SS355	DIODE	
R354-357			RK73GB2A100J	CHIP R 10 J 1/10W		D251			1SS133	DIODE	
R360			RK73GB2A563J	CHIP R 56K J 1/10W		D301			LM1MA142WA-G	DIODE	
R401			RK73GB2A103J	CHIP R 10K J 1/10W		D302			LM1MA142WK-G	DIODE	
R402			RK73GB2A473J	CHIP R 47K J 1/10W		D303			STZ6.8N	ZENER DIODE	
R418,419			RK73GB2A104J	CHIP R 100K J 1/10W		D304,305			1SS355	DIODE	
R420			RK73GB2A103J	CHIP R 10K J 1/10W		D306-308			STZ6.8N	ZENER DIODE	
R421,422			RK73GB2A101J	CHIP R 100 J 1/10W		D309			DA204U	DIODE	
R423,424			RK73GB2A103J	CHIP R 10K J 1/10W		D310			UDZS5.1B	ZENER DIODE	
R425,426			RK73GB2A181J	CHIP R 180 J 1/10W		D311			STZ6.8N	ZENER DIODE	
R427-429			RK73GB2A103J	CHIP R 10K J 1/10W		D312			UDZS16B	ZENER DIODE	
R430			RK73GB2A222J	CHIP R 2.2K J 1/10W		D313,314			STZ6.8N	ZENER DIODE	
R431			RK73GB2A473J	CHIP R 47K J 1/10W		D315			LM1MA142WK-G	DIODE	
R432,433			RK73GB2A272J	CHIP R 2.7K J 1/10W		D317			DA204U	DIODE	
R434			RK73GB2A103J	CHIP R 10K J 1/10W		D318			1SS355	DIODE	
R438			RK73GB2A153J	CHIP R 15K J 1/10W		D319			STZ6.8N	ZENER DIODE	
R439			RK73GB2A301J	CHIP R 300 J 1/10W		D341-344			1SS355	DIODE	
R440			RK73GB2A103J	CHIP R 10K J 1/10W		D351			UDZS5.1B	ZENER DIODE	
R441			RK73GB2A102J	CHIP R 1.0K J 1/10W		D352			UDZS10B	ZENER DIODE	
R442			RK73GB2A182J	CHIP R 1.8K J 1/10W		D353			UDZS3.3B	ZENER DIODE	
R443,444			RK73GB2A272J	CHIP R 2.7K J 1/10W		D354			UDZS5.1B	ZENER DIODE	
R450-453			RK73GB2A102J	CHIP R 1.0K J 1/10W		IC1			BA4560F	ANALOGUE IC	
R454,455			RK73GB2A101J	CHIP R 100 J 1/10W		IC2		*	UPC494GS-A	ANALOGUE IC	
R458-460			RK73GB2A101J	CHIP R 100 J 1/10W		IC3			P82B96PN	ANALOGUE IC	
R475,476			RK73GB2A562J	CHIP R 5.6K J 1/10W		IC5			BA10393F	ANALOGUE IC	
R477,478			RK73GB2A133J	CHIP R 13K J 1/10W		IC6		*	784224YGC117A	MICROCONTROLLER IC	
R479,480			RK73GB2A103J	CHIP R 10K J 1/10W		IC7			PST3436UL-E	MOS-IC	
VR1,2			R32-0294-05	SEMI FIXED VARIABLE RESISTOR		IC9,10			BA4560F	ANALOGUE IC	
W501-511			RK73EB2E000J	CHIP R 0.0 J 1/4W		Q50			2SC4081	TRANSISTOR	
W513-532			RK73EB2E000J	CHIP R 0.0 J 1/4W		Q51,52			2SC4097	TRANSISTOR	
W534-545			RK73EB2E000J	CHIP R 0.0 J 1/4W		Q53,54			2SA1577	TRANSISTOR	
W547-558			RK73EB2E000J	CHIP R 0.0 J 1/4W		Q55-60			2SK3662-F	FET	
W560-573			RK73EB2E000J	CHIP R 0.0 J 1/4W		Q61			2SD2012-F	TRANSISTOR	
W601-617			R92-1252-05	CHIP R 0 OHM J 1/16W		Q62			2SB1375-F	TRANSISTOR	
S1	3B		S68-0806-05	PUSH SWITCH		Q63			2SA1576A	TRANSISTOR	

E : Europe K : North America M : Other Areas E : Without Europe

△ Indicates safety critical components.

