

EXPLODED VIEW

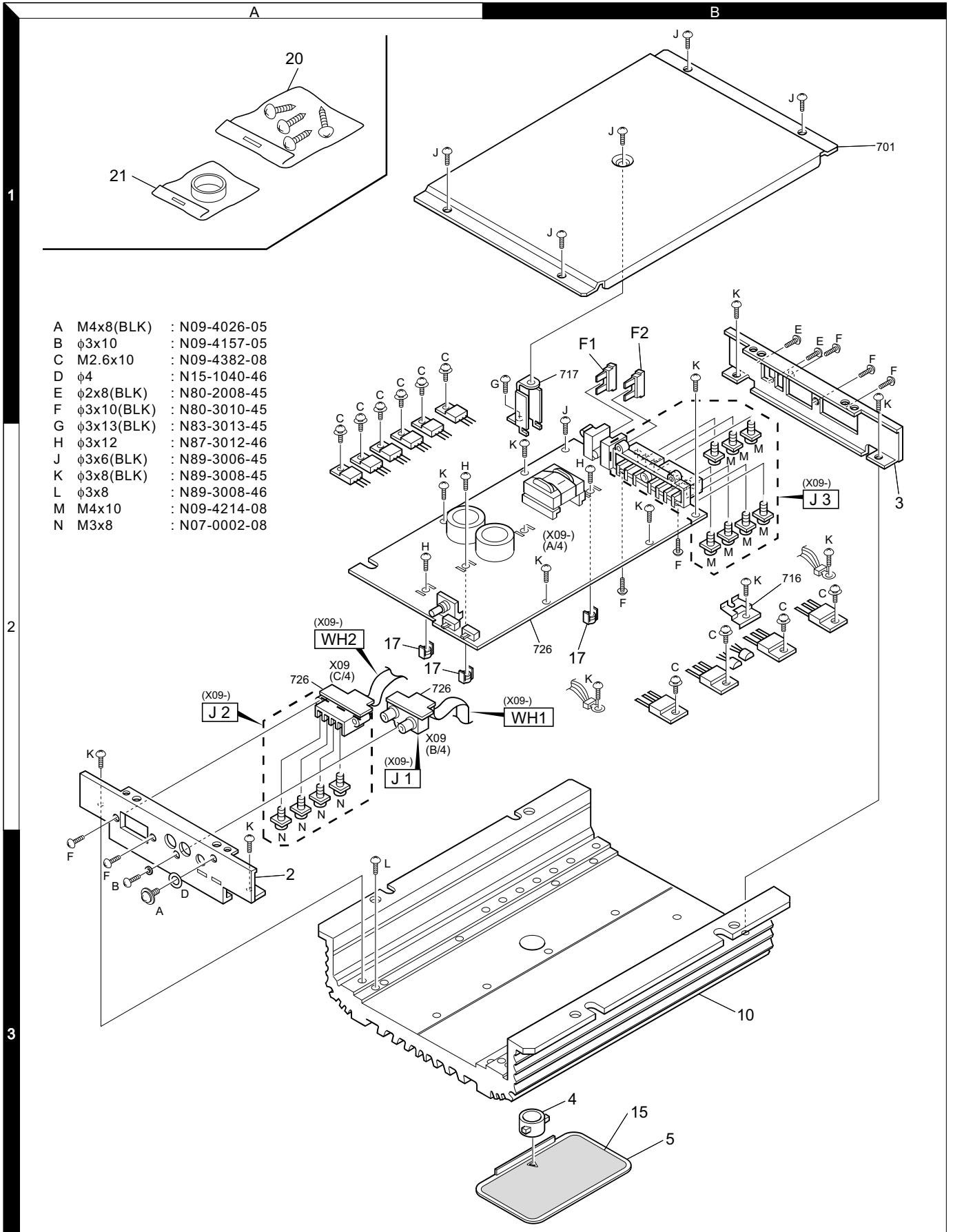

PARTS LIST

* New Parts

Parts without **Parts No.** are not supplied.

Les articles non mentionnes dans le **Parts No.** ne sont pas fournis.

Teile ohne **Parts No.** werden nicht geliefert.

Ref. No.	A d d	N e w	Parts No.	Description	Des- tina- tion
KAC-729S					
2	3A		A64-2331-02	PANEL	
3	2B		A84-0277-02	REAR PANEL	
4	3B		B19-2082-04	LIGHTING BOARD	
5	3B		B43-1276-03	BADGE	
-			B46-0100-50	WARRANTY CARD	
-			B64-1949-00	INSTRUCTION MANUAL (E)	KE1
-			B64-1950-00	INSTRUCTION MANUAL (F,S)	KE1
-			B64-1951-00	INSTRUCTION MANUAL (E,T)	M1
-			B64-1962-00	INSTRUCTION MANUAL (G,D)	E1
-			B64-1963-00	INSTRUCTION MANUAL (I,P)	E1
10	3B		F01-1656-01	HEAT SINK	
F1,2	1B		F52-0013-05	FUSE(20A BLADE TYPE)	
-			H10-4644-03	POLYSTYRENE FOAMED FIXTURE	
-			H21-1117-04	PROTECTION SHEET	
-			H25-0336-04	PROTECTION BAG(170X250X0.03)	
15	3B		H30-0543-04	ADHESIVE DOUBLE-COATED TAPE	
-			H54-2065-03	ITEM CARTON CASE	
17	2A		J30-1066-04	SPACER	
20	1A		N99-1587-05	SCREW SET	
A	3A		N09-4026-05	TAPPING SCREW (4X8,TP,S)	
B	3A		N09-4157-05	SEMS (TAPTITE SCREW)	
C	2B		N09-4382-05	TAPTITE SCREW (2.6X10)	
D	3A		N15-1040-46	FLAT WASHER(φ4)	
E	1B		N80-2008-45	PAN HEAD TAPTITE SCREW	
F	1B		N80-3010-45	PAN HEAD TAPTITE SCREW	
G	1B		N83-3013-45	PAN HEAD TAPTITE SCREW	
H	2A		N87-3012-46	BRAZIER HEAD TAPTITE SCREW	
J	1B		N89-3006-45	BINDING HEAD TAPTITE SCREW	
K	2B		N89-3008-45	BINDING HEAD TAPTITE SCREW	
L	3A		N89-3008-46	BINDING HEAD TAPTITE SCREW	
21	1A		W01-1516-05	ACCESSORY	
AUDIO UNIT (X09-5260-10)					
D306			B30-1460-05	LED(RED)	
C1 ,2			CK45FB1H102K	CERAMIC 1000PF	K
C3 ,4			CE04DW1H3R3M	ELECTRO 3.3UF	50WV
C5 -8			CC45FCH1H220J	CERAMIC 22PF	J
C9 -12			CE04DW1H2R2M	ELECTRO 2.2UF	50WV
C14			CF92FV1H823J	MF-C 0.082UF	J
C15			CF92FV1H124J	MF-C 0.12UF	J
C16			CF92FV1H223J	MF-C 0.022UF	J
C17			CE04DW1C220M	ELECTRO 22UF	16WV
C18			CC45FSL1H470J	CERAMIC 47PF	J
C19 ,20			CE04DW1C470M	ELECTRO 47UF	16WV
C50			CF92FV1H102J	MF-C 1000PF	J
C101,102			CE04DW1C100M	ELECTRO 10UF	16WV
C103,104			CK45FB1H471K	CERAMIC 470PF	K
C105,106			CF92FV1H102J	MF-C 1000PF	J
C107,108			CF92FV1H103J	MF-C 0.010UF	J
C109,110			CE04DW1A330M	ELECTRO 33UF	10WV

Ref. No.	A d d	N e w	Parts No.	Description	Des- tina- tion
C111,112			CC45FSL1H331J	CERAMIC 330PF	J
C113,114			CC45FSL1H060D	CERAMIC 6.0PF	D
C115,116			CC45FSL1H120J	CERAMIC 12PF	J
C117,118			CF92FV1H102J	MF-C 1000PF	J
C119,120			CE04DW1V220M	ELECTRO 22UF	35WV
C121-128			CC45FSL1H470J	CERAMIC 47PF	J
C129,130			CF92FV1H473J	MF-C 0.047UF	J
C181,182			CE04DW1C220M	ELECTRO 22UF	16WV
C183			CE04DW1H221M	ELECTRO 220UF	50WV
C201,202		*	C90-2994-05	ELECTRO 4700UF	45WV
C203,204			CF92FV1H182J	MF-C 1800PF	J
C205			CF92FV1H153J	MF-C 0.015UF	J
C206			C90-2921-05	ELECTRO 3900UF	16WV
C207			CE04DW1C100M	ELECTRO 10UF	16WV
C213			CE04DW1C100M	ELECTRO 10UF	16WV
C214			CF92FV1H102J	MF-C 1000PF	J
C215			CE04DW1C470M	ELECTRO 47UF	16WV
C305,306			CE04DW1A101M	ELECTRO 100UF	10WV
C307			CE04DW1H2R2M	ELECTRO 2.2UF	50WV
C308			CE04DW1A101M	ELECTRO 100UF	10WV
C309			CE04DW1H100M	ELECTRO 10UF	50WV
C310			CE04DW1H010M	ELECTRO 1.0UF	50WV
C401-404			CF92FV1H103J	MF-C 0.010UF	J
CN1 ,2			E40-9472-05	FLAT CABLE CONNECTOR	
CN3			E40-3640-05	PIN ASSY	
E3			E23-0149-05	TERMINAL	
J1			E63-0834-05	PIN JACK	
J2			E70-0824-05	SCREW TERMINAL BOARD	
J3			E70-0823-05	SCREW TERMINAL BOARD	
△ CN4			J13-0602-05	FUSE HOLDER	
L1			L33-1015-05	CHOKE COIL	
L2		*	L19-0569-05	TRANSFORMER FOR CONVERTER	
M	2B		N80-3010-45	PAN HEAD TAPTITE SCREW	
R141-144			RD14DB2H101J	SMALL-RD 100	J 1/2W
R149-152			R92-0205-05	METAL-PLATE 0.1	K 2W
R153,154			RD14DB2H4R7J	SMALL-RD 4.7	J 1/2W
R181-184			RS14KB3D122J	FL-PROOF RS 1.2K	J 2W
R185			RD14DB2H100J	SMALL-RD 10	J 1/2W
R186			RD14DB2H102J	SMALL-RD 1.0K	J 1/2W
R201-203			RD14DB2H100J	SMALL-RD 10	J 1/2W
VR1			R31-0209-05	VARIABLE RESISTOR	
VR11,12			R32-0032-05	SEMI FIXED VARIABLE RESISTOR	
K1			S76-0804-05	MAGNETIC RELAY	
S1 ,2			S62-0845-05	SLIDE SWITCH	
D1 -4			1SS133	DIODE	
D181-184			RD7.5JS(B)	ZENER DIODE	
D186			RD10JS(B)	ZENER DIODE	
D201			FML22S*A	DIODE	
D202			FML22R*A	DIODE	
D203,204			1SS133	DIODE	
D205			1N5406-M	DIODE	

PARTS LIST

* New Parts

Parts without **Parts No.** are not supplied.

Les articles non mentionnes dans le **Parts No.** ne sont pas fournis.

Teile ohne **Parts No.** werden nicht geliefert.

Ref. No.	A d d	N e w	Parts No.	Description	Des- tina- tion
D305			1SS133	DIODE	
D307			RD7.5JS(B)	ZENER DIODE	
D308			RD15JS(B)	ZENER DIODE	
D309			1SS133	DIODE	
D313,314			1SS133	DIODE	
D401-410			1SS133	DIODE	
IC1			UPC4574C	IC(OP AMP X4)	
IC2			NJM4565D	ANALOGUE IC	
IC11			UPC494C	IC(SWITCHING REGULATOR)	
IC12			UPC1237HA	IC(POWER AMP)	
Q1			2SC945(A)(Q,P)	TRANSISTOR	
Q101-108			2SA733(A)(Q,P)	TRANSISTOR	
Q109-112			2SC1845(F,E)	TRANSISTOR	
Q113,114			2SC945(A)(Q)	TRANSISTOR	
Q115,116			2SC2235	TRANSISTOR	
Q117,118			2SA965	TRANSISTOR	
Q119,120			2SC2235	TRANSISTOR	
Q121,122			2SA965	TRANSISTOR	
Q123,124			2SC4388LB*5	TRANSISTOR	
Q125,126			2SA1673LB*5	TRANSISTOR	
Q201-204			IRF11010N	FET	
Q205,206			2SC945(A)(Q,P)	TRANSISTOR	
Q207,208			2SA733(A)(Q,P)	TRANSISTOR	
Q303			2SA992(F,E)	TRANSISTOR	
Q304,305			2SC945(A)(Q,P)	TRANSISTOR	
Q306			2SA1534A(R,S)	TRANSISTOR	
Q307			2SA733(A)(Q,P)	TRANSISTOR	
Q308-310			2SC945(A)(Q,P)	TRANSISTOR	
Q401,402			2SC1845(F,E)	TRANSISTOR	
Q403,404			2SA992(F,E)	TRANSISTOR	
TH1			PTH9M04BD222T	POSITIVE RESISTOR	
TH2			PTH9L04BD222TS	POSITIVE RESISTOR	
TH3			PTH9M04BD222T	POSITIVE RESISTOR	