

EXPLODED VIEW (CD MECHANISM)

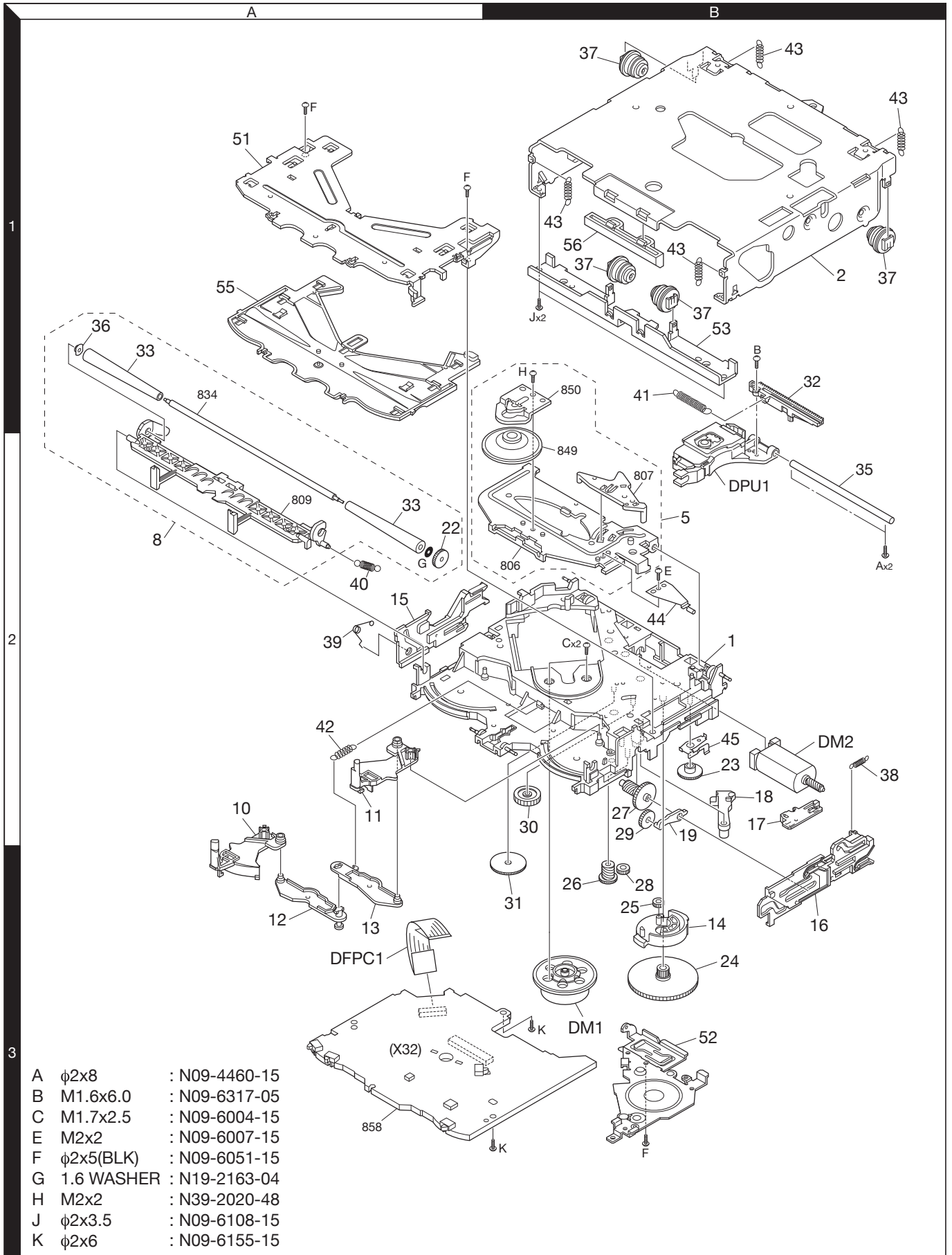

A	φ2x8	: N09-4460-15
B	M1.6x6.0	: N09-6317-05
C	M1.7x2.5	: N09-6004-15
E	M2x2	: N09-6007-15
F	φ2x5(BLK)	: N09-6051-15
G	1.6 WASHER	: N19-2163-04
H	M2x2	: N39-2020-48
J	φ2x3.5	: N09-6108-15
K	φ2x6	: N09-6155-15

Parts with the exploded numbers larger than 700 are not supplied.

PARTS LIST

* New parts

Parts without **Parts No.** are not supplied.

Les articles non mentionnés dans le **Parts No.** ne sont pas fournis.

Teile ohne **Parts No.** werden nicht geliefert.

Ref. No.	A d d	N e w	Parts No.	Description	Desti- nation
KDC-MP738U/W7541U/W7541UY/X792/X8009U					
201	1D		A02-2757-03	PLASTIC CABINET ASSY	M1
203	2C	*	A22-3164-02	SUB PANEL ASSY	
205	2C	*	A46-1865-01	REAR COVER	
207	1D		A52-0897-02	TOP PLATE	
PA1	3C	*	A64-4424-02	PANEL ASSY	K
PA1	3C	*	A64-4425-02	PANEL ASSY	K1
PA1	3C	*	A64-4428-02	PANEL ASSY	E1E2
PA1	3C		A64-4431-02	PANEL ASSY	M1
RC1	1C		A70-2085-05	REMOTE CONTROLLER ASSY(RC-547)	
-		*	B64-4048-00	INSTRUCTION MANUA (ENG.FRE.SPA)	KK1
-		*	B64-4049-00	INSTRUCTION MANUAL (ENG.)	E1E2
-		*	B64-4050-00	INSTRUCTION MANUA (FRE.GER.DUT)	E1
-		*	B64-4051-00	INSTRUCTION MANUA (ITA.SPA.POR)	E1
-		*	B64-4052-00	INSTRUCTION MANUAL (RUS.)	E2
-			B64-4053-00	INSTRUCTION MANUAL (ENG.S-CHI.)	M1
-			B64-4054-00	INSTRUCTION MANUAL (ARA.)	M1
209	3C	*	B07-3234-03	ESCUTCHEON	
210	1C	*	B07-3235-03	ESCUTCHEON	KE1E2
210	1C	*	B07-3235-03	ESCUTCHEON	M1
210	1C	*	B07-3238-03	ESCUTCHEON	K1
211	3C	*	B10-5082-01	FRONT GLASS	K
211	3C	*	B10-5083-01	FRONT GLASS	K1
211	3C	*	B10-5086-01	FRONT GLASS	E1E2
211	3C	*	B10-5089-01	FRONT GLASS	M1
212	3C	*	B19-2471-03	LIGHTING BOARD	
213	3C	*	B19-2472-03	LIGHTING BOARD	
214	3C	*	B19-2474-04	LIGHTING BOARD	
215	3C		B43-1518-04	BADGE	
218	1C		D10-4730-03	LEVER	
219	2C		D10-4731-03	LEVER	
220	1C		D10-7012-04	LEVER	
221	2C		D39-0255-05	DAMPER	
223	3D	*	E29-2120-03	CONDUCTIVE RUBBER	
224	2D	*	E30-6821-05	CORD WITH CONNECTOR (USB)	
225	2D	*	E30-6823-05	CORD WITH DIN CONNECTOR (OPEL)	E1
△ DC1	1C		E30-6428-05	DC CORD	KK1M1
△ DC2	1C		E30-6671-05	DC CORD (ISO)	E1E2
FC1	1D	*	E39-0974-05	FLAT CABLE (30PIN 1MM)	
229	1C	*	F19-1475-04	COVER (USB BRACKET)	K
233	2D		F29-0637-04	INSULATING COVER (USB)	
△ F1	2D		F52-0023-05	FUSE (MINI BLADE TYPE) 10A	
235	1C		G01-3171-04	TORSION COIL SPRING	
236	2C		G01-3172-04	TORSION COIL SPRING	
237	2C		G01-3173-04	COMPRESSION SPRING	
238	3C		G01-3203-04	COMPRESSION SPRING	
-		*	H54-4324-03	ITEM CARTON CASE	K
-		*	H54-4325-03	ITEM CARTON CASE	K1
-		*	H54-4328-03	ITEM CARTON CASE	E1
-		*	H54-4329-03	ITEM CARTON CASE	E2
-		*	H54-4332-03	ITEM CARTON CASE	M1
244	2C		J19-5203-03	HOLDER	

Ref. No.	A d d	N e w	Parts No.	Description	Desti- nation
245	2D		J19-5204-03	HOLDER	
246	2C		J19-5205-03	HOLDER	
248	2D	*	J21-9977-03	MOUNTING HARDWARE	
249	1C		J22-0011-03	MOUNTING HARDWARE ASSY	
252	3D	*	K24-4801-04	PUSH KNOB (RESET)	
253	2C	*	K24-4802-03	PUSH KNOB (EJECT)	
254	3C	*	K24-4803-03	PUSH KNOB (RELEASE)	
255	3C	*	K25-1919-03	PUSH KNOB (PRESET)	
256	3C	*	K28-0282-14	KNOB ASSY (VOL)	KE1E2
256	3C	*	K28-0282-14	KNOB ASSY (VOL)	M1
256	3C	*	K28-0290-14	KNOB ASSY (VOL)	K1
258	3C	*	K28-0284-04	KNOB ASSY (FM/AM)	
260	3C	*	K28-0287-04	KEY TOP	KE1E2
260	3C	*	K28-0287-04	KEY TOP	M1
260	3C	*	K28-0288-04	KEY TOP	K1
262	1C	*	N99-1730-35	SCREW SET	KK1M1
263	1C		N99-1757-15	SCREW SET	KK1M1
264	1C	*	N99-1790-05	SCREW SET	K
A	3C		N80-2006-48	PAN HEAD TAPTITE SCREW	
B	2C		N80-2008-43	PAN HEAD TAPTITE SCREW	
C	1D		N83-3005-48	PAN HEAD TAPTITE SCREW	
D	2C		N84-2005-43	PAN HEAD TAPTITE SCREW	
E	2D		N84-2005-48	PAN HEAD TAPTITE SCREW	
F	2C		N84-2606-43	PAN HEAD TAPTITE SCREW	
265	1C		W01-1664-05	CARRYING CASE	K
265	1C		W01-1710-05	CARRYING CASE	K1E1E2
266	1C	*	W01-1723-05	COMPACT DISC	
272	2D	*	X34-5790-10	ELECTRIC UNIT	K
272	2D	*	X34-5790-11	ELECTRIC UNIT	K1
272	2D	*	X34-5790-21	ELECTRIC UNIT	M1
272	2D	*	X34-5792-71	ELECTRIC UNIT	E1
272	2D	*	X34-5792-73	ELECTRIC UNIT	E2
DME1	1D		X92-6130-00	CD MECHANISM ASSY (DXM-6E20W)	
DISPLAY UNIT (X15-1190-10)					
D1			B30-1779-05	LED (1608_SR)	
CN1		*	E41-2984-05	PIN ASSY	
J1			E58-1008-05	RECTANGULAR RECEPTACLE	
R1-4			RK73EB2E432J	CHIP R 4.3K J 1/4W	
R5-8			RK73EB2E102J	CHIP R 1.0K J 1/4W	
R9,10			RK73EB2E432J	CHIP R 4.3K J 1/4W	
R11			RK73FB2B331J	CHIP R 330 J 1/8W	
S1			S70-0901-05	TACT SWITCH	
SWITCH UNIT (X16-624x-xx)					
D1			B30-1780-05	LED (1608_PG)	K
D2			B30-1566-05	LED (1608_RED)	
D6,7		*	B30-1790-05	LED (1608_BLUE)	
D10-19			B30-1779-05	LED (1608_SR)	K1
D10-19		*	B30-1790-05	LED (1608_BLUE)	KE1E2
D10-19		*	B30-1790-05	LED (1608_BLUE)	M1
D41-43		*	B30-1790-05	LED (1608_BLUE)	

E1 : KDC-W7541U E2 : KDC-W7541UY (Europe)
K : KDC-X792 K1 : KDC-MP738U (North America)
M : KDC-X8009U (Other Areas)

△ Indicates safety critical components.

PARTS LIST

SWITCH UNIT (X16-624x-xx)

Ref. No.	Add	New	Parts No.	Description	Destination
C10			CK73GB1A105K	CHIP C 1.0UF K	
C16-23			CK73GB1H103K	CHIP C 0.010UF K	
C26,27			CK73GB1H103K	CHIP C 0.010UF K	
C30			CK73GB1H103K	CHIP C 0.010UF K	
C32			CK73GB1A105K	CHIP C 1.0UF K	
C33			CK73GB1H103K	CHIP C 0.010UF K	
C35,36			CK73GB1H103K	CHIP C 0.010UF K	
C38			CK73FB1A225K	CHIP C 2.2UF K	
C39			CK73FB0J106K	CHIP C 10UF K	
C40			CK73GB0J475K	CHIP C 4.7UF K	
C41,42			CK73FB0J106K	CHIP C 10UF K	
C43			CC73GCH1H101J	CHIP C 100PF J	
J1			E59-0850-05	RECTANGULAR PLUG	
X1			L78-1208-05	RESONATOR (6.6M)	
CP1			RK74HB1J223J	CHIP-COM 22K J 1/16W	
CP3			RK74GA1J223J	CHIP-COM 22K J 1/16W	
CP8			RK74GA1J331J	CHIP-COM 330 J 1/16W	
CP9-14			RK74HB1J331J	CHIP-COM 330 J 1/16W	
CP16			RK74HB1J331J	CHIP-COM 330 J 1/16W	
CP18			RK74HB1J331J	CHIP-COM 330 J 1/16W	
CP20			RK74GA1J101J	CHIP-COM 100 J 1/16W	
CP21			RK74HB1J331J	CHIP-COM 330 J 1/16W	
CP23			RK74HB1J101J	CHIP-COM 100 J 1/16W	
CP24			RK74HB1J102J	CHIP-COM 1.0K J 1/16W	
CP25			RK74HB1J332J	CHIP-COM 3.3K J 1/16W	
CP26			RK74HB1J223J	CHIP-COM 22K J 1/16W	
CP27			RK74HB1J101J	CHIP-COM 100 J 1/16W	
CP28			RK74GA1J101J	CHIP-COM 100 J 1/16W	
CP29			RK74HB1J101J	CHIP-COM 100 J 1/16W	
CP30			RK74HB1J102J	CHIP-COM 1.0K J 1/16W	
CP31			RK74HB1J223J	CHIP-COM 22K J 1/16W	
CP32			RK74GA1J101J	CHIP-COM 100 J 1/16W	
CP36,37			RK74GA1J332J	CHIP-COM 3.3K J 1/16W	
R1			RK73FB2B331J	CHIP R 330 J 1/8W	
R3-9			RK73EB2E621J	CHIP R 620 J 1/4W	KE1E2
R3-9			RK73EB2E621J	CHIP R 620 J 1/4W	M1
R3,4			RK73EB2E621J	CHIP R 620 J 1/4W	K1
R5-9			RK73EB2E821J	CHIP R 820 J 1/4W	K1
R10			RK73EB2E911J	CHIP R 910 J 1/4W	
R13			RK73GB2A222J	CHIP R 2.2K J 1/10W	
R18			RK73GB2A473J	CHIP R 47K J 1/10W	
R20			RK73GB2A332J	CHIP R 3.3K J 1/10W	
R23,24			RK73GB2A472J	CHIP R 4.7K J 1/10W	
R25			RK73GB2A101J	CHIP R 100 J 1/10W	KE1E2
R26			RK73GB2A223J	CHIP R 22K J 1/10W	
R30			RK73GB2A223J	CHIP R 22K J 1/10W	K1M1
R31			RK73GB2A223J	CHIP R 22K J 1/10W	KE1E2
R33			RK73GB2A102J	CHIP R 1.0K J 1/10W	
R34			RK73GB2A101J	CHIP R 100 J 1/10W	
R36			RK73GB2A101J	CHIP R 100 J 1/10W	
R37			RK73GB2A473J	CHIP R 47K J 1/10W	
R38			RK73GB2A102J	CHIP R 1.0K J 1/10W	
R43,44			RK73PB2H3R9J	CHIP R 3.9 J 1/2W	

Ref. No.	Add	New	Parts No.	Description	Destination
R52			RK73GB2A223J	CHIP R 22K J 1/10W	
R53			RK73GB2A102J	CHIP R 1.0K J 1/10W	
R54			RK73EB2E333J	CHIP R 33K J 1/4W	
R55			RK73GB2A473J	CHIP R 47K J 1/10W	
R59			RK73GB2A473J	CHIP R 47K J 1/10W	
R60			RK73FB2B150J	CHIP R 15 J 1/8W	
R61			RK73GB2A753J	CHIP R 75K J 1/10W	
R68			RK73GB2A333J	CHIP R 33K J 1/10W	
R71			RK73GB2A102J	CHIP R 1.0K J 1/10W	
R77			RK73GB2A223J	CHIP R 22K J 1/10W	
R79			RK73GB2A822J	CHIP R 8.2K J 1/10W	
R80			RK73GB2A332J	CHIP R 3.3K J 1/10W	
W4			RK73GB2A000J	CHIP R 0.0 J 1/10W	
S19			S70-0947-05	TACT SWITCH	
S1			T99-0456-15	ROTARY ENCODER	
ED1	*		JN12832A	FLUORESCENT INDICATOR TUBE	
IC1	*		MX233213T19Z7	ROM IC	K1M1
IC1	*		29L32CBT179Z6	ROM IC	KE1E2
IC3			BR24L04FV-W	ROM IC	
IC4	*		703134AGJ018A	MICROCONTROLLER IC	
IC6			PIC95603	ANALOGUE IC	
IC7			74LVC08APW	MOS-IC	
IC8	*		74HC2G08DP	MOS-IC	
IC9			74AHC1G32GW	MOS-IC	
IC10			SI-3025KMMF	ANALOGUE IC	
IC11			S-1132B33U5T1G	ANALOGUE IC	
Q1-4			DTC143ZE	DIGITAL TRANSISTOR	K
Q2-4			DTC143ZE	DIGITAL TRANSISTOR	K1E1E2
Q2-4			DTC143ZE	DIGITAL TRANSISTOR	M1
Q5			2SC4081	TRANSISTOR	
Q6			2SB1689	TRANSISTOR	
Q11			2SC2713-F	TRANSISTOR	
Q13			2SB1260	TRANSISTOR	
CD PLAYER UNIT (X32-6130-00)					
C20			CC73GCH1H330J	CHIP C 33PF J	
C23			CC73GCH1H151J	CHIP C 150PF J	
C24			CK73FB1A225K	CHIP C 2.2UF K	
C25			CK73GB1A105K	CHIP C 1.0UF K	
C26			CK73GB1H153K	CHIP C 0.015UF K	
C27			CC73GCH1H470J	CHIP C 47PF J	
C30-32			CK73GB1H103K	CHIP C 0.010UF K	
C33			CK73GB1H332K	CHIP C 3300PF K	
C34			CK73GB1H104K	CHIP C 0.10UF K	
C35			CK73GB1H153K	CHIP C 0.015UF K	
C36			CK73GB1H104K	CHIP C 0.10UF K	
C38			CC73GCH1H680J	CHIP C 68PF J	
C39			CK73GB1H104K	CHIP C 0.10UF K	
C41			CK73GB1A105K	CHIP C 1.0UF K	
C44			CK73GB1H104K	CHIP C 0.10UF K	
C45			CK73GB1H223K	CHIP C 0.022UF K	
C46			CK73GB1H103K	CHIP C 0.010UF K	
C47,48			CK73GB1H333K	CHIP C 0.033UF K	
C49,50			CK73GB1H104K	CHIP C 0.10UF K	

PARTS LIST

CD PLAYER UNIT (X32-6130-00)

Ref. No.	Add	New	Parts No.	Description	Destination
C51			CK73GB1H222K	CHIP C 2200PF K	
C52,53			CK73GB1H104K	CHIP C 0.10UF K	
C54			CK73GB1A105K	CHIP C 1.0UF K	
C58			CK73GB1A105K	CHIP C 1.0UF K	
C60			CK73EB0J226K	CHIP C 22UF K	
C61-64			CK73GB1H104K	CHIP C 0.10UF K	
C66			CK73FB1C105K	CHIP C 1.0UF K	
C68,69			CK73GB1H104K	CHIP C 0.10UF K	
C71			CK73GB1H104K	CHIP C 0.10UF K	
C72			CK73FB0J106K	CHIP C 10UF K	
C87,88			CK73GB1H332K	CHIP C 3300PF K	
C89-91			CK73GB1H104K	CHIP C 0.10UF K	
C94,95			CK73GB1A105K	CHIP C 1.0UF K	
C96			CK73GB1H103K	CHIP C 0.010UF K	
C97			CK73GB1H104K	CHIP C 0.10UF K	
C101			CK73GB1C224K	CHIP C 0.22UF K	
C102			CK73GB1A474K	CHIP C 0.47UF K	
C103			CK73GB1H153K	CHIP C 0.015UF K	
C104			CK73FB1A225K	CHIP C 2.2UF K	
CN1			E41-2612-05	FLAT CABLE CONNECTOR	
CN2			E41-2630-05	FLAT CABLE CONNECTOR	
X1			L78-1221-05	RESONATOR (16.93MHZ)	
CP7			RK74GB1J103J	CHIP-COM 10K J 1/16W	
R20			RK73GB2A184J	CHIP R 180K J 1/10W	
R27			RK73GB2A912J	CHIP R 9.1K J 1/10W	
R29			RK73GB2A102J	CHIP R 1.0K J 1/10W	
R30			RK73GB2A101J	CHIP R 100 J 1/10W	
R31			RK73GB2A224J	CHIP R 220K J 1/10W	
R32			RK73GB2A181J	CHIP R 180 J 1/10W	
R33			RK73GB2A153J	CHIP R 15K J 1/10W	
R34			RK73GB2A473J	CHIP R 47K J 1/10W	
R35			RK73GB2A562J	CHIP R 5.6K J 1/10W	
R36			RK73GB2A154J	CHIP R 150K J 1/10W	
R37			RK73GB2A334J	CHIP R 330K J 1/10W	
R38			RK73GB2A223J	CHIP R 22K J 1/10W	
R40			RK73GB2A114J	CHIP R 110K J 1/10W	
R41			RK73GB2A473J	CHIP R 47K J 1/10W	
R45			RK73GB2A221J	CHIP R 220 J 1/10W	
R46			RK73GB2A105J	CHIP R 1.0M J 1/10W	
R50			RK73GB2A560J	CHIP R 56 J 1/10W	
R51			RK73EB2E220J	CHIP R 22 J 1/4W	
R52			RK73EB2E100J	CHIP R 10 J 1/4W	
R55			RK73GB2A103J	CHIP R 10K J 1/10W	
R59			RK73GB2A4R7J	CHIP R 4.7 J 1/10W	
R60,61			RK73GB2A103J	CHIP R 10K J 1/10W	
R82,83			RK73GB2A331J	CHIP R 330 J 1/10W	
R207			RK73EB2E000J	CHIP R 0.0 J 1/4W	
R216,217			RK73GB2A103J	CHIP R 10K J 1/10W	
R221,222			RK73GB2A101J	CHIP R 100 J 1/10W	
R226			RK73GB2A101J	CHIP R 100 J 1/10W	
R228-230			RK73GB2A101J	CHIP R 100 J 1/10W	
R231			RK73GB2A473J	CHIP R 47K J 1/10W	
R232			RK73GB2A104J	CHIP R 100K J 1/10W	

Ref. No.	Add	New	Parts No.	Description	Destination
R233			RK73GB2A331J	CHIP R 330 J 1/10W	
R240			RK73EB2E000J	CHIP R 0.0 J 1/4W	
R241			RK73GB2A104J	CHIP R 100K J 1/10W	
R243			RK73GB2A472J	CHIP R 4.7K J 1/10W	
R244			RK73GB2A225J	CHIP R 2.2M J 1/10W	
R246			RK73GB2A104J	CHIP R 100K J 1/10W	
R247			RK73GB2A101J	CHIP R 100 J 1/10W	
R252			RK73GB2A102J	CHIP R 1.0K J 1/10W	
R257-261			RK73GB2A101J	CHIP R 100 J 1/10W	
R262-264			RK73GB2A472J	CHIP R 4.7K J 1/10W	
R280			RK73GB2A103J	CHIP R 10K J 1/10W	
R281,282			RK73GB2A2R2J	CHIP R 2.2 J 1/10W	
R284,285			RK73GB2A2R2J	CHIP R 2.2 J 1/10W	
R287			RK73GB2A2R2J	CHIP R 2.2 J 1/10W	
R288			RK73GB2A302J	CHIP R 3.0K J 1/10W	
R289			RK73GB2A103J	CHIP R 10K J 1/10W	
S1,2			S68-0863-05	PUSH SWITCH	
S3			S68-0862-05	PUSH SWITCH	
D2			DAP202U	DIODE	
D3,4			DA204U	DIODE	
IC3			BD8222EFV	ANALOGUE IC	
IC4			TC94A70FG-010	MOS-IC	
IC5			S-1132B15U5T1G	ANALOGUE IC	
IC6			S-1132B33U5T1G	ANALOGUE IC	
IC11			XC6218S152MR	MOS-IC	
Q1			2SB0970	TRANSISTOR	
Q13			DTC114YUA	DIGITAL TRANSISTOR	
ELECTRIC UNIT (X34-579x-xx)					
C1			C90-6783-05	ERECTRO 3900 16WV	K1E1E2
C1			C90-6783-05	ERECTRO 3900 16WV	M1
C1			C90-6784-05	ELECTRO 3900UF 16WV	K
C3			C93-1470-05	CHIP C 1500PF K	E1E2
C10			CD04AY1A221M	ELECTRO 220UF 10WV	
C11			CK73GB1H103K	CHIP C 0.010UF K	
C20			C90-6851-05	ELECTRO 220UF 25WV	
C22			CD04BA1C100M	ELECTRO 10UF 16WV	
C23			CD04BA0J101M	ELECTRO 100UF 6.3WV	
C24			C90-6851-05	ELECTRO 220UF 25WV	
C25			CK73GB0J475K	CHIP C 4.7UF K	
C26			CK73GB1A105K	CHIP C 1.0UF K	
C30			CK73GB1A105K	CHIP C 1.0UF K	K
C31			CD04AY1H220M	ELECTRO 22UF 50WV	K
C60			CK73GB1H103K	CHIP C 0.010UF K	
C63			CK73GB1H103K	CHIP C 0.010UF K	
C64			CC73GCH1H101J	CHIP C 100PF J	
C65		*	C93-1457-05	CHIP C 1UF K	
C66,67			C93-0059-05	CERAMIC 1UF K	
C68		*	C93-1457-05	CHIP C 1UF K	
C69			CK73FB1C105K	CHIP C 1.0UF K	
C81			CK73FB0J106K	CHIP C 10UF K	
C82			CK73FB1E474K	CHIP C 0.47UF K	
C83			CK73GB1H102K	CHIP C 1000PF K	
C84			CK73EB1C106K	CHIP C 10UF K	

E1 : KDC-W7541U E2 : KDC-W7541UY (Europe)
K : KDC-X792 K1 : KDC-MP738U (North America)
M : KDC-X8009U (Other Areas)

△ Indicates safety critical components.

PARTS LIST

ELECTRIC UNIT (X34-579x-xx)

Ref. No.	Add	New	Parts No.	Description	Destination	Ref. No.	Add	New	Parts No.	Description	Destination
X502			L77-2921-05	CRYSTAL RESONATOR (32.768KHZ)		R150			RK73GB2A223J	CHIP R 22K J 1/10W	KK1M1
X700			L77-2921-05	CRYSTAL RESONATOR (32.768KHZ)		R151,152			RK73PB2H221J	CHIP R 220 J 1/2W	KK1M1
X701			L77-2964-05	CRYSTAL RESONATOR (9.00MHZ)		R153			RK73FB2B472J	CHIP R 4.7K J 1/8W	
X750			L77-2921-05	CRYSTAL RESONATOR (32.768KHZ)		R170			RK73GB2A473J	CHIP R 47K J 1/10W	
						R171			RK73GB2A104J	CHIP R 100K J 1/10W	
C	2D		N83-3005-48	PAN HEAD TAPTITE SCREW		R172			RK73EB2E103J	CHIP R 10K J 1/4W	
G	2D		N80-3008-48	PAN HEAD TAPTITE SCREW		R180			RK73GB2A104J	CHIP R 100K J 1/10W	
H	2D		N83-3010-43	PAN HEAD TAPTITE SCREW		R181			RK73EB2E103J	CHIP R 10K J 1/4W	
J	2D		N83-3016-48	PAN HEAD TAPTITE SCREW		R190			RK73EB2E102J	CHIP R 1.0K J 1/4W	
K	3D		N86-2606-48	BINDING HEAD TAPTITE SCREW		R191-193			RK73EB2E471J	CHIP R 470 J 1/4W	E1
CP190			RK74HB1J101J	CHIP-COM 100 J 1/16W	E1	R194			RK73GB2A222J	CHIP R 2.2K J 1/10W	
CP420			RK74GA1J101J	CHIP-COM 100 J 1/16W		R195			RK73GB2A473J	CHIP R 47K J 1/10W	
CP421			RK74HB1J101J	CHIP-COM 100 J 1/16W		R200			RK73GB2A101J	CHIP R 100 J 1/10W	
CP501			RK74HB1J101J	CHIP-COM 100 J 1/16W		R210			RK73GB2A473J	CHIP R 47K J 1/10W	
CP503			RK74GA1J101J	CHIP-COM 100 J 1/16W		R211			RK73GB2A104J	CHIP R 100K J 1/10W	
CP504			RK74GA1J472J	CHIP-COM 4.7K J 1/16W		R214-216			RK73GB2A101J	CHIP R 100 J 1/10W	
CP506			RK74GA1J101J	CHIP-COM 100 J 1/16W		R300			RK73GB2A223J	CHIP R 22K J 1/10W	
R10			RK73GH2A432D	CHIP R 4.3K D 1/10W		R310,311			RK73GB2A102J	CHIP R 1.0K J 1/10W	K
R11			RK73GH2A243D	CHIP R 24K D 1/10W		R312			RK73GH2A111D	CHIP R 110 D 1/10W	K
R12			RK73FB2B221J	CHIP R 220 J 1/8W		R313			RK73GH2A241D	CHIP R 240 D 1/10W	K
R20			RK73FB2B153J	CHIP R 15K J 1/8W		R314			RK73GB2A223J	CHIP R 22K J 1/10W	K
R21			RK73GB2A223J	CHIP R 22K J 1/10W		R340-342			RK73GB2A222J	CHIP R 2.2K J 1/10W	KE1E2
R22			RK73GB2A272J	CHIP R 2.7K J 1/10W		R343			RK73GB2A102J	CHIP R 1.0K J 1/10W	KE1E2
R30			RK73FB2B152J	CHIP R 1.5K J 1/8W		R344			RK73GB2A223J	CHIP R 22K J 1/10W	KE1E2
R40			RK73FB2B471J	CHIP R 470 J 1/8W		R345			RK73GB2A222J	CHIP R 2.2K J 1/10W	KE1E2
R41			RK73GB2A223J	CHIP R 22K J 1/10W		R350			RK73GB2A2R2J	CHIP R 2.2 J 1/10W	KE1E2
R46			RK73FB2B102J	CHIP R 1.0K J 1/8W		R350			RK73GB2A2R2J	CHIP R 2.2 J 1/10W	M1
R47			RK73GB2A223J	CHIP R 22K J 1/10W		R351			RK73GB2A332J	CHIP R 3.3K J 1/10W	KE1E2
R50			RK73FB2B152J	CHIP R 1.5K J 1/8W		R351			RK73GB2A332J	CHIP R 3.3K J 1/10W	M1
R60			RK73GB2A203J	CHIP R 20K J 1/10W		R352			RK73GB2A2R2J	CHIP R 2.2 J 1/10W	KE1E2
R61			RK73PB2H1R0J	CHIP R 1.0 J 1/2W		R352			RK73GB2A2R2J	CHIP R 2.2 J 1/10W	M1
R65			RK73GB2A103J	CHIP R 10K J 1/10W		R353			RK73GB2A221J	CHIP R 220 J 1/10W	KE1E2
R66			RK73GH2A103D	CHIP R 10K D 1/10W		R353			RK73GB2A221J	CHIP R 220 J 1/10W	M1
R67		*	RK73GH2A514D	CHIP R 510K D 1/10W		R354-356			RK73GB2A102J	CHIP R 1.0K J 1/10W	KE1E2
R72			RK73GH2A912D	CHIP R 9.1K D 1/10W		R354-356			RK73GB2A102J	CHIP R 1.0K J 1/10W	M1
R73			RK73EB2E361J	CHIP R 360 J 1/4W		R357			RK73GB2A513J	CHIP R 51K J 1/10W	KE1E2
R80			RK73GH2A104D	CHIP R 100K D 1/10W		R357			RK73GB2A513J	CHIP R 51K J 1/10W	M1
R81			RK73GH2A473D	CHIP R 47K D 1/10W		R358			RK73GB2A472J	CHIP R 4.7K J 1/10W	KE1E2
R82			RK73GB2A103J	CHIP R 10K J 1/10W		R358			RK73GB2A472J	CHIP R 4.7K J 1/10W	M1
R83			RK73GH2A333D	CHIP R 33K D 1/10W		R359			RK73FB2B102J	CHIP R 1.0K J 1/8W	KE1E2
R84			RK73GH2A163D	CHIP R 16K D 1/10W		R359			RK73FB2B102J	CHIP R 1.0K J 1/8W	M1
R120,121			RK73GB2A103J	CHIP R 10K J 1/10W		R360			RK73GB2A473J	CHIP R 47K J 1/10W	KE1E2
R126			RK73GB2A183J	CHIP R 18K J 1/10W		R360			RK73GB2A473J	CHIP R 47K J 1/10W	M1
R127			RK73FB2B203J	CHIP R 20K J 1/8W		R361			RK73PB2H220J	CHIP R 22 J 1/2W	KE1E2
R128			RK73GB2A104J	CHIP R 100K J 1/10W		R361			RK73PB2H220J	CHIP R 22 J 1/2W	M1
R129			RK73EB2E473J	CHIP R 47K J 1/4W		R362			RK73GB2A222J	CHIP R 2.2K J 1/10W	KE1E2
R130			RK73EB2E102J	CHIP R 1.0K J 1/4W		R362			RK73GB2A222J	CHIP R 2.2K J 1/10W	M1
R131			RK73GB2A473J	CHIP R 47K J 1/10W		R370			RK73FB2B181J	CHIP R 180 J 1/8W	
R132			RK73FB2B683J	CHIP R 68K J 1/8W		R371			RK73GB2A331J	CHIP R 330 J 1/10W	
R133,134			RK73EB2E102J	CHIP R 1.0K J 1/4W		R372,373			RK73GB2A223J	CHIP R 22K J 1/10W	
R140-142			RK73PB2H561J	CHIP R 560 J 1/2W		R374			RK73FB2B181J	CHIP R 180 J 1/8W	
R143			RK73GB2A223J	CHIP R 22K J 1/10W		R375			RK73GB2A331J	CHIP R 330 J 1/10W	
R144			RK73PB2H561J	CHIP R 560 J 1/2W		R376			RK73FB2B181J	CHIP R 180 J 1/8W	
R145			RK73FB2B472J	CHIP R 4.7K J 1/8W		R377			RK73GB2A331J	CHIP R 330 J 1/10W	
R146			RK73GB2A000J	CHIP R 0.0 J 1/10W	E1E2	R378,379			RK73GB2A223J	CHIP R 22K J 1/10W	

E1 : KDC-W7541U E2 : KDC-W7541UY (Europe)
K : KDC-X792 K1 : KDC-MP738U (North America)
M : KDC-X8009U (Other Areas)

△ Indicates safety critical components.

PARTS LIST

ELECTRIC UNIT (X34-579x-xx)

Ref. No.	Add	New	Parts No.	Description	Destination
R380			RK73FB2B181J	CHIP R 180 J 1/8W	
R381			RK73GB2A331J	CHIP R 330 J 1/10W	
R382			RK73FB2B181J	CHIP R 180 J 1/8W	
R383			RK73GB2A331J	CHIP R 330 J 1/10W	
R384,385			RK73GB2A223J	CHIP R 22K J 1/10W	
R386			RK73FB2B181J	CHIP R 180 J 1/8W	
R387			RK73GB2A331J	CHIP R 330 J 1/10W	
R401			RK73GB2A223J	CHIP R 22K J 1/10W	
R402			RK73FB2B821J	CHIP R 820 J 1/8W	
R403,404			RK73GB2A471J	CHIP R 470 J 1/10W	
R410,411			RK73GB2A123J	CHIP R 12K J 1/10W	
R412,413			RK73EB2E100J	CHIP R 10 J 1/4W	
R414			RK73EB2E4R7J	CHIP R 4.7 J 1/4W	
R415			RK73GB2A102J	CHIP R 1.0K J 1/10W	
R420-424			RK73EB2E432J	CHIP R 4.3K J 1/4W	
R425			RK73EB2E101J	CHIP R 100 J 1/4W	
R426			RK73EB2E100J	CHIP R 10 J 1/4W	
R427			RK73EB2E4R7J	CHIP R 4.7 J 1/4W	
R428			RK73EB2E100J	CHIP R 10 J 1/4W	
R429			RK73EB2E432J	CHIP R 4.3K J 1/4W	
R430			RK73EB2E101J	CHIP R 100 J 1/4W	
R431			RK73GB2A102J	CHIP R 1.0K J 1/10W	
R432			RK73GB2A104J	CHIP R 100K J 1/10W	
R433,434			RK73GB2A473J	CHIP R 47K J 1/10W	
R435			RK73GB2A101J	CHIP R 100 J 1/10W	
R440			RK73GB2A473J	CHIP R 47K J 1/10W	
R441			RK73GB2A101J	CHIP R 100 J 1/10W	
R442			RK73GB2A104J	CHIP R 100K J 1/10W	
R450			RK73GB2A133J	CHIP R 13K J 1/10W	
R451			RK73GB2A473J	CHIP R 47K J 1/10W	
R452			RK73GB2A331J	CHIP R 330 J 1/10W	
R453			RK73GB2A432J	CHIP R 4.3K J 1/10W	
R456			RK73GB2A100J	CHIP R 10 J 1/10W	
R469			RK73GB2A473J	CHIP R 47K J 1/10W	
R482,483			RK73GB2A103J	CHIP R 10K J 1/10W	
R490			RK73EB2E2R2J	CHIP R 2.2 J 1/4W	
R500,501			RK73GB2A103J	CHIP R 10K J 1/10W	
R502			RK73GB2A104J	CHIP R 100K J 1/10W	
R503			RK73GB2A102J	CHIP R 1.0K J 1/10W	
R505			RK73GB2A473J	CHIP R 47K J 1/10W	
R506			RK73GB2A104J	CHIP R 100K J 1/10W	
R507			RK73GB2A102J	CHIP R 1.0K J 1/10W	
R508,509			RK73GB2A472J	CHIP R 4.7K J 1/10W	
R511			RK73GB2A101J	CHIP R 100 J 1/10W	
R512-514			RK73GB2A473J	CHIP R 47K J 1/10W	
R515,516			RK73GB2A471J	CHIP R 470 J 1/10W	
R517,518			RK73GB2A104J	CHIP R 100K J 1/10W	
R519,520			RK73GB2A473J	CHIP R 47K J 1/10W	
R522,523			RK73GB2A473J	CHIP R 47K J 1/10W	
R525			RK73GB2A222J	CHIP R 2.2K J 1/10W	
R526			RK73EB2E333J	CHIP R 33K J 1/4W	
R527			RK73GB2A333J	CHIP R 33K J 1/10W	
R528			RK73GB2A223J	CHIP R 22K J 1/10W	
R529			RK73GB2A473J	CHIP R 47K J 1/10W	
R530			RK73GB2A223J	CHIP R 22K J 1/10W	K KK1M1

Ref. No.	Add	New	Parts No.	Description	Destination
R530			RK73GB2A473J	CHIP R 47K J 1/10W	E2
R532			RK73GB2A473J	CHIP R 47K J 1/10W	
R533			RK73GB2A223J	CHIP R 22K J 1/10W	
R534			RK73GB2A000J	CHIP R 0.0 J 1/10W	
R540			RK73GB2A223J	CHIP R 22K J 1/10W	E1E2
R540			RK73GB2A473J	CHIP R 47K J 1/10W	M1
R542			RK73GB2A104J	CHIP R 100K J 1/10W	
R543			RK73GB2A223J	CHIP R 22K J 1/10W	
R544			RK73GB2A222J	CHIP R 2.2K J 1/10W	
R600-602			RK73GB2A101J	CHIP R 100 J 1/10W	
R603,604			RK73GB2A223J	CHIP R 22K J 1/10W	
R605			RK73GB2A102J	CHIP R 1.0K J 1/10W	
R606,607			RK73GB2A223J	CHIP R 22K J 1/10W	
R650			RK73GB2A471J	CHIP R 470 J 1/10W	
R651			RK73GB2A104J	CHIP R 100K J 1/10W	
R653			RK73GB2A102J	CHIP R 1.0K J 1/10W	
R700			RK73GB2A000J	CHIP R 0.0 J 1/10W	
R701			RK73FB2B2R2J	CHIP R 2.2 J 1/8W	
R702			RK73GB2A000J	CHIP R 0.0 J 1/10W	
R704			RK73GB2A223J	CHIP R 22K J 1/10W	
R705			RK73GB2A101J	CHIP R 100 J 1/10W	
R706			RK73GB2A223J	CHIP R 22K J 1/10W	
R707			RK73GB2A104J	CHIP R 100K J 1/10W	
R708			RK73GB2A101J	CHIP R 100 J 1/10W	
R709,710			RK73GB2A102J	CHIP R 1.0K J 1/10W	
R711			RK73GB2A223J	CHIP R 22K J 1/10W	
R713			RK73GB2A101J	CHIP R 100 J 1/10W	
R714			RK73GB2A223J	CHIP R 22K J 1/10W	
R715			RK73GB2A102J	CHIP R 1.0K J 1/10W	
R716			RK73GB2A101J	CHIP R 100 J 1/10W	
R719			RK73GB2A101J	CHIP R 100 J 1/10W	
R720			RK73GB2A223J	CHIP R 22K J 1/10W	
R721,722			RK73GB2A101J	CHIP R 100 J 1/10W	
R723			RK73GB2A223J	CHIP R 22K J 1/10W	
R724			RK73GB2A101J	CHIP R 100 J 1/10W	
R725			RK73GB2A472J	CHIP R 4.7K J 1/10W	
R726			RK73GB2A101J	CHIP R 100 J 1/10W	
R727			RK73GB2A105J	CHIP R 1.0M J 1/10W	
R728			RK73GB2A153J	CHIP R 15K J 1/10W	
R729			RK73GB2A330J	CHIP R 33 J 1/10W	
R730			RK73GB2A153J	CHIP R 15K J 1/10W	
R731			RK73GB2A330J	CHIP R 33 J 1/10W	
R732			RK73GB2A153J	CHIP R 15K J 1/10W	
R733			RK73GB2A472J	CHIP R 4.7K J 1/10W	
R734-737			RK73GB2A101J	CHIP R 100 J 1/10W	
R738			RK73GB2A223J	CHIP R 22K J 1/10W	
R739			RK73GB2A101J	CHIP R 100 J 1/10W	
R741			RK73GB2A332J	CHIP R 3.3K J 1/10W	
R743			RK73GB2A332J	CHIP R 3.3K J 1/10W	
R744-746			RK73GB2A101J	CHIP R 100 J 1/10W	
R747			RK73GB2A223J	CHIP R 22K J 1/10W	
R750			RK73GB2A333J	CHIP R 33K J 1/10W	
R751			RK73GB2A515J	CHIP R 5.1M J 1/10W	
R757			RK73GH2A104D	CHIP R 100K D 1/10W	
R758-760			RK73GB2A473J	CHIP R 47K J 1/10W	

E1 : KDC-W7541U E2 : KDC-W7541UY (Europe)
K : KDC-X792 K1 : KDC-MP738U (North America)

△Indicates safety critical components.

PARTS LIST

ELECTRIC UNIT (X34-579x-xx)

Ref. No.	Add	New	Parts No.	Description	Destination	Ref. No.	Add	New	Parts No.	Description	Destination
R761			RK73GB2A101J	CHIP R 100 J 1/10W		IC300			STMP2151STR	MOS-IC	
R763			RK73GB2A223J	CHIP R 22K J 1/10W		IC310		*	MMA6270QR2	ANALOGUE IC	K
R767			RK73GB2A223J	CHIP R 22K J 1/10W		IC340			E-TDA7478AD	ANALOGUE IC	KE1E2
R769			RK73GB2A473J	CHIP R 47K J 1/10W		IC350			NJM4565V-ZB	ANALOGUE IC	KE1E2
R901			RK73GB2A000J	CHIP R 0.0 J 1/10W		IC350			NJM4565V-ZB	ANALOGUE IC	M1
R903			RK73GB2A100J	CHIP R 10 J 1/10W		IC450			TB2923HQ	ANALOGUE IC	
R908			RK73GB2A100J	CHIP R 10 J 1/10W		IC480			E-TDA7415CB	ANALOGUE IC	
R963			RK73GB2A102J	CHIP R 1.0K J 1/10W		IC500		*	30624MGPB77GP	MICROCONTROLLER IC	
R990			RK73GB2A1R5J	CHIP R 1.5 J 1/10W		IC510			XC6120N362N1	MOS-IC	
R999			RK73GB2A2R2J	CHIP R 2.2 J 1/10W		IC520			BR24L04FV-W	ROM IC	
W350			R92-2053-05	CHIP R 0 OHM J 1/8W	K1	IC530			74HC2G02DP	MOS-IC	
W401			R92-2053-05	CHIP R 0 OHM J 1/8W		IC600			74AHCT08PW	MOS-IC	
S650			S74-0809-05	MICRO SWITCH		IC602			74LVC08APW	MOS-IC	
D1			S2V60-5009F46	DIODE		IC700		*	92CD28AFG6V1	MICROCONTROLLER IC	
D20		*	D1FJ4	DIODE		IC751			BR24L04FV-W	ROM IC	
D21			UDZW5.6 (B)	ZENER DIODE		IC752			341S2094	MICROPROCESSOR IC	
D30			UDZW8.2 (B)	ZENER DIODE		Q10			KTA1046-P	TRANSISTOR	
D50			UDZW12 (B)	ZENER DIODE		Q11			DTA124EUA	DIGITAL TRANSISTOR	
D61-63		*	D1FJ4	DIODE		Q12			DTC124EUA	DIGITAL TRANSISTOR	
D70		*	UDZW15 (B)	ZENER DIODE		Q13			DTA124EUA	DIGITAL TRANSISTOR	
D80			EC31QS04AG	DIODE		Q14			DTC124EUA	DIGITAL TRANSISTOR	
D121,122			UDZW6.8 (B)	ZENER DIODE		Q20			KTA1046-P	TRANSISTOR	
D123			UDZW6.2 (B)	ZENER DIODE		Q21			2SC4081	TRANSISTOR	
D140			DAP202U	DIODE		Q22			2SA1577	TRANSISTOR	
D141,142			1SR154-400	DIODE		Q23			DTC124EUA	DIGITAL TRANSISTOR	
D150,151			1SR154-400	DIODE		Q30			KTA1046-P	TRANSISTOR	
D170			UDZW4.7 (B)	ZENER DIODE		Q31			2SC4081	TRANSISTOR	
D190			UDZW6.2 (B)	ZENER DIODE	KK1E2	Q40			2SB1689	TRANSISTOR	
D190			UDZW6.2 (B)	ZENER DIODE	M1	Q41			DTC114YUA	DIGITAL TRANSISTOR	
D190-193			UDZW6.2 (B)	ZENER DIODE	E1	Q45			2SB1689	TRANSISTOR	
D200,201			AVRL1613R3FTA	VARISTOR		Q46			DTC114YUA	DIGITAL TRANSISTOR	
D350			1SR154-400	DIODE	KE1E2	Q50			2SB1184	TRANSISTOR	
D350			1SR154-400	DIODE	M1	Q51			2SC4081	TRANSISTOR	
D351			DAP202U	DIODE	KE1E2	Q52			DTA124EUA	DIGITAL TRANSISTOR	
D351			DAP202U	DIODE	M1	Q53			DTC124EUA	DIGITAL TRANSISTOR	
D352			UDZW12 (B)	ZENER DIODE	KE1E2	Q70			KTA1046-P	TRANSISTOR	
D352			UDZW12 (B)	ZENER DIODE	M1	Q71			2SC4081	TRANSISTOR	
D353			UDZW5.6 (B)	ZENER DIODE	KE1E2	Q80			DTC144EUA	DIGITAL TRANSISTOR	
D353			UDZW5.6 (B)	ZENER DIODE		Q120			2SC4081	TRANSISTOR	
D353			UDZW5.6 (B)	ZENER DIODE	M1	Q122,123			2SC4081	TRANSISTOR	
D370			DAP202U	DIODE		Q140			DTC114YUA	DIGITAL TRANSISTOR	
D373			DAP202U	DIODE		Q141			DTA114EUA	DIGITAL TRANSISTOR	
D410-412			UDZW6.8 (B)	ZENER DIODE		Q142			2SA1576A	TRANSISTOR	
D420-422			UDZW6.8 (B)	ZENER DIODE		Q143			2SB1188 (Q,R)	TRANSISTOR	
D423			UDZW6.2 (B)	ZENER DIODE		Q150			2SB1188 (Q,R)	TRANSISTOR	KK1M1
D428			UDZW6.2 (B)	ZENER DIODE		Q151			DTC114YUA	DIGITAL TRANSISTOR	KK1M1
D451			DAP202U	DIODE		Q180			DTC144EUA	DIGITAL TRANSISTOR	
D454			1SR154-400	DIODE		Q350			2SB1443	TRANSISTOR	KE1E2
D458			1SR154-400	DIODE		Q350			2SB1443	TRANSISTOR	M1
D458			1SR154-400	DIODE		Q351,352			2SC4081	TRANSISTOR	KE1E2
D484-486			DAP202U	DIODE		Q351,352			2SC4081	TRANSISTOR	M1
IC10			M5237ML-CF0J	ANALOGUE IC		Q353			DTA124EUA	DIGITAL TRANSISTOR	KE1E2
IC20			R1114N331B-TR	ANALOGUE IC (3.3V LF)		Q353		*	DTA124EUA	DIGITAL TRANSISTOR	M1
IC60			LT3489	ANALOGUE IC		Q354			DTC124EUA	DIGITAL TRANSISTOR	KE1E2
IC80			LT3684EMSE	ANALOGUE IC		Q354			DTC124EUA	DIGITAL TRANSISTOR	M1

E1 : KDC-W7541U E2 : KDC-W7541UY (Europe)
K : KDC-X792 K1 : KDC-MP738U (North America)
M : KDC-X8009U (Other Areas)

△ Indicates safety critical components.

PARTS LIST

ELECTRIC UNIT (X34-579x-xx)

Ref. No.	A d d	N e w	Parts No.	Description	Desti- nation
Q370			DTC143TUA	DIGITAL TRANSISTOR	
Q371			DTA124EUA	DIGITAL TRANSISTOR	
Q372-376			DTC143TUA	DIGITAL TRANSISTOR	
Q377			DTA124EUA	DIGITAL TRANSISTOR	
Q400			2SA1577	TRANSISTOR	
Q401			DTC124EUA	DIGITAL TRANSISTOR	
Q500			2SB1260	TRANSISTOR	
Q501			2SC2713-F	TRANSISTOR	
Q650			DTA114YUA	DIGITAL TRANSISTOR	
Q702			DTC114YUA	DIGITAL TRANSISTOR	
Q703			2SA1577	TRANSISTOR	
Q704,705			DTC114YUA	DIGITAL TRANSISTOR	
TH450			PRF18BE471QS2	POSITIVE RESISTOR	
A400			X86-4030-11	FRONT-END UNIT	KK1M1
A400			X86-4032-70	FRONT-END UNIT	E1E2
CD MECHANISM ASSY (X92-6130-00) (DXM-6E20W)					
1	2B		A10-5328-31	CHASSIS	
2	1B		A10-5329-11	CHASSIS	
5	2B		D10-4910-13	ARM ASSY	
8	2A		D10-4911-23	LEVER ASSY	
10	2A		D10-4906-33	ARM	
11	2A		D10-4907-33	ARM	
12	3A		D10-4908-03	ARM	
13	3A		D10-4909-03	ARM	
14	3B		D10-4915-03	ARM	
15	2A		D10-4916-23	SLIDER	
16	3B		D10-4914-22	SLIDER	
17	2B		D10-4588-13	SLIDER	
18	2B		D10-4917-04	ARM	
19	2B		D10-4596-24	ARM	
22	2A		D13-2151-04	GEAR	
23	2B		D13-2152-04	GEAR	
24	3B		D13-2153-04	GEAR	
25	3B		D13-2154-04	GEAR	
26	3B		D13-2155-04	WORM	
27	2B		D13-2156-14	GEAR	
28	3B		D13-2157-04	GEAR	
29	2B		D13-2158-04	GEAR	
30	2B		D13-2168-04	GEAR	
31	3B		D13-2171-04	GEAR	
32	1B		D13-2400-23	RACK (GEAR)	
33	2A		D14-0759-04	ROLLER	
35	2B		D21-2382-04	SHAFT	
36	1A		D23-0954-04	RETAINER	
37	1B		D39-0271-05	DAMPER	
38	2B		G01-3072-04	EXTENSION SPRING	
39	2A		G01-3073-04	TORSION COIL SPRING	
40	2A		G01-3074-04	EXTENSION SPRING	
41	1B		G01-4615-04	EXTENSION SPRING	
42	2A		G01-3076-04	EXTENSION SPRING	
43	1B		G01-3077-14	EXTENSION SPRING	
44	2B		G02-1399-14	FLAT SPRING	
45	2B		G02-1547-14	FLAT SPRING	

Ref. No.	A d d	N e w	Parts No.	Description	Desti- nation
51	1A		J22-0473-21	MOUNTING HARDWARE	
52	3B		J22-0474-12	MOUNTING HARDWARE	
53	1B		J22-0519-13	MOUNTING HARDWARE	
55	1A		J90-1138-41	GUIDE	
56	1B		J90-1023-03	GUIDE	
DFPC1	3A		J86-0039-05	FPC (LEAD FREE)	
A	2B		N09-4460-15	TAPTITE SCREW (PT 2X8)	
B	1B		N09-6317-05	TAPTITE SCREW (PT 1.7X6)	
C	2B		N09-6004-15	MACHINE SCREW (M1.7X2.5)	
E	2B		N09-6007-15	MACHINE SCREW (PAN M2X2)	
F	1A		N09-6051-15	TAPTITE SCREW (BIND P 2X5)	
G	2A		N19-2163-04	FLAT WASHER (1.6X6X0.25)	
H	1B		N39-2020-48	PAN HEAD MACHINE SCREW	
J	1B		N09-6108-15	TAPTITE SCREW (M2X3.5)	
K	3B		N09-6155-15	SEMS (TAPTITE SCREW) (PT 2X6)	
DM1	3B		T42-1066-14	DC MOTOR (SPINDLE)	
DM2	2B		T42-1067-14	DC MOTOR (LOADING/SLED)	
DPU1	2B		X93-2130-01	OPTICAL PICKUP ASSY	