

NO.	PART NO.	DESCRIPTION	Q'TY
1	-	N/A(UPPER-CASE)	-
2	-	N/A(UPPER CASE-S)	-
3	310-2010-11	UPPER-CASE-SB	-
4	-	N/A(HEAT-SINK)	-
5	-	N/A(HEAT SINK-S)	-
6	948-1085-00	FRONT-CVR-ASSY	1
7	-	N/A(FRONT-COV-ASSY)	-
8	-	N/A(FRONT-COV-ASSY)	-
9	-	N/A(REAR-COVER)	-
10	307-0811-42	REAR-COVER-N	1
11	-	N/A(REAR-COVER-J)	-
12	-	N/A(B-CAS-SIM-CVR)	-
13	-	N/A(DVD-MECH-MODULE)	-
14	-	N/A(DVD-MECH-MODULE: ATA)	-
15	-	N/A(DVD-HLD-ASSY)	-
16	-	N/A(FLAT-WIRE-B)	-
17	-	N/A(FLAT-WIRE-A)	-
18	929-5210-80	CD-MECH-MODULE	1
19	816-4081-00	FLAT WIRE	1
20	-	N/A(FLAT-WIRE-D)	-
21	331-5363-01	IF-PWB-HOLDER	1
△ 22	345-6636-00	FAN-RUBBER (for PN-3554E-A)	1
△ 23	020-3064-00	DC-MOTOR (for PN-3554E-A)	1
24	331-5364-01	AUDIO-PWB-HOLDE	1
25	-	N/A(LOWER-CASE)	-
26	311-2061-01	LOWER CASE-S	1
27	-	N/A(SD-CVR)	-
28	-	N/A(SD-CARD)	-
29	-	N/A(ANT-TAPE)	-
△ 30	-	-	-
31	780-2604-50	IT SCREW	19
32	-	N/A(MACHINE SCREW)	-
33	-	N/A(MACHINE SCREW)	-
34	714-2603-8B	MACHINE SCREW	4
35	714-2604-8B	MACHINE SCREW	21
36	MJZ1024	SCREW(2.6x3.5)	3
37	-	N/A(GASKET-A)	-
38	-	N/A(GASKET-B)	-
39	-	N/A(GASKET-C)	-
40	-	-	-

NO.	PART NO.	DESCRIPTION	Q'TY
41	345-5994-00	CUSHION RUBBER	△ 1
42	347-9152-01	PAPER PART	1
△ 43	276-1148-05 276-1148-57	SETPLATE (for PN-3554E-A) SETPLATE (for PN-3554E-B)	1 1
44	276-0779-00	SETPLATE(XM)	1
45	-	N/A(LABEL: B-CAS CARD ID)	-
46	-	-	-
47	-	N/A(MINI B-CAS-CARD)	-
48	714-2605-8B	MACHINE SCREW	10
49	-	N/A(EMC-SHEET)	-
50	-----	IF-PWB-ASSY(3519A7-77)	1
50-1	-	N/A(GASKET-D)	-
51	-----	IF-PWB-ASSY(3519A7-77)	1
△ 52	-----	MAIN-PWB-ASSY (3554A7-75) (for PN-3554E-A) (3554B7-75) (for PN-3554E-B)	1
52-1	331-5367-10	CN-HOLDER-AUDIO	1
52-2	-	N/A(AMP-HOLDER)	-
52-3	331-5366-01	CN-HOLDER-PWR	1
52-4	-	N/A(SHIELD-CASE)	-
52-5	347-9244-00	PAPER PART	1
52-6	-	N/A(GASKET-E)	-
52-7	-	N/A(GASKET-F)	-
52-8	-	N/A(GASKET-G)	-
52-9	-	N/A(GASKET-H)	-
52-10	-	N/A(GASKET-I)	-
52-11	-	N/A(GASKET-J)	-
53	-	N/A(DAB-PWB-ASSY)	-
53-1	-	N/A(CN-HOLDER-FAKRA)	-
53-2	-	N/A(MACHINE-SCREW)	-
54	-	N/A(12DTV-PWB-ASSY)	-
54-1	-	N/A(ANTENNA-JACK HOLDER)	-
54-2	-	N/A(SHIELD-CASE: BOTTOM)	-
54-3	-	N/A(SHIELD-CASE: TOP)	-
54-4	-	N/A(MACHINE-SCREW)	-
△ 55	.882-9109A	XM-PWB-ASSY(3557A7-78)	1
55-1	331-5391-00	FAKRA-ANT-HOLDE	1
55-2	855-0617-02	EXTENSION LEAD	1
55-3	714-2604-8B	MACHINE SCREW	1
△ 55-4	347-9141-00	THEAMAL-SHEET	2

ELECTRICAL PARTS LIST

MAIN PWB(B1) section

REF No.	PART No.	DESCRIPTION	REF No.	PART No.	DESCRIPTION	REF No.	PART No.	DESCRIPTION
C101	178-1062-88	10uF	C204	046-1042-78	0.1uF K B	C331	045-3901-50	39pFJ CH
C102	046-1042-78	0.1uF K B	C205	046-1042-78	0.1uF K B	C332	045-3901-50	39pFJ CH
C103	046-1042-78	0.1uF K B	C210	168-4752-98	4.7uF K	C333	045-1211-50	120pFJ CH
C104	046-1042-78	0.1uF K B	C211	168-4752-98	4.7uF K	C334	045-1211-50	120pFJ CH
C105	046-1042-78	0.1uF K B	C212	046-1042-78	0.1uF K B	C335	045-2211-50	220pFJ CH
C106	046-1042-78	0.1uF K B	C213	046-1042-78	0.1uF K B	C336	046-1022-58	50V 1000pF
C107	178-1062-88	10uF	C214	046-1042-78	0.1uF K B	C337	046-3922-58	3900pF K B
C108	046-1042-78	0.1uF K B	C215	046-1042-78	0.1uF K B	C338	046-1022-58	50V 1000pF
C109	046-1042-78	0.1uF K B	C216	046-1042-78	0.1uF K B	C339	046-1022-58	50V 1000pF
C110	046-1042-78	0.1uF K B	C217	045-8097-50	8 +/-0.5pF CH	C340	046-1022-58	50V 1000pF
C111	046-1042-78	0.1uF K B	C218	046-1042-78	0.1uF K B	C341	046-1032-78	0.01uF K B
C112	178-1062-88	10uF	C219	045-1007-50	10 +/-0.5pF CH	C342	046-1032-78	0.01uF K B
C113	046-1042-78	0.1uF K B	C220	046-1042-78	0.1uF K B	C343	045-5096-50	5 +/-0.25pF CH
C114	046-1042-78	0.1uF K B	C225	168-4752-98	4.7uF K	C344	045-5096-50	5 +/-0.25pF CH
C115	046-1032-78	0.01uF K B	C226	046-1042-78	0.1uF K B	C345	046-3322-58	3300pF K B
C116	046-1042-78	0.1uF K B	C228	046-1042-78	0.1uF K B	C346	046-3322-58	3300pF K B
C117	046-1042-78	0.1uF K B	C229	045-2201-50	22pFJ CH	C347	046-2232-78	0.022uF K B
C118	046-1042-78	0.1uF K B	C230	046-1042-78	0.1uF K B	C348	046-2232-78	0.022uF K B
C119	046-1042-78	0.1uF K B	C231	042-0630-50	16V 100uF	C349	046-1022-58	50V 1000pF
C120	046-1042-78	0.1uF K B	C232	046-1042-78	0.1uF K B	C350	043-0563-90	16V 47uF
C121	046-1042-78	0.1uF K B	C233	168-4752-98	4.7uF K	C351	046-2232-78	0.022uF K B
C122	046-1042-78	0.1uF K B	C234	046-1042-78	0.1uF K B	C352	043-0562-90	10V 0.22uF
C123	046-1032-78	0.01uF K B	C236	046-1042-78	0.1uF K B	C353	046-2232-78	0.022uF K B
C124	046-1042-78	0.1uF K B	C237	043-0559-90	6.3V 22uF	C354	046-2232-78	0.022uF K B
C125	046-1042-78	0.1uF K B	C238	168-1052-78	16V 1uF K	C355	046-1022-58	50V 1000pF
C126	046-1042-78	0.1uF K B	C239	046-1042-78	0.1uF K B	C356	043-0563-90	16V 47uF
C127	046-1042-78	0.1uF K B	C240	046-1042-78	0.1uF K B	C357	046-2232-78	0.022uF K B
C128	045-1011-50	100pFJ CH	C241	046-1042-78	0.1uF K B	C358	043-0562-90	10V 0.22uF
C129	046-1042-78	0.1uF K B	C242	046-1042-78	0.1uF K B	C359	046-2232-78	0.022uF K B
C130	046-1042-78	0.1uF K B	C243	043-0552-90	6.3V 47uF M	C360	046-2232-78	0.022uF K B
C131	046-1042-78	0.1uF K B	C244	043-0559-90	6.3V 22uF	C361	046-2232-78	0.022uF K B
C132	046-1042-78	0.1uF K B	C245	168-1052-78	16V 1uF K	C362	046-2232-78	0.022uF K B
C133	045-1011-50	100pFJ CH	C246	046-1042-78	0.1uF K B	C363	046-2232-78	0.022uF K B
C134	046-1042-78	0.1uF K B	C247	045-2201-50	22pFJ CH	C364	046-2232-78	0.022uF K B
C135	046-1042-78	0.1uF K B	C248	046-1042-78	0.1uF K B	C379	046-5612-58	560pF K B
C136	046-1042-78	0.1uF K B	C249	046-1042-78	0.1uF K B	C380	168-1052-78	16V 1uF K
C137	046-1042-78	0.1uF K B	C250	045-2201-50	22pFJ CH	C381	043-7701-90	2.2uF
C138	046-1042-78	0.1uF K B	C251	046-1042-78	0.1uF K B	C382	AAZ0293	25V 10uF 10%
C139	046-1042-78	0.1uF K B	C252	046-1042-78	0.1uF K B	C601	043-7503-90	4.7uF
C140	046-1042-78	0.1uF K B	C253	046-1042-78	0.1uF K B	C602	045-1011-50	100pFJ CH
C141	046-1042-78	0.1uF K B	C254	046-1042-78	0.1uF K B	C603	046-3332-78	0.033uF K B
C142	045-1201-50	12pFJ CH	C255	046-1022-58	50V 1000pF	C604	043-6400-90	16V 4.7uF K
C143	046-1042-78	0.1uF K B	C256	046-1042-78	0.1uF K B	C605	165-4763-15	6.3V 47uF
C144	046-1042-78	0.1uF K B	C257	045-4711-50	470pFJ CH	C606	046-1042-78	0.1uF K B
C145	046-1042-78	0.1uF K B	C258	042-4033-90	6.3V 220uF	C607	165-3363-25	10V 33uF
C146	046-1042-78	0.1uF K B	C259	046-3322-58	3300pF K B	C610	046-1042-78	0.1uF K B
C147	045-1201-50	12pFJ CH	C260	046-1042-78	0.1uF K B	C701	045-2201-50	22pFJ CH
C148	046-1042-78	0.1uF K B	C262	046-3322-58	3300pF K B	C703	045-2201-50	22pFJ CH
C149	046-1042-78	0.1uF K B	C263	046-3322-58	3300pF K B	C705	046-1042-78	0.1uF K B
C150	045-1011-50	100pFJ CH	C264	046-3322-58	3300pF K B	C708	046-1042-78	0.1uF K B
C151	046-1042-78	0.1uF K B	C265	046-3322-58	3300pF K B	C709	045-2201-50	22pFJ CH
C152	046-1042-78	0.1uF K B	C266	046-3322-58	3300pF K B	C710	045-2201-50	22pFJ CH
C153	046-1042-78	0.1uF K B	C273	046-1042-78	0.1uF K B	C712	045-2201-50	22pFJ CH
C154	178-1062-88	10uF	C290	AAZ0331	6.3V 10uF	C714	045-2201-50	22pFJ CH
C155	178-1062-88	10uF	C291	043-4306-90	1uF	C715	045-2201-50	22pFJ CH
C156	046-1042-78	0.1uF K B	C292	043-4306-90	1uF	C716	045-2201-50	22pFJ CH
C157	046-1042-78	0.1uF K B	C293	043-0552-90	6.3V 47uF M	C717	045-2201-50	22pFJ CH
C158	046-1042-78	0.1uF K B	C294	043-0554-90	25V 10uF	C801	046-1032-78	0.01uF K B
C159	046-1042-78	0.1uF K B	C295	046-1022-58	50V 1000pF	C802	046-1022-58	50V 1000pF
C160	046-1042-78	0.1uF K B	C296	043-0554-90	25V 10uF	C803	168-1052-78	16V 1uF K
C161	046-1042-78	0.1uF K B	C306	166-2221-50	2200pF CH	C805	046-1032-78	0.01uF K B
C162	046-1042-78	0.1uF K B	C321	166-1201-50	12pF CH	C806	046-1022-58	50V 1000pF
C163	046-1042-78	0.1uF K B	C322	166-1201-50	12pF CH	C807	045-1011-50	100pFJ CH
C164	046-1042-78	0.1uF K B	C323	046-1022-58	50V 1000pF	C808	043-0605-90	10V 2.2uF
C165	046-1042-78	0.1uF K B	C324	045-2201-50	22pFJ CH	C809	046-1042-78	0.1uF K B
C166	046-1042-78	0.1uF K B	C325	046-1022-58	50V 1000pF	C810	046-1032-78	0.01uF K B
C167	046-1042-78	0.1uF K B	C326	046-1022-58	50V 1000pF	C811	043-0605-90	10V 2.2uF
C168	045-1007-50	10 +/-0.5pF CH	C327	045-5096-50	5 +/-0.25pF CH	C812	046-1042-78	0.1uF K B
C169	045-1007-50	10 +/-0.5pF CH	C328	045-1501-50	15pFJ CH	C901	042-0643-59	16V 47uF
C170	045-1201-50	12pFJ CH	C329	046-1042-78	0.1uF K B	C902	046-1042-78	0.1uF K B
C171	045-1201-50	12pFJ CH	C330	046-1042-78	0.1uF K B	C903	043-7400-90	16V 22uF

REF No.	PART No.	DESCRIPTION	REF No.	PART No.	DESCRIPTION	REF No.	PART No.	DESCRIPTION
C904	043-7503-90	4.7uF	C1509	043-0570-90	16V 2.2uF K	IC702	051-7202-28	TC7SH32FU TE85L
C905	046-1042-78	0.1uF K B	C1510	043-0570-90	16V 2.2uF K	IC703	051-7244-90	TC7WZ125FK-TE85L
C906	046-1042-78	0.1uF K B	C1511	043-0570-90	16V 2.2uF K	IC801	-----	M30281FATHP (Power monitoring microcomputer) (Software should be written on production) (CMZ0561)
C907	045-2211-50	220pFJ CH	C1512	043-0570-90	16V 2.2uF K	IC802	051-5481-90	S-1009N30I-M5T1U
C908	046-2222-58	2200pF K B	C1513	045-2201-50	22pFJ CH	IC803	051-5443-08	BD4850G-TR
C909	046-1022-58	50V 1000pF	C1514	045-2201-50	22pFJ CH	IC804	051-5443-08	BD4850G-TR
C910	046-1042-78	0.1uF K B	C1515	043-0570-90	16V 2.2uF K	IC901	-----	NJM2886DL3-05-TE1 (Voltage regulator) (Thermal pad) (336890-051)
C911	046-1032-78	0.01uF K B	C1516	043-0570-90	16V 2.2uF K	IC902	-----	BD00C0AWFP (Voltage regulator) (Thermal pad) (358290-051)
C913	042-0560-84	16V 47uF	C1517	043-0570-90	16V 2.2uF K	IC904	051-3608-80	LTC3850IGN-1 #TRPBF
C914	043-7503-90	4.7uF	C1518	043-0570-90	16V 2.2uF K	IC906	051-3724-80	S-1172B1C-E6T1U
C915	043-7503-90	4.7uF	C1519	046-2232-78	0.022uF K B	IC907	051-3741-91	NJW4184U2-33A
C916	043-0574-90	25V 1.0uF	C1520	046-2232-78	0.022uF K B	IC1302	051-3034-90	NJM4558V
C918	042-0643-54	25V 470uF	C1521	046-2232-78	0.022uF K B	IC1303	051-2802-90	TDA7476
C920	046-1032-78	0.01uF K B	C1522	046-2232-78	0.022uF K B	IC1501	051-3034-90	NJM4558V
C921	043-6400-90	16V 4.7uF K	C1523	045-2201-50	22pFJ CH	J601	EBZ0031	30P
C922	046-1042-78	0.1uF K B	C1524	045-2201-50	22pFJ CH	J701	074-3062-50	50P
C923	046-1022-58	50V 1000pF	C1525	046-1822-38	1800pF K B	J1301	074-4009-20	20P
C924	045-2211-50	220pFJ CH	C1526	046-1822-38	1800pF K B	J1401	074-3062-50	50P
C925	046-3322-58	3300pF K B	C1527	043-6401-90	16V 10uF	J1402	074-3062-00	100P
C926	046-1042-78	0.1uF K B	C1528	043-6401-90	16V 10uF	J1501	074-1302-16	16P
C927	043-7503-90	4.7uF	C1529	046-1822-38	1800pF K B	J1502	074-1302-12	12P
C928	043-7400-90	16V 22uF	C1530	046-1822-38	1800pF K B	L101	010-3104-54	600 ohm/100MHz
C929	042-0643-59	16V 47uF	D302	001-9013-90	BA891	L102	010-3104-54	600 ohm/100MHz
C934	178-1062-88	10uF	D303	001-9013-90	BA891	L201	010-3104-54	600 ohm/100MHz
C935	046-1022-58	50V 1000pF	D304	001-9013-90	BA891	L202	010-3104-54	600 ohm/100MHz
C938	046-1042-78	0.1uF K B	D305	001-9013-90	BA891	L203	010-3104-54	600 ohm/100MHz
C939	043-5600-90	0.10uF	D307	001-2412-90	RR264M-400	L204	010-3104-54	600 ohm/100MHz
C940	042-0560-58	16V 10uF	D801	001-2403-90	M1F60	L205	010-3104-54	600 ohm/100MHz
C941	043-0603-90	16V 10uF	D802	001-2412-90	RR264M-400	L206	010-3104-54	600 ohm/100MHz
C943	046-1042-78	0.1uF K B	D901	001-2403-90	M1F60	L207	010-3104-54	600 ohm/100MHz
C945	178-1062-88	10uF	D902	001-2629-90	D1FM3-5063	L208	010-3104-54	600 ohm/100MHz
C946	043-0603-90	16V 10uF	D903	001-2633-90	1SS388-TPL3,F	L209	010-3104-54	600 ohm/100MHz
C947	046-1222-38	1200pF K B	D904	001-2633-90	1SS388-TPL3,F	L211	010-3104-54	600 ohm/100MHz
C948	043-0603-90	16V 10uF	IC101	-----	R5S72691P266FP (Microcomputer) (Software should be written on production) (043600-052)	L212	010-3104-54	600 ohm/100MHz
C951	043-7503-90	4.7uF	IC102	051-9326-80	IS45S16800E-6TLA1	L213	010-3104-54	600 ohm/100MHz
C952	046-1042-78	0.1uF K B	IC103	051-9833-10	MX29GL256FHT2I-90 Q (FLASH-ROM)	L214	010-3104-54	600 ohm/100MHz
C953	178-1062-88	10uF	IC108	051-7222-28	TC7SH08FU-TE85L,F	L215	010-3104-54	600 ohm/100MHz
C954	046-1042-78	0.1uF K B	IC109	051-5481-90	S-1009N30I-M5T1U	L216	010-3104-54	600 ohm/100MHz
C955	046-1042-78	0.1uF K B	IC110	051-5482-90	S-1009N11I-N4T1U	L217	010-3104-54	600 ohm/100MHz
C1105	168-1042-38	50V 0.1uF K	IC201	-----	SAF7741HV/N127 (DSP) (Thermal pad) (674710-051)	L218	010-3104-54	600 ohm/100MHz
C1107	045-6097-50	6 +/-0.5pF CH	IC202	051-7106-90	CD4052B-PWR	L219	010-3104-54	600 ohm/100MHz
C1108	046-1022-58	50V 1000pF	IC204	-----	S-24C64CI-T8T5U3 (E2PROM) (Software should be written on production) (943080-051)	L220	010-3105-70	240ohm/100MHz
C1109	045-6097-50	6 +/-0.5pF CH	IC205	-----	BD00C0AWFP (Voltage regulator) (Thermal pad) (358290-051)	L221	010-3104-54	600 ohm/100MHz
C1113	168-1052-78	16V 1uF K	IC301	-----	TEF7000 (Tuner) (thermal pad) (402590-051)	L222	010-3104-54	600 ohm/100MHz
C1301	046-1042-78	0.1uF K B	IC302	-----	TEF7000 (Tuner) (thermal pad) (402590-051)	L223	010-3104-54	600 ohm/100MHz
C1302	043-0603-90	16V 10uF	IC303	051-3741-90	NJM4184U2-15A (TE2)	L312	010-3100-68	3.3uH J
C1312	043-0603-90	16V 10uF	IC601	-----	BD00D0AWHFP-TR (Voltage regulator) (Thermal pad) (370990-051)	L314	010-3062-54	290nH
C1314	043-0603-90	16V 10uF				L316	010-3062-54	290nH
C1315	168-3322-55	3300pF K				L318	010-3062-56	0.5uH
C1319	046-1042-78	0.1uF K B				L319	010-3062-53	0.215uH
C1324	043-6401-90	16V 10uF				L320	010-3406-53	1.8uH J
C1325	042-1762-90	35V 4.7uF M				L322	010-3104-54	600 ohm/100MHz
C1326	043-5600-90	0.10uF				L323	010-3104-54	600 ohm/100MHz
C1327	042-4433-00	25V 3300uF				L324	010-2290-52	330uH
C1328	168-1832-55	0.018uF K				L325	010-2290-52	330uH
C1329	168-1832-55	0.018uF K				L601	010-3104-50	30 ohm/100MHz
C1330	168-1832-55	0.018uF K				L603	010-3104-50	30 ohm/100MHz
C1331	168-1832-55	0.018uF K				L701	010-3104-54	600 ohm/100MHz
C1332	168-1832-55	0.018uF K				L702	010-3104-54	600 ohm/100MHz
C1333	168-1832-55	0.018uF K				L703	010-3104-54	600 ohm/100MHz
C1334	168-1832-55	0.018uF K				L801	BAZ0431	10uH
C1335	168-1832-55	0.018uF K				L901	010-3538-52	3.9uH
C1336	046-2222-58	2200pF K B						
C1360	168-3342-58	0.33uF K						
C1371	046-1042-78	0.1uF K B						
C1375	168-1032-55	0.01uF K						
C1421	165-3363-25	10V 33uF						
C1422	165-3363-25	10V 33uF						
C1423	165-3363-25	10V 33uF						
C1424	165-3363-25	10V 33uF						
C1425	165-3363-25	10V 33uF						
C1426	165-3363-25	10V 33uF						
C1427	165-3363-25	10V 33uF						
C1428	165-3363-25	10V 33uF						

REF No.	PART No.	DESCRIPTION	REF No.	PART No.	DESCRIPTION	REF No.	PART No.	DESCRIPTION
L903	010-3538-51	3.3uH	R136	033-4701-15	1/16W 47 ohm J	R243	032-0150-52	1/16W 20k ohm F
L904	010-3104-50	30 ohm/100MHz	R138	033-0000-05	1/16W 0 ohm	R244	032-0150-53	1/16W 33k ohm F
L905	010-3127-91	220 ohm/100MHz	R139	033-4721-15	1/16W 4.7k ohm J	R245	032-0150-53	1/16W 33k ohm F
L1102	BEZ0161	DLW31SN601SQ2	R140	033-4721-15	1/16W 4.7k ohm J	R246	032-0150-53	1/16W 33k ohm F
L1301	010-8063-00	DN-CL2541	R141	033-4721-15	1/16W 4.7k ohm J	R247	033-1011-15	1/16W 100 ohm J
NF101	060-3124-90	NFM18PS105R0J3 1 uF	R142	032-0221-76	1/16W 24k ohm F	R248	032-0150-53	1/16W 33k ohm F
NF102	060-3124-90	NFM18PS105R0J3 1 uF	R144	033-3321-15	1/16W 3.3k ohm J	R249	033-4731-15	1/16W 47k ohm J
NF107	060-3124-90	NFM18PS105R0J3 1 uF	R146	033-6811-15	1/16W 680 ohm J	R250	033-1031-15	1/16W 10k ohm J
NF108	060-3124-90	NFM18PS105R0J3 1 uF	R147	032-0150-65	1/16W 5.6k ohm F	R251	033-0000-05	1/16W 0 ohm
P301	092-2210-00	ANTENNA RECEPT	R148	033-0000-05	1/16W 0 ohm	R252	033-0000-05	1/16W 0 ohm
P901	076-0569-02	2P	R149	033-0000-05	1/16W 0 ohm	R253	033-1031-15	1/16W 10k ohm J
P1102	074-4073-00	8P	R150	033-0000-05	1/16W 0 ohm	R254	033-0000-05	1/16W 0 ohm
Q201	125-2046-95	DTC143ZUB	R151	033-0000-05	1/16W 0 ohm	R255	033-0000-05	1/16W 0 ohm
Q202	125-7007-90	Si5441BDC-TI-E3	R152	033-1031-15	1/16W 10k ohm J	R256	033-1011-15	1/16W 100 ohm J
Q203	198-3018-00	2SK3018	R153	033-0000-05	1/16W 0 ohm	R257	033-1011-15	1/16W 100 ohm J
Q204	198-3018-00	2SK3018	R155	033-1031-15	1/16W 10k ohm J	R258	033-0000-05	1/16W 0 ohm
Q306	192-4116-51	2SC4116 G.L	R157	033-4721-15	1/16W 4.7k ohm J	R260	033-1011-15	1/16W 100 ohm J
Q601	125-2046-95	DTC143ZUB	R158	033-4721-15	1/16W 4.7k ohm J	R261	033-1011-15	1/16W 100 ohm J
Q602	125-7011-90	RSR025P03TL	R159	033-4721-15	1/16W 4.7k ohm J	R262	033-1031-15	1/16W 10k ohm J
Q701	125-2046-95	DTC143ZUB	R160	033-4721-15	1/16W 4.7k ohm J	R263	033-1011-15	1/16W 100 ohm J
Q702	125-2046-95	DTC143ZUB	R161	033-4721-15	1/16W 4.7k ohm J	R264	033-2201-15	1/16W 22 ohm J
Q801	192-4116-51	2SC4116 G.L	R162	033-0000-05	1/16W 0 ohm	R266	033-3921-15	1/16W 3.9k ohm J
Q802	125-0035-98	DTA114YUBTL	R163	033-0000-05	1/16W 0 ohm	R269	033-3921-15	1/16W 3.9k ohm J
Q803	125-2046-95	DTC143ZUB	R164	033-1011-15	1/16W 100 ohm J	R272	033-3921-15	1/16W 3.9k ohm J
Q901	125-2046-95	DTC143ZUB	R165	033-1011-15	1/16W 100 ohm J	R273	033-3921-15	1/16W 3.9k ohm J
Q902	125-2046-95	DTC143ZUB	R166	033-1021-15	1/16W 1k ohm J	R274	033-0000-05	1/16W 0 ohm
Q903	125-2046-95	DTC143ZUB	R167	033-0000-05	1/16W 0 ohm	R275	033-0000-05	1/16W 0 ohm
Q904	190-2060-00	2SA2060	R168	033-0000-05	1/16W 0 ohm	R280	033-0000-05	1/16W 0 ohm
Q905	125-8017-90	SP8K4-TB	R169	033-1011-15	1/16W 100 ohm J	R281	033-0000-05	1/16W 0 ohm
Q906	125-8017-90	SP8K4-TB	R170	033-1011-15	1/16W 100 ohm J	R284	033-1031-15	1/16W 10k ohm J
Q909	125-9027-90	UPA1981TE	R171	033-1031-15	1/16W 10k ohm J	R285	033-1031-15	1/16W 10k ohm J
Q1101	125-2046-95	DTC143ZUB	R172	033-1031-15	1/16W 10k ohm J	R286	033-1031-15	1/16W 10k ohm J
Q1102	125-0021-93	DTA144EUA-T106	R181	033-1011-15	1/16W 100 ohm J	R287	033-1031-15	1/16W 10k ohm J
Q1301	125-2046-95	DTC143ZUB	R182	033-1011-15	1/16W 100 ohm J	R289	033-1011-15	1/16W 100 ohm J
Q1302	125-9017-92	UMD3N-TR	R197	033-2211-15	1/16W 220 ohm J	R290	033-1011-15	1/16W 100 ohm J
Q1304	125-9017-92	UMD3N-TR	R198	033-2211-15	1/16W 220 ohm J	R291	033-1011-15	1/16W 100 ohm J
Q1305	198-3018-00	2SK3018	R199	033-2211-15	1/16W 220 ohm J	R294	032-0221-63	1/16W 12k ohm F
Q1306	198-3018-00	2SK3018	R201	033-1811-15	1/16W 180 ohm J	R295	032-0221-63	1/16W 12k ohm F
R101	033-1031-15	1/16W 10k ohm J	R202	033-1811-15	1/16W 180 ohm J	R296	032-0221-61	1/16W 6.8k ohm F
R102	033-1031-15	1/16W 10k ohm J	R203	033-1811-15	1/16W 180 ohm J	R301	033-0000-05	1/16W 0 ohm
R103	033-1031-15	1/16W 10k ohm J	R204	033-1811-15	1/16W 180 ohm J	R305	033-0000-05	1/16W 0 ohm
R104	033-1031-15	1/16W 10k ohm J	R205	032-0221-75	1/16W 47k ohm F	R307	033-0000-05	1/16W 0 ohm
R105	033-1031-15	1/16W 10k ohm J	R206	032-0221-75	1/16W 47k ohm F	R316	033-1811-15	1/16W 180 ohm J
R107	033-1031-15	1/16W 10k ohm J	R209	033-0000-05	1/16W 0 ohm	R317	033-1811-15	1/16W 180 ohm J
R108	033-1031-15	1/16W 10k ohm J	R210	033-0000-05	1/16W 0 ohm	R318	033-3311-15	1/16W 330 ohm J
R109	033-1031-15	1/16W 10k ohm J	R211	032-0221-75	1/16W 47k ohm F	R319	033-3311-15	1/16W 330 ohm J
R110	033-1031-15	1/16W 10k ohm J	R212	032-0221-75	1/16W 47k ohm F	R320	033-1051-15	1/16W 1M ohm J
R111	033-1031-15	1/16W 10k ohm J	R213	032-0150-53	1/16W 33k ohm F	R321	033-1051-15	1/16W 1M ohm J
R112	033-1031-15	1/16W 10k ohm J	R214	032-0150-53	1/16W 33k ohm F	R322	033-4741-15	1/16W 470k ohm J
R113	033-1031-15	1/16W 10k ohm J	R217	033-0000-05	1/16W 0 ohm	R323	033-1201-15	1/16W 12 ohm
R114	033-1031-15	1/16W 10k ohm J	R218	033-0000-05	1/16W 0 ohm	R324	033-4741-15	1/16W 470k ohm J
R115	032-0150-54	1/16W 1k ohm F	R219	033-1031-15	1/16W 10k ohm J	R325	033-1201-15	1/16W 12 ohm
R117	033-1031-15	1/16W 10k ohm J	R220	033-1031-15	1/16W 10k ohm J	R326	033-1051-15	1/16W 1M ohm J
R118	032-0150-59	1/16W 100k ohm F	R221	033-1031-15	1/16W 10k ohm J	R327	033-1051-15	1/16W 1M ohm J
R119	033-1031-15	1/16W 10k ohm J	R222	032-0221-74	1/16W 10k ohm 1%	R328	033-5601-15	1/16W 56 ohm J
R120	033-1031-15	1/16W 10k ohm J	R223	032-0221-74	1/16W 10k ohm 1%	R333	033-2231-15	1/16W 22k ohm J
R121	033-4721-15	1/16W 4.7k ohm J	R225	033-0000-05	1/16W 0 ohm	R334	033-2231-15	1/16W 22k ohm J
R122	033-3301-15	1/16W 33 ohm J	R226	033-0000-05	1/16W 0 ohm	R335	033-3921-15	1/16W 3.9k ohm J
R123	033-3301-15	1/16W 33 ohm J	R227	119-1001-15	1/10W 10 ohm	R336	033-3921-15	1/16W 3.9k ohm J
R124	033-3301-15	1/16W 33 ohm J	R228	033-1031-15	1/16W 10k ohm J	R337	033-0000-05	1/16W 0 ohm
R125	033-3301-15	1/16W 33 ohm J	R229	033-1011-15	1/16W 100 ohm J	R339	033-0000-05	1/16W 0 ohm
R126	033-4721-15	1/16W 4.7k ohm J	R230	033-4731-15	1/16W 47k ohm J	R340	033-0000-05	1/16W 0 ohm
R127	033-4721-15	1/16W 4.7k ohm J	R231	033-1031-15	1/16W 10k ohm J	R343	033-0000-05	1/16W 0 ohm
R128	033-3301-15	1/16W 33 ohm J	R232	033-1031-15	1/16W 10k ohm J	R344	033-0000-05	1/16W 0 ohm
R129	033-3301-15	1/16W 33 ohm J	R233	032-0150-52	1/16W 20k ohm F	R345	033-4721-15	1/16W 4.7k ohm J
R130	033-3301-15	1/16W 33 ohm J	R234	032-0150-52	1/16W 20k ohm F	R346	033-4721-15	1/16W 4.7k ohm J
R131	033-3301-15	1/16W 33 ohm J	R235	032-0150-52	1/16W 20k ohm F	R347	033-0000-05	1/16W 0 ohm
R133	033-1021-15	1/16W 1k ohm J	R236	032-0150-52	1/16W 20k ohm F	R348	033-0000-05	1/16W 0 ohm
R134	033-4721-15	1/16W 4.7k ohm J	R237	033-2201-15	1/16W 22 ohm J	R351	033-0000-05	1/16W 0 ohm
R135	033-3301-15	1/16W 33 ohm J	R238	032-0150-59	1/16W 100k ohm F	R352	033-0000-05	1/16W 0 ohm
			R239	032-0150-59	1/16W 100k ohm F	R353	033-0000-05	1/16W 0 ohm
			R240	032-0150-52	1/16W 20k ohm F	R354	033-0000-05	1/16W 0 ohm
			R241	032-0150-52	1/16W 20k ohm F	R355	033-0000-05	1/16W 0 ohm
			R242	032-0150-52	1/16W 20k ohm F	R356	033-0000-05	1/16W 0 ohm

REF No.	PART No.	DESCRIPTION	REF No.	PART No.	DESCRIPTION	REF No.	PART No.	DESCRIPTION
R357	033-0000-05	1/16W 0 ohm	R829	033-1041-15	1/16W 100k ohm J	R1339	033-1021-15	1/16W 1k ohm J
R358	033-0000-05	1/16W 0 ohm	R830	033-4721-15	1/16W 4.7k ohm J	R1340	033-4731-15	1/16W 47k ohm J
R359	116-2201-15	1/4W 22 ohm	R831	033-1011-15	1/16W 100 ohm J	R1345	033-3321-15	1/16W 3.3k ohm J
R360	116-2201-15	1/4W 22 ohm	R832	033-4721-15	1/16W 4.7k ohm J	R1346	033-1031-15	1/16W 10k ohm J
R361	116-2201-15	1/4W 22 ohm	R833	033-1011-15	1/16W 100 ohm J	R1347	033-1031-15	1/16W 10k ohm J
R362	116-2201-15	1/4W 22 ohm	R834	033-4721-15	1/16W 4.7k ohm J	R1348	033-1031-15	1/16W 10k ohm J
R363	033-4731-15	1/16W 47k ohm J	R835	033-1011-15	1/16W 100 ohm J	R1349	033-1031-15	1/16W 10k ohm J
R364	033-1031-15	1/16W 10k ohm J	R836	033-0000-05	1/16W 0 ohm	R1352	033-1001-15	1/16W 10 ohm J
R365	033-4731-15	1/16W 47k ohm J	R837	033-1011-15	1/16W 100 ohm J	R1353	033-1001-15	1/16W 10 ohm J
R366	033-0000-05	1/16W 0 ohm	R838	033-1011-15	1/16W 100 ohm J	R1355	033-0000-05	1/16W 0 ohm
R367	033-0000-05	1/16W 0 ohm	R839	033-1031-15	1/16W 10k ohm J	R1356	033-1001-15	1/16W 10 ohm J
R370	033-0000-05	1/16W 0 ohm	R902	033-1031-15	1/16W 10k ohm J	R1357	033-1001-15	1/16W 10 ohm J
R371	116-0000-05	1/4W 0 ohm JW	R903	033-1031-15	1/16W 10k ohm J	R1371	033-1021-15	1/16W 1k ohm J
R372	119-1041-15	1/10W 100k ohm	R904	032-0225-66	1/16W 3.6k ohm +/-0.5%	R1373	033-0000-05	1/16W 0 ohm
R601	033-1021-15	1/16W 1k ohm J	R905	032-0225-88	1/16W 1.5k ohm +/-0.5%	R1375	033-0000-05	1/16W 0 ohm
R602	033-0000-05	1/16W 0 ohm	R906	032-0225-87	1/16W 75 ohm +/-0.5%	R1411	033-0000-05	1/16W 0 ohm
R603	119-1831-15	1/10W 18k ohm	R907	032-0225-75	1/16W 1.3k ohm +/-0.5%	R1412	033-0000-05	1/16W 0 ohm
R604	119-1021-15	1/10W 1k ohm	R908	032-0225-86	1/16W 39 ohm +/-0.5%	R1413	033-0000-05	1/16W 0 ohm
R605	032-0221-65	1/16W 68k ohm F	R910	116-1031-15	1/4W 10k ohm	R1414	033-0000-05	1/16W 0 ohm
R606	032-0221-61	1/16W 6.8k ohm F	R912	116-2221-15	1/4W 2.2k ohm	R1501	119-1531-15	1/10W 15k ohm
R607	033-3331-15	1/16W 33k ohm J	R913	032-0224-51	1/2W 0.010 ohm F	R1502	119-1531-15	1/10W 15k ohm
R608	033-3331-15	1/16W 33k ohm J	R914	116-2221-15	1/4W 2.2k ohm	R1503	032-0221-75	1/16W 47k ohm F
R609	033-3331-15	1/16W 33k ohm J	R915	AQZ0402	1/16W 10 ohm 1%	R1504	032-0221-75	1/16W 47k ohm F
R661	033-0000-05	1/16W 0 ohm	R916	AQZ0402	1/16W 10 ohm 1%	R1505	032-0221-75	1/16W 47k ohm F
R662	033-0000-05	1/16W 0 ohm	R917	032-0221-83	1/16W 3.3k ohm F	R1506	032-0221-75	1/16W 47k ohm F
R663	033-0000-05	1/16W 0 ohm	R918	116-0000-05	1/4W 0 ohm JW	R1507	032-0221-75	1/16W 47k ohm F
R701	033-1031-15	1/16W 10k ohm J	R919	032-0221-50	1/16W 43k ohm F	R1508	032-0221-75	1/16W 47k ohm F
R703	033-1031-15	1/16W 10k ohm J	R921	033-0000-05	1/16W 0 ohm	R1509	119-3331-15	1/10W 33k ohm
R704	033-1041-15	1/16W 100k ohm J	R922	116-3011-15	1/4W 300 ohm	R1510	119-3331-15	1/10W 33k ohm
R705	033-4731-15	1/16W 47k ohm J	R923	116-3311-15	1/4W 330 ohm	R1511	119-2221-15	1/10W 2.2k ohm
R708	033-1031-15	1/16W 10k ohm J	R924	033-4791-15	1/16W 4.7 ohm	R1512	119-2221-15	1/10W 2.2k ohm
R709	033-4721-15	1/16W 4.7k ohm J	R925	AQZ0441	1/16W 8.2k ohm +/-1%	R1513	032-0221-75	1/16W 47k ohm F
R710	033-0000-05	1/16W 0 ohm	R926	116-2291-15	1/4W 2.2 ohm	R1514	033-0000-05	1/16W 0 ohm
R711	033-0000-05	1/16W 0 ohm	R927	032-0225-73	1/16W 15k ohm	R1515	033-0000-05	1/16W 0 ohm
R712	033-4741-15	1/16W 470k ohm J	R928	033-4791-15	1/16W 4.7 ohm	R1516	033-0000-05	1/16W 0 ohm
R715	033-1041-15	1/16W 100k ohm J	R929	AQZ0451	1/16W 47k ohm 1%	R1517	033-0000-05	1/16W 0 ohm
R716	033-1041-15	1/16W 100k ohm J	R930	033-0000-05	1/16W 0 ohm	R1518	032-0221-75	1/16W 47k ohm F
R717	033-0000-05	1/16W 0 ohm	R931	AQZ0402	1/16W 10 ohm 1%	R1519	033-4731-15	1/16W 47k ohm J
R720	033-0000-05	1/16W 0 ohm	R932	AQZ0402	1/16W 10 ohm 1%	R1520	033-4731-15	1/16W 47k ohm J
R721	033-0000-05	1/16W 0 ohm	R933	033-1041-15	1/16W 100k ohm J	R1521	033-4731-15	1/16W 47k ohm J
R722	033-0000-05	1/16W 0 ohm	R936	032-0221-73	1/16W 2.2k ohm 1%	R1522	033-4731-15	1/16W 47k ohm J
R723	033-4741-15	1/16W 470k ohm J	R937	032-0224-51	1/2W 0.010 ohm F	R1971	033-1011-15	1/16W 100 ohm J
R725	033-0000-05	1/16W 0 ohm	R938	116-0000-05	1/4W 0 ohm JW	RN101	050-0140-59	1/32W 33 ohm x4J
R726	033-0000-05	1/16W 0 ohm	R940	116-0000-05	1/4W 0 ohm JW	RN102	050-0140-59	1/32W 33 ohm x4J
R728	033-0000-05	1/16W 0 ohm	R941	033-1031-15	1/16W 10k ohm J	RN103	050-0140-59	1/32W 33 ohm x4J
R729	033-0000-05	1/16W 0 ohm	R944	032-0221-86	1/16W 82k ohm F	RN104	050-0140-59	1/32W 33 ohm x4J
R731	119-0000-05	1/10W 0 ohm JW	R946	032-0221-80	1/16W 6.2k ohm F	RN105	050-0140-51	1/32W 22 ohm x4J
R732	119-0000-05	1/10W 0 ohm JW	R947	033-0000-05	1/16W 0 ohm	RN106	050-0140-51	1/32W 22 ohm x4J
R735	119-0000-05	1/10W 0 ohm JW	R949	033-0000-05	1/16W 0 ohm	RN107	050-0140-51	1/32W 22 ohm x4J
R747	033-1031-15	1/16W 10k ohm J	R950	033-1041-15	1/16W 100k ohm J	RN108	050-0140-51	1/32W 22 ohm x4J
R749	033-1031-15	1/16W 10k ohm J	R951	116-0000-05	1/4W 0 ohm JW	RN109	050-0140-57	1/32W 10k ohm x4J
R801	AQZ0457	1/16W 150k ohm 1%	R952	032-0221-56	1/16W 22k ohm F	RN110	050-0140-57	1/32W 10k ohm x4J
R802	033-0000-05	1/16W 0 ohm	R953	033-2221-15	1/16W 2.2k ohm J	RN111	050-0140-57	1/32W 10k ohm x4J
R803	AQZ0461	1/16W 270k ohm 1%	R954	119-1021-15	1/10W 1k ohm	RN112	050-0140-57	1/32W 10k ohm x4J
R804	033-0000-05	1/16W 0 ohm	R955	033-1021-15	1/16W 1k ohm J	RN114	050-0140-59	1/32W 33 ohm x4J
R805	033-4731-15	1/16W 47k ohm J	R956	116-1511-15	1/4W 150 ohm	RN115	050-0140-51	1/32W 22 ohm x4J
R806	033-1031-15	1/16W 10k ohm J	R957	116-1511-15	1/4W 150 ohm	RN116	050-0140-51	1/32W 22 ohm x4J
R807	033-4731-15	1/16W 47k ohm J	R958	032-0221-66	1/16W 270 ohm F	RN117	050-0140-51	1/32W 22 ohm x4J
R808	033-5611-15	1/16W 560 ohm J	R1109	119-5621-15	1/10W 5.6k ohm	RN118	050-0140-51	1/32W 22 ohm x4J
R809	033-1031-15	1/16W 10k ohm J	R1127	033-5611-15	1/16W 560 ohm J	RN123	050-0140-57	1/32W 10k ohm x4J
R810	032-0208-51	1/4W 15k ohm	R1317	116-8211-15	1/4W 820 ohm	RN124	050-0140-59	1/32W 33 ohm x4J
R813	032-0150-59	1/16W 100k ohm F	R1318	116-8211-15	1/4W 820 ohm	RN125	050-0140-59	1/32W 33 ohm x4J
R814	033-0000-05	1/16W 0 ohm	R1319	116-8211-15	1/4W 820 ohm	RN126	050-0140-59	1/32W 33 ohm x4J
R815	AQZ0468	1/16W 1M ohm 1%	R1325	119-2211-15	1/10W 220 ohm	RN127	050-0140-59	1/32W 33 ohm x4J
R816	033-0000-05	1/16W 0 ohm	R1326	033-0000-05	1/16W 0 ohm	RN128	050-0140-59	1/32W 33 ohm x4J
R817	033-4731-15	1/16W 47k ohm J	R1327	119-0000-05	1/10W 0 ohm JW	RN129	050-0140-59	1/32W 33 ohm x4J
R818	033-4731-15	1/16W 47k ohm J	R1330	033-4731-15	1/16W 47k ohm J	RN203	050-0140-52	1/32W 100 ohm x4J
R819	033-1031-15	1/16W 10k ohm J	R1337	033-1011-15	1/16W 100 ohm J	RN209	050-0140-52	1/32W 100 ohm x4J
R821	033-4731-15	1/16W 47k ohm J	R1338	033-1011-15	1/16W 100 ohm J	RN505	050-0140-52	1/32W 100 ohm x4J
R822	033-1011-15	1/16W 100 ohm J				RN601	050-0140-51	1/32W 22 ohm x4J
R823	033-1011-15	1/16W 100 ohm J				RN602	050-0140-51	1/32W 22 ohm x4J
R824	032-0150-54	1/16W 1k ohm F				RN603	050-0140-51	1/32W 22 ohm x4J
R825	032-0150-59	1/16W 100k ohm F				RN604	050-0140-51	1/32W 22 ohm x4J
R827	033-1041-15	1/16W 100k ohm J				RN701	050-0140-52	1/32W 100 ohm x4J

REF No.	PART No.	DESCRIPTION	REF No.	PART No.	DESCRIPTION	REF No.	PART No.	DESCRIPTION
RN801	050-0140-67	1/32W 220 ohm x4J	VR1307	001-9210-50	AVR-M1608C270MTA	VR1513	001-9210-50	AVR-M1608C270MTA
RN802	050-0140-67	1/32W 220 ohm x4J			AD			AD
RN803	050-0140-62	1/32W 22k ohm X4 J	VR1308	001-9210-50	AVR-M1608C270MTA	VR1514	001-9210-50	AVR-M1608C270MTA
RN804	050-0140-52	1/32W 100 ohm x4J			AD			AD
RN805	050-0140-52	1/32W 100 ohm x4J	VR1309	001-9210-50	AVR-M1608C270MTA	VR1515	001-9210-50	AVR-M1608C270MTA
RN806	050-0140-52	1/32W 100 ohm x4J			AD			AD
T301	010-4100-50	0.215uH	VR1311	001-9210-50	AVR-M1608C270MTA	VR1518	001-9210-50	AVR-M1608C270MTA
T302	010-4100-50	0.215uH			AD			AD
TH101	002-0315-00	TN10-3U153JT	VR1504	001-9210-50	AVR-M1608C270MTA	X101	061-3575-80	22.5792MHz
VR801	001-9210-50	AVR-M1608C270MTA			AD	X102	061-3580-90	12MHz
		AD	VR1506	001-9210-50	AVR-M1608C270MTA	X103	061-3593-80	NX3225GA 48MHz
VR1101	AQZ0761	EZJZ0V800AA			AD	X201	061-3589-90	41.6MHz
VR1102	AQZ0761	EZJZ0V800AA	VR1507	001-9210-50	AVR-M1608C270MTA	X801	060-1542-90	16MHz
VR1103	AQZ0761	EZJZ0V800AA			AD	ZD301	060-8107-50	SURGE PROTECTO
VR1302	001-9210-50	AVR-M1608C270MTA	VR1508	001-9210-50	AVR-M1608C270MTA			R
		AD			AD	ZD302	060-8107-50	SURGE PROTECTO
VR1303	001-9210-50	AVR-M1608C270MTA	VR1509	001-9210-50	AVR-M1608C270MTA			R
		AD			AD	ZD801	001-4301-48	HZU 9.1B3
VR1304	001-9210-50	AVR-M1608C270MTA	VR1510	001-9210-50	AVR-M1608C270MTA	ZD802	001-4313-58	HZU6C1L
		AD			AD	ZD810	001-4301-48	HZU 9.1B3
VR1305	001-9210-50	AVR-M1608C270MTA	VR1511	001-9210-50	AVR-M1608C270MTA	ZD1302	001-4912-90	SM5S22A-HE3/2D
		AD			AD	ZD1371	001-4305-19	UDZSTE-17 5.1B
VR1306	001-9210-50	AVR-M1608C270MTA	VR1512	001-9210-50	AVR-M1608C270MTA	PWB	039-4059-00	PWB(WITHOUT
		AD			AD			COMPONENTS)

XM PWB(B2) section

REF No.	PART No.	DESCRIPTION	REF No.	PART No.	DESCRIPTION	REF No.	PART No.	DESCRIPTION
C002	046-1022-58	50V 1000pF	C019	045-1801-50	18pFJ CH	R022	032-0162-50	1/10W 0.51 ohm
C003	046-1022-58	50V 1000pF	D001	001-2403-90	M1F60	R043	033-3311-15	1/16W 330 ohm J
C004	046-1022-58	50V 1000pF	FE001	941-0253-51	TUNER PACK	R046	033-1021-15	1/16W 1k ohm J
C006	043-5703-90	50V 0.001uF	IC001	051-3374-90	NJM2386ADL3-05-TE	R048	033-1021-15	1/16W 1k ohm J
C007	043-7701-90	2.2uF			1	R051	033-1021-15	1/16W 1k ohm J
C008	042-4025-90	16V 47uF	L002	010-3104-53	220 ohm/100MHz	R054	033-1021-15	1/16W 1k ohm J
C009	042-1753-90	16V 100uF M	L003	010-3104-53	220 ohm/100MHz	R057	033-0000-05	1/16W 0 ohm
C010	046-1042-78	0.1uF K B	L004	010-3104-53	220 ohm/100MHz	R058	033-3301-15	1/16W 33 ohm J
C011	046-1042-78	0.1uF K B	NF005	060-3115-51	CKD310JB1C224ST	R059	033-3301-15	1/16W 33 ohm J
C012	046-1022-58	50V 1000pF	P001	076-3062-50	50P	R060	033-1011-15	1/16W 100 ohm J
C013	046-1022-58	50V 1000pF	R008	117-0000-05	1/8W 0 ohm JW	R62	033-0000-05	1/16W 0 ohm
C017	045-1011-50	100pFJ CH	R009	117-0000-05	1/8W 0 ohm JW	PWB	039-3956-00	PWB(WITHOUT
C018	045-1801-50	18pFJ CH	R010	033-0000-05	1/16W 0 ohm			COMPONENTS)

IF PWB(B3) section

REF No.	PART No.	DESCRIPTION	REF No.	PART No.	DESCRIPTION	REF No.	PART No.	DESCRIPTION
C2301	165-1073-35	16V 100uF	C2333	043-6401-90	16V 10uF	C2440	045-1511-50	150pFJ CH
C2302	046-1042-78	0.1uF K B	C2352	043-7400-90	16V 22uF	C2443	046-1042-78	0.1uF K B
C2303	043-6401-90	16V 10uF	C2353	043-7400-90	16V 22uF	C2444	046-1042-78	0.1uF K B
C2304	046-1042-78	0.1uF K B	C2401	046-1022-58	50V 1000pF	C2446	043-6400-90	16V 4.7uF K
C2305	046-1022-58	50V 1000pF	C2402	046-1022-58	50V 1000pF	C2447	043-6400-90	16V 4.7uF K
C2306	046-1042-78	0.1uF K B	C2403	046-1022-58	50V 1000pF	C2448	043-6400-90	16V 4.7uF K
C2307	045-1011-50	100pFJ CH	C2404	046-1022-58	50V 1000pF	C2449	043-6400-90	16V 4.7uF K
C2308	046-1042-78	0.1uF K B	C2407	046-1022-58	50V 1000pF	C2450	045-3311-50	330pFJ CH
C2309	045-1011-50	100pFJ CH	C2408	046-1022-58	50V 1000pF	C2451	045-3311-50	330pFJ CH
C2310	043-7503-90	4.7uF	C2409	046-1022-58	50V 1000pF	C2452	045-3311-50	330pFJ CH
C2311	043-5600-90	0.10uF	C2410	046-1022-58	50V 1000pF	C2453	045-3311-50	330pFJ CH
C2312	043-6401-90	16V 10uF	C2413	043-7400-90	16V 22uF	C2454	043-6400-90	16V 4.7uF K
C2313	046-1042-78	0.1uF K B	C2414	043-7400-90	16V 22uF	C2455	043-6400-90	16V 4.7uF K
C2314	043-0547-50	16V 3.3uF	C2415	043-7400-90	16V 22uF	C2456	043-6400-90	16V 4.7uF K
C2315	046-1042-78	0.1uF K B	C2416	043-7400-90	16V 22uF	C2457	043-6400-90	16V 4.7uF K
C2316	046-1042-78	0.1uF K B	C2417	043-7400-90	16V 22uF	C2458	045-2201-50	22pFJ CH
C2317	046-1042-78	0.1uF K B	C2418	043-7400-90	16V 22uF	C2459	045-2201-50	22pFJ CH
C2318	043-6401-90	16V 10uF	C2419	043-7400-90	16V 22uF	C2460	045-2201-50	22pFJ CH
C2319	045-1011-50	100pFJ CH	C2420	043-7400-90	16V 22uF	C2461	045-2201-50	22pFJ CH
C2321	165-1073-35	16V 100uF	C2425	046-1522-58	1500pF K B	C2462	045-2201-50	22pFJ CH
C2323	043-6401-90	16V 10uF	C2426	046-1522-58	1500pF K B	C2463	045-2201-50	22pFJ CH
C2324	046-1042-78	0.1uF K B	C2427	046-1522-58	1500pF K B	C2464	045-2201-50	22pFJ CH
C2325	046-1022-58	50V 1000pF	C2428	046-1522-58	1500pF K B	C2465	045-2201-50	22pFJ CH
C2326	046-1042-78	0.1uF K B	C2431	045-1511-50	150pFJ CH	C2466	046-1042-78	0.1uF K B
C2327	045-1011-50	100pFJ CH	C2432	045-1511-50	150pFJ CH	C2467	046-1042-78	0.1uF K B
C2328	046-1042-78	0.1uF K B	C2433	045-1511-50	150pFJ CH	C3101	045-1011-50	100pFJ CH
C2329	045-1011-50	100pFJ CH	C2434	045-1511-50	150pFJ CH	C3103	042-0643-52	6.3V 1000uF
C2330	043-6401-90	16V 10uF	C2437	045-1511-50	150pFJ CH	C3105	046-4722-58	4700pF K B
C2331	043-0547-50	16V 3.3uF	C2438	045-1511-50	150pFJ CH	C3106	046-1042-78	0.1uF K B
C2332	046-1042-78	0.1uF K B	C2439	045-1511-50	150pFJ CH	C3108	043-6200-90	6.3V 10uF

REF No.	PART No.	DESCRIPTION	REF No.	PART No.	DESCRIPTION	REF No.	PART No.	DESCRIPTION
C3110	046-1042-78	0.1uF K B	R2316	AQZ0425	1/16W 560 ohm 1%	R2448	032-0221-53	1/16W 18k ohm F
C3111	046-1042-78	0.1uF K B	R2317	AQZ0425	1/16W 560 ohm 1%	R2449	032-0221-56	1/16W 22k ohm F
C3115	046-1042-78	0.1uF K B	R2318	AQZ0425	1/16W 560 ohm 1%	R2450	032-0150-51	1/16W 15k ohm F
C3144	046-1042-78	0.1uF K B	R2319	033-0000-05	1/16W 0 ohm	R2451	032-0150-51	1/16W 15k ohm F
C3151	045-1011-50	100pFJ CH	R2320	033-0000-05	1/16W 0 ohm	R2452	032-0221-56	1/16W 22k ohm F
C3156	046-1042-78	0.1uF K B	R2321	033-0000-05	1/16W 0 ohm	R2453	032-0221-53	1/16W 18k ohm F
CN3202	EAZ0928	40P	R2322	033-0000-05	1/16W 0 ohm	R2454	119-3301-15	1/10W 33 ohm
IC2301	051-6742-90	CS4350-DZZR	R2326	033-8221-15	1/16W 8.2k ohm J	R2455	119-3301-15	1/10W 33 ohm
IC2302	051-3020-90	NJM4565V	R2327	033-8221-15	1/16W 8.2k ohm J	R2456	032-0221-53	1/16W 18k ohm F
IC2303	051-7517-08	SN74LVC00APWR	R2328	033-8221-15	1/16W 8.2k ohm J	R2457	032-0221-56	1/16W 22k ohm F
IC2304	051-6742-90	CS4350-DZZR	R2329	033-8221-15	1/16W 8.2k ohm J	R2458	032-0150-51	1/16W 15k ohm F
IC2305	051-7517-08	SN74LVC00APWR	R2333	033-1031-15	1/16W 10k ohm J	R2459	032-0221-75	1/16W 47k ohm F
IC2401	051-3034-90	NJM4558V	R2334	033-1031-15	1/16W 10k ohm J	R2460	032-0221-75	1/16W 47k ohm F
IC2402	051-3034-90	NJM4558V	R2335	033-1031-15	1/16W 10k ohm J	R2461	032-0221-75	1/16W 47k ohm F
IC2404	051-3019-90	NJM2060V	R2336	033-1031-15	1/16W 10k ohm J	R2462	032-0221-75	1/16W 47k ohm F
IC2405	051-3019-90	NJM2060V	R2342	033-1041-15	1/16W 100k ohm J	R2463	032-0150-56	1/16W 27k ohm F
IC3101	051-5357-90	BH76330FVM-TR	R2343	033-1041-15	1/16W 100k ohm J	R2464	032-0150-56	1/16W 27k ohm F
IC3103	051-6647-70	TJA1051T/3,118	R2348	033-1041-15	1/16W 100k ohm J	R2465	032-0150-56	1/16W 27k ohm F
J2501	074-3063-50	50P	R2349	033-1041-15	1/16W 100k ohm J	R2466	032-0150-56	1/16W 27k ohm F
L2301	010-3104-54	600 ohm/100MHz	R2401	032-0221-83	1/16W 3.3k ohm F	R2467	032-0221-56	1/16W 22k ohm F
L2302	010-3104-54	600 ohm/100MHz	R2402	032-0221-83	1/16W 3.3k ohm F	R2468	119-3301-15	1/10W 33 ohm
L2303	010-3104-54	600 ohm/100MHz	R2403	032-0221-83	1/16W 3.3k ohm F	R2469	119-3301-15	1/10W 33 ohm
L2304	010-3104-54	600 ohm/100MHz	R2404	032-0221-83	1/16W 3.3k ohm F	R2470	032-0221-56	1/16W 22k ohm F
L2305	010-3104-54	600 ohm/100MHz	R2405	032-0221-83	1/16W 3.3k ohm F	R2471	032-0221-56	1/16W 22k ohm F
L2306	010-3104-54	600 ohm/100MHz	R2406	032-0221-83	1/16W 3.3k ohm F	R2472	119-3301-15	1/10W 33 ohm
L2307	010-3104-54	600 ohm/100MHz	R2407	032-0221-83	1/16W 3.3k ohm F	R2473	119-3301-15	1/10W 33 ohm
L3101	010-3417-90	10uH	R2408	032-0221-83	1/16W 3.3k ohm F	R2474	032-0221-56	1/16W 22k ohm F
NF3101	010-3609-90	DLW43SH510XK2L	R2413	032-0221-74	1/16W 10k ohm 1%	R2511	033-1011-15	1/16W 100 ohm J
P2501	076-3062-50	50P	R2414	032-0221-74	1/16W 10k ohm 1%	R3101	032-0140-12	1/10W 75 ohm F
P2502	076-3062-00	100P	R2415	032-0221-74	1/16W 10k ohm 1%	R3103	033-4731-15	1/16W 47k ohm J
P3602	076-3062-50	50P	R2416	032-0221-74	1/16W 10k ohm 1%	R3105	032-0210-35	1/10W 120 ohm F
Q2301	125-2046-95	DTC143ZUB	R2419	AQZ0422	1/16W 330 ohm 1%	R3106	032-0210-35	1/10W 120 ohm F
Q2302	125-2046-95	DTC143ZUB	R2420	AQZ0422	1/16W 330 ohm 1%	R3107	032-0210-35	1/10W 120 ohm F
Q2303	125-0006-90	UNR2110	R2421	AQZ0422	1/16W 330 ohm 1%	R3108	032-0210-35	1/10W 120 ohm F
Q2304	125-0006-90	UNR2110	R2422	AQZ0422	1/16W 330 ohm 1%	R3111	033-0000-05	1/16W 0 ohm
Q2305	125-0006-90	UNR2110	R2423	AQZ0422	1/16W 330 ohm 1%	R3112	032-0150-50	1/16W 10k ohm F
Q2306	125-0006-90	UNR2110	R2424	AQZ0422	1/16W 330 ohm 1%	R3144	032-0140-12	1/10W 75 ohm F
Q2309	125-4030-90	IMX9	R2425	AQZ0422	1/16W 330 ohm 1%	RN2301	050-0140-52	1/32W 100 ohm x4J
Q2310	125-4030-90	IMX9	R2426	AQZ0422	1/16W 330 ohm 1%	RN2302	050-0140-52	1/32W 100 ohm x4J
R2301	033-4731-15	1/16W 47k ohm J	R2431	032-0221-74	1/16W 10k ohm 1%	RN2501	050-0140-52	1/32W 100 ohm x4J
R2302	032-0221-55	1/16W 1.5k ohm F	R2432	032-0221-74	1/16W 10k ohm 1%	RN3101	050-0140-52	1/32W 100 ohm x4J
R2303	AQZ0425	1/16W 560 ohm 1%	R2433	032-0221-74	1/16W 10k ohm 1%	RN3102	050-0140-57	1/32W 10k ohm x4J
R2304	AQZ0425	1/16W 560 ohm 1%	R2434	032-0221-74	1/16W 10k ohm 1%	VR3101	001-9210-50	AVR-M1608C270MTA AD
R2305	032-0221-51	1/16W 4.7k ohm F	R2437	032-0221-83	1/16W 3.3k ohm F	VR3107	001-9210-50	AVR-M1608C270MTA AD
R2306	AQZ0425	1/16W 560 ohm 1%	R2438	032-0221-83	1/16W 3.3k ohm F	ZD2301	001-4313-55	HZU7C3L
R2307	AQZ0425	1/16W 560 ohm 1%	R2439	032-0221-83	1/16W 3.3k ohm F	ZD2302	001-4313-56	HZU7A1L
R2308	033-4721-15	1/16W 4.7k ohm J	R2440	032-0221-83	1/16W 3.3k ohm F	PWB	039-3999-00	PWB(WITHOUT COMPONENTS)
R2309	032-0221-63	1/16W 12k ohm F	R2443	032-0150-51	1/16W 15k ohm F			
R2310	032-0221-65	1/16W 68k ohm F	R2444	032-0221-56	1/16W 22k ohm F			
R2311	033-4721-15	1/16W 4.7k ohm J	R2445	032-0221-53	1/16W 18k ohm F			
R2314	033-4731-15	1/16W 47k ohm J	R2446	119-3301-15	1/10W 33 ohm			
R2315	AQZ0425	1/16W 560 ohm 1%	R2447	119-3301-15	1/10W 33 ohm			

EXPLODED VIEW / PARTS LIST

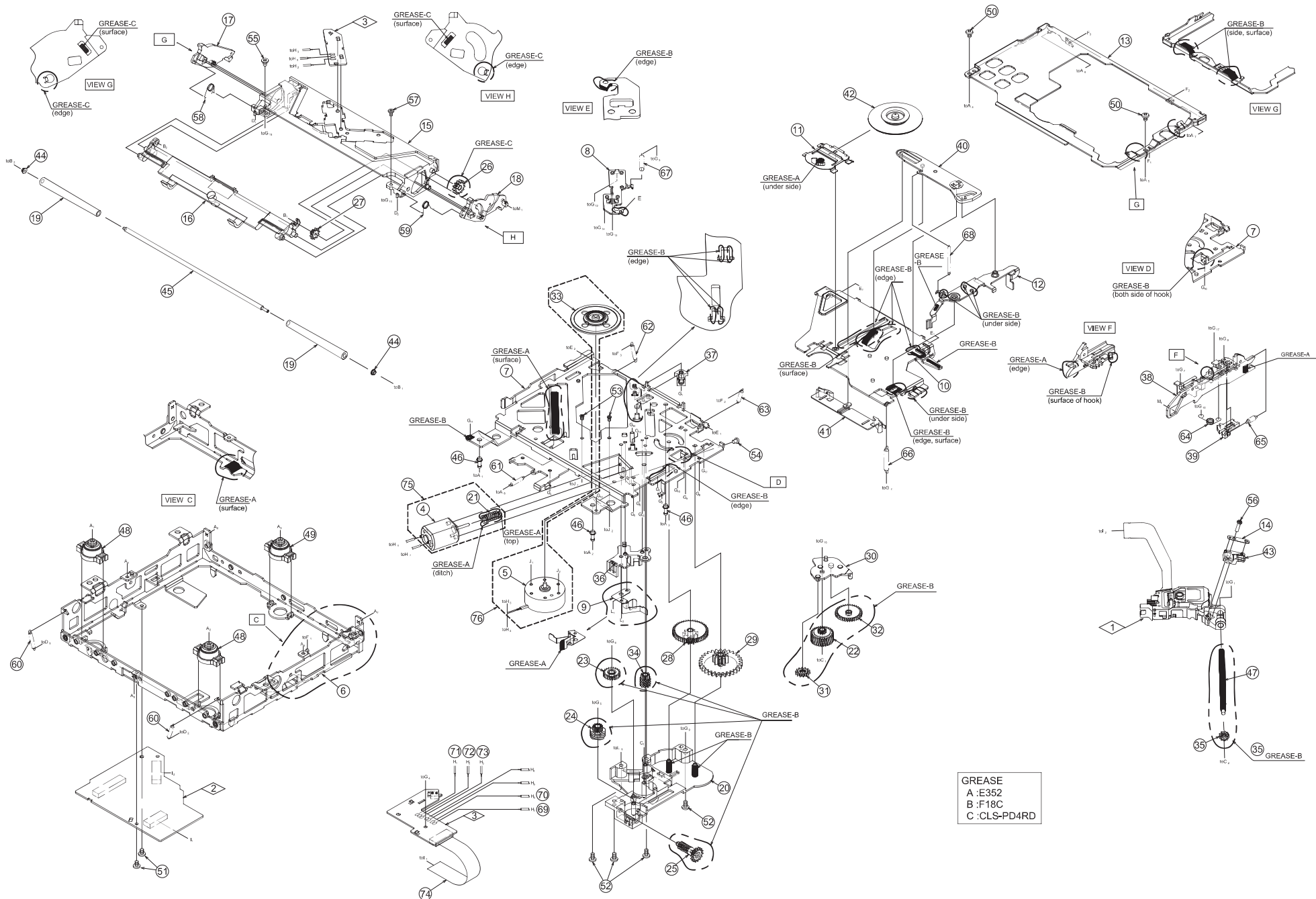

NO.	PART NO.	DESCRIPTION	QTY	NO.	PART NO.	DESCRIPTION	QTY
1	969-0080-30	PICKUP-ASSY	1	38	621-1878-20	SHIFT LEVER	1
2	-----	MAIN-PWB-ASSY	1	39	621-1869-21	RACK	1
3	-----	SENSOR-PWB-ASSY	1	40	621-1870-21	STOPPER LINK	1
4	-----	DC-MOTOR(PWR)(154000-020)	1	41	621-1871-22	DISC STOPPER	1
5	-----	DC-MOTOR(SP)(154100-020)	1	42	621-1872-21	CLAMPER RING	1
6	620-1942-20	LOWER CHASSIS(929521080)	1	43	621-1873-21	LS-RACK	1
	620-1942-21	LOWER CHASSIS(929521081)	1	44	621-1726-21	ROLLER SLEEVE	2
7	-----	DRIVE PLATE(191120-620)(929521080)	1	45	622-1885-20	ROLLER SHAFT	1
	-----	DRIVE PLATE(191121-620)(929521081)	1	46	-----	DAMPER PIN(188620-622)	3
8	620-1912-21	ID-LOCK PLATE	1	47	624-3062-20	LEAD SCREW	1
9	620-1913-20	SPRING PLATE	1	48	629-0138-21	DAMPER F	2
10	620-1914-21	CLAMPER ARM	1	49	629-0139-21	DAMPER R	1
11	620-1915-22	CLAMPER PLATE	1	50	714-2003-8B	MACHIN SCREW	2
12	620-1916-22	SENSOR ARM	1	51	716-3718-00	SCREW	2
13	620-1928-20	UPPER CHASSIS	1	52	716-3719-00	SPECIAL SCREW	4
14	620-1918-21	LS-RACK PLATE	1	53	716-3720-00	SPECIAL SCREW	2
15	621-1877-20	UPPER GUIDE	1	54	716-3721-00	SPECIAL SCREW	1
16	621-1846-22	ROLLER GUIDE	1	55	716-3722-00	SPECIAL SCREW	1
17	621-1847-20	LOCK ARM L	1	56	716-3723-02	SPECIAL-SCREW	1
18	621-1848-22	LOCK ARM R	1	57	716-3724-00	SPECIAL SCREW	1
19	621-1849-20	LOADING ROLLER	2	58	750-7924-22	ROLLER SPRING L	1
20	621-1850-22	GEAR BOX	1	59	750-7925-21	ROLLER SPRING R	1
21	-----	MOTOR GEAR(185121-621)	1	60	750-7926-20	DR-SPRING F	2
22	621-1852-20	SECOND GEAR	1	61	750-7927-20	DR-SPRING C	1
23	621-1853-20	ROLLER GEAR A	1	62	750-7928-20	DR-SPRING RA	1
24	621-1888-20	ROLLER GEAR B	1	63	750-7929-20	DR-SPRING RB	1
25	621-1855-20	ROLLER GEAR C	1	64	750-7930-20	SHIFT SPRING	1
26	621-1856-20	ROLLER GEAR D	1	65	750-7931-20	RACK SPRING	1
27	621-1857-21	ROLLER GEAR E	1	66	750-7932-20	CLAMPER SPRING	1
28	621-1858-20	POWER GEAR A	1	67	750-7933-20	ID-LOCK SPRING	1
29	621-1859-20	POWER GEAR B	1	68	750-7934-20	SENSOR SPRING	1
30	621-1860-21	IDLE CASE	1	69	803-4906-60	VINYL-COAT-WIRE	1
31	621-1861-20	IDLE GEAR A	1	70	816-2590-00	SPECIAL LEAD(GRN)	1
32	621-1862-20	IDLE GEAR B	1	71	816-2591-00	SPECIAL LEAD(YEL)	1
33	-----	TURN TABLE(186320-621)	1	72	816-2592-00	SPECIAL LEAD(PUR)	1
34	621-1864-20	THREAD GEAR A	1	73	816-2593-00	SPECIAL LEAD(BLU)	1
35	621-1865-20	THREAD GEAR B	1	74	816-4070-50	FLAT WIRE	1
36	621-1866-20	LS-HOLDER A	1	75	HBS-668-100	POWER-MOTOR-ASSY	1
37	621-1867-20	LS-HOLDER B	1	76	HBS-669-100	SPINDLE-MOTOR-ASSY	1

ELECTRICAL PARTS LIST

SENSOR PWB(B1) section

REF No.	PART No.	DESCRIPTION	REF No.	PART No.	DESCRIPTION	REF No.	PART No.	DESCRIPTION
D1	001-7138-91	SML-S13RT T86	Q1	060-4025-90	SML-H10TBT86	PWB	039-3732-20	PWB(WITHOUT COMPONENTS)
D2	001-7138-91	SML-S13RT T86	Q2	060-4025-90	SML-H10TBT86			
J1	074-2504-10	OUTLET SOCKET	S2	013-7414-50	SPVG220100			

MAIN PWB(B2) section

REF No.	PART No.	DESCRIPTION	REF No.	PART No.	DESCRIPTION	REF No.	PART No.	DESCRIPTION
C3	166-1011-50	100pF CH	C38	046-1042-78	0.1uF K B	R8	033-1541-15	1/16W 150k ohm J
C4	168-1042-78	16V 0.1uF K	C39	045-1201-50	12pFJ CH	R9	033-1031-15	1/16W 10k ohm J
C5	165-1073-35	16V 100uF	C40	046-1042-78	0.1uF K B	R10	116-1001-15	1/4W 10 ohm
C6	168-1052-78	16V 1uF K	C41	046-2222-58	2200pF K B	R11	033-1031-15	1/16W 10k ohm J
C7	165-1073-15	6.3V 100uF	C42	046-1532-78	0.015uF K B	R17	119-0000-05	1/10W 0 ohm JW
C8	046-4732-78	0.047uF K B	C43	045-4701-50	47pF CH	R18	033-2211-15	1/16W 220 ohm J
C9	168-1052-78	16V 1uF K	C44	046-1042-78	0.1uF K B	R19	119-0000-05	1/10W 0 ohm JW
C10	046-4732-78	0.047uF K B	C45	046-1042-78	0.1uF K B	R24	033-6821-15	1/16W 6.8k ohm J
C12	046-4712-58	470pF K B	C46	045-6097-50	6 +/-0.5pF CH	R27	033-1051-15	1/16W 1M ohm J
C14	046-4712-58	470pF K B	C47	046-1042-78	0.1uF K B	R28	033-2221-15	1/16W 2.2k ohm J
C15	168-1052-78	16V 1uF K	C48	168-1052-78	16V 1uF K	R29	033-2211-15	1/16W 220 ohm J
C16	046-1042-78	0.1uF K B	D1	001-0367-91	1SS226	R30	033-4731-15	1/16W 47k ohm J
C17	046-1042-78	0.1uF K B	IC1	051-6101-80	BD8229EFV-E2	R31	033-1011-15	1/16W 100 ohm J
C22	168-5622-55	5600pF K	IC2	051-6756-50	TC94B16FG	R32	033-2231-15	1/16W 22k ohm J
C23	046-1042-78	0.1uF K B	J1	074-2504-10	OUTLET SOCKET	R33	033-3341-15	1/16W 330k ohm J
C24	168-1062-98	10uF K	J2	074-2215-65	15P	R49	033-2211-15	1/16W 220 ohm J
C25	046-1042-78	0.1uF K B	J3	074-2505-30	30P	R50	033-2211-15	1/16W 220 ohm J
C26	046-1042-78	0.1uF K B	L1	010-3105-69	80 ohm/100MHz	R51	033-2211-15	1/16W 220 ohm J
C27	046-1042-78	0.1uF K B	NF1	010-3304-90	1k ohm/100MHz x4	RN1	050-0140-63	1/32W 47k ohm x4J
C29	046-4732-78	0.047uF K B	Q1	190-1365-50	2SA1365 AF,AG	RN2	050-0140-67	1/32W 220 ohm x4J
C31	045-1501-50	15pFJ CH	R1	117-1821-15	1/8W 1.8k ohm	RN3	050-0140-67	1/32W 220 ohm x4J
C32	168-1052-78	16V 1uF K	R2	033-4721-15	1/16W 4.7k ohm J	X1	061-3586-90	DSX321G(F) 16.920MHz
C33	046-1042-78	0.1uF K B	R3	033-4721-15	1/16W 4.7k ohm J	PWB	039-3865-22	PWB(WITHOUT COMPONENTS)
C34	046-4722-58	4700pF K B	R4	033-4721-15	1/16W 4.7k ohm J			
C35	046-1042-78	0.1uF K B	R5	033-1831-15	1/16W 18k ohm J			
C36	168-1052-78	16V 1uF K	R6	033-3331-15	1/16W 33k ohm J			
C37	046-1032-78	0.01uF K B	R7	033-2731-15	1/16W 27k ohm J			