







Assembly parts list

Quotation of assembly parts for CX505							
NO.	Clarion Model	Part NO #	Qty	MOQ	Description	Lead time (day)	Assembly parts Picture
1	9482CMB4255NA194A	843CMB4255NAMB003	1	30	CMB4255NA MB MI	TBC	
2	9482CMB4253NA194A	843CMB4253NASB002	1	30	CMB4253NA SB MI	TBC	
3	9482CMB4253NA194A	143830001236	1	30	WIRE,CON,16P,L130, CMB1511,PWR	TBC	
4	9482CMB4253NA194A	843CMB4255NAKB003	1	30	CMB4255NA KB MI	TBC	
5	9482CMB4253NA194A	121270001362000	1	30	TRIM PLATE	TBC	
6	9482CMB4253NA194A	141000001722	1	30	BOT COVER	TBC	
7	9482CMB4253NA194A	141000011494	1	30	TOP COVER	TBC	
8	9482CMB4253NA194A	843CMB1535RMT002	1	30	REMOTE CONTROL	TBC	

EXPLODED VIEW / PARTS LIST

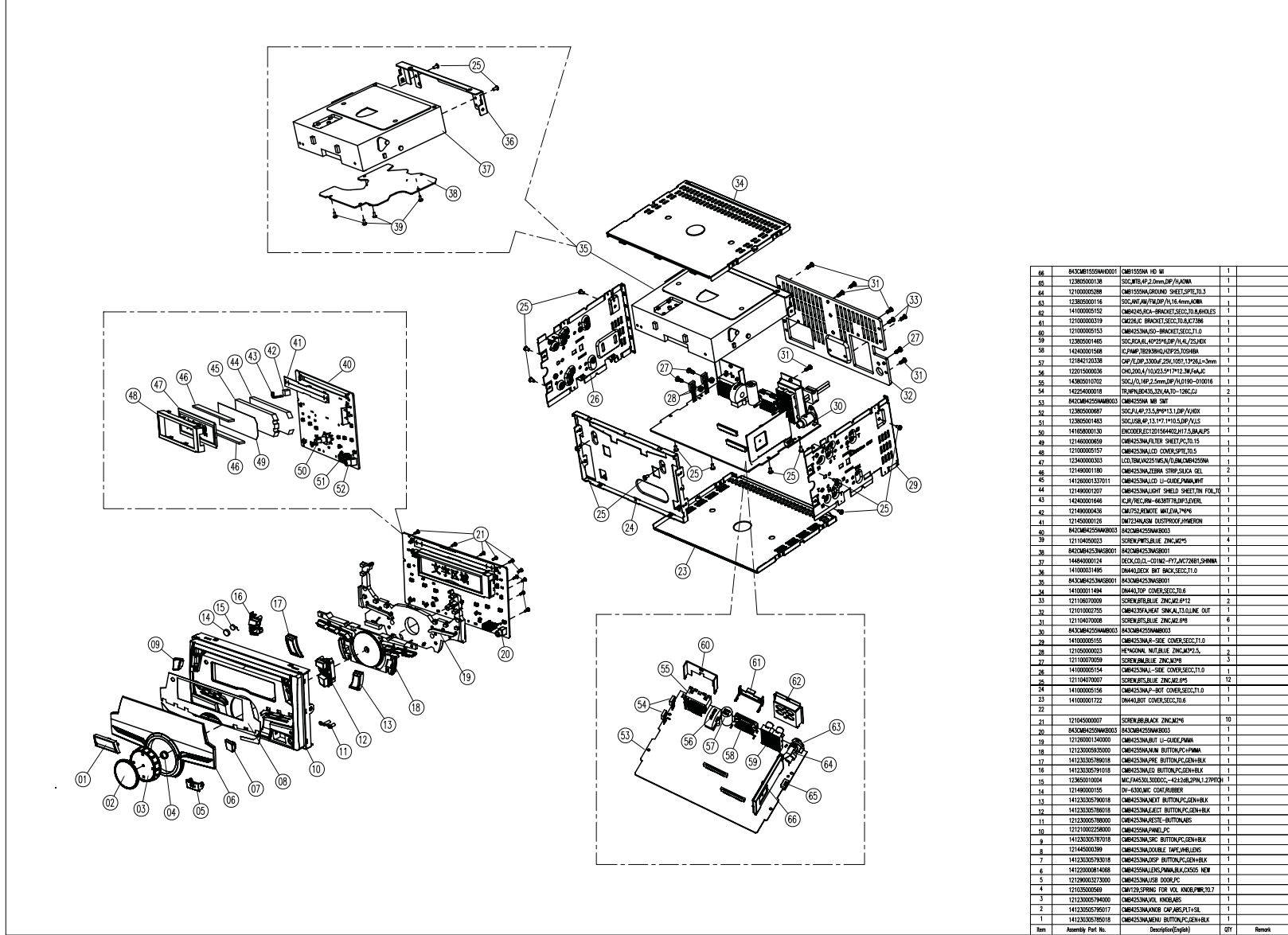

Item	Assembly Part No.	Description(English)	QTY	Remark
86	8430M1555M40001	CM1555M HD MI	1	
85	12385000138	SOC_PFB,AP,2.0mm,LP,PA0MM	1	
84	12100002289	CM1555M,DRK,NO SHEET,SPT,TL0	1	
83	12385000116	SOC_PFB,AV,FW,DP,PA,16.4mm,AWMA	1	
82	14100005152	CM1424,PCA-BRACKET,SEC,TO,RA,HOLES	1	
81	12100000319	CM2024,C BRACKET,SEC,TO,RA,CT798	1	
80	12100005153	CM1424,SN,DR-BRACKET,SEC,TL,0	1	
79	12385000146	SOC_PFB,AL,AP,SW,LP,PA,AL,25,HEX	1	
58	14240001568	IC,PAMP,2828,38,3,4,DP,25,TO,8BA	1	
57	12184212038	CAP,LEP,3300UF,25V,1051,13,92xL=3mm	1	
56	122015000036	CH,LS,0A,PA,1,0,0,23,0,11,12,30,AW,JC	1	
55	14280010702	SOC_PFB,LP,2.5mm,DP,PA,DP-019016	1	
54	14225400018	TR,PN,UK,45,3,2V,AL,10-T2C,CI	2	
53	8430M4255M40003	CM4255M SB MIT	1	
52	12385000067	SOC_PFB,21.5,5,5,1,1,1,LP,PA,DRX	1	
51	12385001483	SOC_PFB,AP,1.3,1,1,1,1,1,5,0,DP,PA,LS	1	
50	14105800110	SC,CO,EL,ET,2016,40,40,HT,LS,AL,PS	1	
49	12146000059	CM4255M,FLTR-SHEET,PC,TL,5	1	
48	12100005157	CM4255M,LED COVER,SPT,TL,0	1	
47	12340000033	LED,DM,AP,25,10,6,4,0,2,0,CM4255M	1	
46	12146000180	CM4255M,STRIP,SOLA,CEL	2	
45	1412000133701	CM4255M,LED LI-COVER,PMMA,MIT	1	
44	121460001207	CM4255M,LIGHT SHIELD,SHEET,IN,FOLIO	1	
43	14240001646	IC,AP,REG,LM-66387,7,0,3,3,LEVEL	1	
42	12146000436	CM7552,EMOTE,WA,LE,PA,7,4,6	1	
41	12145000118	CM7552,EMOTE,DIS,TR,OC,2,PM,DRK	1	
40	8430M4255M40003	8430M4255M40003	1	
39	121104050023	SCREW,PTS,BLUE,ZINC,AP,5	4	
38	8430M4255M40001	8430M4255M40001	1	
37	14480000174	SEC,C,CL,0-CO,NG-PT,ACT,260,LS,9MM	1	
36	14100011465	DR,HA,LE,CK-BOT,BACK,SEC,TL,0	1	
35	8430M4255M40001	8430M4255M40001	1	
34	14100011484	DR,HA,LE,TRP,COVER,SEC,TL,0	1	
33	12110807009	SCREW,PTS,BLUE,ZINC,M2,PH12	2	
32	12101000275	CM4255M,LIGHT SHIELD,LS,LINE,OUT	1	
31	12110407008	SCREW,PTS,BLUE,ZINC,M2,PH6	6	
30	8430M4255M40003	8430M4255M40003	1	
29	14100005155	CM4255M,LED COVER,SEC,TL,0	1	
28	12105000023	HEX,NOM,AL,NUT,BLUE,ZINC,M2,PH2,5	2	
27	12110007009	SCREW,PTS,BLUE,ZINC,AP,5	3	
26	14100005154	CM4255M-LED COVER,SEC,TL,0	1	
25	12110407007	SCREW,PTS,BLUE,ZINC,M2,PH5	12	
24	14100005156	CM4255M,LED COVER,SEC,TL,0	1	
23	14100001722	DR,HA,LE,BOT,COVER,SEC,TL,0	1	
22	12104500007	SCREW,PTS,BLUE,ZINC,M2,PH5	10	
21	12104500007	SCREW,PTS,BLUE,ZINC,M2,PH5	10	
20	8430M4255M40003	8430M4255M40003	1	
19	1212000124000	CM4255M,BOT LI-COVER,PMMA	1	
18	1212300501000	CM4255M,LEM,BUTTON,PC,PMMA	1	
17	14123035788018	CM4255M,PRE-BUTTON,PC,GEN-BLK	1	
16	14123035781018	CM4255M,LED,BUTTON,PC,GEN-BLK	1	
15	12360010004	MIC,FMS,LS,3000CT-C12,2,8,2,PH,1.2,PH,0	1	
14	12146000195	DR-30,0MM,COVER,PMMA	1	
13	14123035788018	CM4255M,RIGHT,BUTTON,PC,GEN-BLK	1	
12	14123035788018	CM4255M,LEFT,BUTTON,PC,GEN-BLK	1	
11	12123005788000	CM4255M,PRE-EST,BUTTON,ABS	1	
10	12121000258000	CM4255M,PANEL,PC	1	
9	14123035781018	CM4255M,LED,BUTTON,PC,GEN-BLK	1	
8	12144500189	CM4255M,DOUBLE TAPE,MB,LENS	1	
7	14123035783018	CM4255M,DRP,BUTTON,PC,GEN-BLK	1	
6	1212000081468	CM4255M,LENS,PMMA,BLK,CH,505 NEW	1	
5	12129000273000	CM4255M,USB COVER,PC	1	
4	121230050660	CM4255M,SPRING FOR VOL,IN,OL,PM,TR,0,1	1	
3	12123005784000	CM4255M,VOL,KNOB,ABS	1	
2	14123005785017	CM4255M,ANOD CAP,ABS,PLT-SL	1	
1	14123035785018	CM4255M,MENU,BUTTON,PC,GEN-BLK	1	

Packing materials and accessories parts list

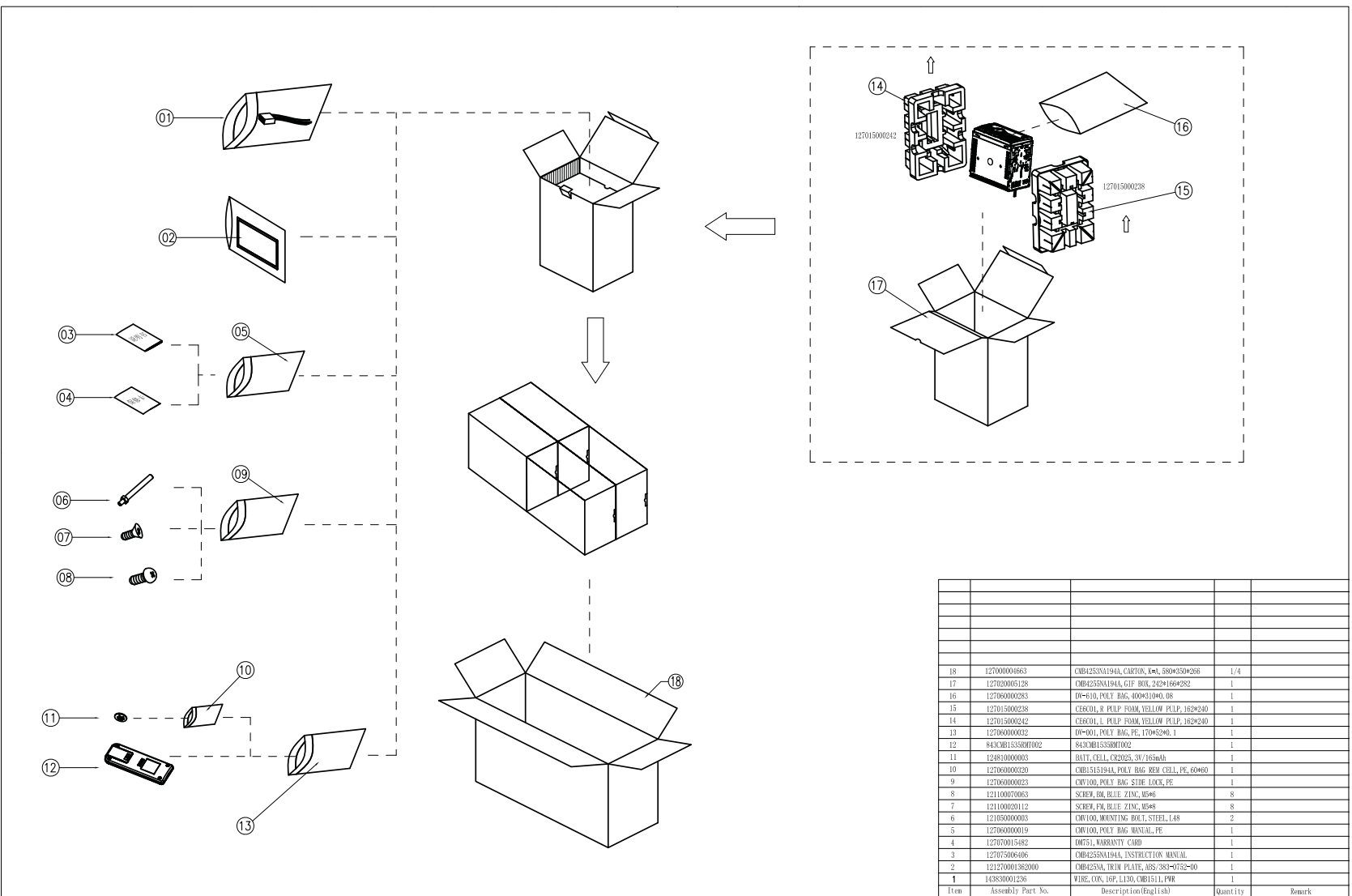

Item No.	Part No.	Description	Quantity	Remark
18	12700004663	CMB425NA194A CARTON, 1x1, 589x350x296	1/4	
17	12702005128	CMB425NA194A GIF BOX, 249x166x582	1	
16	127060000283	DW=610, POLY BAG, 400x310x0, 08	1	
15	127015000238	CER001, 8 P.L.P. FOAM, YELLOW P.L.P., 162x240	1	
14	127015000242	CER001, L P.L.P. FOAM, YELLOW P.L.P., 162x240	1	
13	127060000032	DW=001, POLY BAG, PE, 170x52x0, 1	1	
12	843CMB1538R01002	843CMB1538R01002	1	
11	124810000003	BATT, CELL, CR2025, 3V/165mAh	1	
10	127060000230	CMB1515194A, POLY BAG, REM CELL, PE, 60x60	1	
9	127060000023	CMB100, POLY BAG, SIDE LOCK, PE	1	
8	121100070063	SCREW, BR, BLUE ZINC, W5x6	8	
7	121100020112	SCREW, PB, BLUE ZINC, W5x8	8	
6	121050000003	CMB100, MOUNTING BOLT, STEEL, L48	2	
5	127060000019	CMB100, POLY BAG, MINIM., PE	1	
4	127070015482	HW51, HARDENED CHOP	1	
3	127075009406	CMB425NA194A, INSTRUCTION MANUAL	1	
2	121270001363000	CMB425NA, TRIM PLATE, ABS/383-9752-00	1	
1	143830001236	WIRE, COP, 16F, L130, CMB1511, PWR	1	

CX505