

DNR-1000U/DNX210EX

EXPLODED VIEW (CD MECHANISM)

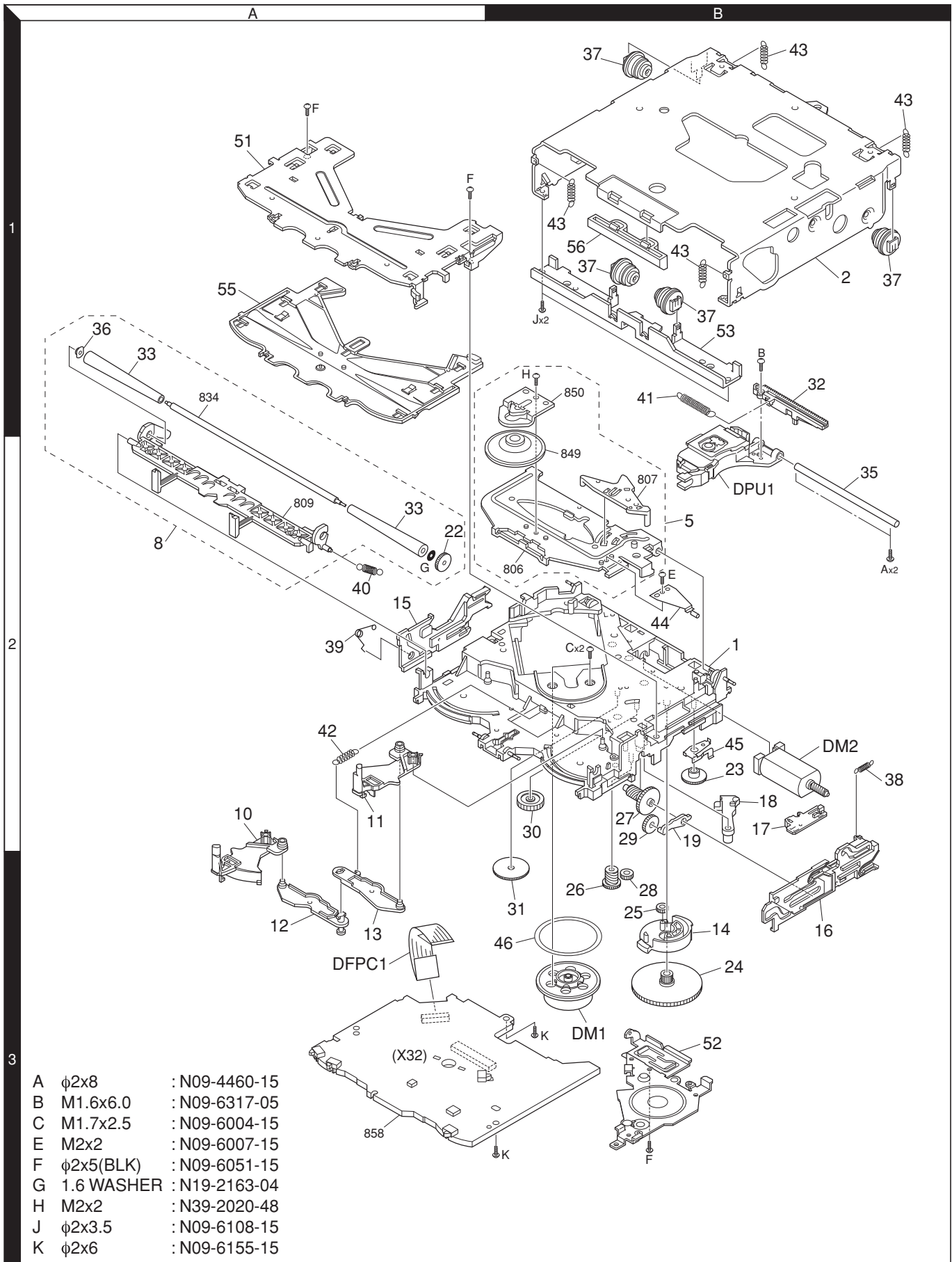

Parts with the exploded numbers larger than 700 are not supplied.

EXPLODED VIEW (UNIT)

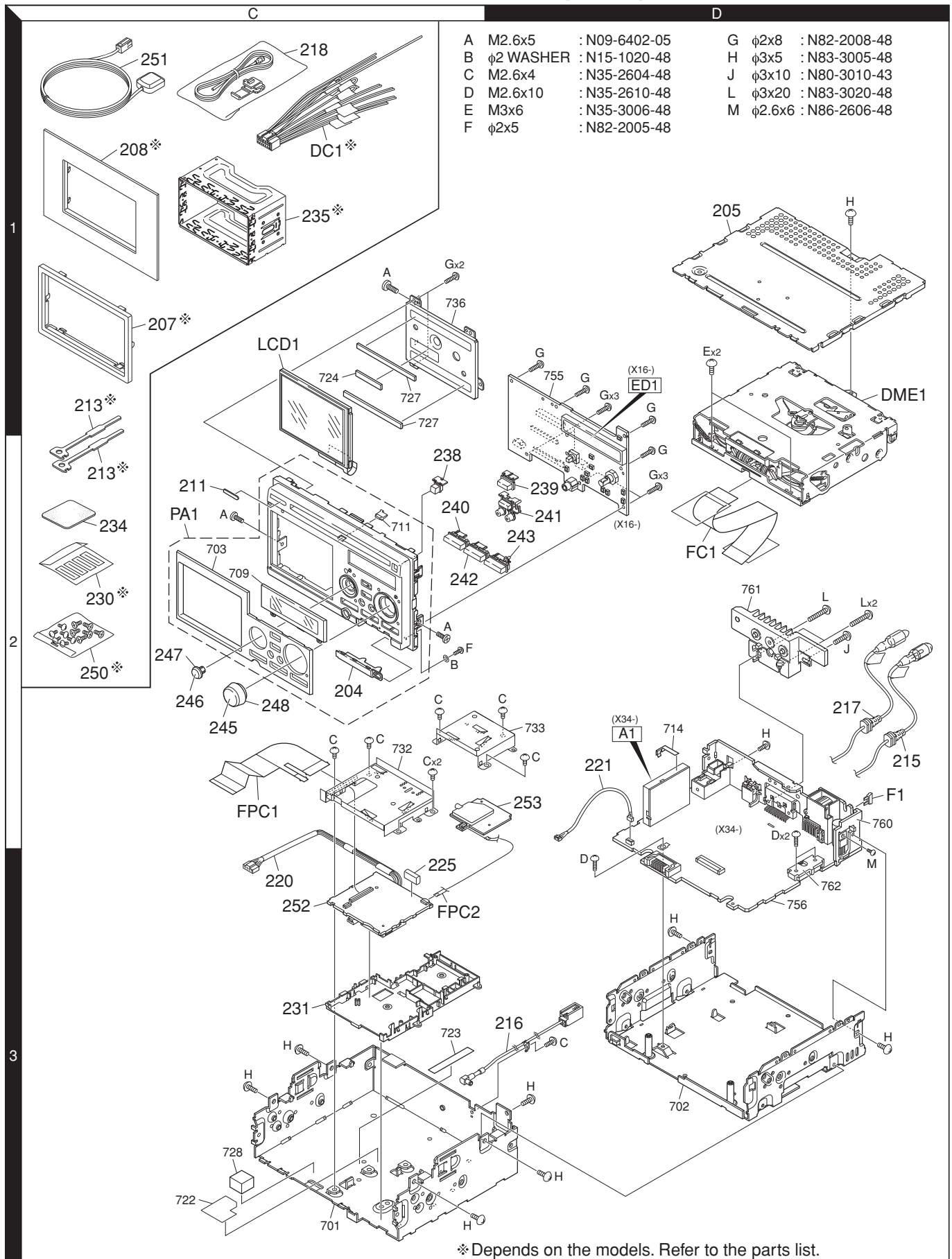

Parts with the exploded numbers larger than 700 are not supplied.

DNR-1000U/DNX210EX

PARTS LIST

* New parts

Parts without **Parts No.** are not supplied.

Les articles non mentionnés dans le **Parts No.** ne sont pas fournis.

Teile ohne **Parts No.** werden nicht geliefert.

Ref. No.	Ad	New	Parts No.	Description	Destination
DNR-1000U, DNX210EX					
204	2C	*	A21-6621-13	DRESSING PANEL	
205	1D		A52-0821-12	TOP PLATE	K
205	1D	*	A52-0896-02	TOP PLATE	K1
PA1	2C	*	A64-4269-12	PANEL ASSY	K
PA1	2C	*	A64-4374-02	PANEL ASSY	K1
-		*	B54-4602-00	INSTALLATION MANUAL	K1
-		*	B64-3787-10	INSTRUCTION MANUAL (AUDIO,E.F.S)	K
-		*	B64-3816-00	INSTRUCTION MANUAL (NAVI,E.F.S)	K
-		*	B64-3895-00	INSTRUCTION MANUAL (AUDIO,E.S.F)	K1
-		*	B64-3896-00	INSTRUCTION MANUAL (NAVI,E.F.S)	K1
207	1C		B07-3165-02	ESCUTCHEON	K1
208	1C		B07-3172-12	ESCUTCHEON	K1
211	2C		B43-1524-04	BADGE	
LCD1	1C	*	B38-1197-05	LCD ASSY	
213	1C		D10-4589-04	LEVER	K1
215	2D		E30-6673-05	CORD WITH CONNECTOR (REMO)	
216	3D	*	E30-6737-05	CORD WITH CONNECTOR (GPS)	
217	2D	*	E30-6739-05	CORD WITH CONNECTOR (PRK)	
218	1C	*	E30-6744-05	CONNECTING CORD ASSY (PRK ASSY)	
220	3C	*	E39-0938-05	WIRING HARNESS	
221	2D	*	E39-0939-05	WIRING HARNESS	
△ DC1	1C		E30-6415-15	DC CORD	K1
FC1	2D		E39-0736-05	FLAT CABLE	
225	3C	*	F12-0953-04	SHIELDING TUBE (NAVI)	
△ F1	2D		F52-0006-05	FUSE(MINI BLADE TYPE) 10A	
-		*	H54-4103-03	ITEM CARTON CASE	K
-		*	H54-4149-03	ITEM CARTON CASE	K1
230	2C		H30-0595-04	ADHESIVE DOUBLE-COATED TAPE	K1
231	3C	*	J19-7181-01	HOLDER	
234	2C		J21-9867-04	MOUNTING HARDWARE (GPS)	
235	1C		J22-0429-13	MOUNTING HARDWARE ASSY	K1
FPC1	2C	*	J86-0040-05	FPC (LEAD FREE)	
FPC2	3C	*	J86-0043-05	FPC (LEAD FREE)	
238	2C	*	K24-4778-13	PUSH KNOB (CDEJ)	
239	2D	*	K24-4779-13	PUSH KNOB (POWER)	
240	2C	*	K25-1901-03	PUSH KNOB (1-2)	
241	2D	*	K25-1902-03	PUSH KNOB (ATT,AUTO,BOOST)	
242	2C	*	K25-1904-03	PUSH KNOB (3/4)	
243	2D	*	K25-1905-03	PUSH KNOB (5-6)	
245	2C		K28-0230-03	KEY TOP (VOL)	
246	2C		K28-0232-03	KEY TOP (4DIR)	
247	2C		K28-0235-03	KNOB BASE (4DIR)	
248	2C	*	K28-0265-03	KNOB ASSY (VOL)	
250	2C	*	N99-1814-05	SCREW SET	K1
A	2C		N09-6402-05	MACHINE SCREW (M2.6X5)	
B	2C	*	N15-1020-48	FLAT WASHER (2)	
C	2C		N35-2604-48	BINDING HEAD MACHINE SCREW	
D	2D	*	N35-2610-48	BINDING HEAD MACHINE SCREW	
E	1D		N35-3006-48	BINDING HEAD MACHINE SCREW	
F	2C		N82-2005-48	BINDING HEAD TAPTITE SCREW	
G	1D		N82-2008-48	BINDING HEAD TAPTITE SCREW	

Ref. No.	Ad	New	Parts No.	Description	Destination
H	1D		N83-3005-48	PAN HEAD TAPTITE SCREW	
251	1C		W02-5229-05	ELECTRIC CIRCUIT MODUL (GPS-ANT)	
252	3C	*	W02-5261-05	ELECTRIC CIRCUIT MODULE (NAVI)	
253	2D	*	W02-5262-05	ELECTRIC CIRCUIT MODULE (GPS)	
DME1	1D		X92-5880-01	CD MECHANISM ASSY (DXM-6E01W)	
SWITCH UNIT (X16-6150-10)					
D3			B30-1566-05	LED (1608,RED)	K
D3			B30-1627-05	LED (1608 ULTRA RED)	K1
D16-27			B30-1627-05	LED (1608 ULTRA RED)	K1
D16-27			B30-1649-05	LED (1608,D)	K
D40-44			B30-1766-05	LED	
C3,4			CK73GB1H102K	CHIP C 1000PF	K
C5			CK73GB1H103K	CHIP C 0.010UF	K
C6,7			CK73GB1H104K	CHIP C 0.10UF	K
C9-14			CK73GB1H103K	CHIP C 0.010UF	K
C16			CK73GB1H103K	CHIP C 0.010UF	K
C17			CE32BM1E101M	CHIP EL 100UF 25WV	
C18			CK73GB1H103K	CHIP C 0.010UF	K
C19,20			CE32BM1C221M	CHIP EL 220UF 16WV	
C21,22			CK73GB1H103K	CHIP C 0.010UF	K
C23			CK73GB1H104K	CHIP C 0.10UF	K
C24			CK73GB1H102K	CHIP C 1000PF	K
C25-27			CC73GCH1H471J	CHIP C 470PF	J
C28			CC73GCH1H102J	CHIP C 1000PF	J
C29			CK73GB1H104K	CHIP C 0.10UF	K
C30			CK73GB1H103K	CHIP C 0.010UF	K
C36			CE32BM1E101M	CHIP EL 100UF 25WV	
CN1		*	E41-2914-05	FLAT CABLE CONNECTOR	
CN2		*	E41-2087-05	FLAT CABLE CONNECTOR	
CN3		*	E41-2893-05	SOCKET FOR PIN ASSY	
CN5		*	E41-2911-05	PIN ASSY	
CN6		*	E41-2812-05	FLAT CABLE CONNECTOR	
CN7		*	E41-2897-05	PIN ASSY	
J1			E11-0649-05	3.5D PHONE JACK	
L1			L33-2208-05	CHOKE COIL	
CP1,2			RK74HB1J101J	CHIP-COM 100 J 1/16W	
CP3			RK74HB1J222J	CHIP-COM 2.2K J 1/16W	
CP4			RK74HB1J473J	CHIP-COM 47K J 1/16W	
CP5			RK74GA1J101J	CHIP-COM 100 J 1/16W	
R1			RK73EB2E101J	CHIP R 100 J 1/4W	
R2			RK73EB2E102J	CHIP R 1.0K J 1/4W	
R3-9			RK73EB2E101J	CHIP R 100 J 1/4W	
R10			RK73GB2A104J	CHIP R 100K J 1/10W	
R11			RK73GB2A4R7J	CHIP R 4.7 J 1/10W	
R13			RK73GB2A101J	CHIP R 100 J 1/10W	
R14			RK73GB2A000J	CHIP R 0.0 J 1/10W	
R15			RK73GB2A101J	CHIP R 100 J 1/10W	
R23			RK73GB2A473J	CHIP R 47K J 1/10W	
R26			RK73GB2A473J	CHIP R 47K J 1/10W	
R29			RK73GB2A473J	CHIP R 47K J 1/10W	
R51			RK73FB2B152J	CHIP R 1.5K J 1/8W	

K : DNR-1000U K1 : DNX210EX (North America)

△ Indicates safety critical components.

PARTS LIST

SWITCH UNIT (X16-6150-10)

Ref. No.	Add	New	Parts No.	Description	Destination
R52,53			RK73FB2B821J	CHIP R 820 J 1/8W	
R54			RK73FB2B241J	CHIP R 240 J 1/8W	
R55		*	RK73EB2E242J	CHIP R 2.4K J 1/4W	
R56			RK73EB2E132J	CHIP R 1.3K J 1/4W	
R57			RK73FB2B122J	CHIP R 1.2K J 1/8W	
R59			RK73FB2B152J	CHIP R 1.5K J 1/8W	
R60			RK73EB2E911J	CHIP R 910 J 1/4W	
R73			RK73PB2H220J	CHIP R 22 J 1/2W	
R74,75			RK73PB2H330J	CHIP R 33 J 1/2W	
R104			RK73GB2A223J	CHIP R 22K J 1/10W	
R105			RK73GB2A222J	CHIP R 2.2K J 1/10W	
R111,112			RK73GB2A104J	CHIP R 100K J 1/10W	
R132			RK73FB2B122J	CHIP R 1.2K J 1/8W	
S2			S70-0106-05	TACT SWITCH	
S3-14			S70-0901-05	TACT SWITCH	
S1			T99-0474-05	ROTARY ENCODER	
D4			DA204U	DIODE	
D5-12			UDZ5.6B	ZENER DIODE	
D13		*	SFPB-74VNF	DIODE	
D14			IMSA-6802-E	SURGE ABSORBER	
D15			UDZ5.6B	ZENER DIODE	
D45			DAN222	DIODE	
ED1	1D	*	3-BT-255IN	FLUORESCENT INDICATOR TUBE	
IC1			SI-8050JDNF	ANALOGUE IC	
Q1			DTC144EUA	DIGITAL TRANSISTOR	
Q2			DTC114EUA	DIGITAL TRANSISTOR	
Q3-6			2SA1774	TRANSISTOR	
Q7			DTC144EUA	DIGITAL TRANSISTOR	
Q8			DTC114YUA	DIGITAL TRANSISTOR	
TH1			TN20-3T333JTP	THERMISTOR	
CD PLAYER UNIT (X32-5970-00)					
C20			CC73GCH1H680J	CHIP C 68PF J	
C21			CK73GB1H472K	CHIP C 4700PF K	
C22			CK73GB1H222K	CHIP C 2200PF K	
C23			CC73GCH1H220J	CHIP C 22PF J	
C24			CK73EB1A475K	CHIP C 4.7UF K	
C25			CK73FB0J106K	CHIP C 10UF K	
C26			CK73GB1H153K	CHIP C 0.015UF K	
C27			CC73GCH1H470J	CHIP C 47PF J	
C29			C93-1451-05	CHIP C 0.10UF K	
C30-32			CK73GB1H103K	CHIP C 0.010UF K	
C33			CK73GB1H332K	CHIP C 3300PF K	
C34			C93-1451-05	CHIP C 0.10UF K	
C35			CK73GB1H153K	CHIP C 0.015UF K	
C36			C93-1451-05	CHIP C 0.10UF K	
C38			CC73GCH1H680J	CHIP C 68PF J	
C39,40			C93-1451-05	CHIP C 0.10UF K	
C41			CK73GB1A105K	CHIP C 1.0UF K	
C44			C93-1451-05	CHIP C 0.10UF K	
C45,46			CK73GB1H222K	CHIP C 2200PF K	
C47,48			CK73GB1H333K	CHIP C 0.033UF K	
C49,50			C93-1451-05	CHIP C 0.10UF K	
C51			CK73GB1H222K	CHIP C 2200PF K	

Ref. No.	Add	New	Parts No.	Description	Destination
C52,53			C93-1451-05	CHIP C 0.10UF K	
C54			CK73GB1A105K	CHIP C 1.0UF K	
C58			CK73EB1E105K	CHIP C 1.0UF K	
C60			CK73EB0J226K	CHIP C 22UF K	
C61-64			C93-1451-05	CHIP C 0.10UF K	
C66			CK73FB1C105K	CHIP C 1.0UF K	
C68,69			C93-1451-05	CHIP C 0.10UF K	
C71			C93-1451-05	CHIP C 0.10UF K	
C72			CK73EB1A106K	CHIP C 10UF K	
C73			CK73GB1A105K	CHIP C 1.0UF K	
C74			CK73GB1C224K	CHIP C 0.22UF K	
C76			CK73GB1H103K	CHIP C 0.010UF K	
C77			CK73FB1A225K	CHIP C 2.2UF K	
C87,88			CK73GB1H222K	CHIP C 2200PF K	
C89-91			C93-1451-05	CHIP C 0.10UF K	
C94,95			CK73GB1A105K	CHIP C 1.0UF K	
C96			CK73GB1H103K	CHIP C 0.010UF K	
C97			C93-1451-05	CHIP C 0.10UF K	
C100,101			CK73GB1A105K	CHIP C 1.0UF K	
C102			CK73FB1A225K	CHIP C 2.2UF K	
C103			CK73GB1H153K	CHIP C 0.015UF K	
CN1			E41-2612-05	FLAT CABLE CONNECTOR	
CN2			E41-2083-15	FLAT CABLE CONNECTOR	
X1			L78-1221-05	RESONATOR (16.93MHZ)	
CP7			RK74GB1J103J	CHIP-COM 10K J 1/16W	
R20			RK73GB2A393J	CHIP R 39K J 1/10W	
R21			RK73GB2A163J	CHIP R 16K J 1/10W	
R22			RK73GB2A562J	CHIP R 5.6K J 1/10W	
R23			RK73GB2A273J	CHIP R 27K J 1/10W	
R25			RK73GB2A562J	CHIP R 5.6K J 1/10W	
R26			RK73GB2A683J	CHIP R 68K J 1/10W	
R27			RK73GB2A333J	CHIP R 33K J 1/10W	
R28			RK73GB2A563J	CHIP R 56K J 1/10W	
R29			RK73GB2A102J	CHIP R 1.0K J 1/10W	
R30			RK73GB2A101J	CHIP R 100 J 1/10W	
R31			RK73GB2A133J	CHIP R 13K J 1/10W	
R32			RK73GB2A181J	CHIP R 180 J 1/10W	
R33			RK73GB2A153J	CHIP R 15K J 1/10W	
R34			RK73GB2A473J	CHIP R 47K J 1/10W	
R35			RK73GB2A562J	CHIP R 5.6K J 1/10W	
R36			RK73GB2A154J	CHIP R 150K J 1/10W	
R37			RK73GB2A334J	CHIP R 330K J 1/10W	
R38			RK73GB2A223J	CHIP R 22K J 1/10W	
R40			RK73GB2A273J	CHIP R 27K J 1/10W	
R41			RK73GB2A393J	CHIP R 39K J 1/10W	
R45			RK73GB2A221J	CHIP R 220 J 1/10W	
R46			RK73GB2A105J	CHIP R 1.0M J 1/10W	
R48,49			RK73GB2A105J	CHIP R 1.0M J 1/10W	
R50			RK73GB2A560J	CHIP R 56 J 1/10W	
R51			RK73EB2E220J	CHIP R 22 J 1/4W	
R52			RK73EB2E100J	CHIP R 10 J 1/4W	
R55			RK73GB2A103J	CHIP R 10K J 1/10W	
R59			RK73GB2A4R7J	CHIP R 4.7 J 1/10W	

K : DNR-1000U K1 : DNX210EX (North America)

△ Indicates safety critical components.

DNR-1000U/DNX210EX

PARTS LIST

CD PLAYER UNIT (X32-5970-00)

Ref. No.	Add	New	Parts No.	Description	Destination
R60,61			RK73GB2A103J	CHIP R 10K J 1/10W	
R82,83			RK73GB2A102J	CHIP R 1.0K J 1/10W	
R216,217			RK73GB2A103J	CHIP R 10K J 1/10W	
R218			RK73GB2A102J	CHIP R 1.0K J 1/10W	
R219,220			RK73GB2A472J	CHIP R 4.7K J 1/10W	
R221,222			RK73GB2A101J	CHIP R 100 J 1/10W	
R223			RK73GB2A103J	CHIP R 10K J 1/10W	
R226-230			RK73GB2A101J	CHIP R 100 J 1/10W	
R231			RK73GB2A473J	CHIP R 47K J 1/10W	
R232			RK73GB2A104J	CHIP R 100K J 1/10W	
R233			RK73GB2A331J	CHIP R 330 J 1/10W	
R239			RK73GB2A472J	CHIP R 4.7K J 1/10W	
R240			RK73EB2E470J	CHIP R 47 J 1/4W	
R241			RK73GB2A104J	CHIP R 100K J 1/10W	
R243			RK73GB2A472J	CHIP R 4.7K J 1/10W	
R244			RK73GB2A225J	CHIP R 2.2M J 1/10W	
R245			RK73GB2A000J	CHIP R 0.0 J 1/10W	
R246			RK73GB2A333J	CHIP R 33K J 1/10W	
R247			RK73GB2A183J	CHIP R 18K J 1/10W	
R248			RK73GB2A472J	CHIP R 4.7K J 1/10W	
R251			RK73GB2A473J	CHIP R 47K J 1/10W	
R252			RK73GB2A102J	CHIP R 1.0K J 1/10W	
S1,2			S68-0863-05	PUSH SWITCH	
S3			S68-0862-05	PUSH SWITCH	
D1			DA204U	DIODE	
D2			DAP202U	DIODE	
D3,4			DA204U	DIODE	
IC3			BA5824FP	ANALOGUE IC	
IC4			TC94A70FG-007	MOS-IC	
IC5			S-1132B15U5T1G	ANALOGUE IC	
IC6			S-1132B33U5T1G	ANALOGUE IC	
IC7			TAR5S33-F	ANALOGUE IC	
IC11			XC6206P152MR	ANALOGUE IC	
Q1			2SB0970	TRANSISTOR	
Q10-12			UM6K1N	DUAL FET	
Q13			DTC114YUA	DIGITAL TRANSISTOR	
ELECTRIC UNIT (X34-5620-1x)					
C1			CD04AZ1C332M2	ELECTRO 3300UF 16WV	
C2			CD04AS1C220M	ELECTRO 22UF 16WV	
C3,4			CK73GB1H104K	CHIP C 0.10UF K	
C5,6	*		C90-6851-05	ELECTRO 220UF 25WV	
C7			CD04AS0J101M	ELECTRO 100UF 6.3WV	
C9			CK73GB1H104K	CHIP C 0.10UF K	
C11			CK73FB1A225K	CHIP C 2.2UF K	
C12			CK73GB1H104K	CHIP C 0.10UF K	
C14			CK73GB1H104K	CHIP C 0.10UF K	
C15			CD04AS1C220M	ELECTRO 22UF 16WV	
C16,17			CK73FB1A225K	CHIP C 2.2UF K	
C18,19			CK73GB1H104K	CHIP C 0.10UF K	
C20			CC73GCH1H101J	CHIP C 100PF J	
C101,102			CK73GB1H103K	CHIP C 0.010UF K	
C201			CK73GB1A105K	CHIP C 1.0UF K	
C202			CC73GCH1H180J	CHIP C 18PF J	

Ref. No.	Add	New	Parts No.	Description	Destination
C203			CC73GCH1H220J	CHIP C 22PF J	
C204			CK73GB1H104K	CHIP C 0.10UF K	
C205			CK73GB1H102K	CHIP C 1000PF K	
C301,302			CD04AS1HR47M	ELECTRO 0.47UF 50WV	
C306,307			CK73FB1E474K	CHIP C 0.47UF K	
C308			CD04AS0J470M	ELECTRO 47UF 6.3WV	
C309			CK73GB1H103K	CHIP C 0.010UF K	
C401			CD04AS1C470M	ELECTRO 47UF 16WV	
C403			CD04AS1H010M	ELECTRO 1UF 50WV	
C404			CK73GB1H103K	CHIP C 0.010UF K	
C405			CK73GB1H104K	CHIP C 0.10UF K	
C502			CK73GB1H103K	CHIP C 0.010UF K	
C504			CK73GB1H103K	CHIP C 0.010UF K	
C506			CK73GB1H103K	CHIP C 0.010UF K	
C508			CK73GB1H103K	CHIP C 0.010UF K	
C509,510			CK73GB1A474K	CHIP C 0.47UF K	
C601,602			CK73FB1E474K	CHIP C 0.47UF K	
C603			CD04AT0J470M	ELECTRO 47UF 6.3WV	
C604			CK73GB1H103K	CHIP C 0.010UF K	
C620			CD04AS1C470M	ELECTRO 47UF 16WV	
C621-623			CK73GB1H104K	CHIP C 0.10UF K	K1
C701,702			CD04AS1V100M	ELECTRO 10UF 35WV	
C703,704			CC73GCH1H681J	CHIP C 680PF J	
C801-804			C90-5684-05	NP-ELECT 0.22UF 50WV	
C805			CD04AS1C470M	ELECTRO 47UF 16WV	
C806			CK73GB1H472K	CHIP C 4700PF K	
C807			CD04AS1H010M	ELECTRO 1UF 50WV	
C808			C90-6802-05	ELECTRO 1UF 50WV	
C809			CK73GB1A105K	CHIP C 1.0UF K	
C901,902			CD04AS1C101M	ELECTRO 100UF 16WV	
C990			CK73GB1H223K	CHIP C 0.022UF K	
C991			CD04AT0J331M	ELECTRO 330UF 6.3WV	
C992			CK73GB1H102K	CHIP C 1000PF K	
C993			CK73GB1H103K	CHIP C 0.010UF K	
C994,995			CK73GB1H104K	CHIP C 0.10UF K	
C996,997			CK73GB1H102K	CHIP C 1000PF K	
C998,999			CK73GB1C224K	CHIP C 0.22UF K	
CN2			E41-2352-05	FLAT CABLE CONNECTOR	
CN3			E41-1699-05	PIN ASSY	
CN5			E41-2092-05	PIN ASSY	
CN6	*		E41-2897-05	PIN ASSY	
CN7	*		E41-2896-05	PIN ASSY	
CN8	*		E41-2653-05	PIN ASSY	
J1			E58-0991-05	RECTANGULAR RECEPTACLE	K1
J2			E04-0332-05	RF COAXIAL CABLE RECEPTACLE	
J4			E56-0855-05	CYLINDRICAL RECEPTACLE	
J5			E63-0898-05	PIN JACK	
L1			L33-2319-05	CHOKE COIL ASSY	
L401			L41-4795-33	SMALL FIXED INDUCTOR (4.7U)	
L620			L41-4795-33	SMALL FIXED INDUCTOR (4.7U)	
L621			L92-0373-05	CHIP FERRITE	
X1			L78-0879-05	RESONATOR (10.0MHZ)	
X2			L77-2920-05	CRYSTAL RESONATOR	

K : DNR-1000U K1 : DNX210EX (North America)

△ Indicates safety critical components.

PARTS LIST

ELECTRIC UNIT (X34-5620-1x)

Ref. No.	Add	New	Parts No.	Description	Destination	Ref. No.	Add	New	Parts No.	Description	Destination
J	2D		N80-3010-43	PAN HEAD TAPTITE SCREW		R319			RK73GB2A222J	CHIP R 2.2K J 1/10W	
H	2D		N83-3005-48	PAN HEAD TAPTITE SCREW		R320			RK73GB2A472J	CHIP R 4.7K J 1/10W	
L	2D		N83-3020-48	PAN HEAD TAPTITE SCREW		R329			RD14BB2C102J	RD 1.0K J 1/6W	
M	2D		N86-2606-48	BINDING HEAD TAPTITE SCREW		R330			RK73GB2A222J	CHIP R 2.2K J 1/10W	
						R331			RK73GB2A473J	CHIP R 47K J 1/10W	
R1			RD14BB2C102J	RD 1.0K J 1/6W		R332			RK73GB2A222J	CHIP R 2.2K J 1/10W	
R2-5			RD14BB2C103J	RD 10K J 1/6W		R333			RK73GB2A102J	CHIP R 1.0K J 1/10W	
R16			RK73FB2B681J	CHIP R 680 J 1/8W		R334			RK73GB2A222J	CHIP R 2.2K J 1/10W	
R17			RK73GB2A272J	CHIP R 2.7K J 1/10W		R335			RK73GB2A473J	CHIP R 47K J 1/10W	
R18-25		*	RK73PB2H6R2J	CHIP R 6.2 J 1/2W		R336-339			RK73GB2A222J	CHIP R 2.2K J 1/10W	
R101,102			RD14BB2C472J	RD 4.7K J 1/6W		R340			RK73GB2A225J	CHIP R 2.2M J 1/10W	
R103			RD14BB2C103J	RD 10K J 1/6W		R341			RK73GB2A222J	CHIP R 2.2K J 1/10W	
R104			RK73GB2A473J	CHIP R 47K J 1/10W		R342			RK73GB2A473J	CHIP R 47K J 1/10W	
R105			RK73GB2A104J	CHIP R 100K J 1/10W		R343			RK73GB2A222J	CHIP R 2.2K J 1/10W	
R106			RD14DB2H332J	SMALL-RD 3.3K J 1/2W		R344,345			RD14BB2C4R7J	RD 4.7 J 1/6W	
R107			RD14BB2C333J	RD 33K J 1/6W		R346			RD14BB2C2R2J	RD 2.2 J 1/6W	
R108			RK73GB2A103J	CHIP R 10K J 1/10W		R347			RK73GB2A102J	CHIP R 1.0K J 1/10W	
R109			RD14BB2C223J	RD 22K J 1/6W		R402,403			RD14BB2C471J	RD 470 J 1/6W	
R110			RK73FB2B683J	CHIP R 68K J 1/8W		R404			RD14BB2C102J	RD 1.0K J 1/6W	
R111			RK73GB2A393J	CHIP R 39K J 1/10W		R405			RK73GB2A473J	CHIP R 47K J 1/10W	
R112			RD14BB2C203J	RD 20K J 1/6W		R406			RK73GB2A223J	CHIP R 22K J 1/10W	
R113			RK73GB2A104J	CHIP R 100K J 1/10W		R407			RD14BB2C103J	RD 10K J 1/6W	
R114,115			RK73GB2A103J	CHIP R 10K J 1/10W		R408			RK73GB2A152J	CHIP R 1.5K J 1/10W	
R116,117			RD14BB2C103J	RD 10K J 1/6W		R409			RK73GB2A392J	CHIP R 3.9K J 1/10W	
R201			RK73GB2A473J	CHIP R 47K J 1/10W		R501			RK73GB2A471J	CHIP R 470 J 1/10W	
R202			RK73GB2A104J	CHIP R 100K J 1/10W		R502			RK73GB2A472J	CHIP R 4.7K J 1/10W	
R203,204			RK73GB2A103J	CHIP R 10K J 1/10W		R503			RK73GB2A471J	CHIP R 470 J 1/10W	
R205,206			RK73GB2A473J	CHIP R 47K J 1/10W		R504			RK73GB2A472J	CHIP R 4.7K J 1/10W	
R207			RK73GB2A000J	CHIP R 0.0 J 1/10W		R598			RK73GB2A223J	CHIP R 22K J 1/10W	
R208			RD14BB2C473J	RD 47K J 1/6W		R599			RK73GB2A102J	CHIP R 1.0K J 1/10W	
R209,210			RD14BB2C471J	RD 470 J 1/6W		R601,602			RD14BB2C100J	RD 10 J 1/6W	
R211,212			RK73GB2A473J	CHIP R 47K J 1/10W		R603			RD14BB2C4R7J	RD 4.7 J 1/6W	
R215-217			RK73GB2A471J	CHIP R 470 J 1/10W		R604			RK73GB2A102J	CHIP R 1.0K J 1/10W	
R218			RK73GB2A223J	CHIP R 22K J 1/10W		R605			RD14BB2C101J	RD 100 J 1/6W	
R219,220			RD14BB2C104J	RD 100K J 1/6W		R606,607			RD14BB2C102J	RD 1.0K J 1/6W	
R221			RK73GB2A222J	CHIP R 2.2K J 1/10W		R608,609			RD14BB2C101J	RD 100 J 1/6W	
R222			RK73GB2A473J	CHIP R 47K J 1/10W		R610			RD14BB2C472J	RD 4.7K J 1/6W	
R223			RK73GB2A222J	CHIP R 2.2K J 1/10W		R611			RD14BB2C101J	RD 100 J 1/6W	
R224			RK73GB2A103J	CHIP R 10K J 1/10W		R612			RD14BB2C472J	RD 4.7K J 1/6W	
R226			RK73GB2A473J	CHIP R 47K J 1/10W		R620-625			RK73GB2A222J	CHIP R 2.2K J 1/10W	
R228			RK73GB2A473J	CHIP R 47K J 1/10W		R626			RK73GB2A223J	CHIP R 22K J 1/10W	K1
R229			RK73GB2A104J	CHIP R 100K J 1/10W		R627,628			RK73GB2A000J	CHIP R 0.0 J 1/10W	K
R300			RK73GB2A223J	CHIP R 22K J 1/10W		R628			RK73GB2A000J	CHIP R 0.0 J 1/10W	K1
R301			RK73GB2A222J	CHIP R 2.2K J 1/10W		R630			RK73GB2A392J	CHIP R 3.9K J 1/10W	
R302			RD14BB2C101J	RD 100 J 1/6W		R631			RK73GB2A102J	CHIP R 1.0K J 1/10W	
R303			RK73GB2A102J	CHIP R 1.0K J 1/10W		R701,702			RK73GB2A331J	CHIP R 330 J 1/10W	K1
R304			RD14BB2C102J	RD 1.0K J 1/6W		R703,704			RD14BB2C223J	RD 22K J 1/6W	K1
R305			RK73GB2A102J	CHIP R 1.0K J 1/10W		R705,706			RD14BB2C181J	RD 180 J 1/6W	K1
R306			RK73GB2A472J	CHIP R 4.7K J 1/10W		R793			RK73EB2E000J	CHIP R 0.0 J 1/4W	K1
R307			RK73GB2A222J	CHIP R 2.2K J 1/10W		R801			RK73FB2B102J	CHIP R 1.0K J 1/8W	
R310-313			RK73GB2A102J	CHIP R 1.0K J 1/10W		R802			RK73GB2A333J	CHIP R 33K J 1/10W	
R314			RK73GB2A104J	CHIP R 100K J 1/10W		R803			RK73GB2A473J	CHIP R 47K J 1/10W	
R315			RK73GB2A472J	CHIP R 4.7K J 1/10W		R804			RK73GB2A221J	CHIP R 220 J 1/10W	
R316,317			RK73GB2A222J	CHIP R 2.2K J 1/10W		R805			RK73GB2A223J	CHIP R 22K J 1/10W	
R318			RK73GB2A472J	CHIP R 4.7K J 1/10W		R806			RK73GB2A183J	CHIP R 18K J 1/10W	

K : DNR-1000U K1 : DNX210EX (North America)

△ Indicates safety critical components.

PARTS LIST

ELECTRIC UNIT (X34-5620-1x)

Ref. No.	Add	New	Parts No.	Description	Destination
R807			RK73GB2A432J	CHIP R 4.3K J 1/10W	
R808			RK73GB2A100J	CHIP R 10 J 1/10W	
R891			RK73EB2E000J	CHIP R 0.0 J 1/4W	
R892			RK73GB2A000J	CHIP R 0.0 J 1/10W	
R901,902			RK73GB2A334J	CHIP R 330K J 1/10W	
R903			RK73GB2A153J	CHIP R 15K J 1/10W	
R904			RK73GB2A223J	CHIP R 22K J 1/10W	
R905,906			RK73GB2A104J	CHIP R 100K J 1/10W	
R907-914			RD14BB2C104J	RD 100K J 1/6W	
R915			RK73GB2A104J	CHIP R 100K J 1/10W	
R951			RK73EB2E000J	CHIP R 0.0 J 1/4W	
R952,953			RK73GB2A000J	CHIP R 0.0 J 1/10W	
R955			RK73EB2E000J	CHIP R 0.0 J 1/4W	
R958			RK73GB2A000J	CHIP R 0.0 J 1/10W	K1
R962,963			RK73GB2A000J	CHIP R 0.0 J 1/10W	
R964			RK73EB2E000J	CHIP R 0.0 J 1/4W	
R967			RK73GB2A471J	CHIP R 470 J 1/10W	
R968			RK73GB2A000J	CHIP R 0.0 J 1/10W	K
R968-971			RK73GB2A000J	CHIP R 0.0 J 1/10W	K1
R971			RK73GB2A000J	CHIP R 0.0 J 1/10W	K
R972			RK73EB2E000J	CHIP R 0.0 J 1/4W	
R973			RK73GB2A000J	CHIP R 0.0 J 1/10W	
R974			RK73GB2A103J	CHIP R 10K J 1/10W	
R975,976			RK73GB2A223J	CHIP R 22K J 1/10W	
R977			RK73GB2A103J	CHIP R 10K J 1/10W	
R978-981			RK73GB2A223J	CHIP R 22K J 1/10W	
R982,983			RK73GB2A103J	CHIP R 10K J 1/10W	
R984,985			RK73GB2A222J	CHIP R 2.2K J 1/10W	
R986,987			RK73GB2A102J	CHIP R 1.0K J 1/10W	
D1			S2V60-5009F46	DIODE	
D2			MTZJ8.2 (B)	ZENER DIODE	
D3			D1FS4N	DIODE	
D4,5			1SS133	DIODE	
D7			MTZJ12 (B)	ZENER DIODE	
D101-104			D1F60-5063	DIODE	
D105			MTZJ4.7 (B)	ZENER DIODE	
D106-108			MTZJ6.8 (B)	ZENER DIODE	
D109			1SS133	DIODE	
D110			DAN202U	DIODE	
D301			DA204U	DIODE	
D303			MTZJ6.2 (B)	ZENER DIODE	
D304,305			UDZS6.8B	ZENER DIODE	
D306			MTZJ6.8 (B)	ZENER DIODE	
D401			1SS133	DIODE	
D402,403			MTZJ6.8 (B)	ZENER DIODE	
D404			1SS133	DIODE	
D501			IMSA-6802-E	SURGE ABSORBER	
D601-606			MTZJ6.8 (B)	ZENER DIODE	
D801			DAN202U	DIODE	
D802,803			1SS133	DIODE	
D804			1SR154-400	DIODE	
D901			MTZJ4.7 (B)	ZENER DIODE	
D902			RB411D	DIODE	
D991			DA204U	DIODE	

Ref. No.	Add	New	Parts No.	Description	Destination
IC1		*	M30624FGPPFP4Y5	MICROCONTROLLER IC	
IC2			E-TDA7419	ANALOGUE IC	
IC4			BD4913-V4	ANALOGUE IC	
IC6			KKZ10Z	ANALOGUE IC	
IC8			S-80836CNNB-J	MOS-IC	
IC9			HEF4053BT	MOS-IC	
IC10			BR24L04FV-W	ROM IC	
IC12,13			NJM4565V-ZB	ANALOGUE IC	
Q1			UMC2N	TRANSISTOR	
Q2			2SB1565	TRANSISTOR	
Q3			2SC4081	TRANSISTOR	
Q4			UMC2N	TRANSISTOR	
Q7			UMC2N	TRANSISTOR	
Q8			2SB1565	TRANSISTOR	
Q9			2SC4081	TRANSISTOR	
Q101-103			2SC4081	TRANSISTOR	
Q104,105			DTC144EUA	DIGITAL TRANSISTOR	
Q301			DTA114YUA	DIGITAL TRANSISTOR	
Q401			DTC144EUA	DIGITAL TRANSISTOR	
Q402			2SC4081	TRANSISTOR	
Q701,702			DTC143TUA	DIGITAL TRANSISTOR	K1
Q705			DTA124EUA	DIGITAL TRANSISTOR	K1
Q801			DTC114YUA	DIGITAL TRANSISTOR	
Q901			2SC4081	TRANSISTOR	
Q902,903			2SA1576A	TRANSISTOR	
Q904			DTA124EUA	DIGITAL TRANSISTOR	
Q905,906			DTC143TUA	DIGITAL TRANSISTOR	
TH1			PRF18BE471QS2	POSITIVE RESISTOR	
A1	2D		X86-4030-12	FRONT-END UNIT	
CD MECHANISM ASSY (X92-5880-01) (DXM-6E01W)					
1	2B		A10-5328-11	CHASSIS	
2	1B		A10-5329-11	CHASSIS	
5	2B		D10-4910-13	ARM ASSY	
8	2A	*	D10-4911-23	LEVER ASSY	
10	2A		D10-4906-33	ARM	
11	2A		D10-4907-33	ARM	
12	3A		D10-4908-03	ARM	
13	3A		D10-4909-03	ARM	
14	3B		D10-4915-03	ARM	
15	2A		D10-4916-23	SLIDER	
16	3B		D10-4914-12	SLIDER	
17	2B		D10-4588-13	SLIDER	
18	2B		D10-4917-04	ARM	
19	2B		D10-4596-24	ARM	
22	2A		D13-2151-04	GEAR	
23	2B		D13-2152-04	GEAR	
24	3B		D13-2153-04	GEAR	
25	3B		D13-2154-04	GEAR	
26	3B		D13-2155-04	WORM	
27	2B		D13-2156-14	GEAR	
28	3B		D13-2157-04	GEAR	
29	2B		D13-2158-04	GEAR	
30	2B		D13-2168-04	GEAR	

K : DNR-1000U K1 : DNX210EX (North America)

△ Indicates safety critical components.

PARTS LIST

CD MECHANISM ASSY (X92-5880-01) (DXM-6E01W)

Ref. No.	Add	New	Parts No.	Description	Destination	Ref. No.	Add	New	Parts No.	Description	Destination
31	3B		D13-2171-04	GEAR							
32	1B		D13-2400-13	RACK (GEAR)							
33	2A		D14-0759-04	ROLLER							
35	2B		D21-2382-04	SHAFT							
36	1A		D23-0954-04	RETAINER							
37	1B		D39-0246-05	DAMPER							
46	3B		F09-1804-14	SHEET							
38	2B		G01-3072-04	EXTENSION SPRING							
39	2A		G01-3073-04	TORSION COIL SPRING							
40	2A		G01-3074-04	EXTENSION SPRING							
41	1B		G01-4615-04	EXTENSION SPRING							
42	2A		G01-3076-04	EXTENSION SPRING							
43	1B		G01-3077-14	EXTENSION SPRING							
44	2B		G02-1399-04	FLAT SPRING							
45	2B		G02-1547-04	FLAT SPRING							
51	1A		J22-0473-21	MOUNTING HARDWARE							
52	3B		J22-0474-12	MOUNTING HARDWARE							
53	1B		J22-0519-03	MOUNTING HARDWARE							
55	1A		J90-1138-41	GUIDE							
56	1B		J90-1023-03	GUIDE							
DFPC1	3A		J86-0039-05	FPC (LEAD FREE)							
A	2B		N09-4460-15	TAPTITE SCREW (PT 2X8)							
B	1B		N09-6317-05	TAPTITE SCREW							
C	2B		N09-6004-15	MACHINE SCREW (M1.7X2.5)							
E	2B		N09-6007-15	MACHINE SCREW (M2X2)							
F	1A		N09-6051-15	TAPTITE SCREW (PT 2X5)							
G	2A		N19-2163-04	FLAT WASHER (1.6X6X0.25)							
H	1B		N39-2020-48	PAN HEAD MACHINE SCREW (M2X2)							
J	1B		N09-6108-15	TAPTITE SCREW (M2X3.5)							
K	3B		N09-6155-15	SEMS (TAPTITE SCREW) (PT 2X6)							
DM1	3B		T42-1066-14	DC MOTOR (SPINDLE)							
DM2	2B		T42-1067-14	DC MOTOR (LOADING/SLED)							
DPU1	2B		X93-2130-01	OPTICAL PICKUP ASSY							

K : DNR-1000U K1 : DNX210EX (North America)

△ Indicates safety critical components.