

## EXPLODED VIEW (MECHANISM)

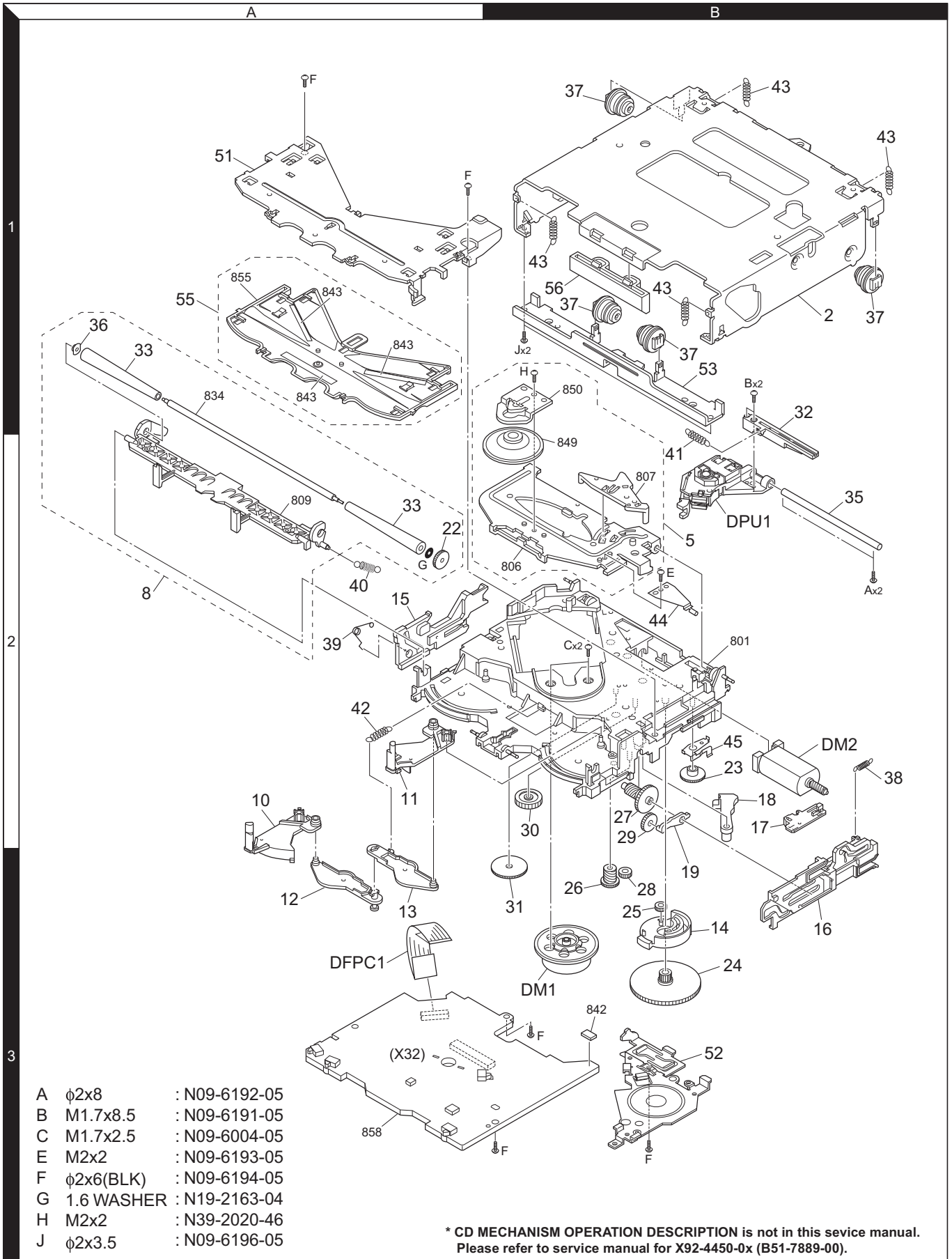

Parts with the exploded numbers larger than 700 are not supplied.

# KDC-X879

## EXPLODED VIEW (UNIT)

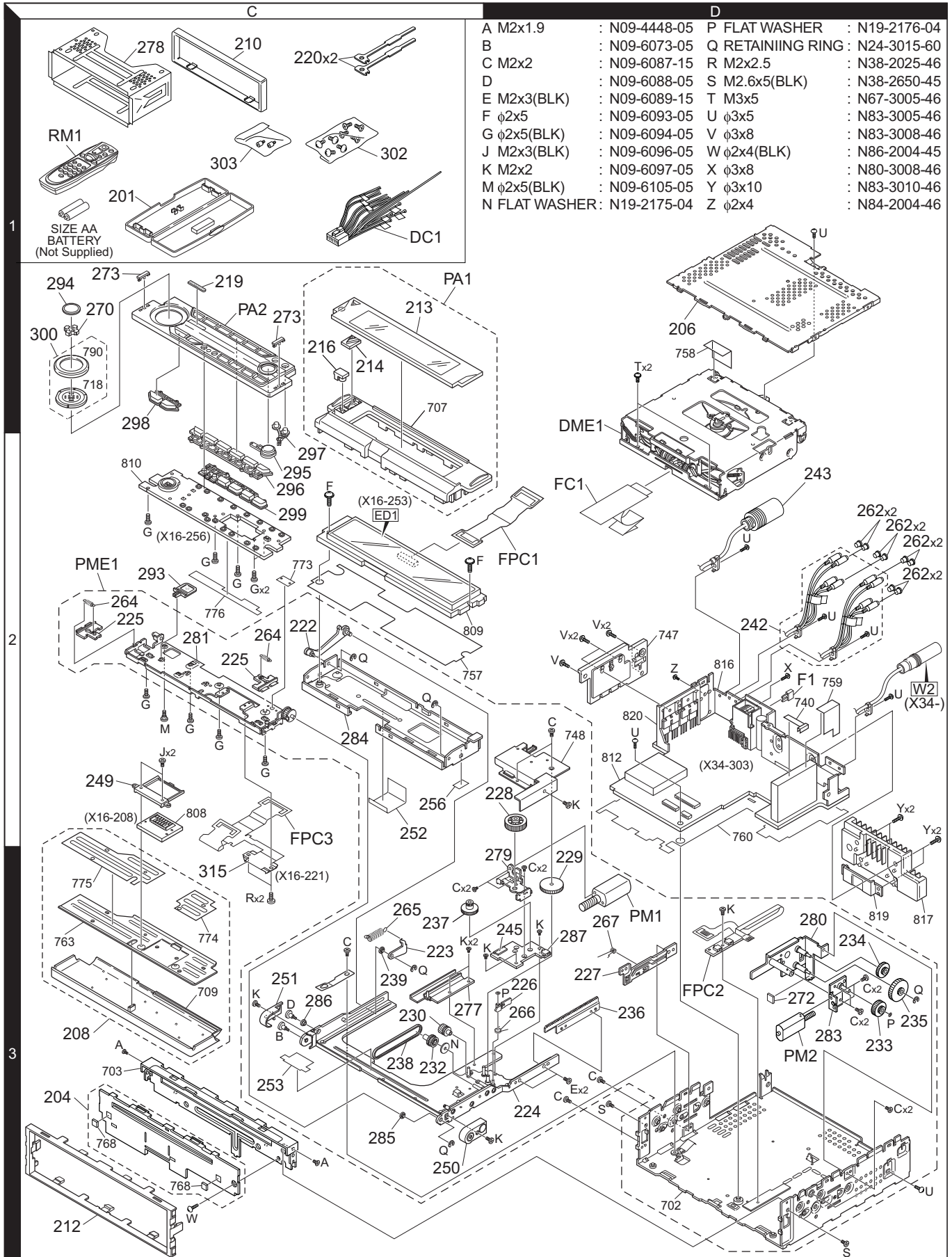

## PARTS LIST

\* New parts

Parts without **Parts No.** are not supplied.

Les articles non mentionnés dans le **Parts No.** ne sont pas fournis.

Teile ohne **Parts No.** werden nicht geliefert.

Ref. No.	A d d	N e w	Parts No.	Description	Desti- nation
<b>KDC-X879</b>					
201	1C		A02-2731-13	PLASTIC CABINET ASSY	
204	3C		A22-2988-03	SUB PANEL ASSY	
206	1D		A52-0831-02	TOP PLATE	
PA1	1D	*	A64-3227-01	PANEL ASSY	
PA2	1C	*	A64-3249-02	PANEL ASSY	
PME1	2C	*	A10-5123-01	CHASSIS ASSY	
RM1	1C		A70-2040-05	REMOTE CONTROLLER ASSY (RC-505)	
-			B46-0100-50	WARRANTY CARD	
-			B46-0606-04	ID CARD	
-			B46-0648-13	USER CARD	
-			B64-2741-00	INST. MANUAL (ENGLISH)	
-			B64-2742-00	INST. MANUAL (FRE, SPA)	
208	3C		B03-5016-03	DRESSING PLATE ASSY	
210	1C		B07-3079-01	ESCUTCHEON	
212	3C		B07-3080-02	ESCUTCHEON	
213	1D	*	B10-4514-01	FRONT GLASS	
214	1C	*	B12-1227-04	INDICATOR	
216	1C	*	B19-2248-04	LIGHTING BOARD	
219	1C		B43-1505-04	KENWOOD BADGE	
220	1C		D10-4674-04	LEVER	
222	2C		D10-4716-04	ARM ASSY	
223	3C		D10-4718-04	ARM ASSY	
224	3D		D10-4721-21	SLIDER ASSY	
225	2C		D10-4749-03	LEVER	
226	3D		D10-4750-04	LEVER	
227	3D		D12-0637-03	CAM	
228	2D		D13-2270-04	GEAR	
229	3D		D13-2272-04	GEAR	
230	3C		D13-2273-34	GEAR	
232	3C		D13-2274-24	GEAR	
233	3D		D13-2276-04	GEAR	
234	3D		D13-2277-04	GEAR	
235	3D		D13-2278-04	GEAR	
236	3D		D13-2289-03	RACK (GEAR)	
237	3C		D13-2290-04	GEAR ASSY	
238	3C		D16-0617-15	BELT	
239	3C		D23-0958-04	RETAINER	
242	2D		E30-6311-05	CORD WITH PINPLUG	
243			E30-6216-05	CORD WITH DIN CONNECTOR	
245	3D		E41-0351-05	FLAT CABLE CONNECTOR	
△ DC1	1C		E30-6294-05	DC CORD	
FC1	2D		E39-0565-05	FLAT CABLE	
249	2C		F07-1121-03	COVER	
250	3C		F07-1122-03	COVER	
251	3C		F07-1123-03	COVER	
252	2C		F09-1794-04	SHEET	
253	3C		F09-1798-04	SHEET	
256	2D		F09-1842-04	SHEET	
262	2D		F29-0626-04	INSULATING COVER	
△ F1	2D		F52-0023-05	FUSE (MINI BLADE TYPE : 10A)	
264	2C	*	G01-3162-04	EXTENSION SPRING	

Ref. No.	A d d	N e w	Parts No.	Description	Desti- nation
265	2C		G01-3221-04	EXTENSION SPRING	
266	3C		G01-3189-04	TORSION COIL SPRING	
267	3D		G01-3199-04	TORSION COIL SPRING	
270	2C		G11-3539-04	CUSHION	
272	3D		G11-3559-04	CUSHION	
273	1C		G11-3575-04	CUSHION (KEY)	
-			H10-4854-22	POLYSTYRENE FOAMED FIXTURE	
-			H21-1151-04	PROTECTION SHEET	
-			H25-0329-04	PROTECTION BAG (280X450X0.03)	
-			H25-0337-04	PROTECTION BAG (180X300X0.03)	
-			H54-3030-03	ITEM CARTON CASE	
277	3C		J19-5220-03	HOLDER	
278	1C		J21-9823-03	MOUNTING HARDWARE ASSY	
279	3D		J21-9951-03	MOUNTING HARDWARE ASSY	
280	3D		J21-9954-02	MOUNTING HARDWARE ASSY	
281	2C	*	J21-9996-32	MOUNTING HARDWARE ASSY	
283	3D		J21-9997-03	MOUNTING HARDWARE ASSY	
284	2C		J21-9999-02	MOUNTING HARDWARE ASSY	
285	3C		J31-1055-04	COLLAR	
286	3C		J31-1056-04	COLLAR	
287	3D		J74-1444-14	RIGID PRINTED WIRING BOARD	
FPC1	2D		J84-0153-05	FLEXIBLE PRINTED WIRING BOARD	
FPC2	3D		J84-0156-04	FLEXIBLE PRINTED WIRING BOARD	
293	2C		K24-4007-04	KNOB (OPEN)	
294	1C	*	K24-4106-03	KNOB (ATT)	
295	1C	*	K24-4167-03	KNOB (SRC)	
296	1C	*	K25-1632-02	KNOB (PRESET1-6)	
297	2C	*	K25-1634-03	KNOB (EJECT)	
298	1C	*	K25-1610-03	KNOB (Q, PLAY)	
299	2C	*	K25-1633-02	KNOB (SM/AM, SKIP)	
300	1C	*	K29-7082-03	KNOB ASSY (VOL.)	
302	1C		N99-1723-05	SCREW SET	
303	1C		N99-1734-05	SCREW SET	
A	3D		N09-4448-05	MACHINE SCREW	
B	3C		N09-6073-05	STEPPED SCREW	
C	3D	*	N09-6087-15	MACHINE SCREW	
D	3C		N09-6088-05	STEPPED SCREW	
E	3D	*	N09-6089-15	MACHINE SCREW	
F	2C		N09-6093-05	TAPTITE SCREW	
G	2C		N09-6094-05	MACHINE SCREW	
J	2C		N09-6096-05	MACHINE SCREW	
K	3C		N09-6097-05	MACHINE SCREW	
M	2C		N09-6105-05	STEPPED SCREW	
N	2C		N19-2175-04	FLAT WASHER	
P	3D		N19-2176-04	FLAT WASHER	
Q	2C		N24-3015-60	E TYPE RETAINING RING	
R	3C		N38-2025-46	PAN HEAD MACHIN SCREW	
S	3D		N38-2650-45	PAN HEAD MACHIN SCREW	
T	2D		N67-3005-46	PAN HEAD SEMS SCREW	
U	2D		N83-3005-46	PAN HEAD TAPTITE SCREW	
V	2D		N83-3008-46	PAN HEAD TAPTITE SCREW	
W	3C		N86-2004-45	BINDING HEAD TAPTITE SCREW	

E : Europe K : North America M : Other Areas W : Without Europe

△ Indicates safety critical components.

## PARTS LIST

\* New parts

Parts without **Parts No.** are not supplied.

Les articles non mentionnés dans le **Parts No.** ne sont pas fournis.

Teile ohne **Parts No.** werden nicht geliefert.

**KDC-X879**

Ref. No.	A d d	N e w	Parts No.	Description	Desti- nation
RLED RPH			RK73GB2A102J RK73GB2A104J	CHIP R 1.0K J 1/10W CHIP R 100K J 1/10W	
SW1 SW2-3 SW4			S68-0871-05 S68-0863-05 S68-0864-05	PUSH SWITCH (PANEL MECHA) PUSH SWITCH (PANEL MECHA) PUSH SWITCH (PANEL MECHA)	
PH PM1 PM2	3D 3D	*	T95-0212-05 T42-1076-14 T42-1077-24	OPTO ISOLATOR (PANEL MECHA) MOTOR ASSY MOTOR ASSY	
DME1	2D	*	X92-4880-00	MECHANISM ASSY (DXM-6550V)	
<b>SUB CIRCUIT UNIT (X16-2080-10)</b>					
J1			E59-0833-15	RECTANGULAR PLUG	
CP1			R90-1019-05	MULTI-COMP 100 X2	
IC1			BR24C01AFV-W	MEMORY IC	
<b>SUB CIRCUIT UNIT (X16-2210-10)</b>					
315	3C		E58-0968-05	RECTANGULAR RECEPTACLE	
FPC3	2C		J84-0154-05	FLEXIBLE PRINTED WIRING BOARD	
<b>DISPLAY UNIT (X16-2530-11)</b>					
D14			B30-2233-05	LED (HR 1608)	
C1			CK73GB1C104K	CHIP C 0.10UF K	
C1			CK73GB1H104K	CHIP C 0.10UF K	
C2			C92-0628-05	CHIP-TAN 10UF 10WV	
C4			CK73GB1C104K	CHIP C 0.10UF K	
C4			CK73GB1H104K	CHIP C 0.10UF K	
C5			C92-0628-05	CHIP-TAN 10UF 10WV	
C7			CK73GB0J105K	CHIP C 1.0UF K	
C8-10			CK73GB1C104K	CHIP C 0.10UF K	
C8-10			CK73GB1H104K	CHIP C 0.10UF K	
C11			CK73GB1H103K	CHIP C 0.010UF K	
C12-18			CK73GB1C104K	CHIP C 0.10UF K	
C12-18			CK73GB1H104K	CHIP C 0.10UF K	
C19,20			CK73GB1H103K	CHIP C 0.010UF K	
C21,22			CK73GB1C104K	CHIP C 0.10UF K	
C21,22			CK73GB1H104K	CHIP C 0.10UF K	
C23			CK73FB1A225K	CHIP C 2.2UF K	
C25			CK73FB1A225K	CHIP C 2.2UF K	
C26			C93-1174-05	CERAMIC 0.1UF 100WV	
C27			CK73GB1C104K	CHIP C 0.10UF K	
C27			CK73GB1H104K	CHIP C 0.10UF K	
C28			CK73EB0J106K	CHIP C 10UF K	
C29,30			CK73GB1H332K	CHIP C 3300PF K	
C31			CK73FB1A225K	CHIP C 2.2UF K	
C32-34			CK73FB0J475K	CHIP C 4.7UF K	
C35			C92-0628-05	CHIP-TAN 10UF 10WV	
C36			CK73GB1C104K	CHIP C 0.10UF K	
C36			CK73GB1H104K	CHIP C 0.10UF K	
C200			CK73GB1A224K	CHIP C 0.22UF K	
CN1			E40-9364-05	FLAT CABLE CONNECTOR (28PIN)	
CN2			E41-0166-05	FLAT CABLE CONNECTOR (32PIN)	

Ref. No.	A d d	N e w	Parts No.	Description	Desti- nation
L1,2			L92-0321-05	CHIP FERRITE	
L3			L40-1005-34	SMALL FIXED INDUCTOR	
L3			L40-1005-68	SMALL FIXED INDUCTOR	
L4-8			L92-0332-05	CHIP FERRITE	
L9			L40-1005-34	SMALL FIXED INDUCTOR	
L9			L40-1005-68	SMALL FIXED INDUCTOR	
X1			L78-0868-05	RESONATOR (5.00MHZ)	
CP1			R90-1022-05	MULTI-COMP 470 X2	
CP2			RK74HB1J471J	CHIP-COM 470 J 1/16W	
CP3			R90-1022-05	MULTI-COMP 470 X2	
CP4		*	RK74HB1J223J	CHIP-COM 22K J 1/16W	
CP5,6			RK74HB1J102J	CHIP-COM 1.0K J 1/16W	
CP7			RK74HB1J221J	CHIP-COM 220 J 1/16W	
CP8			R90-1020-05	MULTI-COMP 22K X2	
CP9			RK74HB1J471J	CHIP-COM 470 J 1/16W	
CP10			RK74GA1J102J	CHIP-COM 1.0K J 1/16W	
CP11			RK74HB1J471J	CHIP-COM 470 J 1/16W	
CP12			R90-1022-05	MULTI-COMP 470 X2	
CP13-16			RK74HB1J471J	CHIP-COM 470 J 1/16W	
CP17			RK74HB1J221J	CHIP-COM 220 J 1/16W	
CP18		*	RK74HB1J223J	CHIP-COM 22K J 1/16W	
CP19			RK74HB1J221J	CHIP-COM 220 J 1/16W	
CP20		*	RK74HB1J223J	CHIP-COM 22K J 1/16W	
CP21			RK74HB1J221J	CHIP-COM 220 J 1/16W	
CP22		*	RK74HB1J223J	CHIP-COM 22K J 1/16W	
CP23			RK74HB1J221J	CHIP-COM 220 J 1/16W	
CP24		*	RK74HB1J223J	CHIP-COM 22K J 1/16W	
CP25,26			RK74HB1J102J	CHIP-COM 1.0K J 1/16W	
CP27,28			R90-1021-05	MULTI-COMP 3.3K X2	
CP30		*	RK74HB1J223J	CHIP-COM 22K J 1/16W	
CP31			RK74HB1J473J	CHIP-COM 47K J 1/16W	
CP32			R90-0723-05	MULTI-COMP 47K X2	
CP200			RK74GA1J102J	CHIP-COM 1.0K J 1/16W	
CP300		*	RK74HB1J223J	CHIP-COM 22K J 1/16W	
R1			RK73GB2A471J	CHIP R 470 J 1/10W	
R2			RK73GB2A102J	CHIP R 1.0K J 1/10W	
R3			RK73GB2A4R7J	CHIP R 4.7 J 1/10W	
R4			RK73GB2A223J	CHIP R 22K J 1/10W	
R5			RK73GB2A101J	CHIP R 100 J 1/10W	
R6			RK73GB2A223J	CHIP R 22K J 1/10W	
R7			RK73GB2A102J	CHIP R 1.0K J 1/10W	
R8,9			RK73GB2A223J	CHIP R 22K J 1/10W	
R10			RK73GB2A101J	CHIP R 100 J 1/10W	
R11			RK73GB2A223J	CHIP R 22K J 1/10W	
R12			RK73GB2A102J	CHIP R 1.0K J 1/10W	
R14			RK73GB2A101J	CHIP R 100 J 1/10W	
R16			RK73GB2A102J	CHIP R 1.0K J 1/10W	
R17			RK73GB2A473J	CHIP R 47K J 1/10W	
R18			RK73GB2A393J	CHIP R 39K J 1/10W	
R19,20			RK73GB2A473J	CHIP R 47K J 1/10W	
R21			RK73GB2A103J	CHIP R 10K J 1/10W	
R22			RK73GB2A152J	CHIP R 1.5K J 1/10W	
R23			RK73GB2A222J	CHIP R 2.2K J 1/10W	
R24			RK73GB2A104J	CHIP R 100K J 1/10W	

E : Europe K : North America M : Other Areas W : Without Europe

△ Indicates safety critical components.

## PARTS LIST

\* New parts

Parts without **Parts No.** are not supplied.

Les articles non mentionnés dans le **Parts No.** ne sont pas fournis.

Teile ohne **Parts No.** werden nicht geliefert.

### DISPLAY UNIT (X16-2530-11)

Ref. No.	Add	New	Parts No.	Description	Destination
R25			RK73GB2A220J	CHIP R 22 J 1/10W	
R26,27			RK73GB2A103J	CHIP R 10K J 1/10W	
R28-30			RK73GB2A222J	CHIP R 2.2K J 1/10W	
R31			RK73GB2A101J	CHIP R 100 J 1/10W	
R32			RK73GB2A104J	CHIP R 100K J 1/10W	
R33			RK73GB2A102J	CHIP R 1.0K J 1/10W	
R34			RK73GB2A100J	CHIP R 10 J 1/10W	
R35			RK73GB2A153J	CHIP R 15K J 1/10W	
R36			RK73GB2A103J	CHIP R 10K J 1/10W	
R37,38			RK73GB2A274J	CHIP R 270K J 1/10W	
R39			RK73GB2A223J	CHIP R 22K J 1/10W	
R40			RK73GB2A333J	CHIP R 33K J 1/10W	
R44			RK73GB2A104J	CHIP R 100K J 1/10W	
R45			RK73GB2A181J	CHIP R 180 J 1/10W	
R46			RK73GB2A472J	CHIP R 4.7K J 1/10W	
R47			RK73GB2A331J	CHIP R 330 J 1/10W	
R48			RK73GB2A104J	CHIP R 100K J 1/10W	
R49,50			RK73GB2A101J	CHIP R 100 J 1/10W	
R200	*		RK73EB2E3R3J	CHIP R 3.3 J 1/4W	
R201-203			RK73GB2A473J	CHIP R 47K J 1/10W	
R204			RK73GB2A472J	CHIP R 4.7K J 1/10W	
R206			RK73GB2A223J	CHIP R 22K J 1/10W	
R300			RK73GB2A393J	CHIP R 39K J 1/10W	
D1-5			DA204U	DIODE	
ED1	*		MN19236A	FLUORESCENT INDICATOR TUBE	
IC1	*		703132GJ011-A	MICROCONTROLLER IC	
IC2	*		MX23L3213TG114	ROM IC	
IC4	*		S-816A34AMCT2G	ANALOGUE IC	
IC5	*		S-816A25AMCT2G	ANALOGUE IC	
IC6			TC74HC4050AFT	MOS-IC	
IC7			TC7WT126FU	MOS-IC	
IC8			RS-171	ANALOGUE IC	
IC9	*		TC7WH32FU-F	MOS-IC	
IC10			BA3830F	ANALOGUE IC	
Q1			2SB1188(Q,R)	TRANSISTOR	
Q2			2SB1132	TRANSISTOR	
Q3			2SC2713	TRANSISTOR	
Q4			2SA1163	TRANSISTOR	
Q5,6			2SA1774	TRANSISTOR	
Q7			DTC114EE	DIGITAL TRANSISTOR	
Q8			2SA1774	TRANSISTOR	
Q9			2SC4667	TRANSISTOR	
Q11			UMX2N	TRANSISTOR	
Q200			2SC4617	TRANSISTOR	
<b>SWITCH UNIT (X16-2560-10)</b>					
D1-10			B30-1605-05	LED (2COLOR PG/RED)	
D11-15			B30-1564-05	LED (1608,BLUE)	
D17-22			B30-1564-05	LED (1608,BLUE)	
D24			B30-1566-05	LED (1608,RED)	
C1-5			CK73GB1H103K	CHIP C 0.010UF K	
C7-12			CK73GB1H103K	CHIP C 0.010UF K	
CN1			E41-0419-05	FLAT CABLE CONNECTOR (24PIN)	

Ref. No.	Add	New	Parts No.	Description	Destination
R1,2			RK73FB2B471J	CHIP R 470 J 1/8W	
R3,4			RK73FB2B301J	CHIP R 300 J 1/8W	
R5			RK73FB2B471J	CHIP R 470 J 1/8W	
R6-10			RK73FB2B181J	CHIP R 180 J 1/8W	
R11			RK73GB2A241J	CHIP R 240 J 1/10W	
R12			RK73GB2A332J	CHIP R 3.3K J 1/10W	
R13			RK73GB2A103J	CHIP R 10K J 1/10W	
R14			RK73GB2A332J	CHIP R 3.3K J 1/10W	
R15			RK73GB2A103J	CHIP R 10K J 1/10W	
R16			RK73GB2A222J	CHIP R 2.2K J 1/10W	
R17			RK73GB2A103J	CHIP R 10K J 1/10W	
S1			S70-0901-05	TACT SWITCH	
S2-9	*		S70-0912-05	TACT SWITCH	
S10			S70-0901-05	TACT SWITCH	
S11-20	*		S70-0912-05	TACT SWITCH	
S21			T99-0445-05	ROTARY ENCODER	
D25			DAN222	DIODE	
Q1			DTA114YUA	DIGITAL TRANSISTOR	
Q1			UN5114	DIGITAL TRANSISTOR	
Q2-4			2SD2114K	TRANSISTOR	
<b>CD PLAYER UNIT (X32-5590-00)</b>					
C5			CK73GB1C104K	CHIP C 0.10UF K	
C6			CK73GB1H103K	CHIP C 0.010UF K	
C7			CK73FB1A225K	CHIP C 2.2UF K	
C10-15			CK73GB1C104K	CHIP C 0.10UF K	
C16			CK73FB1A225K	CHIP C 2.2UF K	
C17,18			CK73GB1C104K	CHIP C 0.10UF K	
C19			CK73FB1A225K	CHIP C 2.2UF K	
C20			CK73GB1C104K	CHIP C 0.10UF K	
C21			CK73GB1H102K	CHIP C 1000PF K	
C25-27			CK73GB1C104K	CHIP C 0.10UF K	
C28			CK73FB0J106M	CHIP C 10UF M	
C29			CK73GB1C104K	CHIP C 0.10UF K	
C30			CK73GB1H152K	CHIP C 1500PF K	
C31			CC73GCH1H470J	CHIP C 47PF J	
C33			CK73GB1C104K	CHIP C 0.10UF K	
C34			CC73GCH1H560J	CHIP C 56PF J	
C35			CK73GB1C104K	CHIP C 0.10UF K	
C37			CK73GB1H102K	CHIP C 1000PF K	
C38			CK73GB1H682K	CHIP C 6800PF K	
C39			CK73GB1C104K	CHIP C 0.10UF K	
C41			CK73GB1A334K	CHIP C 0.33UF K	
C42-44			CK73GB1C104K	CHIP C 0.10UF K	
C46			CK73GB1H682K	CHIP C 6800PF K	
C47			CK73GB1C104K	CHIP C 0.10UF K	
C48			CC73GCH1H040C	CHIP C 4.0PF C	
C49			CK73GB1H332K	CHIP C 3300PF K	
C50			CK73GB1C104K	CHIP C 0.10UF K	
C51			CC73GCH1H330J	CHIP C 33PF J	
C52,53			CK73FB1A225K	CHIP C 2.2UF K	
C54,55			CK73GB1H103K	CHIP C 0.010UF K	
C56,57			CK73GB1H331K	CHIP C 330PF K	
C58			CK73GB1H472K	CHIP C 4700PF K	

E : Europe K : North America M : Other Areas W : Without Europe

△ Indicates safety critical components.

## PARTS LIST

\* New parts

Parts without **Parts No.** are not supplied.

Les articles non mentionnés dans le **Parts No.** ne sont pas fournis.

Teile ohne **Parts No.** werden nicht geliefert.

### CD PLAYER UNIT (X32-5590-00)

Ref. No.	A d d	N e w	Parts No.	Description	Desti- nation
C59-63			CK73GB1H152K	CHIP C 1500PF K	
C64			CK73GB1C104K	CHIP C 0.10UF K	
C66,67			CC73GCH1H100D	CHIP C 10PF D	
C68			CK73GB0J105K	CHIP C 1.0UF K	
C69-71			CK73GB1C104K	CHIP C 0.10UF K	
C72			CK73FB1A225K	CHIP C 2.2UF K	
C74			CK73FB0J475K	CHIP C 4.7UF K	
C75			CC73GCH1H221J	CHIP C 220PF J	
C78-80			CC73GCH1H221J	CHIP C 220PF J	
C81-84			CC73GCH1H102J	CHIP C 1000PF J	
C86			CK73GB1A105K	CHIP C 1.0UF K	
C87			CK73FB0J475K	CHIP C 4.7UF K	
C89			CK73GB1H103K	CHIP C 0.010UF K	
C90			CK73GB1H102K	CHIP C 1000PF K	
C91			CC73GCH1H102J	CHIP C 1000PF J	
C92			CK73FB0J475K	CHIP C 4.7UF K	
C93,94			CK73GB1H103K	CHIP C 0.010UF K	
C95,96			CK73GB1C104K	CHIP C 0.10UF K	
C97			CK73GB0J105K	CHIP C 1.0UF K	
C98			CK73FB1A225K	CHIP C 2.2UF K	
C99			CC73GCH1H121J	CHIP C 120PF J	
C100			CC73GCH1H050C	CHIP C 5.0PF C	
C101			CK73GB1H102K	CHIP C 1000PF K	
CN1			E41-2083-05	FLAT CABLE CONNECTOR (24PIN)	
CN2			E41-2068-05	FLAT CABLE CONNECTOR (16PIN)	
CN2			E41-2085-05	FLAT CABLE CONNECTOR (16PIN)	
X1			L77-2863-05	CRYSTAL RESONATOR (16.899M)	
X2			L78-0896-05	RESONATOR (16.00MHZ)	
CP1			RK74GA1J104J	CHIP-COM 100K J 1/16W	
CP2,3			RK74GA1J101J	CHIP-COM 100 J 1/16W	
CP4			RK74GA1J103J	CHIP-COM 10K J 1/16W	
CP5			RK74GA1J102J	CHIP-COM 1.0K J 1/16W	
CP7			RK74GB1J102J	CHIP-COM 1.0K J 1/16W	
CP10			RK74GB1J103J	CHIP-COM 10K J 1/16W	
CP11			RK74GB1J472J	CHIP-COM 4.7K J 1/16W	
CP12			RK74GA1J104J	CHIP-COM 100K J 1/16W	
CP13,14			RK74GB1J104J	CHIP-COM 100K J 1/16W	
CP15			RK74GA1J104J	CHIP-COM 100K J 1/16W	
CP16			RK74GB1J222J	CHIP-COM 2.2K J 1/16W	
CP17			RK74GA1J102J	CHIP-COM 1.0K J 1/16W	
CP18			RK74GA1J104J	CHIP-COM 100K J 1/16W	
CP19,20			RK74GB1J104J	CHIP-COM 100K J 1/16W	
R2			R92-3494-05	CHIP R 5.6 J 1/2W	
R5			RK73GB2A101J	CHIP R 100 J 1/10W	
R6			RK73GH2A223D	CHIP R 22K D 1/10W	
R8			RK73GH2A393D	CHIP R 39K D 1/10W	
R9			RK73GB2A104J	CHIP R 100K J 1/10W	
R10			RK73GB2A101J	CHIP R 100 J 1/10W	
R11,12			RK73GB2A104J	CHIP R 100K J 1/10W	
R13			RK73GB2A102J	CHIP R 1.0K J 1/10W	
R18			RK73GB2A101J	CHIP R 100 J 1/10W	
R21,22			RK73GB2A103J	CHIP R 10K J 1/10W	
R27			RK73GB2A104J	CHIP R 100K J 1/10W	

Ref. No.	A d d	N e w	Parts No.	Description	Desti- nation
R28			RK73GB2A103J	CHIP R 10K J 1/10W	
R29			RK73GB2A102J	CHIP R 1.0K J 1/10W	
R34			RK73GB2A472J	CHIP R 4.7K J 1/10W	
R35			RK73GB2A104J	CHIP R 100K J 1/10W	
R36			RK73FB2B4R7J	CHIP R 4.7 J 1/8W	
R37			RK73GB2A103J	CHIP R 10K J 1/10W	
R40			RK73GB2A274J	CHIP R 270K J 1/10W	
R42			RK73GB2A101J	CHIP R 100 J 1/10W	
R43			RK73GB2A393J	CHIP R 39K J 1/10W	
R44,45			RK73GB2A302J	CHIP R 3.0K J 1/10W	
R46			RK73GB2A105J	CHIP R 1.0M J 1/10W	
R47			RK73GB2A104J	CHIP R 100K J 1/10W	
R48,49			RK73GB2A331J	CHIP R 330 J 1/10W	
R50			RK73GB2A101J	CHIP R 100 J 1/10W	
R51			RK73GB2A392J	CHIP R 3.9K J 1/10W	
R52			RK73GB2A163J	CHIP R 16K J 1/10W	
R53			RK73GB2A123J	CHIP R 12K J 1/10W	
R54			RK73GB2A333J	CHIP R 33K J 1/10W	
R55			RK73GB2A103J	CHIP R 10K J 1/10W	
R56			RK73GB2A123J	CHIP R 12K J 1/10W	
R57,58			RK73GB2A133J	CHIP R 13K J 1/10W	
R59			RK73GB2A472J	CHIP R 4.7K J 1/10W	
R60			RK73GB2A123J	CHIP R 12K J 1/10W	
R61			RK73GB2A183J	CHIP R 18K J 1/10W	
R62			RK73GB2A432J	CHIP R 4.3K J 1/10W	
R63			RK73GB2A133J	CHIP R 13K J 1/10W	
R64			RK73GB2A241J	CHIP R 240 J 1/10W	
R65			RK73GB2A104J	CHIP R 100K J 1/10W	
R68			RK73GB2A104J	CHIP R 100K J 1/10W	
R70			RK73GB2A102J	CHIP R 1.0K J 1/10W	
R71-73			RK73GB2A101J	CHIP R 100 J 1/10W	
R108-110			RK73GH2A392D	CHIP R 3.9K D 1/10W	
R111,112			RK73GH2A562D	CHIP R 5.6K D 1/10W	
R113			RK73GH2A392D	CHIP R 3.9K D 1/10W	
R114			RK73GH2A562D	CHIP R 5.6K D 1/10W	
R115			RK73GH2A392D	CHIP R 3.9K D 1/10W	
R116			RK73GH2A562D	CHIP R 5.6K D 1/10W	
R117			RK73GH2A392D	CHIP R 3.9K D 1/10W	
R118,119			RK73GH2A100D	CHIP R 10 D 1/10W	
R120,121			RK73GH2A392D	CHIP R 3.9K D 1/10W	
R122			RK73GH2A202D	CHIP R 2.0K D 1/10W	
R123			RK73GH2A681D	CHIP R 680 D 1/10W	
R124			RK73GB2A680J	CHIP R 68 J 1/10W	
R128,129			RK73GB2A101J	CHIP R 100 J 1/10W	
R130			RK73GB2A221J	CHIP R 220 J 1/10W	
R132,133			RK73GB2A102J	CHIP R 1.0K J 1/10W	
R134			RK73GH2A202D	CHIP R 2.0K D 1/10W	
R135			RK73GH2A681D	CHIP R 680 D 1/10W	
R136			RK73EB2E220J	CHIP R 22 J 1/4W	
R137			RK73GB2A680J	CHIP R 68 J 1/10W	
R138			RK73GB2A470J	CHIP R 47 J 1/10W	
R139-141			RK73GH2A151D	CHIP R 150 D 1/10W	
R142			RK73GB2A2R2J	CHIP R 2.2 J 1/10W	
R143			RK73GB2A104J	CHIP R 100K J 1/10W	
R144			RK73GB2A103J	CHIP R 10K J 1/10W	

E : Europe K : North America M : Other Areas W : Without Europe

△ Indicates safety critical components.

## PARTS LIST

\* New parts

Parts without **Parts No.** are not supplied.

Les articles non mentionnés dans le **Parts No.** ne sont pas fournis.

Teile ohne **Parts No.** werden nicht geliefert.

### CD PLAYER UNIT (X32-5590-00)

Ref. No.	Add	New	Parts No.	Description	Destination	Ref. No.	Add	New	Parts No.	Description	Destination
R145			RK73GH2A330D	CHIP R 33 D 1/10W		C31			C90-2962-05	ELECTRO 100UF 16WV	
R146,147			RK73GB2A101J	CHIP R 100 J 1/10W		C32-35			CK73EB1C225K	CHIP C 2.2UF K	
R148			RK73GB2A562J	CHIP R 5.6K J 1/10W		C36			C94-0040-05	ELECTRO 22UF 16WV	
R149			RK73GB2A104J	CHIP R 100K J 1/10W		C37			CK73GB1E223K	CHIP C 0.022UF K	
R151			RK73GB2A104J	CHIP R 100K J 1/10W		C37			CK73GB1H223K	CHIP C 0.022UF K	
R152			RK73GB2A472J	CHIP R 4.7K J 1/10W		C38			CK73GB1H103K	CHIP C 0.010UF K	
W10			R92-1252-05	CHIP R 0 OHM J 1/16W		C39,40			CK73EB1C225K	CHIP C 2.2UF K	
S1,2			S68-0863-05	PUSH SWITCH		C41			CK73GB1H103K	CHIP C 0.010UF K	
S3			S68-0862-05	PUSH SWITCH		C42			CK73GB1E223K	CHIP C 0.022UF K	
D2			DA204U	DIODE		C42			CK73GB1H223K	CHIP C 0.022UF K	
D3			DAN202U	DIODE		C43			CK73FB1C105K	CHIP C 1.0UF K	
D4,5			MAZS0510L	ZENER DIODE		C44,45			CK73GB1H103K	CHIP C 0.010UF K	
IC1			91CW12AFG-4VF6	MICROCONTROLLER IC		C46			CK73GB1H102K	CHIP C 1000PF K	
IC2			UPD63712GC	MOS-IC		C47			CK73FB1C105K	CHIP C 1.0UF K	
IC3			TC94A20F-010	MOS-IC		C48			CK73GB1H103K	CHIP C 0.010UF K	
IC4			BA5824FP	ANALOGUE IC		C100	*		C90-5626-05	ELECTRO 3900UF 16WV	
IC5			NJM2880U133	ANALOGUE IC		C101			C94-0032-05	ELECTRO 47UF 6.3WV	
IC5			NJM2880U33	ANALOGUE IC		C102			CC73GCH1H220J	CHIP C 22PF J	
IC10			PCM1793DB	MOS-IC		C103			CC73GCH1H270J	CHIP C 27PF J	
IC10			PCM1793DB	MOS-IC		C104			CK73GB0J105K	CHIP C 1.0UF K	
IC13			NJM4580V-LF	ANALOGUE IC		C106			CK73GB0J105K	CHIP C 1.0UF K	
IC14			TAR5S50-F	ANALOGUE IC		C107			CK73GB1H103K	CHIP C 0.010UF K	
IC15			NJM2890R3325	ANALOGUE IC		C109			CK73GB1H102K	CHIP C 1000PF K	
Q1			2SK3018	FET		C110,111			CK73GB1H103K	CHIP C 0.010UF K	
Q3			UMD9N	TRANSISTOR		C199			CK73GB1C104K	CHIP C 0.10UF K	
Q4			2SK3018	FET		C199			CK73GB1H104K	CHIP C 0.10UF K	
Q5			UMD9N	TRANSISTOR		C201,202			C94-0161-05	ELECTRO 0.47UF 50WV	
Q6			UMD12N	TRANSISTOR		C203,204			CK73FB1C474K	CHIP C 0.47UF K	
Q7			DTC124EUA	DIGITAL TRANSISTOR		C205,206			C94-0032-05	ELECTRO 47UF 6.3WV	
Q8			2SB0970	TRANSISTOR		C207,208			CK73FB1C474K	CHIP C 0.47UF K	
Q9,10			DTC114YUA	DIGITAL TRANSISTOR		C209			CK73GB1E223K	CHIP C 0.022UF K	
Q11,12			2SB0970	TRANSISTOR		C209			CK73GB1H223K	CHIP C 0.022UF K	
<b>ELECTRIC UNIT (X34-3030-11)</b>						C210			CK73GB1H103K	CHIP C 0.010UF K	
C2			CK73GB1H103K	CHIP C 0.010UF K		C211			CK73GB1A474K	CHIP C 0.47UF K	
C3		*	C90-5619-05	ELECTRO 220UF 16WV		C212			CC73GCH1H151J	CHIP C 150PF J	
C4			CK73GB1H103K	CHIP C 0.010UF K		C213			CK73GB1C104K	CHIP C 0.10UF K	
C5			C94-0039-05	ELECTRO 10UF 16WV		C213			CK73GB1H104K	CHIP C 0.10UF K	
C6			C94-0033-05	ELECTRO 100UF 6.3WV		C214			CK73GB1H103K	CHIP C 0.010UF K	
C7			CK73FB1C105K	CHIP C 1.0UF K		C215			C94-0042-05	ELECTRO 47UF 16WV	
C8		*	C94-0188-05	ELECTRO 220UF 10WV		C216-223			CK73FB1C105K	CHIP C 1.0UF K	
C9		*	C94-0186-05	ELECTRO 100UF 10WV		C224			CK73GB1C104K	CHIP C 0.10UF K	
C10			CE32AZ1E221M	CHIP EL 220UF 25WV		C224			CK73GB1H104K	CHIP C 0.10UF K	
C11			CK73GB1H332K	CHIP C 3300PF K		C225			CK73GB1H103K	CHIP C 0.010UF K	
C12			CE32AZ1C221M	CHIP EL 220UF 16WV		C226-231			CK73GB1E473K	CHIP C 0.047UF K	
C13			CK73GB0J105K	CHIP C 1.0UF K		C226-231			CK73GB1H473K	CHIP C 0.047UF K	
C14			CK73EB1C225K	CHIP C 2.2UF K		C232			CK73FB1C105K	CHIP C 1.0UF K	
C15			CK73GB1H103K	CHIP C 0.010UF K		C233			C92-0667-05	ELECTRO 10UF 10WV	
C16			CE32AZ1C101M	CHIP EL 100UF 16WV		C234			CK73GB1E333K	CHIP C 0.033UF K	
C17			CK73GB1H103K	CHIP C 0.010UF K		C234			CK73GB1H333K	CHIP C 0.033UF K	
C18			CE32AZ1C101M	CHIP EL 100UF 16WV		C235			CK73GB1H103K	CHIP C 0.010UF K	
C21			CK73FB1A225K	CHIP C 2.2UF K		C236			CK73GB1A334K	CHIP C 0.33UF K	
C22			C93-1218-05	CHIP C 0.010UF K		C237			CK73GB1A474K	CHIP C 0.47UF K	
C23			C90-5375-05	ELECTRO 33UF 63WV		C238			CC73GCH1H221J	CHIP C 220PF J	
C30			C94-0044-05	ELECTRO 4.7UF 25WV		C239			CK73GB1H103K	CHIP C 0.010UF K	
						C240,241			C92-0667-05	ELECTRO 10UF 10WV	

E : Europe K : North America M : Other Areas W : Without Europe

△ Indicates safety critical components.

## PARTS LIST

\* New parts

Parts without **Parts No.** are not supplied.

Les articles non mentionnés dans le **Parts No.** ne sont pas fournis.

Teile ohne **Parts No.** werden nicht geliefert.

### ELECTRIC UNIT (X34-3030-11)

Ref. No.	A d d	N e w	Parts No.	Description	Desti- nation
C250			CE32AT1H2R2M	CHIP EL 2.2UF 50WV	
C251			CK73FB1C334K	CHIP C 0.33UF K	
C252			CK73GB1A334K	CHIP C 0.33UF K	
C253			CK73FB1C334K	CHIP C 0.33UF K	
C254			CK73GB1A334K	CHIP C 0.33UF K	
C255			CK73FB1C334K	CHIP C 0.33UF K	
C256			CK73GB1A334K	CHIP C 0.33UF K	
C257			CK73FB1C334K	CHIP C 0.33UF K	
C258			CK73GB1A334K	CHIP C 0.33UF K	
C259			CE32AT1H010M	CHIP EL 1.0UF 50WV	
C260-263			CK73GB1C104K	CHIP C 0.10UF K	
C260-263			CK73GB1H104K	CHIP C 0.10UF K	
C264,265			C94-0040-05	ELECTRO 22UF 16WV	
C266,267			C94-0039-05	ELECTRO 10UF 16WV	
C268,269			C94-0040-05	ELECTRO 22UF 16WV	
C270,271			C94-0039-05	ELECTRO 10UF 16WV	
C272-275			C94-0179-05	ELECTRO 0.22UF 50WV	
C276			CK73FB1C105K	CHIP C 1.0UF K	
C277			C94-0041-05	ELECTRO 33UF 16WV	
C278			C90-5663-05	ELECTRO 1UF 50WV	
C279			C94-0051-05	ELECTRO 1UF 50WV	
C280-285			CK73GB1H222K	CHIP C 2200PF K	
C286			CK73GB1H103K	CHIP C 0.010UF K	
C287-289			CK73FB1H104K	CHIP C 0.10UF K	
C290,291			CK73GB1H103K	CHIP C 0.010UF K	
C292-296			CK73EB1A475K	CHIP C 4.7UF K	
C297,298			C92-0672-05	ELECTRO 22UF 16WV	
C299,300			C94-0039-05	ELECTRO 10UF 16WV	
C303-305			CK73GB1H103K	CHIP C 0.010UF K	
C307			CK73GB1H103K	CHIP C 0.010UF K	
C309,310			CC73GCH1H100D	CHIP C 10PF D	
C311			CC73GCH1H331J	CHIP C 330PF J	
C312			CK73FB1A225K	CHIP C 2.2UF K	
C313			CK73GB1H103K	CHIP C 0.010UF K	
C314			C94-0039-05	ELECTRO 10UF 16WV	
C316-319			CK73GB1A224K	CHIP C 0.22UF K	
C502-504			CK73GB1H103K	CHIP C 0.010UF K	
C601,602			CK73GB1C104K	CHIP C 0.10UF K	
C601,602			CK73GB1H104K	CHIP C 0.10UF K	
C603			CK73GB1H103K	CHIP C 0.010UF K	
C701			CK73GB1A474K	CHIP C 0.47UF K	
CN1			E41-0224-05	PIN ASSY (12PIN)	
CN2			E40-3237-05	PIN ASSY (2PIN)	
CN3			E41-0384-05	PIN ASSY (16PIN)	
CN4			E40-9527-05	FLAT CABLE CONNECTOR (24PIN)	
CN4			E41-0213-05	FLAT CABLE CONNECTOR (24PIN)	
CN5			E40-9368-05	FLAT CABLE CONNECTOR (28PIN)	
CN6			E41-0399-05	FLAT CABLE CONNECTOR (15PIN)	
CN7			E41-0009-05	PIN ASSY (2PIN)	
J1			E58-0863-15	RECTANGULAR RECEPTACLE (16PIN)	
P1			E23-0745-05	TERMINAL	
W2			E30-6218-05	CORD WITH PLUG (ANT)	
L1			L33-1170-05	CHOKE COIL ASSY	

Ref. No.	A d d	N e w	Parts No.	Description	Desti- nation
L2			L33-1126-05	CHOKE COIL	
L3			L33-1029-05	SMALL FIXED INDUCTOR	
L4			L40-2205-34	SMALL FIXED INDUCTOR (22UH)	
L7			L33-1039-05	LINE FILTER COIL	
L101			L40-4795-34	SMALL FIXED INDUCTOR	
L101			L40-4795-68	SMALL FIXED INDUCTOR (4.7UH)	
L102			L92-0075-05	CHIP FERRITE	
L201			L40-4795-34	SMALL FIXED INDUCTOR	
L201			L40-4795-68	SMALL FIXED INDUCTOR (4.7UH)	
L303-307			L40-4795-34	SMALL FIXED INDUCTOR	
L303-307			L40-4795-68	SMALL FIXED INDUCTOR (4.7UH)	
X1			L78-0821-05	RESONATOR (20MHz)	
X2			L77-2738-05	CRYSTAL RESONATOR (32.768KHz)	
X3			L77-2002-05	CRYSTAL RESONATOR (4.332MHz)	
U	2D		N83-3005-46	PAN HEAD TAPTITE SCREW	
X	2D		N80-3008-46	PAN HEAD TAPTITE SCREW	
Y	2D		N83-3010-46	PAN HEAD TAPTITE SCREW	
Z	2D		N84-2004-46	PAN HEAD TAPTITE SCREW	
R1			RK73FB2B223J	CHIP R 22K J 1/8W	
R2			RK73GB2A101J	CHIP R 100 J 1/10W	
R3			RK73GB2A223J	CHIP R 22K J 1/10W	
R4			RK73GB2A222J	CHIP R 2.2K J 1/10W	
R5			RK73FB2B221J	CHIP R 220 J 1/8W	
R6			RK73GB2A153J	CHIP R 15K J 1/10W	
R7			R92-3032-05	CHIP R 4.3K D 1/10W	
R8			R92-3047-05	CHIP R 24K D 1/10W	
R9			RK73FB2B152J	CHIP R 1.5K J 1/8W	
R10			R92-3022-05	METAL R 750 D 1/10W	
R11			R92-3028-05	CHIP R 2.2K D 1/10W	
R12			RK73GB2A103J	CHIP R 10K J 1/10W	
R13			R92-2104-05	CHIP R 2.2 J 1W	
R14			RK73FB2B751J	CHIP R 750 J 1/8W	
R15			RK73GB2A473J	CHIP R 47K J 1/10W	
R16			RK73FB2B103J	CHIP R 10K J 1/8W	
R17			RK73GB2A102J	CHIP R 1.0K J 1/10W	
R18			RK73GB2A750J	CHIP R 75 J 1/10W	
R19			RK73GB2A272J	CHIP R 2.7K J 1/10W	
R20			RK73GB2A470J	CHIP R 47 J 1/10W	
R21			RK73GB2A752J	CHIP R 7.5K J 1/10W	
R22			RK73GB2A274J	CHIP R 270K J 1/10W	
R23			RK73GB2A563J	CHIP R 56K J 1/10W	
R24			RK73GB2A470J	CHIP R 47 J 1/10W	
R25			RK73GB2A103J	CHIP R 10K J 1/10W	
R26,27			RK73GB2A913J	CHIP R 91K J 1/10W	
R28			RK73FB2B472J	CHIP R 4.7K J 1/8W	
R29			RD14DB2H102J	SMALL-RD 1.0K J 1/2W	
R30			RK73GB2A223J	CHIP R 22K J 1/10W	
R31			RK73FB2B472J	CHIP R 4.7K J 1/8W	
R32			RK73FB2B561J	CHIP R 560 J 1/8W	
R33			RK73GB2A473J	CHIP R 47K J 1/10W	
R34			RK73GB2A223J	CHIP R 22K J 1/10W	
R35			RK73GB2A104J	CHIP R 100K J 1/10W	
R36			RK73FB2B103J	CHIP R 10K J 1/8W	
R37			RK73GB2A103J	CHIP R 10K J 1/10W	

E : Europe K : North America M : Other Areas W : Without Europe

△ Indicates safety critical components.

## PARTS LIST

\* New parts

Parts without **Parts No.** are not supplied.

Les articles non mentionnés dans le **Parts No.** ne sont pas fournis.

Teile ohne **Parts No.** werden nicht geliefert.

### ELECTRIC UNIT (X34-3030-11)

Ref. No.	Add	New	Parts No.	Description	Destination	Ref. No.	Add	New	Parts No.	Description	Destination
R38			RK73GB2A822J	CHIP R 8.2K J 1/10W		R186			RK73GB2A102J	CHIP R 1.0K J 1/10W	
R41			RK73GB2A223J	CHIP R 22K J 1/10W		R201			RK73GB2A103J	CHIP R 10K J 1/10W	
R42			RD14DB2H332J	SMALL-RD 3.3K J 1/2W		R202-204			RK73GB2A472J	CHIP R 4.7K J 1/10W	
R43			RK73EB2E473J	CHIP R 47K J 1/4W		R205			RK73GB2A134J	CHIP R 130K J 1/10W	
R44			RK73GB2A183J	CHIP R 18K J 1/10W		R206			RK73GB2A823J	CHIP R 82K J 1/10W	
R45			RK73GB2A104J	CHIP R 100K J 1/10W		R207			RK73GB2A473J	CHIP R 47K J 1/10W	
R46,47			RK73EB2E103J	CHIP R 10K J 1/4W		R208			RK73GB2A912J	CHIP R 9.1K J 1/10W	
R48			RK73EB2E102J	CHIP R 1.0K J 1/4W		R209			RK73GB2A363J	CHIP R 36K J 1/10W	
R49			RD14DB2H102J	SMALL-RD 1.0K J 1/2W		R210			RK73GB2A622J	CHIP R 6.2K J 1/10W	
R101			RK73GB2A103J	CHIP R 10K J 1/10W		R217			RK73GB2A682J	CHIP R 6.8K J 1/10W	
R102			RK73GB2A153J	CHIP R 15K J 1/10W		R218			RK73GB2A332J	CHIP R 3.3K J 1/10W	
R103			RK73GB2A104J	CHIP R 100K J 1/10W		R219			RK73GB2A392J	CHIP R 3.9K J 1/10W	
R106,107			RK73GB2A103J	CHIP R 10K J 1/10W		R220,221			RK73FB2B361J	CHIP R 360 J 1/8W	
R110			RK73GB2A104J	CHIP R 100K J 1/10W		R222,223			RK73FB2B222J	CHIP R 2.2K J 1/8W	
R111,112			RK73GB2A103J	CHIP R 10K J 1/10W		R224,225			RK73FB2B103J	CHIP R 10K J 1/8W	
R115,116			RK73GB2A102J	CHIP R 1.0K J 1/10W		R226,227			RK73FB2B223J	CHIP R 22K J 1/8W	
R117			RK73GB2A103J	CHIP R 10K J 1/10W		R228,229			RK73FB2B820J	CHIP R 82 J 1/8W	
R118-120			RK73GB2A102J	CHIP R 1.0K J 1/10W		R232,233			RK73FB2B361J	CHIP R 360 J 1/8W	
R121			RK73GB2A222J	CHIP R 2.2K J 1/10W		R234,235			RK73FB2B222J	CHIP R 2.2K J 1/8W	
R122-126			RK73GB2A101J	CHIP R 100 J 1/10W		R236,237			RK73FB2B103J	CHIP R 10K J 1/8W	
R127			RK73GB2A102J	CHIP R 1.0K J 1/10W		R238,239			RK73FB2B223J	CHIP R 22K J 1/8W	
R128			RK73GB2A104J	CHIP R 100K J 1/10W		R240,241			RK73FB2B820J	CHIP R 82 J 1/8W	
R129			RK73GB2A102J	CHIP R 1.0K J 1/10W		R244,245			RK73FB2B361J	CHIP R 360 J 1/8W	
R130			RK73GB2A104J	CHIP R 100K J 1/10W		R246,247			RK73FB2B222J	CHIP R 2.2K J 1/8W	
R131			RK73GB2A102J	CHIP R 1.0K J 1/10W		R248,249			RK73FB2B103J	CHIP R 10K J 1/8W	
R132			RK73GB2A104J	CHIP R 100K J 1/10W		R250,251			RK73FB2B223J	CHIP R 22K J 1/8W	
R133-136			RK73GB2A222J	CHIP R 2.2K J 1/10W		R252,253			RK73FB2B820J	CHIP R 82 J 1/8W	
R137			RK73GB2A102J	CHIP R 1.0K J 1/10W		R256			RK73GB2A221J	CHIP R 220 J 1/10W	
R138-140			RK73GB2A222J	CHIP R 2.2K J 1/10W		R257			RK73GB2A223J	CHIP R 22K J 1/10W	
R141			RK73GB2A102J	CHIP R 1.0K J 1/10W		R259			RK73GB2A432J	CHIP R 4.3K J 1/10W	
R142,143			RK73GB2A222J	CHIP R 2.2K J 1/10W		R260			RK73GB2A100J	CHIP R 10 J 1/10W	
R144			RK73GB2A102J	CHIP R 1.0K J 1/10W		R261			RK73GB2A752J	CHIP R 7.5K J 1/10W	
R145,146			RK73GB2A473J	CHIP R 47K J 1/10W		R262			RK73EB2E4R7J	CHIP R 4.7 J 1/4W	
R150,151			RK73GB2A104J	CHIP R 100K J 1/10W		R263,264			RK73EB2E100J	CHIP R 10 J 1/4W	
R152,153			RK73GB2A222J	CHIP R 2.2K J 1/10W		R265,266			RK73GB2A102J	CHIP R 1.0K J 1/10W	
R156			RK73GB2A104J	CHIP R 100K J 1/10W		R267			RK73EB2E100J	CHIP R 10 J 1/4W	
R158			RK73GB2A104J	CHIP R 100K J 1/10W		R268			RK73EB2E4R7J	CHIP R 4.7 J 1/4W	
R159,160			RK73GB2A471J	CHIP R 470 J 1/10W		R269			RK73EB2E100J	CHIP R 10 J 1/4W	
R161			RK73GB2A104J	CHIP R 100K J 1/10W		R270			RK73GB2A473J	CHIP R 47K J 1/10W	
R162			RK73GB2A103J	CHIP R 10K J 1/10W		R271			RK73GB2A821J	CHIP R 820 J 1/10W	
R163,164			RK73GB2A471J	CHIP R 470 J 1/10W		R272,273			RK73GB2A103J	CHIP R 10K J 1/10W	
R165,166			RK73GB2A472J	CHIP R 4.7K J 1/10W		R274			RK73GB2A104J	CHIP R 100K J 1/10W	
R167			RK73GB2A102J	CHIP R 1.0K J 1/10W		R275			RK73GB2A473J	CHIP R 47K J 1/10W	
R169			RK73GB2A102J	CHIP R 1.0K J 1/10W		R276			RK73GB2A102J	CHIP R 1.0K J 1/10W	
R170			RK73GB2A222J	CHIP R 2.2K J 1/10W		R277			RK73GB2A473J	CHIP R 47K J 1/10W	
R171,172			RK73GB2A471J	CHIP R 470 J 1/10W		R278			RK73GB2A333J	CHIP R 33K J 1/10W	
R173,174			RK73GB2A472J	CHIP R 4.7K J 1/10W		R279,280			RK73GB2A334J	CHIP R 330K J 1/10W	
R175			RK73GB2A333J	CHIP R 33K J 1/10W		R303			RK73FB2B102J	CHIP R 1.0K J 1/8W	
R176			RK73GB2A473J	CHIP R 47K J 1/10W		R304			RK73GB2A223J	CHIP R 22K J 1/10W	
R177			RK73GB2A222J	CHIP R 2.2K J 1/10W		R305			RK73GB2A472J	CHIP R 4.7K J 1/10W	
R178,179			RK73GB2A103J	CHIP R 10K J 1/10W		R306-308			RK73GB2A222J	CHIP R 2.2K J 1/10W	
R180			RK73GB2A222J	CHIP R 2.2K J 1/10W		R501,502			RK73EB2E101J	CHIP R 100 J 1/4W	
R181			RK73GB2A473J	CHIP R 47K J 1/10W		R503-507			RK73EB2E472J	CHIP R 4.7K J 1/4W	
R182			RK73GB2A104J	CHIP R 100K J 1/10W		R508			RK73EB2E101J	CHIP R 100 J 1/4W	
R183,184			RK73GB2A222J	CHIP R 2.2K J 1/10W		R509-511			RK73EB2E471J	CHIP R 470 J 1/4W	

E : Europe K : North America M : Other Areas W : Without Europe

△ Indicates safety critical components.

## PARTS LIST

\* New parts

Parts without **Parts No.** are not supplied.

Les articles non mentionnés dans le **Parts No.** ne sont pas fournis.

Teile ohne **Parts No.** werden nicht geliefert.

### ELECTRIC UNIT (X34-3030-11)

Ref. No.	A d d	N e w	Parts No.	Description	Desti- nation
R512			RK73EB2E102J	CHIP R 1.0K J 1/4W	
R513			RK73GB2A223J	CHIP R 22K J 1/10W	
R514			RK73GB2A392J	CHIP R 3.9K J 1/10W	
R515,516			RK73GB2A472J	CHIP R 4.7K J 1/10W	
R517,518			RK73EB2E101J	CHIP R 100 J 1/4W	
R519			RK73EB2E471J	CHIP R 470 J 1/4W	
R520			RK73EB2E472J	CHIP R 4.7K J 1/4W	
R522-524			RK73GB2A222J	CHIP R 2.2K J 1/10W	
R525			RK73GB2A102J	CHIP R 1.0K J 1/10W	
R526,527			RK73GB2A473J	CHIP R 47K J 1/10W	
R601,602			RK73GB2A104J	CHIP R 100K J 1/10W	
R603			RK73GB2A222J	CHIP R 2.2K J 1/10W	
R604,605			RK73GB2A103J	CHIP R 10K J 1/10W	
R606			RK73GB2A222J	CHIP R 2.2K J 1/10W	
R607			RK73GB2A911J	CHIP R 910 J 1/10W	
R608,609			RK73GB2A104J	CHIP R 100K J 1/10W	
R610			RK73GB2A222J	CHIP R 2.2K J 1/10W	
R611,612			RK73GB2A103J	CHIP R 10K J 1/10W	
R613			RK73GB2A222J	CHIP R 2.2K J 1/10W	
R614			RK73GB2A911J	CHIP R 910 J 1/10W	
R615-618			RK73GB2A102J	CHIP R 1.0K J 1/10W	
R620			RK73EB2E102J	CHIP R 1.0K J 1/4W	
R621			RK73GB2A472J	CHIP R 4.7K J 1/10W	
R623,624			RK73GB2A332J	CHIP R 3.3K J 1/10W	
R625,626			RK73GB2A102J	CHIP R 1.0K J 1/10W	
R701			RK73GB2A104J	CHIP R 100K J 1/10W	
D1			1N5393G-M5	DIODE	
D2			RB160L-40	DIODE	
D3			MA8056-M	ZENER DIODE	
D4			MA8082-L	ZENER DIODE	
D5			SFPB-54V	DIODE	
D6			MA8100-L	ZENER DIODE	
D7			MA4062(N)-L	ZENER DIODE	
D8			MA8110-M	ZENER DIODE	
D9			MA8056-M	ZENER DIODE	
D16			MA3056-M	ZENER DIODE	
D17			MA3047-M	ZENER DIODE	
D18			MA8068-M	ZENER DIODE	
D19			MA8062-M	ZENER DIODE	
D20,21			DAP202U	DIODE	
D20,21		*	LM1MA142WA-G	DIODE	
D20,21			MA142WA	DIODE	
D101			DAP202U	DIODE	
D101		*	LM1MA142WA-G	DIODE	
D101			MA142WA	DIODE	
D201,202			RD6.8M(B2)	ZENER DIODE	
D203			RD6.8MW	ZENER DIODE	
D204,205			RD6.8M(B2)	ZENER DIODE	
D206			RD6.8MW	ZENER DIODE	
D207,208			DAP202U	DIODE	
D207,208		*	LM1MA142WA-G	DIODE	
D207,208			MA142WA	DIODE	
D209-216			S1J	DIODE	
D209-216			1SR154-400	DIODE	

Ref. No.	A d d	N e w	Parts No.	Description	Desti- nation
D217			DA204K	DIODE	
D301			IMSA-6801	SURGE ABSORBER	
D503-505			MA3062WA	ZENER DIODE	
D506-509			DA204K	DIODE	
D601			DA204K	DIODE	
IC1		*	UPD703030GC041	MICROCONTROLLER IC	
IC2			TDA7411	ANALOGUE IC	
IC3			M5237ML	ANALOGUE IC	
IC4			TDA7560	ANALOGUE IC	
IC5			TDA7401	ANALOGUE IC	
IC6			NJM2195FJ1	ANALOGUE IC	
IC7			ICL7660SIBA	ANALOGUE IC	
IC8			S-80837CNNB	MOS-IC	
IC9			TC74HC02AF	MOS-IC	
IC10-13			NJM4565M-TE2	ANALOGUE IC	
IC14			TDA7479D	ANALOGUE IC	
IC15,16			LB1930M	ANALOGUE IC	
IC18			L9820D013TR	ANALOGUE IC	
IC19			LM2672M-ADJ	ANALOGUE IC	
IC20			TC7W66FK	MOS-IC	
Q1			2SA2057	TRANSISTOR	
Q2			2SC4081	TRANSISTOR	
Q3			2SA1576A	TRANSISTOR	
Q4			DTA124EUA	DIGITAL TRANSISTOR	
Q4			UN5112	DIGITAL TRANSISTOR	
Q5			DTC124EUA	DIGITAL TRANSISTOR	
Q5			UN5212	DIGITAL TRANSISTOR	
Q6			DTC144EUA	DIGITAL TRANSISTOR	
Q6			UN5213	DIGITAL TRANSISTOR	
Q7			DTA124EUA	DIGITAL TRANSISTOR	
Q7			UN5112	DIGITAL TRANSISTOR	
Q8,9			2SA2057	TRANSISTOR	
Q11			DTC124EUA	DIGITAL TRANSISTOR	
Q11			UN5212	DIGITAL TRANSISTOR	
Q12			DTA124EUA	DIGITAL TRANSISTOR	
Q12			UN5112	DIGITAL TRANSISTOR	
Q13			2SA2057	TRANSISTOR	
Q14			2SC4081	TRANSISTOR	
Q15			2SB1443	TRANSISTOR	
Q16,17			2SC4081	TRANSISTOR	
Q18,19			2SA1576A	TRANSISTOR	
Q20			2SC4081	TRANSISTOR	
Q21			2SA1576A	TRANSISTOR	
Q22			2SC4081	TRANSISTOR	
Q23			DTC114YUA	DIGITAL TRANSISTOR	
Q23			UN5214	DIGITAL TRANSISTOR	
Q24			2SB1240	TRANSISTOR	
Q25			DTA123JK	DIGITAL TRANSISTOR	
Q25			KRA105S	DIGITAL TRANSISTOR	
Q26			DTC144EUA	DIGITAL TRANSISTOR	
Q26			UN5213	DIGITAL TRANSISTOR	
Q27			2SC4081	TRANSISTOR	
Q29			2SC4081	TRANSISTOR	
Q30,31			DTA124EUA	DIGITAL TRANSISTOR	
Q30,31			UN5112	DIGITAL TRANSISTOR	

E : Europe K : North America M : Other Areas W : Without Europe

△ Indicates safety critical components.

## PARTS LIST

\* New parts

Parts without **Parts No.** are not supplied.

Les articles non mentionnés dans le **Parts No.** ne sont pas fournis.

Teile ohne **Parts No.** werden nicht geliefert.

### ELECTRIC UNIT (X34-3030-11)

Ref. No.	A d d	N e w	Parts No.	Description	Desti- nation
Q201			DTC143TUA	DIGITAL TRANSISTOR	
Q201			UN5216	DIGITAL TRANSISTOR	
Q202			DTC124EUA	DIGITAL TRANSISTOR	
Q202			UN5212	DIGITAL TRANSISTOR	
Q203-208			DTC143TUA	DIGITAL TRANSISTOR	
Q203-208			UN5216	DIGITAL TRANSISTOR	
Q210			2SC4081	TRANSISTOR	
Q303			DTC124EUA	DIGITAL TRANSISTOR	
Q303			UN5212	DIGITAL TRANSISTOR	
Q304			2SB1188(Q,R)	TRANSISTOR	
Q305			DTC143TUA	DIGITAL TRANSISTOR	
Q305			UN5216	DIGITAL TRANSISTOR	
Q501			DTA124EUA	DIGITAL TRANSISTOR	
Q501			UN5112	DIGITAL TRANSISTOR	
Q502			2SB1427	TRANSISTOR	
Q503			DTC124EUA	DIGITAL TRANSISTOR	
Q503			UN5212	DIGITAL TRANSISTOR	
Q601			DTC124EUA	DIGITAL TRANSISTOR	
Q601			UN5212	DIGITAL TRANSISTOR	
Q602			2SC4081	TRANSISTOR	
Q603			DTC124EUA	DIGITAL TRANSISTOR	
Q603			UN5212	DIGITAL TRANSISTOR	
TH1			PTH9C42BD471Q	POSITIVE RESISTOR	
A2			W02-3430-05	ELECTRIC CIRCUIT MODULE	
A1			X86-3730-11	FRONT-END UNIT	
<b>CD MECHANISM ASSY (X92-4880-00)</b>					
2	1B	*	A10-4884-02	CHASSIS	
5	1B	*	D10-4610-03	ARM ASSY	
8	2A	*	D10-4608-03	LEVER ASSY	
10	3A	*	D10-4602-03	ARM	
11	2A	*	D10-4603-03	ARM	
12	3A	*	D10-4604-03	ARM	
13	3A	*	D10-4605-03	ARM	
14	3B	*	D10-4613-03	ARM	
15	2A	*	D10-4615-03	SLIDER	
16	3B	*	D10-4617-02	SLIDER	
17	3B	*	D10-4618-03	SLIDER	
18	3B	*	D10-4614-04	ARM	
19	3B	*	D10-4606-04	ARM	
22	2A	*	D13-2174-04	GEAR	
23	2B	*	D13-2180-04	GEAR	
24	3B	*	D13-2181-04	GEAR	
25	3B	*	D13-2182-04	GEAR	
26	3B	*	D13-2175-04	WORM	
27	3B	*	D13-2176-04	GEAR	
28	3B	*	D13-2177-04	GEAR	
29	3B	*	D13-2178-04	GEAR	
30	3B	*	D13-2183-04	GEAR	
31	3B	*	D13-2184-04	GEAR	
32	2B	*	D13-2173-03	RACK (GEAR)	
33	2A	*	D14-0763-04	ROLLER	
35	2B	*	D21-2389-04	SHAFT	

Ref. No.	A d d	N e w	Parts No.	Description	Desti- nation
36	1A	*	D23-0955-04	RETAINER	
37	1B	*	D39-0246-05	DAMPER	
38	2B	*	G01-3095-04	EXTENSION SPRING	
39	2A	*	G01-3093-04	TORSION COIL SPRING	
40	2A	*	G01-3094-04	EXTENSION SPRING	
41	1B	*	G01-3091-04	EXTENSION SPRING	
42	2A	*	G01-3092-04	EXTENSION SPRING	
43	1B	*	G01-3090-04	EXTENSION SPRING	
44	2B	*	G02-1413-04	FLAT SPRING	
45	2B	*	G02-1414-04	FLAT SPRING	
51	1A	*	J21-9753-02	MOUNTING HARDWARE	
52	3B	*	J21-9755-02	MOUNTING HARDWARE	
53	1B	*	J21-9752-03	MOUNTING HARDWARE	
55	1A	*	J90-1014-01	GUIDE	
56	1B	*	J90-1024-03	GUIDE	
DFPC1	3A		J84-0141-05	FLEXIBLE PRINTED WIRING BOARD	
A	2B	*	N09-6192-05	TAPPING SCREW (P2X8COUNTERSU)	
B	1B	*	N09-6191-05	STEPPED SCREW (M1.7TOTAL8BON)	
C	2B	*	N09-6004-05	MACHINE SCREW (M1.7X2.5 IB-L)	
E	2B	*	N09-6193-05	MACHINE SCREW (M2X2PAN-HEAD#)	
F	1A	*	N09-6194-05	TAPPING SCREW (P2X5BINDING-H)	
G	2A		N19-2163-04	FLAT WASHER	
H	1B		N39-2020-46	PAN HEAD MACHIN SCREW	
J	1B	*	N09-6196-05	TAPTITE SCREW (S2X3.5PRECISI)	
DM1	3B		T42-1066-04	DC MOTOR ASSY (SPINDLE)	
DM2	3B		T42-1067-04	DC MOTOR ASSY (LOADING)	
DPU1	2B		X93-2010-00	OPTICAL PICKUP ASSY	

E : Europe K : North America M : Other Areas W : Without Europe

△ Indicates safety critical components.