

KDC-X8006U/X891

EXPLODED VIEW (CD MECHANISM)

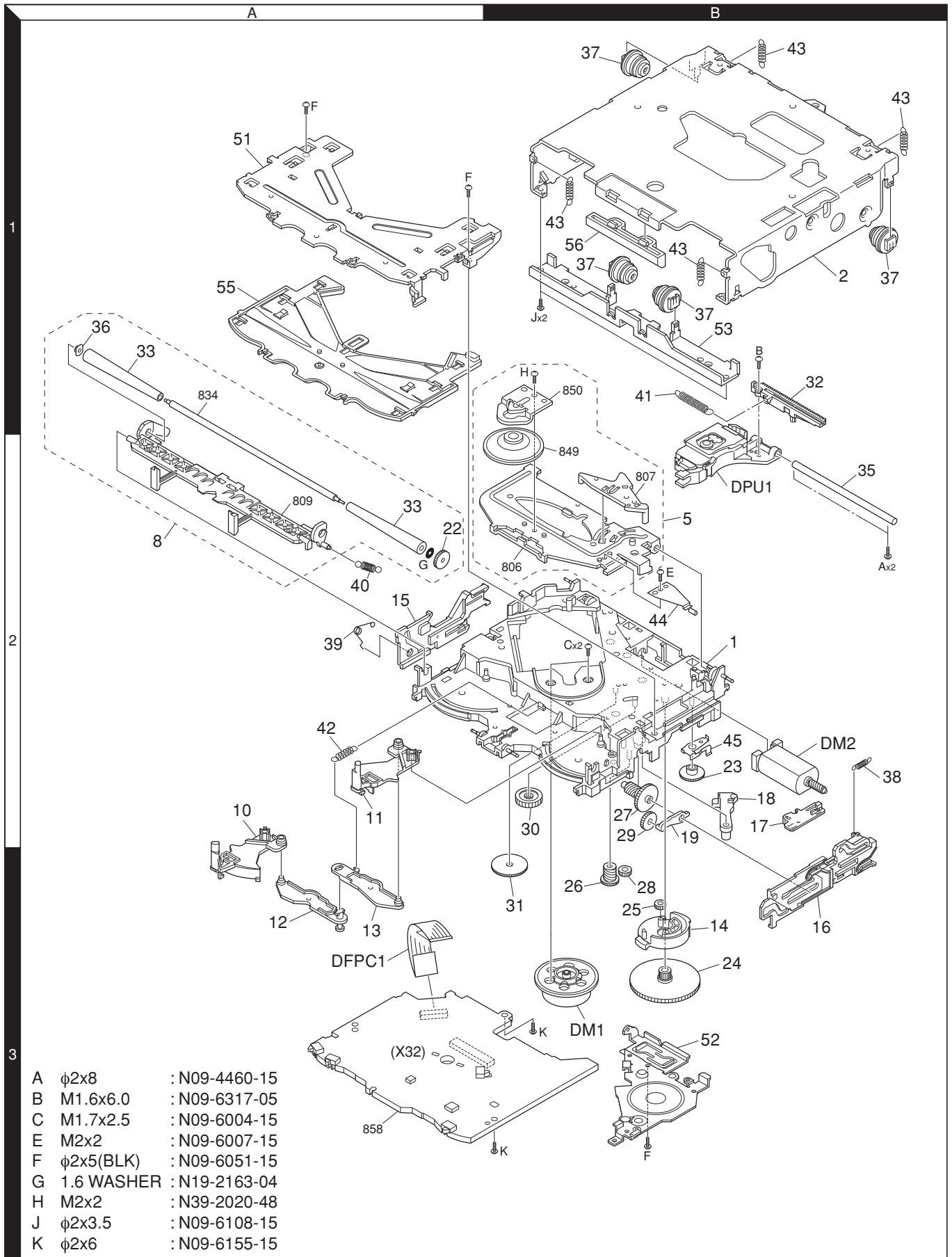

Parts with the exploded numbers larger than 700 are not supplied.

PARTS LIST

* New parts

Parts without **Parts No.** are not supplied.

Les articles non mentionnés dans le **Parts No.** ne sont pas fournis.

Teile ohne **Parts No.** werden nicht geliefert.

Ref. No.	Ad	New	Parts No.	Description	Destination
KDC-X8006U/X891					
201	1C		A02-2732-03	PLASTIC CABINET ASSY	M1
205	3C		A22-3023-22	SUB PANEL ASSY	
206	2C	*	A46-1844-11	REAR COVER	
207	1D	*	A52-0887-02	TOP PLATE	
PA1	2C	*	A64-3987-12	PANEL ASSY	K
PA1	2C	*	A64-3988-12	PANEL ASSY	M1
PME1	3D		A10-5205-32	CHASSIS ASSY	
RC1	1C		A70-2085-05	REMOTE CONTROLLER ASSY (RC-547)	
-		*	B46-0690-04	ID CARD	K
-		*	B46-0691-04	ID CARD	M1
-			B59-1872-00	SUB-INSTRUCTION MANUAL	
-			B59-1873-00	SUB-INSTRUCTION MANUAL	K
-			B59-1876-00	SUB-INSTRUCTION MANUAL	M1
-		*	B64-3635-00	INSTRUCTION MANUAL (ENG.)	K
-		*	B64-3636-00	INSTRUCTION MANUAL (FRE.)	K
-		*	B64-3637-00	INSTRUCTION MANUAL (SPA.)	K
-		*	B64-3638-00	INSTRUCTION MANUAL (ENG.CHI.)	M1
-		*	B64-3639-00	INSTRUCTION MANUAL (ARA.)	M1
210	1C		B07-3125-01	ESCUTCHEON	
211	2D		B07-3095-02	ESCUTCHEON	
215	2C	*	B19-2410-04	LIGHTING BOARD	
217	2C		B43-1518-04	BADGE	
218	1C		D10-4589-04	LEVER	
219	3C		D10-4805-03	LEVER	
220	3C		D10-4806-03	LEVER	
222	3C		D10-4807-13	LEVER	
226	3D		D10-4875-13	SLIDER ASSY	
227	2D		D13-2318-13	RACK (GEAR)	
229	2D		D13-2320-04	GEAR	
230	2D		D13-2321-04	GEAR	
231	3C		D21-2442-04	SHAFT	
232	3C		D21-2443-04	SHAFT	
236	1D		E30-6631-05	CORD WITH PINPLUG (3PRE_AU)	K
236	1D		E30-6632-05	CORD WITH PINPLUG (3PRE_NI)	M1
237	2D		E30-6639-05	CORD WITH CONNECTOR (REMO)	
238	2D	*	E30-6638-15	CORD WITH CONNECTOR (USB)	
△ DC1	1C		E30-6408-05	DC CORD	
FC1	1D		E39-0736-05	FLAT CABLE	
243	1D		F29-0626-04	INSULATING COVER (RCA)	
244	1D		F29-0637-04	INSULATING COVER (USB)	
△ F1	2D		F52-0023-05	FUSE (MINI BLADE TYPE) 10A	
245	3C		G01-3210-04	TORSION COIL SPRING	
246	3C		G01-3211-04	TORSION COIL SPRING	
247	3D		G01-3212-04	TORSION COIL SPRING	
248	2C		G01-3213-04	COMPRESSION SPRING	
249	3D		G01-3215-04	EXTENSION SPRING	
251	2D	*	G16-1661-04	SHEET	
252	3C		G11-3594-04	CUSHION	
253	2D		G11-3646-04	CUSHION	
255	3D		G16-1482-14	SHEET	
256	3D		G16-1483-04	SHEET	

Ref. No.	Ad	New	Parts No.	Description	Destination
-		*	H54-3890-03	ITEM CARTON CASE	K
-		*	H54-3891-03	ITEM CARTON CASE	M1
257	1D		H30-0594-04	MAGIC TAPE	K
259	1C		J21-9716-03	MOUNTING HARDWARE ASSY	
260	2D	*	J22-0114-13	MOUNTING HARDWARE ASSY	
261	3D		J22-0263-02	MOUNTING HARDWARE	
264	3D		J31-1062-04	COLLAR	
266	2C	*	K25-1856-03	PUSH KNOB (EJECT)	
267	2C	*	K24-4643-03	PUSH KNOB (ATT)	
268	2C	*	K24-4644-03	PUSH KNOB (SRC)	
269	2C	*	K24-4646-03	PUSH KNOB (RELEASE)	
270	2C	*	K25-1857-03	PUSH KNOB (FNC)	
271	3C	*	K28-0181-04	KNOB ASSY (FM/AM)	
272	2C		K28-0188-04	KEY TOP (VOL)	
273	3C		K28-0189-03	KEY TOP (FM/AM)	
274	2C	*	K28-0263-04	KNOB ASSY (VOL)	
276	1C		N09-6280-05	TAPPING SCREW	
277	1C		N99-1758-05	SCREW SET	
A	3D		N09-6269-05	STEPPED SCREW (M2X2)	
B	3D		N09-6140-05	STEPPED SCREW (M1.7X2)	
C	3D		N09-6141-05	STEPPED SCREW (M2X2)	
D	3D		N09-6142-05	MACHINE SCREW (M2X2.5)	
E	3C		N09-6190-05	TAPPING SCREW (T1.7X4.5)	
F	3D		N19-2305-04	FLAT WASHER (3.05X5.83)	
G	2D		N19-2184-04	FLAT WASHER (1.6X4)	
H	3C		N19-2193-04	FLAT WASHER (1.3X8)	
J	2D		N24-3015-60	E TYPE RETAINING RING	
K	3D		N09-6286-05	STEPPED SCREW (M2X1.8)	
L	3D		N09-6326-05	MACHINE SCREW (M2X2.5)	
M	2C		N78-2660-48	PAN HEAD TAPTITE SCREW	
N	2D		N09-6108-15	TAPTITE SCREW (M2X3.5)	
P	2C		N80-2008-43	PAN HEAD TAPTITE SCREW	
Q	1D		N83-3005-48	PAN HEAD TAPTITE SCREW	
R	2D		N83-3008-48	PAN HEAD TAPTITE SCREW	
S	3C		N86-2004-43	BINDING HEAD TAPTITE SCREW	
PM1	3D		T42-1086-14	MOTOR ASSY	
281	1C		W01-1690-05	COMPACT DISC	
282	1C		W01-1664-05	CARRYING CASE	K
DME1	1D		X92-5870-00	CD MECHANISM ASSY (DXM-6C20W)	
SUB-CIRCUIT UNIT (X16-2570-12)					
J1	1C		E58-1038-05	RECTANGULAR RECEPTACLE	
287	3C		F20-2284-14	INSULATING SHEET	
FPC1	3C		J86-0025-05	FPC (LEAD FREE)	
SWITCH UNIT (X16-3900-xx)					
D2-6			B30-1766-05	LED	
D7			B30-1565-05	LED (1608,PG)	
D8			B30-1566-05	LED (1608,RED)	
D9-13			B30-1766-05	LED	
C10			CK73GB1A105K	CHIP C 1.0UF	K
C16-18			CK73GB1H103K	CHIP C 0.010UF	K

K : KDC-X891 (North America) **M1** : KDC-X8006U (Other Areas)

△ Indicates safety critical components.

PARTS LIST

SWITCH UNIT (X16-3900-xx)

Ref. No.	Add	New	Parts No.	Description	Destination
C20-23			CK73GB1H103K	CHIP C 0.010UF K	
C24,25			CK73GB1H473K	CHIP C 0.047UF K	
C26,27			CK73GB1H103K	CHIP C 0.010UF K	
C28,29			CK73GB1A105K	CHIP C 1.0UF K	
C30			CK73GB1H103K	CHIP C 0.010UF K	
C31			CC73GCH1H221J	CHIP C 220PF J	
C32			CK73FB1A225K	CHIP C 2.2UF K	
C33			CK73GB1H103K	CHIP C 0.010UF K	
C34			CK73GB1C224K	CHIP C 0.22UF K	
C35,36			CK73GB1H103K	CHIP C 0.010UF K	
C37			C93-1218-05	CERAMIC 0.01UF K	
C38			CK73FB1A225K	CHIP C 2.2UF K	
C39			CK73FB0J106K	CHIP C 10UF K	
C40			CK73GB1H104K	CHIP C 0.10UF K	
C41,42			CK73FB0J106K	CHIP C 10UF K	
C43			CC73GCH1H101J	CHIP C 100PF J	
C44			CK73GB1H104K	CHIP C 0.10UF K	
C56,57			CK73GB1H473K	CHIP C 0.047UF K	
C78			CK73GB1A105K	CHIP C 1.0UF K	
C79			CK73GB1H104K	CHIP C 0.10UF K	
J1			E59-0846-05	RECTANGULAR PLUG	
X1			L78-1208-05	RESONATOR (6.6M)	
CP1,2			RK74HB1J223J	CHIP-COM 22K J 1/16W	K M1
CP2			RK74HB1J223J	CHIP-COM 22K J 1/16W	
CP3			RK74GA1J223J	CHIP-COM 22K J 1/16W	
CP4			RK74HB1J472J	CHIP-COM 4.7K J 1/16W	
CP5			RK74GA1J332J	CHIP-COM 3.3K J 1/16W	
CP6			RK74GA1J473J	CHIP-COM 47K J 1/16W	
CP7			RK74HB1J473J	CHIP-COM 47K J 1/16W	
CP8			RK74GA1J331J	CHIP-COM 330 J 1/16W	
CP9-14			RK74HB1J331J	CHIP-COM 330 J 1/16W	
CP16			RK74HB1J331J	CHIP-COM 330 J 1/16W	
CP18			RK74HB1J331J	CHIP-COM 330 J 1/16W	
CP20			RK74GA1J101J	CHIP-COM 100 J 1/16W	
CP21			RK74HB1J331J	CHIP-COM 330 J 1/16W	
CP23			RK74HB1J101J	CHIP-COM 100 J 1/16W	
CP24			RK74HB1J102J	CHIP-COM 1.0K J 1/16W	
CP25			RK74HB1J332J	CHIP-COM 3.3K J 1/16W	
CP26			RK74HB1J223J	CHIP-COM 22K J 1/16W	
CP27			RK74HB1J101J	CHIP-COM 100 J 1/16W	
CP28			RK74GA1J101J	CHIP-COM 100 J 1/16W	
CP29			RK74HB1J101J	CHIP-COM 100 J 1/16W	
CP30			RK74HB1J102J	CHIP-COM 1.0K J 1/16W	
CP31			RK74HB1J223J	CHIP-COM 22K J 1/16W	
CP34			RK74HB1J473J	CHIP-COM 47K J 1/16W	
CP35			RK74GA1J223J	CHIP-COM 22K J 1/16W	
CP36,37			RK74GA1J332J	CHIP-COM 3.3K J 1/16W	
R2			RK73EB2E821J	CHIP R 820 J 1/4W	
R3-6			RK73EB2E561J	CHIP R 560 J 1/4W	
R7			RK73EB2E821J	CHIP R 820 J 1/4W	
R8			RK73FB2B271J	CHIP R 270 J 1/8W	
R13			RK73GB2A222J	CHIP R 2.2K J 1/10W	
R18			RK73GB2A473J	CHIP R 47K J 1/10W	

Ref. No.	Add	New	Parts No.	Description	Destination
R20			RK73GB2A332J	CHIP R 3.3K J 1/10W	K M1
R23,24			RK73GB2A472J	CHIP R 4.7K J 1/10W	
R25			RK73GB2A101J	CHIP R 100 J 1/10W	
R26			RK73GB2A223J	CHIP R 22K J 1/10W	
R27,28			RK73GB2A103J	CHIP R 10K J 1/10W	
R29			RK73GB2A102J	CHIP R 1.0K J 1/10W	
R30			RK73GB2A223J	CHIP R 22K J 1/10W	
R31			RK73GB2A223J	CHIP R 22K J 1/10W	
R33			RK73GB2A102J	CHIP R 1.0K J 1/10W	
R34			RK73GB2A101J	CHIP R 100 J 1/10W	
R36			RK73GB2A101J	CHIP R 100 J 1/10W	
R37			RK73GB2A473J	CHIP R 47K J 1/10W	
R38			RK73GB2A102J	CHIP R 1.0K J 1/10W	
R39-41			RK73GB2A473J	CHIP R 47K J 1/10W	K M1
R42			RK73GB2A472J	CHIP R 4.7K J 1/10W	
R43,44			RK73PB2H3R3J	CHIP R 3.3 J 1/2W	
R45			RK73EB2E102J	CHIP R 1.0K J 1/4W	
R47,48			RK73EB2E101J	CHIP R 100 J 1/4W	
R49,50			RK73EB2E102J	CHIP R 1.0K J 1/4W	
R52			RK73GB2A223J	CHIP R 22K J 1/10W	
R53			RK73GB2A222J	CHIP R 2.2K J 1/10W	
R54			RK73EB2E333J	CHIP R 33K J 1/4W	
R55			RK73GB2A473J	CHIP R 47K J 1/10W	
R56			RK73GB2A222J	CHIP R 2.2K J 1/10W	
R58			RK73GB2A222J	CHIP R 2.2K J 1/10W	
R59			RK73GB2A473J	CHIP R 47K J 1/10W	K M1
R60			RK73FB2B180J	CHIP R 18 J 1/8W	
R61			RK73GB2A104J	CHIP R 100K J 1/10W	
R62			RK73PB2H2R7J	CHIP R 2.7 J 1/2W	
R64			RK73GB2A223J	CHIP R 22K J 1/10W	
R67			RK73GB2A333J	CHIP R 33K J 1/10W	
R71			RK73GB2A102J	CHIP R 1.0K J 1/10W	
W1,2			R92-2053-05	CHIP R 0 OHM J 1/8W	
W4			R92-1252-05	CHIP R 0 OHM J 1/16W	
S2-7			S70-0901-05	TACT SWITCH	
S19			S70-0942-05	TACT SWITCH	
S1		*	T99-0475-05	ROTARY ENCODER	
D21			DA204U	DIODE	
ED1			JN12829A	FLUORESCENT INDICATOR TUBE	
IC1		*	MX233213T14X1	ROM IC	
IC1		*	29L32CBT174X2	ROM IC	
IC4			703134AGJ015A	MICROCONTROLLER IC	
IC5			BD5237FVE	ANALOGUE IC	
IC6			PNA4S22M02KW	ANALOGUE IC	
IC7			74LV08PW	MOS-IC	
IC8			TC7WT126FU-F	MOS-IC	
IC9			74AHC1G32GW	MOS-IC	
IC10			SI-3025KMNF	ANALOGUE IC	
IC11			SI-3033LUSNF	ANALOGUE IC	
Q1,2			2SC4617	TRANSISTOR	
Q3,4			2SD2351(W)	TRANSISTOR	
Q6			2SB1689	TRANSISTOR	
Q7			2SA1774	TRANSISTOR	

K : KDC-X891 (North America) M1 : KDC-X8006U (Other Areas)

△ Indicates safety critical components.

PARTS LIST

SWITCH UNIT (X16-3900-xx)

Ref. No.	Add	New	Parts No.	Description	Destination
Q8			DTC143ZE	DIGITAL TRANSISTOR	
Q9			2SC4617	TRANSISTOR	
Q10			2SA1774	TRANSISTOR	
Q11			2SC2713-F	TRANSISTOR	
Q12			2SC4667-F	TRANSISTOR	
Q13			2SB1260	TRANSISTOR	
CD PLAYER UNIT (X32-5980-02) IN CD MECHA.					
C1			CK73GB1A105K	CHIP C 1.0UF K	
C3			CK73GB0J475K	CHIP C 4.7UF K	
C21,22			CK73GB1H104K	CHIP C 0.10UF K	
C24			CK73GB1H104K	CHIP C 0.10UF K	
C26			CK73GB1H104K	CHIP C 0.10UF K	
C31			CK73GB1C224K	CHIP C 0.22UF K	
C33			CK73GB1H472K	CHIP C 4700PF K	
C34			CK73GB1H682K	CHIP C 6800PF K	
C35			CK73GB1H102K	CHIP C 1000PF K	
C36,37			CK73GB1H682K	CHIP C 6800PF K	
C38			CK73GB1H471K	CHIP C 470PF K	
C39			CK73FB1A225K	CHIP C 2.2UF K	
C51			CK73FB0J106K	CHIP C 10UF K	
C52			CK73GB1A105K	CHIP C 1.0UF K	
C53			CK73GB1H223K	CHIP C 0.022UF K	
C54			CK73GB1H332K	CHIP C 3300PF K	
C55			CK73GB1A334K	CHIP C 0.33UF K	
C56			CK73FB0J475K	CHIP C 4.7UF K	
C57			CK73GB1H104K	CHIP C 0.10UF K	
C58			CC73GCH1H681J	CHIP C 680PF J	
C59			CK73GB1H104K	CHIP C 0.10UF K	
C60			CK73GB1H223K	CHIP C 0.022UF K	
C61			CC73GCH1H102J	CHIP C 1000PF J	
C62			CK73GB1C823K	CHIP C 0.082UF K	
C63			CC73GCH1H102J	CHIP C 1000PF J	
C64			CK73GB1A334K	CHIP C 0.33UF K	
C72			CK73GB1H104K	CHIP C 0.10UF K	
C74,75			CK73GB1H104K	CHIP C 0.10UF K	
C77,78			CK73GB1H104K	CHIP C 0.10UF K	
C81,82			CC73GCH1H150J	CHIP C 15PF J	
C84			CK73GB1A105K	CHIP C 1.0UF K	
C85			CK73GB1H102K	CHIP C 1000PF K	
CN1			E41-2612-05	FLAT CABLE CONNECTOR	
CN2			E41-2083-15	FLAT CABLE CONNECTOR	
X2			L77-2867-05	CRYSTAL RESONATOR (16.9344MHZ)	
CP1			RK74GA1J222J	CHIP-COM 2.2K J 1/16W	
CP2			RK74GA1J103J	CHIP-COM 10K J 1/16W	
CP4			RK74GA1J101J	CHIP-COM 100 J 1/16W	
CP11			RK74GA1J103J	CHIP-COM 10K J 1/16W	
R15			RK73GB2A103J	CHIP R 10K J 1/10W	
R16			RK73GB2A102J	CHIP R 1.0K J 1/10W	
R23			RK73GB2A750J	CHIP R 75 J 1/10W	
R24			RK73GB2A101J	CHIP R 100 J 1/10W	
R27			RK73GB2A101J	CHIP R 100 J 1/10W	
R31			RK73GB2A472J	CHIP R 4.7K J 1/10W	

Ref. No.	Add	New	Parts No.	Description	Destination
R32,33			RK73GB2A332J	CHIP R 3.3K J 1/10W	
R34			RK73GB2A562J	CHIP R 5.6K J 1/10W	
R37			RK73GB2A103J	CHIP R 10K J 1/10W	
R39			RK73GB2A103J	CHIP R 10K J 1/10W	
R41			RK73GB2A103J	CHIP R 10K J 1/10W	
R51			RK73GB2A103J	CHIP R 10K J 1/10W	
R52			RK73GB2A562J	CHIP R 5.6K J 1/10W	
R53			RK73GB2A102J	CHIP R 1.0K J 1/10W	
R54,55			RK73GB2A562J	CHIP R 5.6K J 1/10W	
R56			RK73GB2A473J	CHIP R 47K J 1/10W	
R57			RK73GB2A273J	CHIP R 27K J 1/10W	
R58			RK73GB2A222J	CHIP R 2.2K J 1/10W	
R59			RK73GB2A273J	CHIP R 27K J 1/10W	
R60,61			RK73GB2A153J	CHIP R 15K J 1/10W	
R62			RK73GB2A133J	CHIP R 13K J 1/10W	
R63			RK73GB2A183J	CHIP R 18K J 1/10W	
R64			RK73GB2A392J	CHIP R 3.9K J 1/10W	
R65,66			RK73GB2A153J	CHIP R 15K J 1/10W	
R73			RK73GB2A910J	CHIP R 91 J 1/10W	
R74			RK73GB2A472J	CHIP R 4.7K J 1/10W	
R75			RK73FB2B4R7J	CHIP R 4.7 J 1/8W	
R76			RK73GB2A104J	CHIP R 100K J 1/10W	
R77			RK73GB2A823J	CHIP R 82K J 1/10W	
R78			RK73GB2A821J	CHIP R 820 J 1/10W	
R79			RK73GB2A272J	CHIP R 2.7K J 1/10W	
R82-85			RK73GB2A103J	CHIP R 10K J 1/10W	
R86			RK73GB2A102J	CHIP R 1.0K J 1/10W	
R87			RK73GB2A105J	CHIP R 1.0M J 1/10W	
R88,89			RK73GB2A103J	CHIP R 10K J 1/10W	
R91,92			RK73GB2A103J	CHIP R 10K J 1/10W	
R100			RK73GB2A225J	CHIP R 2.2M J 1/10W	
R102			RK73GB2A000JX	CHIP R 0.0 J 1/10W	
R103			RK73GB2A2R2J	CHIP R 2.2 J 1/10W	
R105			RK73GB2A2R2J	CHIP R 2.2 J 1/10W	
R108			RK73EB2E4R7J	CHIP R 4.7 J 1/4W	
R110-112			RK73GB2A2R2J	CHIP R 2.2 J 1/10W	
R131			RK73GB2A103J	CHIP R 10K J 1/10W	
S1,2			S68-0863-05	PUSH SWITCH	
S3			S68-0862-05	PUSH SWITCH	
D1			DAN202U	DIODE	
D2			MA2S784-F	DIODE	
D3			DAN202U	DIODE	
IC1		*	MN6627781KB	MOS-IC	
IC2			XC6219B332PR	ANALOGUE IC	
IC6			BA5824FP	ANALOGUE IC	
Q3			UM6K1N	DUAL FET	
Q6			2SB1295-E	TRANSISTOR	
Q7			2SB0970	TRANSISTOR	
Q8,9			DTC114YUA	DIGITAL TRANSISTOR	
ELECTRIC UNIT (X34-4710-xx)					
D600			B30-1566-05	LED (1608,RED)	
C1			C90-6783-05	ERECTRO 3900 16WV	M1
C1			C90-6784-05	ELECTRO 3900UF 16WV	K

K : KDC-X891 (North America) M1 : KDC-X8006U (Other Areas)

△ Indicates safety critical components.

PARTS LIST

ELECTRIC UNIT (X34-4710-xx)

Ref. No.	Add	New	Parts No.	Description	Destination
C10			CE32BE1C221M	CHIP EL 220UF 16WV	
C11			CK73FB1C105K	CHIP C 1.0UF K	
C12			CK73GB1H104K	CHIP C 0.10UF K	
C20			CE32BE1C221M	CHIP EL 220UF 16WV	
C21			CK73GB1H103K	CHIP C 0.010UF K	
C22			CE32CL1C100M	CHIP EL 10UF 16WV	
C23			CE32CLOJ101M	CHIP EL 100UF 6.3WV	
C30			CK73GB1A474K	CHIP C 0.47UF K	
C31			CE32BM1C101M	CHIP EL 100UF 16WV	
C32			CK73GB1A474K	CHIP C 0.47UF K	
C33			CE32BJ1C101M	CHIP EL 100UF 16WV	
C40			CK73GB1H104K	CHIP C 0.10UF K	
C41			CK73GB1H103K	CHIP C 0.010UF K	
C42			CE32CL1C470M	CHIP EL 47UF 16WV	
C50,51			CK73GB1H104K	CHIP C 0.10UF K	
C60			CK73GB1C224K	CHIP C 0.22UF K	
C61,62			CK73GB1H104K	CHIP C 0.10UF K	
C64			CK73GB1H103K	CHIP C 0.010UF K	
C65			C93-1381-05	CHIP C 1UF K	
C66,67			C93-1382-05	CHIP C 1UF K	
C68			C93-1381-05	CHIP C 1UF K	
C69			C93-1382-05	CHIP C 1UF K	
C70			CK73FB1H224K	CHIP C 0.22UF K	
C71,72			C90-6834-05	ELECTRO 100UF 25WV	
C80			CK73GB1H102K	CHIP C 1000PF K	
C81,82			C90-6833-05	ELECTRO 220UF 10WV	
C83			CK73GB1H682K	CHIP C 6800PF K	
C84			CK73GB1H332K	CHIP C 3300PF K	
C85			CC73GCH1H680J	CHIP C 68PF J	
C86			C90-6834-05	ELECTRO 100UF 25WV	
C87-89			CK73GB1H104K	CHIP C 0.10UF K	
C92			CK73GB1H104K	CHIP C 0.10UF K	
C105			CE32BJ1C100M	CHIP EL 10UF 16WV	
C106,107			CK73GB1H102K	CHIP C 1000PF K	
C109			CK73FB0J106K	CHIP C 10UF K	
C110			CK73GB1A105K	CHIP C 1.0UF K	
C111			CK73GB1H103K	CHIP C 0.010UF K	
C112			CK73GB1A105K	CHIP C 1.0UF K	
C122			CK73GB1H103K	CHIP C 0.010UF K	
C140			CK73GB1H103K	CHIP C 0.010UF K	
C170			CK73GB1H103K	CHIP C 0.010UF K	
C180			CK73FB1C105K	CHIP C 1.0UF K	
C181			CK73GB1H223K	CHIP C 0.022UF K	
C200			CE32BM1C221M	CHIP EL 220UF 16WV	
C201			CK73GB1A105K	CHIP C 1.0UF K	
C300-302			CK73GB1H104K	CHIP C 0.10UF K	
C310-312			CK73GB1H104K	CHIP C 0.10UF K	K
C313			CK73GB1A105K	CHIP C 1.0UF K	K
C340,341			CC73GCH1H270J	CHIP C 27PF J	K
C342			CE32BJ1C100M	CHIP EL 10UF 16WV	K
C343			CK73GB1H103K	CHIP C 0.010UF K	K
C344			CK73FB1A225K	CHIP C 2.2UF K	K
C345			CC73GCH1H331J	CHIP C 330PF J	K
C346			CK73GB1H104K	CHIP C 0.10UF K	K
C347			CC73GCH1H561J	CHIP C 560PF J	K

Ref. No.	Add	New	Parts No.	Description	Destination
C350			CE32BJ1C220M	CHIP EL 22UF 16WV	
C351			C90-6835-05	ELECTRO 100UF 25WV	
C352,353			CK73EB1E225K	CHIP C 2.2UF K	
C354			CE32BJ1C220M	CHIP EL 22UF 16WV	
C355,356			CK73EB1E225K	CHIP C 2.2UF K	
C357			CK73GB1H223K	CHIP C 0.022UF K	
C358			CK73GB1H103K	CHIP C 0.010UF K	
C359,360			CK73EB1E225K	CHIP C 2.2UF K	
C361-378			CE32BE1C100M	CHIP EL 10UF 16WV	
C400-403			CK73GB1H103K	CHIP C 0.010UF K	
C410,411			CK73FB1E474K	CHIP C 0.47UF K	
C412			CE32BJ0J470M	CHIP EL 47UF 6.3WV	
C413			CK73GB1H103K	CHIP C 0.010UF K	
C420			CK73FB1E474K	CHIP C 0.47UF K	
C421			CE32BJ0J470M	CHIP EL 47UF 6.3WV	
C422			CK73FB1E474K	CHIP C 0.47UF K	
C423			CK73GB1H103K	CHIP C 0.010UF K	
C450,451			CK73FB1C105K	CHIP C 1.0UF K	
C453-460			CC73GCH1H150J	CHIP C 15PF J	
C461-464			C90-6768-05	ELECTRO 0.22UF 16WV	
C465-472			CC73GCH1H150J	CHIP C 15PF J	
C475			C90-6765-05	ELECTRO 1UF 16WV	
C479			CK73GB1H103K	CHIP C 0.010UF K	
C480,481			CE32BJ1H2R2M	CHIP EL 2.2UF 50WV	
C482,483			CK73FB1E474K	CHIP C 0.47UF K	
C484,485			CC73GCH1H070D	CHIP C 7.0PF D	
C486,487			CK73GB1A474K	CHIP C 0.47UF K	
C488			CK73FB1C105K	CHIP C 1.0UF K	
C489-491			CE32BJ1H2R2M	CHIP EL 2.2UF 50WV	
C492-495			CK73FB1C105K	CHIP C 1.0UF K	
C496			CK73GB1H103K	CHIP C 0.010UF K	
C497			CE32BE1C100M	CHIP EL 10UF 16WV	
C498			CE32BJ1C470M	CHIP EL 47UF 16WV	
C500,501			CC73GCH1H220J	CHIP C 22PF J	
C502			CK73GB1H104K	CHIP C 0.10UF K	
C503-506			CK73GB1H103K	CHIP C 0.010UF K	
C508,509			CK73GB1H103K	CHIP C 0.010UF K	
C510			CK73GB1H102K	CHIP C 1000PF K	
C511			CK73GB1H103K	CHIP C 0.010UF K	
C512			CE32BJ0J470M	CHIP EL 47UF 6.3WV	
C513,514			CK73GB1H103K	CHIP C 0.010UF K	
C517,518			CC73GCH1H471J	CHIP C 470PF J	
C600-602			CK73GB1H104K	CHIP C 0.10UF K	
C702			CK73GB1H104K	CHIP C 0.10UF K	
C703			CC73GCH1H070D	CHIP C 7.0PF D	
C705			CC73GCH1H070D	CHIP C 7.0PF D	
C707,708			CK73FB0J106K	CHIP C 10UF K	
C711,712			CK73FB0J106K	CHIP C 10UF K	
C713			CK73GB1H104K	CHIP C 0.10UF K	
C714			CK73FB0J106K	CHIP C 10UF K	
C715			CC73GCH1H151J	CHIP C 150PF J	
C716			CE32BE1C100M	CHIP EL 10UF 16WV	
C719			CK73GB1H104K	CHIP C 0.10UF K	
C720			CC73GCH1H681J	CHIP C 680PF J	
C722			CK73FB0J106K	CHIP C 10UF K	

K : KDC-X891 (North America) M1 : KDC-X8006U (Other Areas)

△ Indicates safety critical components.

PARTS LIST

ELECTRIC UNIT (X34-4710-xx)

Ref. No.	Add	New	Parts No.	Description	Destination	Ref. No.	Add	New	Parts No.	Description	Destination
C723,724			CK73GB1A105K	CHIP C 1.0UF K		X502			L77-2880-05	CRYSTAL RESONATOR	
C725			CK73GB1H104K	CHIP C 0.10UF K		X700			L77-2880-05	CRYSTAL RESONATOR	
C726,727			CK73GB1A105K	CHIP C 1.0UF K		X701			L77-2908-05	CRYSTAL RESONATOR (12.000MHZ)	
C728			CC73GCH1H681J	CHIP C 680PF J		Q	2D		N83-3005-48	PAN HEAD TAPTITE SCREW	
C730			CE32BE1C100M	CHIP EL 10UF 16WV		T	2D		N80-3010-48	PAN HEAD TAPTITE SCREW	
C731			CC73GCH1H151J	CHIP C 150PF J		V	2D		N83-3020-48	PAN HEAD TAPTITE SCREW	
C732,733			CK73GB1H473K	CHIP C 0.047UF K		CP210,211			RK74GA1J101J	CHIP-COM 100 J 1/16W	K
C736			CK73GB1A105K	CHIP C 1.0UF K		CP310			RK74GA1J101J	CHIP-COM 100 J 1/16W	
C737			CE32BJ1C100M	CHIP EL 10UF 16WV		CP420			RK74GA1J101J	CHIP-COM 100 J 1/16W	
C739,740			CC73GCH1H120J	CHIP C 12PF J		CP421			RK74HB1J101J	CHIP-COM 100 J 1/16W	
C741			CK73FB0J106K	CHIP C 10UF K		CP501			RK74GA1J101J	CHIP-COM 100 J 1/16W	
C742-744			CK73GB1H103K	CHIP C 0.010UF K		CP502			RK74HB1J102J	CHIP-COM 1.0K J 1/16W	
C745			CC73GCH1H331J	CHIP C 330PF J		CP503			RK74GA1J101J	CHIP-COM 100 J 1/16W	
C747			CK73GB1H103K	CHIP C 0.010UF K		CP504			RK74GA1J472J	CHIP-COM 4.7K J 1/16W	
C749			CK73FB0J106K	CHIP C 10UF K		CP505-507			RK74GA1J101J	CHIP-COM 100 J 1/16W	
C750-762			CK73GB1H103K	CHIP C 0.010UF K		CP600			RK74GA1J102J	CHIP-COM 1.0K J 1/16W	
C763			CK73GB1H104K	CHIP C 0.10UF K		CP700			RK74HB1J330J	CHIP-COM 33 J 1/16W	
C764-768			CK73GB1H103K	CHIP C 0.010UF K		CP701			RK74HB1J101J	CHIP-COM 100 J 1/16W	
C773,774			CK73GB1H103K	CHIP C 0.010UF K		CP703-711			RK74HB1J330J	CHIP-COM 33 J 1/16W	
C903			CC73GCH1H070D	CHIP C 7.0PF D		CP714-717			RK74HB1J330J	CHIP-COM 33 J 1/16W	
C905,906			CC73GCH1H070D	CHIP C 7.0PF D		CP720			RK74HB1J223J	CHIP-COM 22K J 1/16W	
C908,909			CK73EB1E105K	CHIP C 1.0UF K		R10			RK73GH2A432D	CHIP R 4.3K D 1/10W	
C911			CC73GCH1H070D	CHIP C 7.0PF D		R11			RK73GH2A243D	CHIP R 24K D 1/10W	
C912			CK73GB1H104K	CHIP C 0.10UF K		R12			RK73FB2B221J	CHIP R 220 J 1/8W	
C913			CC73GCH1H150J	CHIP C 15PF J		R20			RK73FB2B203J	CHIP R 20K J 1/8W	
C916			CC73GCH1H070D	CHIP C 7.0PF D		R21			RK73GB2A223J	CHIP R 22K J 1/10W	
C917			CC73GCH1H150J	CHIP C 15PF J		R22			RK73FB2B272J	CHIP R 2.7K J 1/8W	
C918			CC73GCH1H180J	CHIP C 18PF J		R30			RK73FB2B102J	CHIP R 1.0K J 1/8W	
C919,920			CK73GB1H104K	CHIP C 0.10UF K		R32			RK73FB2B152J	CHIP R 1.5K J 1/8W	
C960			CK73GB1H104K	CHIP C 0.10UF K		R40,41			RK73PB2H1R0J	CHIP R 1.0 J 1/2W	
C962			CK73GB1H104K	CHIP C 0.10UF K		R42			RK73FB2B223J	CHIP R 22K J 1/8W	
C964			CK73GB1H104K	CHIP C 0.10UF K		R43			RK73GB2A105J	CHIP R 1.0M J 1/10W	
C970			CK73FB0J106K	CHIP C 10UF K		R44,45			RK73GB2A104J	CHIP R 100K J 1/10W	
CN190			E41-2777-05	PIN ASSY		R46			RK73FB2B431J	CHIP R 430 J 1/8W	
CN200			E41-2777-05	PIN ASSY		R50			RK73FB2B182J	CHIP R 1.8K J 1/8W	
CN300			E41-2352-05	FLAT CABLE CONNECTOR		R51			RK73GB2A472J	CHIP R 4.7K J 1/10W	
CN361			E41-2555-05	PIN ASSY		R52			RK73GB2A473J	CHIP R 47K J 1/10W	
CN600			E41-2344-05	FLAT CABLE CONNECTOR		R61			RK73PB2H1R0J	CHIP R 1.0 J 1/2W	
CN601			E41-2735-05	PIN ASSY		R62			RK73GB2A104J	CHIP R 100K J 1/10W	
△ J1			E58-0991-05	RECTANGULAR RECEPTACLE		R63			RK73GB2A473J	CHIP R 47K J 1/10W	
J410			E11-0625-05	PHONE JACK		R64			RK73PB2H102J	CHIP R 1.0K J 1/2W	
J420			E56-0855-05	CYLINDRICAL RECEPTACLE		R65			RK73GB2A473J	CHIP R 47K J 1/10W	
W400	1D		E30-6637-05	CORD WITH PLUG (ANT)		R66			RK73GH2A9311D	CHIP R 9.31K D 1/10W	
△ L1			L33-2365-05	CHOKE COIL ASSY		R67			RK73GH2A434D	CHIP R 430K D 1/10W	
L60			L33-2288-05	SMALL FIXED INDUCTOR		R68			RK73GB2A103J	CHIP R 10K J 1/10W	
L61			L92-0639-05	CHIP FERRITE		R73			RK73FB2B222J	CHIP R 2.2K J 1/8W	
L80			L33-2296-05	SMALL FIXED INDUCTOR		R74			RK73GB2A473J	CHIP R 47K J 1/10W	
L81			L33-2229-05	SMALL FIXED INDUCTOR		R75			RK73GB2A104J	CHIP R 100K J 1/10W	
L200			L92-0616-05	CHIP FERRITE		R80			RK73GH2A753D	CHIP R 75K D 1/10W	
L350			L41-2205-33	SMALL FIXED INDUCTOR (22U)		R81			RK73GH2A103D	CHIP R 10K D 1/10W	
L505			L41-4795-33	SMALL FIXED INDUCTOR (4.7U)		R82,83			RK73GB2A154J	CHIP R 150K J 1/10W	
L700			L92-0615-05	CHIP FERRITE		R84			RK73GH2A103D	CHIP R 10K D 1/10W	
X340			L77-2002-05	CRYSTAL RESONATOR	K	R85			RK73GH2A753D	CHIP R 75K D 1/10W	
X501			L78-0872-05	RESONATOR (12MHZ)		R86			RK73GH2A823D	CHIP R 82K D 1/10W	

K : KDC-X891 (North America) M1 : KDC-X8006U (Other Areas)

△ Indicates safety critical components.

PARTS LIST

ELECTRIC UNIT (X34-4710-xx)

Ref. No.	Add	New	Parts No.	Description	Destination
R87			RK73GH2A114D	CHIP R 110K D 1/10W	
R88			RK73GH2A683D	CHIP R 68K D 1/10W	
R100			RK73FB2B1R0J	CHIP R 1.0 J 1/8W	
R102			RK73FB2B183J	CHIP R 18K J 1/8W	
R103			RK73GB2A473J	CHIP R 47K J 1/10W	
R106			RK73GB2A103J	CHIP R 10K J 1/10W	
R107			RK73GB2A102J	CHIP R 1.0K J 1/10W	
R110			RK73GH2A682D	CHIP R 6.8K D 1/10W	
R111			RK73GH2A472D	CHIP R 4.7K D 1/10W	
R112			RK73GB2A102J	CHIP R 1.0K J 1/10W	
R114			RK73PB2H102J	CHIP R 1.0K J 1/2W	
R115			RK73GB2A563J	CHIP R 56K J 1/10W	
R116			RK73GB2A101J	CHIP R 100 J 1/10W	
R117			RK73GB2A473J	CHIP R 47K J 1/10W	
R118-121			RK73GB2A103J	CHIP R 10K J 1/10W	
R126			RK73GB2A183J	CHIP R 18K J 1/10W	
R127			RK73FB2B203J	CHIP R 20K J 1/8W	
R128			RK73GB2A104J	CHIP R 100K J 1/10W	
R129			RK73EB2E473J	CHIP R 47K J 1/4W	
R130			R92-5088-05	CHIP R 3.3K J 3/4W	
R131			RK73GB2A393J	CHIP R 39K J 1/10W	
R132			RK73FB2B683J	CHIP R 68K J 1/8W	
R140			RK73FB2B472J	CHIP R 4.7K J 1/8W	
R141,142			RK73GB2A222J	CHIP R 2.2K J 1/10W	
R150			RK73GB2A223J	CHIP R 22K J 1/10W	
R151,152			RK73PB2H221J	CHIP R 220 J 1/2W	
R153			RK73FB2B472J	CHIP R 4.7K J 1/8W	
R160			RK73FB2B561J	CHIP R 560 J 1/8W	
R161			RK73EB2E102J	CHIP R 1.0K J 1/4W	
R170			RK73GB2A473J	CHIP R 47K J 1/10W	
R171			RK73GB2A104J	CHIP R 100K J 1/10W	
R172			RK73EB2E103J	CHIP R 10K J 1/4W	
R180			RK73GB2A104J	CHIP R 100K J 1/10W	
R181			RK73EB2E103J	CHIP R 10K J 1/4W	
R182			RK73GB2A222J	CHIP R 2.2K J 1/10W	
R190			RK73EB2E102J	CHIP R 1.0K J 1/4W	
R194			RK73GB2A222J	CHIP R 2.2K J 1/10W	
R195			RK73GB2A104J	CHIP R 100K J 1/10W	
R200			RK73GB2A101J	CHIP R 100 J 1/10W	
R210,211			RK73GB2A104J	CHIP R 100K J 1/10W	
R214			RK73GB2A101J	CHIP R 100 J 1/10W	
R215			RK73GB2A104J	CHIP R 100K J 1/10W	
R300,301			RK73GB2A153J	CHIP R 15K J 1/10W	
R302			RK73PB2H2R2J	CHIP R 2.2 J 1/2W	
R303			RK73GB2A101J	CHIP R 100 J 1/10W	
R310,311			RK73GB2A102J	CHIP R 1.0K J 1/10W	K
R312			RK73GH2A111D	CHIP R 110 D 1/10W	K
R313			RK73GH2A241D	CHIP R 240 D 1/10W	K
R340-342			RK73GB2A222J	CHIP R 2.2K J 1/10W	K
R343			RK73GB2A102J	CHIP R 1.0K J 1/10W	K
R344			RK73GB2A223J	CHIP R 22K J 1/10W	K
R345			RK73GB2A222J	CHIP R 2.2K J 1/10W	K
R346			RK73GB2A512J	CHIP R 5.1K J 1/10W	K
R350			RK73GB2A182J	CHIP R 1.8K J 1/10W	
R351			RK73GB2A750J	CHIP R 75 J 1/10W	

Ref. No.	Add	New	Parts No.	Description	Destination
R352			RK73GB2A272J	CHIP R 2.7K J 1/10W	
R353			RK73GB2A470J	CHIP R 47 J 1/10W	
R354			RK73GB2A752J	CHIP R 7.5K J 1/10W	
R355			RK73GB2A563J	CHIP R 56K J 1/10W	
R356			RK73GB2A274J	CHIP R 270K J 1/10W	
R357			RK73GB2A470J	CHIP R 47 J 1/10W	
R358			RK73GB2A103J	CHIP R 10K J 1/10W	
R359,360			RK73GB2A913J	CHIP R 91K J 1/10W	
R361-366			RK73GB2A361J	CHIP R 360 J 1/10W	
R367-372			RK73GB2A223J	CHIP R 22K J 1/10W	
R373-378			RK73GB2A103J	CHIP R 10K J 1/10W	
R379-384			RK73GB2A104J	CHIP R 100K J 1/10W	
R385-390			RK73GB2A123J	CHIP R 12K J 1/10W	
R391-396			RK73GB2A820J	CHIP R 82 J 1/10W	
R401			RK73GB2A223J	CHIP R 22K J 1/10W	
R402			RK73FB2B821J	CHIP R 820 J 1/8W	
R403,404			RK73GB2A471J	CHIP R 470 J 1/10W	
R410,411			RK73GB2A123J	CHIP R 12K J 1/10W	
R412,413			RK73EB2E100J	CHIP R 10 J 1/4W	
R414			RK73EB2E4R7J	CHIP R 4.7 J 1/4W	
R415			RK73GB2A102J	CHIP R 1.0K J 1/10W	
R420			RK73EB2E432J	CHIP R 4.3K J 1/4W	
R421,422			RK73EB2E101J	CHIP R 100 J 1/4W	
R423			RK73EB2E432J	CHIP R 4.3K J 1/4W	
R424,425			RK73EB2E101J	CHIP R 100 J 1/4W	
R426			RK73EB2E100J	CHIP R 10 J 1/4W	
R427			RK73EB2E4R7J	CHIP R 4.7 J 1/4W	
R428			RK73EB2E100J	CHIP R 10 J 1/4W	
R429,430			RK73EB2E101J	CHIP R 100 J 1/4W	
R431			RK73GB2A102J	CHIP R 1.0K J 1/10W	
R432-434			RK73GB2A104J	CHIP R 100K J 1/10W	
R435			RK73GB2A101J	CHIP R 100 J 1/10W	
R440			RK73GB2A104J	CHIP R 100K J 1/10W	
R441			RK73GB2A101J	CHIP R 100 J 1/10W	
R442			RK73GB2A104J	CHIP R 100K J 1/10W	
R450			RK73GB2A752J	CHIP R 7.5K J 1/10W	
R451			RK73GB2A104J	CHIP R 100K J 1/10W	
R452			RK73GB2A331J	CHIP R 330 J 1/10W	
R453			RK73GB2A273J	CHIP R 27K J 1/10W	
R454			RK73GB2A470J	CHIP R 47 J 1/10W	
R457			RK73GB2A151J	CHIP R 150 J 1/10W	
R458-461			RK73GB2A680J	CHIP R 68 J 1/10W	
R469			RK73GB2A104J	CHIP R 100K J 1/10W	
R470			RK73GB2A102J	CHIP R 1.0K J 1/10W	
R471			RK73GB2A473J	CHIP R 47K J 1/10W	
R480,481			RK73GB2A101J	CHIP R 100 J 1/10W	
R482,483			RK73GB2A103J	CHIP R 10K J 1/10W	
R486-489			RK73GB2A470J	CHIP R 47 J 1/10W	
R490			RK73EB2E2R2J	CHIP R 2.2 J 1/4W	
R500,501			RK73GB2A103J	CHIP R 10K J 1/10W	
R502			RK73GB2A104J	CHIP R 100K J 1/10W	
R503			RK73GB2A102J	CHIP R 1.0K J 1/10W	
R505,506			RK73GB2A104J	CHIP R 100K J 1/10W	
R507			RK73GB2A102J	CHIP R 1.0K J 1/10W	
R508,509			RK73GB2A472J	CHIP R 4.7K J 1/10W	

K : KDC-X891 (North America) M1 : KDC-X8006U (Other Areas)

△ Indicates safety critical components.

PARTS LIST

ELECTRIC UNIT (X34-4710-xx)

Ref. No.	Add	New	Parts No.	Description	Destination	Ref. No.	Add	New	Parts No.	Description	Destination
R512-514			RK73GB2A104J	CHIP R 100K J 1/10W		R745			RK73GB2A330J	CHIP R 33 J 1/10W	
R515,516			RK73GB2A471J	CHIP R 470 J 1/10W		R746			RK73GB2A101J	CHIP R 100 J 1/10W	
R517-519			RK73GB2A104J	CHIP R 100K J 1/10W		R747			RK73GB2A223J	CHIP R 22K J 1/10W	
R520			RK73GB2A101J	CHIP R 100 J 1/10W		R748			RK73GB2A100J	CHIP R 10 J 1/10W	
R522			RK73GB2A222J	CHIP R 2.2K J 1/10W		R749			RK73GB2A515J	CHIP R 5.1M J 1/10W	
R525			RK73GB2A472J	CHIP R 4.7K J 1/10W		R750			RK73GB2A100J	CHIP R 10 J 1/10W	
R526,527			RK73GB2A104J	CHIP R 100K J 1/10W		R751,752			RK73GB2A101J	CHIP R 100 J 1/10W	
R528			RK73GB2A223J	CHIP R 22K J 1/10W		R753			RK73GB2A153J	CHIP R 15K J 1/10W	
R530			RK73GB2A223J	CHIP R 22K J 1/10W		R754			RK73GB2A101J	CHIP R 100 J 1/10W	
R540			RK73GB2A473J	CHIP R 47K J 1/10W	M1	R755,756			RK73GB2A470J	CHIP R 47 J 1/10W	
R541,542			RK73GB2A104J	CHIP R 100K J 1/10W		R758			RK73GB2A332J	CHIP R 3.3K J 1/10W	
R543			RK73GB2A223J	CHIP R 22K J 1/10W		R759-762			RK73GB2A223J	CHIP R 22K J 1/10W	
R544			RK73GB2A222J	CHIP R 2.2K J 1/10W		R764,765			RK73GB2A223J	CHIP R 22K J 1/10W	
R545-548			RK73EB2E101J	CHIP R 100 J 1/4W		R766			RK73GB2A430J	CHIP R 43 J 1/10W	
R549			RK73EB2E102J	CHIP R 1.0K J 1/4W		R767			RK73GB2A223J	CHIP R 22K J 1/10W	
R550			RK73EB2E472J	CHIP R 4.7K J 1/4W		R768			RK73GB2A680J	CHIP R 68 J 1/10W	
R551			RK73EB2E102J	CHIP R 1.0K J 1/4W		R769			RK73GB2A104J	CHIP R 100K J 1/10W	
R552			RK73GB2A473J	CHIP R 47K J 1/10W		R770			RK73GB2A223J	CHIP R 22K J 1/10W	
R553			RK73GB2A223J	CHIP R 22K J 1/10W		R771			RK73GB2A820J	CHIP R 82 J 1/10W	
R554			R92-3418-05	CHIP R 0.47 J 1/2W		R772			RK73GB2A750J	CHIP R 75 J 1/10W	
R556			RK73GB2A1R0J	CHIP R 1.0 J 1/10W		R773			RK73GB2A102J	CHIP R 1.0K J 1/10W	
R557			RK73FB2B4R7J	CHIP R 4.7 J 1/8W	K	R774			RK73GB2A330J	CHIP R 33 J 1/10W	
R600,601			RK73GB2A103J	CHIP R 10K J 1/10W		R775			RK73GB2A153J	CHIP R 15K J 1/10W	
R602			RK73GB2A104J	CHIP R 100K J 1/10W		R776			RK73GB2A330J	CHIP R 33 J 1/10W	
R603,604			RK73GB2A102J	CHIP R 1.0K J 1/10W		R777			RK73GB2A153J	CHIP R 15K J 1/10W	
R605			RK73GB2A241J	CHIP R 240 J 1/10W		R778			RK73GB2A330J	CHIP R 33 J 1/10W	
R702			RK73GB2A473J	CHIP R 47K J 1/10W		R779,780			RK73GB2A101J	CHIP R 100 J 1/10W	
R703			RK73GB2A515J	CHIP R 5.1M J 1/10W		R781			RK73GB2A104J	CHIP R 100K J 1/10W	
R704			RK73GB2A101J	CHIP R 100 J 1/10W		R782-786			RK73GB2A101J	CHIP R 100 J 1/10W	
R705			RK73GB2A473J	CHIP R 47K J 1/10W		R787			RK73GB2A104J	CHIP R 100K J 1/10W	
R706			RK73GB2A123J	CHIP R 12K J 1/10W		R788			RK73GB2A102J	CHIP R 1.0K J 1/10W	
R707			RK73GB2A473J	CHIP R 47K J 1/10W		R789			RK73GB2A104J	CHIP R 100K J 1/10W	
R708			RK73GB2A102J	CHIP R 1.0K J 1/10W		R790			RK73GB2A100J	CHIP R 10 J 1/10W	
R709,710			RK73GB2A473J	CHIP R 47K J 1/10W		R791,792			RK73GB2A104J	CHIP R 100K J 1/10W	
R711			RK73GH2A562D	CHIP R 5.6K D 1/10W		R793,794			RK73GB2A101J	CHIP R 100 J 1/10W	
R712			RK73GB2A103J	CHIP R 10K J 1/10W		R795			RK73GB2A820J	CHIP R 82 J 1/10W	
R713			RK73GH2A822D	CHIP R 8.2K D 1/10W		R796			RK73GB2A101J	CHIP R 100 J 1/10W	
R714			RK73GH2A752D	CHIP R 7.5K D 1/10W		R797			RK73GB2A103J	CHIP R 10K J 1/10W	
R717			RK73GB2A680J	CHIP R 68 J 1/10W		R798			RK73GB2A101J	CHIP R 100 J 1/10W	
R718,719			RK73GB2A473J	CHIP R 47K J 1/10W		R799			RK73GB2A750J	CHIP R 75 J 1/10W	
R720			RK73GH2A104D	CHIP R 100K D 1/10W		R800-804			RK73GB2A101J	CHIP R 100 J 1/10W	
R721			RK73GB2A473J	CHIP R 47K J 1/10W		R805,806			RK73GB2A100J	CHIP R 10 J 1/10W	
R722			RK73GB2A101J	CHIP R 100 J 1/10W		R807-815			RK73GB2A223J	CHIP R 22K J 1/10W	
R723,724			RK73GB2A473J	CHIP R 47K J 1/10W		R816			RK73GB2A680J	CHIP R 68 J 1/10W	
R725			RK73GB2A102J	CHIP R 1.0K J 1/10W		R817			RK73GB2A101J	CHIP R 100 J 1/10W	
R729			RK73GB2A103J	CHIP R 10K J 1/10W		R818			RK73GB2A680J	CHIP R 68 J 1/10W	
R731			RK73GH2A822D	CHIP R 8.2K D 1/10W		R819			RK73GB2A750J	CHIP R 75 J 1/10W	
R732			RK73GH2A752D	CHIP R 7.5K D 1/10W		R850			RK73GB2A1R0J	CHIP R 1.0 J 1/10W	
R734			RK73GH2A562D	CHIP R 5.6K D 1/10W		R900-902			RK73GB2A560J	CHIP R 56 J 1/10W	
R735,736			RK73GB2A223J	CHIP R 22K J 1/10W		R904,905			RK73GB2A101J	CHIP R 100 J 1/10W	
R738,739			RK73GB2A222J	CHIP R 2.2K J 1/10W		R906			RK73GB2A100J	CHIP R 10 J 1/10W	
R740			RK73GB2A101J	CHIP R 100 J 1/10W		R907			RK73GB2A101J	CHIP R 100 J 1/10W	
R741,742			RK73GB2A222J	CHIP R 2.2K J 1/10W		R908-911			RK73GB2A100J	CHIP R 10 J 1/10W	
R743			RK73GB2A223J	CHIP R 22K J 1/10W		R950			RK73GB2A163J	CHIP R 16K J 1/10W	
R744			RK73GB2A750J	CHIP R 75 J 1/10W		R951			RK73GB2A273J	CHIP R 27K J 1/10W	

K : KDC-X891 (North America) M1 : KDC-X8006U (Other Areas)

△ Indicates safety critical components.

PARTS LIST

ELECTRIC UNIT (X34-4710-xx)

Ref. No.	Add	New	Parts No.	Description	Destination
R952			RK73GB2A104J	CHIP R 100K J 1/10W	K
R953			RK73GB2A102J	CHIP R 1.0K J 1/10W	
R954			RK73GH2A472D	CHIP R 4.7K D 1/10W	
R955			RK73GH2A113D	CHIP R 11K D 1/10W	
R960			RK73GB2A100J	CHIP R 10 J 1/10W	
R962			RK73GB2A100J	CHIP R 10 J 1/10W	
R963			RK73GB2A131J	CHIP R 130 J 1/10W	
R973			RK73GB2A104J	CHIP R 100K J 1/10W	
R974			RK73GB2A473J	CHIP R 47K J 1/10W	
R975			RK73GB2A123J	CHIP R 12K J 1/10W	
R976			RK73GB2A103J	CHIP R 10K J 1/10W	
W340			R92-1252-05	CHIP R 0 OHM J 1/16W	
W511			R92-1252-05	CHIP R 0 OHM J 1/16W	
W702			R92-1252-05	CHIP R 0 OHM J 1/16W	
W704,705			R92-1252-05	CHIP R 0 OHM J 1/16W	
W901			R92-1252-05	CHIP R 0 OHM J 1/16W	
W914,915			R92-1252-05	CHIP R 0 OHM J 1/16W	
W970			R92-2052-05	CHIP R 0 OHM J 1/10W	
S600,601			S68-0886-05	PUSH SWITCH	
D1			S2V60-5009F46	DIODE	
D20			RB160L-40	DIODE	
D21			UDZS5.6B	ZENER DIODE	
D30			HZU9.1(B1)-E	ZENER DIODE	
D31			UDZS8.2B	ZENER DIODE	
D40			UDZS5.6B	ZENER DIODE	
D50			HZU11(B1)-E	ZENER DIODE	
D61-63			RB060L-40	DIODE	
D70			HZU16(B1)-E	ZENER DIODE	
D80			NSQ03A04G	DIODE	
D81			SFPB-54VNF	DIODE	
D100			UDZS16B	ZENER DIODE	
D102-104			MC2846	DIODE	
D120			MC2846	DIODE	
D121,122			UDZS6.8B	ZENER DIODE	
D123			UDZS6.2B	ZENER DIODE	
D140,141			1SR154-400	DIODE	
D150,151			1SR154-400	DIODE	
D160			UDZS5.6B	ZENER DIODE	
D170			UDZS4.7B	ZENER DIODE	
D190			STZ6.2N	ZENER DIODE	
D200,201			AVRL1613R3FTA	VARISTOR	
D350			UDZS11B	ZENER DIODE	
D351			UDZS5.6B	ZENER DIODE	
D361,362			MC2846	DIODE	
D379-384			AVRM1608180M6A	VARISTOR	
D410-412			UDZS6.8B	ZENER DIODE	
D420-428			UDZS6.2B	ZENER DIODE	
D450,451			MC2846	DIODE	
D480,481			UDZS5.6B	ZENER DIODE	
D484-486			MC2846	DIODE	
D500			MC2846	DIODE	
D501-506			UDZS6.2B	ZENER DIODE	
IC10			M5237ML-CF0J	ANALOGUE IC	
IC60			LT3467A	ANALOGUE IC	

Ref. No.	Add	New	Parts No.	Description	Destination
IC80			BD9302FP	ANALOGUE IC	K K
IC100			NJM4565V-ZB	ANALOGUE IC	
IC101			TA75S558F-F	ANALOGUE IC	
IC102			74AHC1G32GW	MOS-IC	
IC140			TPD1018F-F	ANALOGUE IC	
IC300			MIC2026-1YM	MOS-IC	
IC310			MMA6261QR2	ANALOGUE IC	
IC340			LC72725KV	ANALOGUE IC	
IC350			ICL7660SIBAZ	ANALOGUE IC	
IC361-363			NJM4565V-ZB	ANALOGUE IC	
IC450			TB2903HQ	ANALOGUE IC	
IC480			E-TDA7415CB	ANALOGUE IC	
IC500			30624MGPB44GP	MICROCONTROLLER IC	
IC510			S-80836CNNB-J	MOS-IC	
IC520			BR24L04FV-W	ROM IC	
IC530			74HC2G02DP	MOS-IC	
IC600			LB1930M-E	ANALOGUE IC	
IC701			WM8716SEDS/R	MOS-IC	
IC702			341S2094	MICROPROCESSOR IC	
IC703			AK4117	MOS-IC	
IC704			NJM4565V-ZB	ANALOGUE IC	
IC705			TAR5S50-F	ANALOGUE IC	
IC708			SI-3033KMS	ANALOGUE IC	
IC709,710			TC7WT126FU-F	MOS-IC	
IC711			TCC760	MOS-IC	
IC712			74LV08PW	MOS-IC	
IC714			IC42S164007TIG	DRAM IC	
IC715			A29L80AUV4X9F	ROM IC	
IC716			R1114N181B-TR	ANALOGUE IC (1.8V LF)	
IC717			TAR5S33-F	ANALOGUE IC	
Q10			2SB1565	TRANSISTOR	
Q11,12			UMC2N	TRANSISTOR	
Q20			2SB1565	TRANSISTOR	
Q21			2SD2351(W)	TRANSISTOR	
Q22			2SA1577	TRANSISTOR	
Q23			DTC124EUA	DIGITAL TRANSISTOR	
Q30			2SB1565	TRANSISTOR	
Q31			2SC4081	TRANSISTOR	
Q32			UMC2N	TRANSISTOR	
Q33			2SC4081	TRANSISTOR	
Q34			2SB1184	TRANSISTOR	
Q40			2SB1565	TRANSISTOR	
Q41			2SD2351(W)	TRANSISTOR	
Q42			UMD12N	TRANSISTOR	
Q43			2SD2351(W)	TRANSISTOR	
Q50			2SB1184	TRANSISTOR	
Q51			2SC4081	TRANSISTOR	
Q52			UMC2N	TRANSISTOR	
Q60			2SB1184	TRANSISTOR	
Q61			2SD2351(W)	TRANSISTOR	
Q70			2SB1449(R)-E	TRANSISTOR	
Q71			2SC5053	TRANSISTOR	
Q72			UMC2N	TRANSISTOR	
Q80			UMG2N	TRANSISTOR	
Q81,82			DTC143TUA	DIGITAL TRANSISTOR	

K : KDC-X891 (North America) M1 : KDC-X8006U (Other Areas)

△ Indicates safety critical components.

PARTS LIST

ELECTRIC UNIT (X34-4710-xx)

Ref. No.	Add	New	Parts No.	Description	Destination
Q100			2SB1188(R)	TRANSISTOR	
Q101			2SC4081	TRANSISTOR	
Q103-105			2SC4081	TRANSISTOR	
Q120			2SC4081	TRANSISTOR	
Q122,123			2SC4081	TRANSISTOR	
Q150			2SB1184	TRANSISTOR	
Q151			DTC114YUA	DIGITAL TRANSISTOR	
Q160			DTA123JK	DIGITAL TRANSISTOR	
Q180			DTC144EUA	DIGITAL TRANSISTOR	
Q350			2SB1184	TRANSISTOR	
Q351			2SC4081	TRANSISTOR	
Q352,353			2SA1576A	TRANSISTOR	
Q354			2SC4081	TRANSISTOR	
Q356,357			2SC4081	TRANSISTOR	
Q358			2SA1576A	TRANSISTOR	
Q361,362			DTA124EUA	DIGITAL TRANSISTOR	
Q363-368			DTC143TUA	DIGITAL TRANSISTOR	
Q400			2SB1689	TRANSISTOR	
Q401			DTC124EUA	DIGITAL TRANSISTOR	
Q500			DTC144EUA	DIGITAL TRANSISTOR	
Q501			2SA1576A	TRANSISTOR	
Q600			DTC114YUA	DIGITAL TRANSISTOR	
Q700			RT1P144M	TRANSISTOR	
Q704			RT1P144M	TRANSISTOR	
Q706			DTC114YUA	DIGITAL TRANSISTOR	
TH450			PRF18BE471QS2	POSITIVE RESISTOR	
A400			X86-4040-11	FRONT-END UNIT	

CD MECHANISM ASSY (X92-5870-00) (DXM-6C20W)

1	2B		A10-5328-11	CHASSIS	
2	1B		A10-5329-11	CHASSIS	
5	2B		D10-4910-13	ARM ASSY	
8	2A		D10-4911-13	LEVER ASSY	
10	2A		D10-4906-33	ARM	
11	2A		D10-4907-33	ARM	
12	3A		D10-4908-03	ARM	
13	3A		D10-4909-03	ARM	
14	3B		D10-4915-03	ARM	
15	2A		D10-4916-23	SLIDER	
16	3B		D10-4914-12	SLIDER	
17	2B		D10-4588-13	SLIDER	
18	2B		D10-4917-04	ARM	
19	2B		D10-4596-24	ARM	
22	2A		D13-2151-04	GEAR	
23	2B		D13-2152-04	GEAR	
24	3B		D13-2153-04	GEAR	
25	3B		D13-2154-04	GEAR	
26	3B		D13-2155-04	WORM	
27	2B		D13-2156-14	GEAR	
28	3B		D13-2157-04	GEAR	
29	2B		D13-2158-04	GEAR	
30	2B		D13-2168-04	GEAR	
31	3B		D13-2171-04	GEAR	
32	1B		D13-2400-13	RACK (GEAR)	

Ref. No.	Add	New	Parts No.	Description	Destination
33	2A		D14-0759-04	ROLLER	
35	2B		D21-2382-04	SHAFT	
36	1A		D23-0954-04	RETAINER	
37	1B		D39-0246-05	DAMPER	
38	2B		G01-3072-04	EXTENSION SPRING	
39	2A		G01-3073-04	TORSION COIL SPRING	
40	2A		G01-3074-04	EXTENSION SPRING	
41	1B		G01-4615-04	EXTENSION SPRING	
42	2A		G01-3076-04	EXTENSION SPRING	
43	1B		G01-3077-14	EXTENSION SPRING	
44	2B		G02-1399-04	FLAT SPRING	
45	2B		G02-1547-04	FLAT SPRING	
51	1A		J22-0473-21	MOUNTING HARDWARE	
52	3B		J22-0474-12	MOUNTING HARDWARE	
53	1B		J22-0519-03	MOUNTING HARDWARE	
55	1A		J90-1138-41	GUIDE	
56	1B		J90-1023-03	GUIDE	
DFPC1	3A	*	J86-0039-05	FPC (LEAD FREE)	
A	2B		N09-4460-15	TAPTITE SCREW (2X8 P-T)	
B	1B		N09-6317-05	TAPTITE SCREW	
C	2B		N09-6004-15	MACHINE SCREW (M1.7X2.5)	
E	2B		N09-6007-15	MACHINE SCREW (M2X2)	
F	1A		N09-6051-15	TAPTITE SCREW (2X5 P-T)	
G	2A		N19-2163-04	FLAT WASHER (1.6X6X0.25)	
H	1B		N39-2020-48	PAN HEAD MACHINE SCREW	
J	1B		N09-6108-15	TAPTITE SCREW (M2X3.5)	
K	3B		N09-6155-15	SEMS (TAPTITE SCREW) (2X6 P-T)	
DM1	3B		T42-1066-14	DC MOTOR ASSY (SP)	
DM2	2B		T42-1067-14	DC MOTOR ASSY (LO&SL)	
DPU1	2B		X93-2130-01	OPTICAL PICKUP ASSY	

K : KDC-X891 (North America) M1 : KDC-X8006U (Other Areas)

△ Indicates safety critical components.