

## EXPLODED VIEW

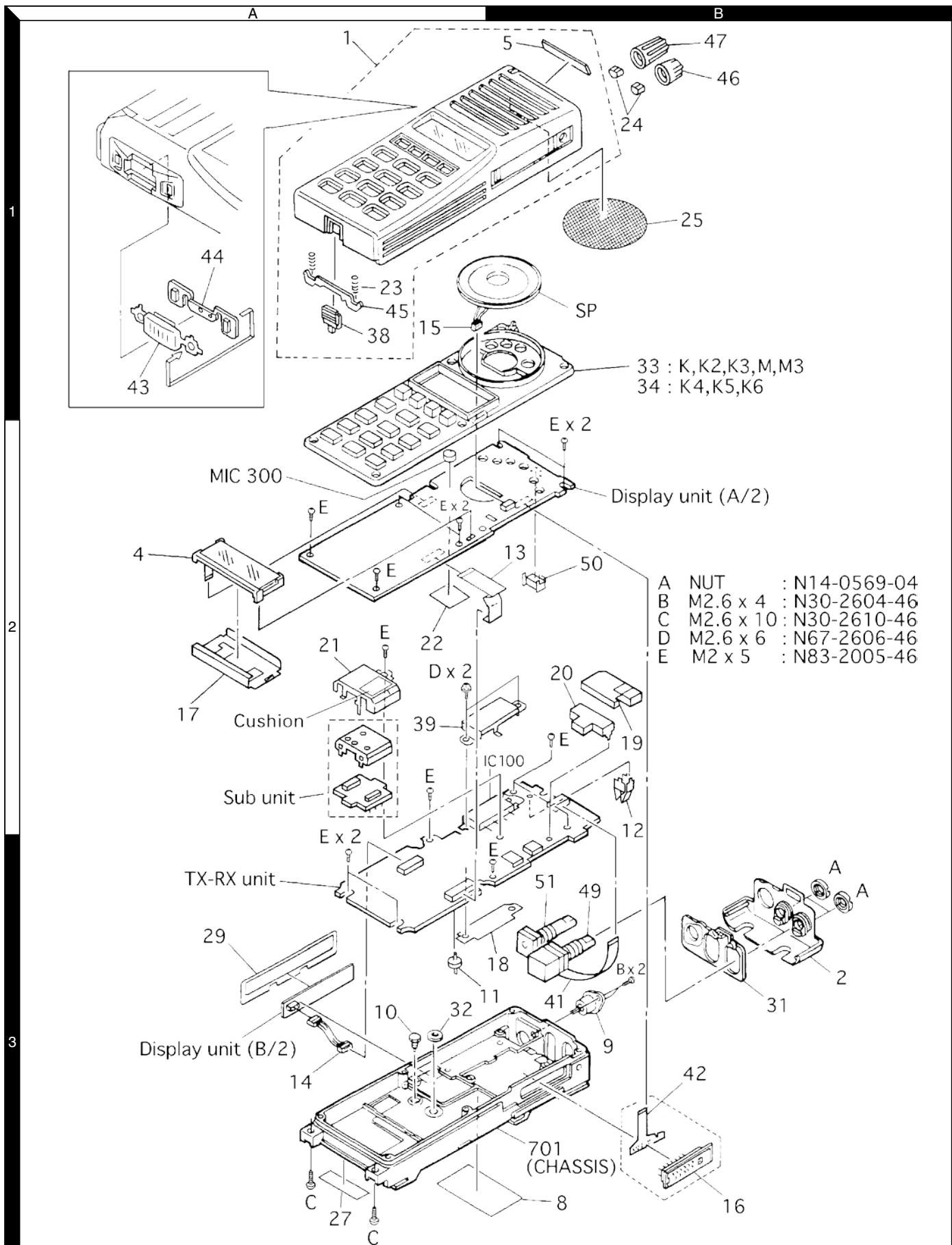

## PACKING

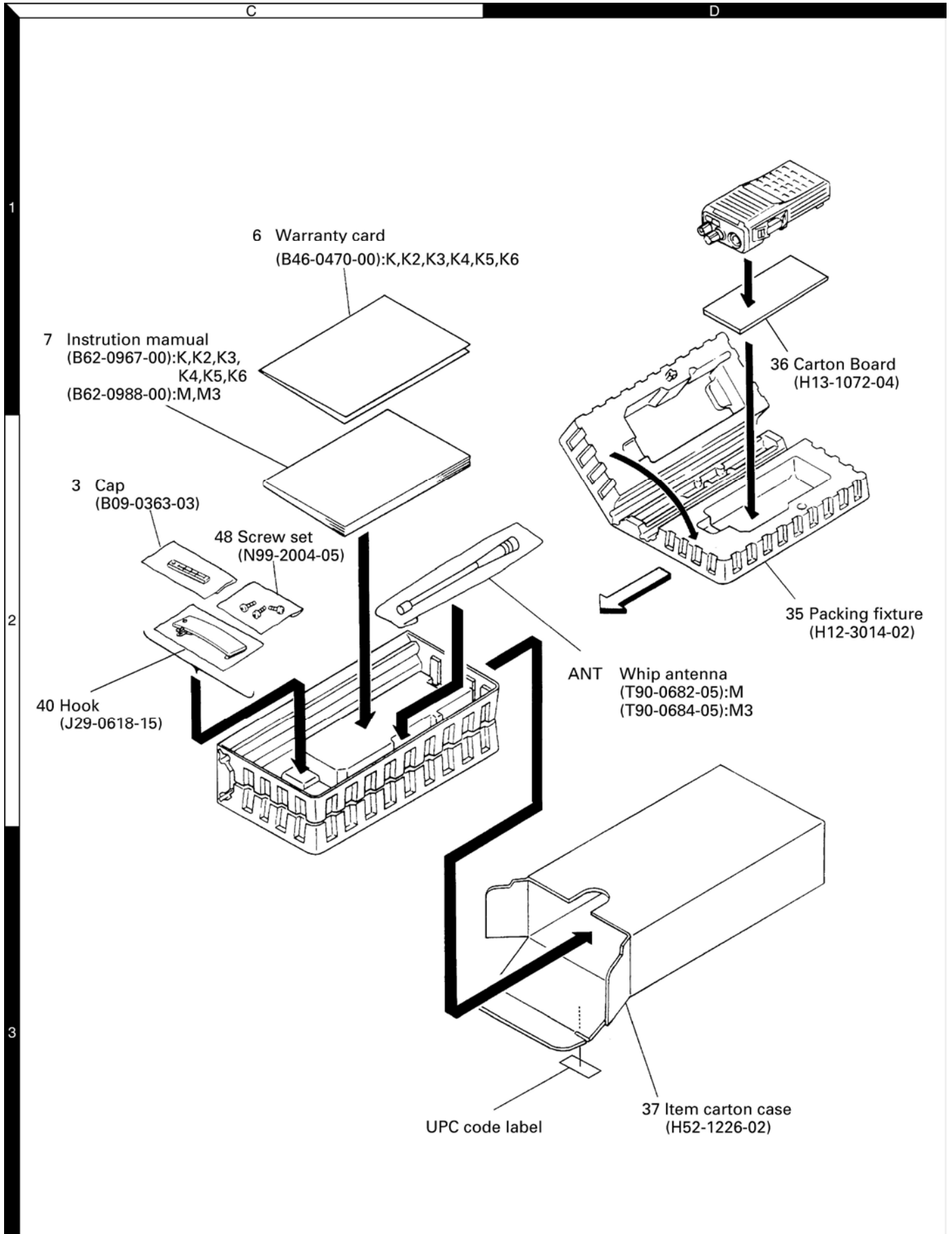

## PARTS LIST

\* New Parts.  $\Delta$  indicates safety critical components.  
 Parts without **Parts No.** are not supplied.  
 Les articles non mentionnés dans le **Parts No.** ne sont pas fournis.  
 Teile ohne **Parts No.** werden nicht geliefert.

L: Scandinavia      K: USA      P: Canada  
 Y: PX (Far East, Hawaii)      T: England      E: Europe  
 Y: AAFES (Europe)      X: Australia      M: Other Areas

TK-380

| Ref. No.                | Address | New parts | Parts No.   | Description                   | Destination      | Ref. No.  | Address | New parts | Parts No.     | Description                     | Destination |
|-------------------------|---------|-----------|-------------|-------------------------------|------------------|---|---------|-----------|---------------|---------------------------------|-------------|
| <b>TK-380 (Y50-488)</b> |         |           |             |                               |                  | 49  | 3B      |           | R31-0617-05   | VARIABLE R (POWER SW/VOL)       |             |
| 1                       | 1A      |           | A02-2054-53 | CABINET ASSY(4 KEYS)          | K,K2,K3,M,M3     | 50  | 2B      |           | S70-0414-05   | TACT SWITCH (AUX SW)            |             |
| 1                       | 1A      |           | A02-2055-53 | CABINET ASSY(16 KEYS)         | K4,K5,K6         | SP  | 1B      |           | T07-0347-05   | SPEAKER                         |             |
| 2                       | 3B      |           | A62-0535-04 | PANEL ASSY                    |                  | ANT   | 2D      |           | T90-0682-05   | WHIP ANTENNA ACSY               | M           |
| 3                       | 2C      |           | B09-0363-03 | CAP (SP/MIC) ACSY             |                  | ANT   | 2D      | *         | T90-0684-05   | WHIP ANTENNA ACSY               | M3          |
| 4                       | 2A      |           | B38-0810-05 | LCD ASSY                      |                  | MIC300  | 2A      |           | T91-0579-05   | MIC ELEMENT                     |             |
| 5                       | 1B      |           | B43-1106-14 | BADGE (KENWOOD)               |                  | IC100   | 2A      |           | M68732HA      | IC(P-MODULE (440-490MHz)        | K,K4,M      |
| 6                       | 1C      |           | B46-0470-00 | WARRANTY CARD ACSY            | K,K2,K3,K4,K5,K6 | IC100   | 2A      | *         | M68732SHA     | IC(P-MODULE (470-512MHz)        | K2,K5       |
| 7                       | 1C      |           | B62-0967-00 | INSTRUCTION MANUAL ACSY       | K,K2,K3,K4,K5,K6 | IC100   | 2A      | *         | M68732LA      | IC(P-MODULE (400-430MHz)        | K3,K6,M3    |
| 7                       | 1C      |           | B62-0988-00 | INSTRUCTION MANUAL ACSY       | M,M3             | 51  | 3B      |           | W02-1814-05   | ENCODER                         |             |
| 8                       | 3B      | *         | B72-1447-14 | MODEL NAME PLATE              | K,K4,M           | <b>DISPLAY UNIT (X54-3210-XX) -10:K,K2,K3,M,M3 -11:K4,K5,K6</b> |         |           |               |                                 |             |
| 8                       | 3B      | *         | B72-1448-04 | MODEL NAME PLATE              | K2,K5            | C301  |         |           | CC73GCH1H470J | CHIP C 47PF J                   |             |
| 8                       | 3B      | *         | B72-1449-14 | MODEL NAME PLATE              | K3,K6,M3         | C302  |         |           | C92-0560-05   | CHIP-TAN 10UF 6.3WV             |             |
| 9                       | 3B      |           | E04-0416-05 | RF COAXIAL RECEPTACLE(SMA)    |                  | C304  |         |           | CK73FB1C474K  | CHIP C 0.47UF K                 |             |
| 10                      | 3A      |           | E23-1048-05 | TERMINAL (BATT-)              |                  | C305  |         |           | CC73GCH1H101J | CHIP C 100PF J                  |             |
| 11                      | 3B      |           | E23-1101-05 | TERMINAL (BATT+)              |                  | C307  |         |           | CK73GB1C104K  | CHIP C 0.10UF K                 |             |
| 12                      | 2B      |           | E23-1104-04 | TERMINAL (ANT)                |                  | C308  |         |           | CC73GCH1H101J | CHIP C 100PF J                  |             |
| 13                      | 2B      |           | E37-0672-05 | FLAT CABLE                    |                  | C309  |         |           | CK73FB1C474K  | CHIP C 0.47UF K                 |             |
| 14                      | 3A      |           | E37-0673-05 | LEAD WIRE WITH CONNECTOR(PTT) |                  | C310  |         |           | CK73GB1C104K  | CHIP C 0.10UF K                 |             |
| 15                      | 1A      |           | E37-0674-05 | LEAD WIRE WITH CONNECTOR(SP)  |                  | C311  |         |           | CC73GCH1H470J | CHIP C 47PF J                   |             |
| 16                      | 3B      |           | E58-0440-05 | SQUARE SOCKET (SP/MIC)        |                  | C312  |         |           | CK73GB1C104K  | CHIP C 0.10UF K                 |             |
| 17                      | 2A      | *         | F10-2310-03 | SHIELDING PLATE(LCD)          |                  | C313  |         |           | C92-0628-05   | CHIP-TAN 10UF 10WV              |             |
| 18                      | 3B      |           | F10-2255-04 | SHIELDING PLATE(P-MODULE)     |                  | C314  |         |           | C92-0647-05   | TAN C 3.3UF 4WV                 |             |
| 19                      | 2B      |           | F10-2271-03 | SHIELDING CASE (FRONT END)    |                  | C315  |         |           | CC73GCH1H101J | CHIP C 100PF J                  |             |
| 20                      | 2B      |           | F10-2272-03 | SHIELDING CASE (DBM)          |                  | C316,317  |         |           | CC73GCH1H470J | CHIP C 47PF J                   |             |
| 21                      | 2A      | *         | F10-2274-13 | SHIELDING CASE (VCO-OUT)      |                  | C318  |         |           | CC73GCH1H101J | CHIP C 100PF J                  |             |
| 22                      | 2A      |           | F20-3303-04 | INSULATING SHEET(MIC/GND)     |                  | C321-333  |         |           | CC73GCH1H470J | CHIP C 47PF J                   |             |
| 23                      | 1A      |           | G01-0881-04 | COIL SPRING                   |                  | C335-339  |         |           | CC73GCH1H470J | CHIP C 47PF J                   |             |
| 24                      | 1B      |           | G09-0418-05 | KNOB SPRING (VOL,ENC)         |                  | C340  |         |           | CK73GB1E153K  | CHIP C 0.015UF K                |             |
| 25                      | 1B      |           | G10-0799-04 | FIBROUS SHEET (SP)            |                  | C341-344  |         |           | CC73GCH1H470J | CHIP C 47PF J                   |             |
| 27                      | 3A      |           | G11-2544-04 | SHEET (CHASSIS)               |                  | CN300   |         |           | E40-5891-05   | FLAT CABLE CONNECTOR(24P:TX-RX) |             |
| 29                      | 3A      | *         | G11-2590-04 | SHEET (PTT)                   |                  | CN301   |         |           | E40-5892-05   | FLAT CABLE CONNECTOR(14P)       |             |
| 31                      | 3B      |           | G53-0811-03 | PACKING (TOP)                 |                  | CN302   |         |           | E40-5662-05   | PIN ASSY SOCKET (SP)            |             |
| 32                      | 3A      |           | G53-0814-04 | PACKING (BATT +)              |                  | CN303   |         |           | E40-5887-05   | PIN ASSY (PTT)                  |             |
| 33                      | 1B      |           | G53-0840-02 | PACKING (4 KEYS)              | K,K2,K3,M,M3     | CN304   |         |           | E40-5823-05   | FLAT CABLE CONNECTOR(LCD)       |             |
| 34                      | 1B      |           | G53-0841-02 | PACKING (16 KEYS)             | K4,K5,K6         | L300,301  |         |           | L92-0141-05   | FERRITE CHIP                    |             |
| 35                      | 2D      |           | H12-3014-02 | PACKING FIXTURE               |                  | L302,303  |         |           | L92-0138-05   | FERRITE CHIP                    |             |
| 36                      | 1D      |           | H13-1072-04 | CARTON BOARD                  |                  | L304,305  |         |           | L92-0141-05   | FERRITE CHIP                    |             |
| 37                      | 3D      |           | H52-1226-02 | ITEM CARTON CASE              |                  | L306,307  |         |           | L92-0138-05   | FERRITE CHIP                    |             |
| 38                      | 1A      |           | J19-1572-04 | HOLDER                        |                  | L308,309  |         |           | L92-0141-05   | FERRITE CHIP                    |             |
| 39                      | 2A      | *         | J21-8380-03 | HARDWARE FIXTURE(P-MODULE)    |                  | CP300,301   |         |           | R90-0723-05   | MULTI-COMP 47K X2               |             |
| 40                      | 2C      |           | J29-0618-15 | HOOK ACSY                     |                  | CP302   |         |           | R90-0724-05   | MULTI-COMP 1K X4                |             |
| 41                      | 3B      |           | J82-0045-05 | FPC (VOL,ENC)                 |                  | CP303   |         |           | R90-0724-05   | MULTI-COMP 1K X4                |             |
| 42                      | 3B      | *         | J82-0066-05 | FPC (SQUARE SOCKET)           |                  | R300  |         |           | RK73GB1J103J  | CHIP R 10K J 1/16W              |             |
| 43                      | 1A      |           | K29-5157-03 | KNOB (PTT etc)                |                  | R301  |         |           | RK73FB2A101J  | CHIP R 100 J 1/10W              |             |
| 44                      | 1A      |           | K29-5158-03 | KEY TOP (PTT etc)             |                  | R302  |         |           | RK73GB1J470J  | CHIP R 47 J 1/16W               |             |
| 45                      | 1A      |           | K29-5165-03 | LEVER KNOB                    |                  | R303  |         |           | RK73GB1J471J  |                                 |             |
| 46                      | 1B      |           | K29-5231-03 | KNOB (VOL)                    |                  | R304  |         |           | RK73GB1J182J  | CHIP R 1.8K J 1/16W             |             |
| 47                      | 1B      |           | K29-5232-03 | KNOB (ENC)                    |                  | R305  |         |           | RK73GB1J104J  | CHIP R 100K J 1/16W             |             |
| A                       | 3B      |           | N14-0569-04 | CIRCULAR NUT (VOL,ENC)        |                  | R306  |         |           | R92-1252-05   | CHIP R 0 OHM                    |             |
| B                       | 3B      |           | N30-2604-46 | PAN HEAD MACHINE SCREW(ANT)   |                  | R307  |         |           | RK73GB1J821J  | CHIP R 820 J 1/16W              |             |
| C                       | 3A      |           | N30-2610-46 | PAN HEAD MACHINE SCREW(CASE)  |                  | R308  |         |           | RK73GB1J153J  | CHIP R 15K J 1/16W              |             |
| D                       | 2A      |           | N67-2606-46 | PAN HEAD SEMS SCREW(P-MODULE) |                  | R309  |         |           | R92-1252-05   | CHIP R 0 OHM                    |             |
| E                       | 2A      |           | N83-2005-46 | PAN HEAD TAPTITE SCREW(UNIT)  |                  | R310  |         |           | RK73GB1J331J  | CHIP R 330 J 1/16W              |             |
| 48                      | 2C      |           | N99-2004-05 | SCREW SET ACSY                |                  | R311  |         |           | RK73GB1J102J  | CHIP R 1.0K J 1/16W             |             |
|                         |         |           |             |                               |                  | R312  |         |           | RK73GB1J104J  | CHIP R 100K J 1/16W             |             |

## PARTS LIST

DISPLAY UNIT (X54-3210-XX)

TX-RX UNIT (X57-5750-XX)

| Ref. No.  | Address | New parts | Parts No.     | Description          | Destination | Ref. No. | Address | New parts | Parts No.     | Description          | Destination |
|---|---------|-----------|---------------|----------------------|-------------|----------|---------|-----------|---------------|----------------------|-------------|
| R313,314  |         |           | RK73GB1J102J  | CHIP R 1.0K J 1/16W  |             | C21      |         |           | C92-0592-05   | CHIP-TAN 4.7UF 6.3WV |             |
| R315  |         |           | RK73GB1J104J  | CHIP R 100K J 1/16W  |             | C22      |         |           | CK73GB1H331K  | CHIP C 330PF K       |             |
| R316  |         |           | RK73GB1J473J  | CHIP R 47K J 1/16W   |             | C23      |         |           | C92-0592-05   | CHIP-TAN 4.7UF 6.3WV |             |
| R317  |         |           | RK73GB1J472J  | CHIP R 4.7K J 1/16W  |             | C24, 25  |         |           | CK73GB1H471K  | CHIP C 470PF K       |             |
| R318  |         |           | RK73GB1J104J  | CHIP R 100K J 1/16W  |             | C26      |         |           | CK73GB1E223K  | CHIP C 0.022UF K     |             |
| R319  |         |           | RK73GB1J820J  | CHIP R 82 J 1/16W    |             | C27 -29  |         |           | CK73GB1H471K  | CHIP C 470PF K       |             |
| R320,321  |         |           | RK73GB1J820J  | CHIP R 82 J 1/16W    | K4,K5,K6    | C30      |         |           | CK73GB1H102K  | CHIP C 1000PF K      |             |
| R324  |         |           | RK73GB1J102J  | CHIP R 1.0K J 1/16W  |             | C31      |         |           | CK73GB1C104K  | CHIP C 0.10UF K      |             |
| R325  |         |           | RK73GB1J102J  | CHIP R 1.0K J 1/16W  | K4,K5,K6    | C32      |         |           | CK73FB1A105K  | CHIP C 1.0UF K       |             |
| R326  |         |           | RK73GB1J124J  | CHIP R 120K J 1/16W  |             | C33, 34  |         |           | CK73GB1H471K  | CHIP C 470PF K       |             |
| R327  |         |           | RK73GB1J563J  | CHIP R 56K J 1/16W   |             | C35      |         |           | CK73GB1E103K  | CHIP C 0.010UF K     |             |
| R328  |         |           | RK73GB1J124J  | CHIP R 120K J 1/16W  |             | C36      |         |           | CK73GB1C104K  | CHIP C 0.10UF K      |             |
| R331  |         |           | RK73GB1J103J  | CHIP R 10K J 1/16W   |             | C37      |         |           | CK73GB1H471K  | CHIP C 470PF K       |             |
| R332  |         |           | RK73GB1J272J  | CHIP R 2.7K J 1/16W  |             | C38      |         |           | CK73GB1H102K  | CHIP C 1000PF K      |             |
| R333  |         |           | RK73GB1J103J  | CHIP R 10K J 1/16W   |             | C39, 40  |         |           | CK73GB1C104K  | CHIP C 0.10UF K      |             |
| R336  |         |           | R92-1252-05   | CHIP R 0 OHM         |             | C41      |         |           | C92-0713-05   | TAN C 10UF 6.3WV     |             |
| R337  |         |           | RK73GB1J472J  | CHIP R 4.7K J 1/16W  |             | C42      |         |           | CK73GB1H102K  | CHIP C 1000PF K      |             |
| R338-341  |         |           | RK73GB1J101J  | CHIP R 100 J 1/16W   |             | C43      |         |           | CK73GB1C333K  | CHIP C 0.033UF K     |             |
| S301-303  |         |           | S70-0457-05   | TACT SWITCH (PTT)    |             | C44      |         |           | CK73GB1H471K  | CHIP C 470PF K       |             |
| D300  |         |           | NNCD6.8G      | ZENER DIODE          |             | C45      |         |           | CC73GCH1H100D | CHIP C 10PF D        |             |
| D301  |         |           | B30-2019-05   | LED(RE/GR)           |             | C46      |         |           | CC73GCH1H121J | CHIP C 120PF J       |             |
| D302  |         |           | 1SS373        | DIODE                |             | C47      |         |           | CK73GB1C104K  | CHIP C 0.10UF K      |             |
| D303  |         |           | 015AZ2.4-X    | ZENER DIODE          |             | C48      |         |           | CK73GB1H471K  | CHIP C 470PF K       |             |
| D304  |         |           | MA2S111       | DIODE                |             | C49      |         |           | CK73GB1C104K  | CHIP C 0.10UF K      |             |
| D305,306  |         |           | B30-2171-05   | LED(1608/D/8)        |             | C50      |         |           | CC73GCH1H100D | CHIP C 10PF D        |             |
| D307-310  |         |           | B30-2171-05   | LED(1608/D/8)        | K4,K5,K6    | C51      |         |           | CK73GB1E103K  | CHIP C 0.010UF K     |             |
| D315  |         |           | IMN10         | DIODE                | K4,K5,K6    | C52      |         |           | CC73GCH1H271J | CHIP C 270PF J       |             |
| D316  |         |           | MA2S111       | DIODE                | K4,K5,K6    | C53      |         |           | CK73GB1H102K  | CHIP C 1000PF K      |             |
| D317  |         |           | MA2S111       | DIODE                |             | C54      |         |           | CK73GB1E103K  | CHIP C 0.010UF K     |             |
| D318  |         |           | IMN10         | DIODE                |             | C55      |         |           | CK73GB1C104K  | CHIP C 0.10UF K      |             |
| D319-321  |         |           | 015AZ6.8      | ZENER DIODE          |             | C56      |         |           | C92-0662-05   | TAN C 15UF 6.3WV     |             |
| IC300   |         |           | TDA7053AT     | IC(AUDIO AMP)        |             | C57      |         |           | CK73GB1H472K  | CHIP C 4700PF K      |             |
| IC301   |         |           | MC74HC4017F   | IC(GATE CMOS)        |             | C58      |         |           | CK73GB1H471K  | CHIP C 470PF K       |             |
| Q300  |         |           | 2SJ243        | FET                  |             | C59      |         |           | CK73GB1H222K  | CHIP C 2200PF K      |             |
| Q301  |         |           | UPA672T       | FET                  |             | C60      |         |           | CK73GB1C273K  | CHIP C 0.027UF K     |             |
| Q302-304  |         |           | 2SC4617(S)    | TRANSISTOR           |             | C61      |         |           | CK73GB1C104K  | CHIP C 0.10UF K      |             |
| Q305  |         |           | 2SB798(DL,DK) | TRANSISTOR           |             | C62      |         |           | CK73GB1E123K  | CHIP C 0.012UF K     |             |
| Q306  |         |           | 2SC4617(S)    | TRANSISTOR           |             | C63      |         |           | CK73GB1H122K  | CHIP C 1200PF K      |             |
| Q307  |         |           | 2SB1132(Q,R)  | TRANSISTOR           |             | C64      |         |           | CK73GB1H102K  | CHIP C 1000PF K      |             |
| Q308  |         |           | UPA672T       | FET                  |             | C65, 66  |         |           | CC73GCH1H680J | CHIP C 68PF J        |             |
| Q309  |         |           | 2SC4617(S)    | TRANSISTOR           |             | C67      |         |           | CK73GB1C104K  | CHIP C 0.10UF K      |             |
| Q310  |         |           | 2SK1824       | FET                  |             | C68, 69  |         |           | CK73GB1E103K  | CHIP C 0.010UF K     |             |
| TH300   |         |           | TN10-3S154JT  | THERMISTOR           |             | C70      |         |           | CK73GB1C104K  | CHIP C 0.10UF K      |             |
| <b>TX-RX UNIT (X57-5750-XX) -10:K,K4,M -11:K2,K5 -12:K3,K6,M3</b> |         |           |               |                      |             | C71      |         |           | CC73GCH1H220J | CHIP C 22PF J        |             |
| C1  |         |           | CK73GB1H471K  | CHIP C 470PF K       |             | C72      |         |           | CK73GB1C683K  | CHIP C 0.068UF K     |             |
| C2, 3   |         |           | CK73GB1E103K  | CHIP C 0.010UF K     |             | C73      |         |           | CC73GCH1H100D | CHIP C 10PF D        |             |
| C4 -6   |         |           | CK73GB1H471K  | CHIP C 470PF K       |             | C74      |         |           | CK73GB1C104K  | CHIP C 0.10UF K      |             |
| C7  |         |           | CK73GB1C104K  | CHIP C 0.10UF K      |             | C75      |         |           | CK73GB1E103K  | CHIP C 0.010UF K     |             |
| C8  |         |           | CK73GB1H103K  | CHIP C 0.010UF K     |             | C76      |         |           | CK73GB1C104K  | CHIP C 0.10UF K      |             |
| C9  |         |           | CK73GB1C104K  | CHIP C 0.10UF K      |             | C77      |         |           | C92-0662-05   | TAN C 15UF 6.3WV     |             |
| C10   |         |           | CK73GB1E103K  | CHIP C 0.010UF K     |             | C78      |         |           | CK73GB1H562J  | CHIP C 5600PF J      |             |
| C11   |         |           | CK73GB1H471K  | CHIP C 470PF K       |             | C79      |         |           | C92-0713-05   | TAN C 10UF 6.3WV     |             |
| C12   |         |           | CK73GB1E103K  | CHIP C 0.010UF K     |             | C81      |         |           | CK73GB1H471K  | CHIP C 470PF K       |             |
| C13   |         |           | CC73GCH1H101J | CHIP C 100PF J       |             | C82      |         |           | CK73GB1C333K  | CHIP C 0.033UF K     |             |
| C14   |         |           | C92-0628-05   | CHIP-TAN 10UF 10WV   |             | C84      |         |           | CK73GB1H562J  | CHIP C 5600PF J      |             |
| C15   |         |           | C92-0592-05   | CHIP-TAN 4.7UF 6.3WV |             | C85      |         |           | CK73GB1H471K  | CHIP C 470PF K       |             |
| C16   |         |           | CK73GB1H471K  | CHIP C 470PF K       |             | C86      |         |           | CK73GB1H562J  | CHIP C 5600PF J      |             |
| C17   |         |           | C92-0628-05   | CHIP-TAN 10UF 10WV   |             | C87      |         |           | CK73GB1C333K  | CHIP C 0.033UF K     |             |
| C18   |         |           | CK73FB1C334K  | CHIP C 0.33UF K      |             | C88      |         |           | CK73GB1C104K  | CHIP C 0.10UF K      |             |
| C19   |         |           | C92-0628-05   | CHIP-TAN 10UF 10WV   |             | C89      |         |           | CC73GCH1H820J | CHIP C 82PF J        |             |
| C20   |         |           | CK73GB1C104K  | CHIP C 0.10UF K      |             | C91      |         |           | CK73GB1H471K  | CHIP C 470PF K       |             |
| C92   |         |           | C92-0662-05   | TAN C 15UF 6.3WV     |             |          |         |           |               |                      |             |

## PARTS LIST

TX-RX UNIT (X57-5750-XX)

| Ref. No. | Address | New parts | Parts No.     | Description          | Destination     | Ref. No. | Address | New parts | Parts No.     | Description         | Destination     |
|----------|---------|-----------|---------------|----------------------|-----------------|----------|---------|-----------|---------------|---------------------|-----------------|
| C93      |         |           | CK73GB1H272J  | CHIP C 2700PF J      |                 | C171     |         |           | CC73GCH1H070B | CHIP C 7.0PF B      | K,K3,K4,K6,M,M3 |
| C95      |         |           | CK73GB1H471K  | CHIP C 470PF K       |                 | C171     |         |           | CC73GCH1H090B | CHIP C 9.0PF B      | K2,K5           |
| C96      |         |           | CC73GCH1H330J | CHIP C 33PF J        |                 | C172     |         |           | CC73GCH1H050B | CHIP C 5.0PF B      | K,K2,K4,K5,M    |
| C97      |         |           | CC73GCH1H030B | CHIP C 3.0PF B       |                 | C172     |         |           | CC73GCH1H060B | CHIP C 6.0PF B      | K3,K6,M3        |
| C98,99   |         |           | CK73GB1H272J  | CHIP C 2700PF J      |                 | C173     |         |           | CK73GB1H471K  | CHIP C 470PF K      |                 |
| C100-102 |         |           | CK73GB1C104K  | CHIP C 0.10UF K      |                 | C174     |         |           | CK73GB1C104K  | CHIP C 0.10UF K     |                 |
| C103     |         |           | CC73GCH1H151J | CHIP C 150PF J       |                 | C175     |         |           | CK73GB1H472K  | CHIP C 4700PF K     |                 |
| C104     |         |           | CK73GB1H152J  | CHIP C 1500PF J      |                 | C176-180 |         |           | CK73GB1H471K  | CHIP C 470PF K      |                 |
| C105     |         |           | CK73GB1H102K  | CHIP C 1000PF K      |                 | C181     |         |           | CK73GB1E103K  | CHIP C 0.010UF K    |                 |
| C106     |         |           | CK73GB1E103K  | CHIP C 0.010UF K     |                 | C182     |         |           | CC73GCH1H060B | CHIP C 6.0PF B      |                 |
| C107     |         |           | CC73GCH1H030B | CHIP C 3.0PF B       |                 | C183     |         |           | CC73GCH1H270J | CHIP C 27PF J       |                 |
| C108     |         |           | C92-0635-05   | TAN C 10UF 6.3WV     |                 | C184     |         |           | CC73GCH1H680J | CHIP C 68PF J       |                 |
| C109     |         |           | C92-0714-05   | TAN C 4.7UF 6.3WV    |                 | C185     |         |           | CK73GB1H471K  | CHIP C 470PF K      |                 |
| C110     |         |           | CK73GB1C104K  | CHIP C 0.10UF K      |                 | C186     |         |           | CC73GCH1H270J | CHIP C 27PF J       |                 |
| C111     |         |           | CK73GB1H471K  | CHIP C 470PF K       |                 | C188,189 |         |           | CK73GB1H471K  | CHIP C 470PF K      |                 |
| C112     |         |           | C92-0713-05   | TAN C 10UF 6.3WV     |                 | C190     |         |           | CK73HB1C103K  | CHIP C 0.010UF K    |                 |
| C113,114 |         |           | CK73GB1C104K  | CHIP C 0.10UF K      |                 | C191,192 |         |           | CK73GB1H471K  | CHIP C 470PF K      |                 |
| C115     |         |           | CK73GB1H471K  | CHIP C 470PF K       |                 | C193     |         |           | CC73GCH1H100D | CHIP C 10PF D       |                 |
| C117,118 |         |           | CK73GB1C104K  | CHIP C 0.10UF K      |                 | C194     |         |           | CC73GCH1H4R5B | CHIP C 4.5PF B      | K,K4,M          |
| C119     |         |           | CC73GCH1H181J | CHIP C 180PF J       |                 | C194     |         |           | CC73GCH1H040B | CHIP C 4.0PF B      | K2,K5           |
| C120     |         |           | CK73GB1C473K  | CHIP C 0.047UF K     |                 | C194     |         |           | CC73GCH1H3R5B | CHIP C 3.5PF B      | K3,K6,M3        |
| C121,122 |         |           | CK73GB1C104K  | CHIP C 0.10UF K      |                 | C195     |         |           | CK73GB1H471K  | CHIP C 470PF K      |                 |
| C123     |         |           | CK73GB1E103K  | CHIP C 0.010UF K     |                 | C196     |         |           | CC73GCH1H390J | CHIP C 39PF J       | K,K4,M          |
| C124,125 |         |           | CK73GB1C104K  | CHIP C 0.10UF K      |                 | C196     |         |           | CC73GCH1H040B | CHIP C 4.0PF B      | K2,K5           |
| C126     |         |           | C92-0519-05   | CHIP-TAN 1.0UF 25WV  |                 | C196     |         |           | CC73GCH1H080J | CHIP C 8.0PF B      | K3,K6,M3        |
| C127     |         |           | C92-0592-05   | CHIP-TAN 4.7UF 6.3WV |                 | C197     |         |           | CK73FB1C474K  | CHIP C 0.47UF K     |                 |
| C128     |         |           | CK73GB1C104K  | CHIP C 0.10UF K      |                 | C198     |         |           | CC73GCH1H070B | CHIP C 7.0PF B      | K,K4,M          |
| C129     |         |           | CK73GB1H562J  | CHIP C 5600PF J      |                 | C198     |         |           | CC73GCH1H1R5B | CHIP C 1.5PF B      | K2,K5           |
| C130     |         |           | CK73GB1H102K  | CHIP C 1000PF K      |                 | C198     |         |           | CC73GCH1H010B | CHIP C 1.0PF B      | K3,K6,M3        |
| C131     |         |           | CK73GB1H562J  | CHIP C 5600PF J      |                 | C199     |         |           | CC73GCH1H101J | CHIP C 100PF J      |                 |
| C133     |         |           | CC73GCH1H050B | CHIP C 5.0PF B       |                 | C200     |         |           | C92-0565-05   | CHIP-TAN 6.8UF 10WV |                 |
| C134     |         |           | CK73GB1E153K  | CHIP C 0.015UF K     |                 | C201     |         |           | CC73GCH1H2R5B | CHIP C 2.5PF B      | K,K4,M          |
| C135     |         |           | CK73GB1E103K  | CHIP C 0.010UF K     |                 | C201     |         |           | CC73GCH1H050B | CHIP C 5.0PF B      | K3,K6,M3        |
| C136     |         |           | CK73GB1E473J  | CHIP C 0.047UF J     |                 | C202     |         |           | CK73GB1H471K  | CHIP C 470PF K      |                 |
| C137     |         |           | CK73GB1E103K  | CHIP C 0.010UF K     |                 | C203     |         |           | CC73GCH1H050B | CHIP C 5.0PF B      | K,K2,K4,K5,M    |
| C138     |         |           | CC73GCH1H030B | CHIP C 3.0PF B       |                 | C203     |         |           | CC73GCH1H100C | CHIP C 10PF C       | K3,K6,M3        |
| C139     |         |           | CK73GB1H471K  | CHIP C 470PF K       |                 | C204     |         |           | CC73GCH1H0R5B | CHIP C 0.5PF B      |                 |
| C140     |         |           | CC73GCH1H050B | CHIP C 5.0PF B       |                 | C205     |         |           | CC73GCH1H101J | CHIP C 100PF J      |                 |
| C141     |         |           | C92-0592-05   | CHIP-TAN 4.7UF 6.3WV |                 | C206     |         |           | CC73GCH1H020B | CHIP C 2.0PF B      | K3,K6,M3        |
| C142     |         |           | CK73GB1H471K  | CHIP C 470PF K       |                 | C207     |         |           | CC73GCH1H030B | CHIP C 3.0PF B      | K,K4,M          |
| C143     |         |           | CC73GCH1H100D | CHIP C 10PF D        |                 | C207     |         |           | CC73GCH1H3R5B | CHIP C 3.5PF B      | K2,K5           |
| C144     |         |           | C92-0714-05   | TAN C 4.7UF 6.3WV    |                 | C207     |         |           | CC73GCH1H060B | CHIP C 6.0PF B      | K3,K6,M3        |
| C145     |         |           | CK73FB1H563K  | CHIP C 0.056UF K     |                 | C208     |         |           | CK73GB1E103K  | CHIP C 0.010UF K    |                 |
| C146,147 |         |           | CK73GB1H102K  | CHIP C 1000PF K      |                 | C208     |         |           | CK73GB1H471K  | CHIP C 470PF K      |                 |
| C149     |         |           | CK73GB1H471K  | CHIP C 470PF K       |                 | C210     |         |           | CC73GCH1H020B | CHIP C 2.0PF B      | K,K4,M          |
| C150     |         |           | CC73GCH1H050B | CHIP C 5.0PF B       |                 | C210     |         |           | CC73GCH1H3R5B | CHIP C 3.5PF B      | K2,K3,K5,K6,M3  |
| C152     |         |           | CC73GCH1H330J | CHIP C 33PF J        |                 | C211     |         |           | CK73FB1C474K  | CHIP C 0.47UF K     |                 |
| C154     |         |           | CK73GB1C104K  | CHIP C 0.10UF K      |                 | C212     |         |           | CC73GCH1H150J | CHIP C 15PF J       | K3,K6,M3        |
| C155     |         |           | CK73GB1H471K  | CHIP C 470PF K       |                 | C213     |         |           | CC73GCH1H101J | CHIP C 100PF J      |                 |
| C157     |         |           | CK73GB1H471K  | CHIP C 470PF K       |                 | C214     |         |           | CC73GCH1H020B | CHIP C 2.0PF B      | K,K3,K4,K6,M,M3 |
| C159     |         |           | CK73HB1C103K  | CHIP C 0.010UF K     |                 | C214     |         |           | CC73GCH1H060B | CHIP C 6.0PF B      | K2,K5           |
| C160     |         |           | CK73GB1C104K  | CHIP C 0.10UF K      |                 | C215     |         |           | CC73GCH1H060B | CHIP C 6.0PF B      | K,K2,K4,K5,M    |
| C161     |         |           | CC73GCH1H040B | CHIP C 4.0PF B       |                 | C215     |         |           | CC73GCH1H070B | CHIP C 7.0PF B      | K3,K6,M3        |
| C162     |         |           | CK73GB1H471K  | CHIP C 470PF K       |                 | C216     |         |           | CC73GCH1H4R5B | CHIP C 4.5PF B      | K,K2,K4,K5,M    |
| C163     |         |           | CK73GB1C104K  | CHIP C 0.10UF K      |                 | C216     |         |           | CC73GCH1H050B | CHIP C 5.0PF B      | K3,K6,M3        |
| C165     |         |           | CK73GB1E103K  | CHIP C 0.010UF K     |                 | C217     |         |           | CC73GCH1H040B | CHIP C 4.0PF B      | K,K2,K4,K5,M    |
| C166     |         |           | CK73HB1C103K  | CHIP C 0.010UF K     |                 | C217     |         |           | CC73GCH1H050B | CHIP C 5.0PF B      | K3,K6,M3        |
| C167     |         |           | CC73GCH1H040B | CHIP C 4.0PF B       |                 | C218     |         |           | CC73GCH1H120J | CHIP C 12PF J       |                 |
| C168     |         |           | CC73GCH1H120J | CHIP C 12PF J        | K,K3,K4,K6,M,M3 | C219     |         |           | CC73GCH1H4R5B | CHIP C 4.5PF B      | K,K4,M          |
| C168     |         |           | CC73GCH1H070B | CHIP C 7.0PF B       | K2,K5           | C219     |         |           | CC73GCH1H040B | CHIP C 4.0PF B      | K2,K5           |
| C169     |         |           | CK73GB1E103K  | CHIP C 0.010UF K     |                 | C219     |         |           | CC73GCH1H030B | CHIP C 3.0PF B      | K3,K6,M3        |
| C170     |         |           | CK73HB1C103K  | CHIP C 0.010UF K     |                 | C220     |         |           | CC73GCH1H050B | CHIP C 5.0PF B      |                 |

## PARTS LIST

TX-RX UNIT (X57-5750-XX)

| Ref. No. | Address | New parts | Parts No.     | Description                   | Destination  | Ref. No. | Address | New parts | Parts No.    | Description                    | Destination    |
|----------|---------|-----------|---------------|-------------------------------|--------------|----------|---------|-----------|--------------|--------------------------------|----------------|
| C221     |         |           | CK73GB1H471K  | CHIP C 470PF K                |              | L13      |         |           | L40-2271-36  | SMALL FIXED INDUCTOR(22NH/8)   |                |
| C222     |         |           | CC73GCH1H030B | CHIP C 3.0PF B                | K,K4,M       | L14      |         |           | L40-1081-36  | SMALL FIXED INDUCTOR(100NH)    |                |
| C222     |         |           | CC73GCH1H4R5B | CHIP C 4.5PF B                | K2,K5        | L15      |         |           | L40-1571-36  | SMALL FIXED INDUCTOR(15NH/8)   |                |
| C222     |         |           | CC73GCH1H3R5B | CHIP C 3.5PF B                | K3,K6,M3     | L17      |         |           | L40-1571-36  | SMALL FIXED INDUCTOR(15NH/8)   |                |
| C223     |         |           | CC73GCH1H030B | CHIP C 3.0PF B                |              | L18      |         |           | L39-1272-05  | TOROIDAL COIL                  |                |
| C224     |         |           | CC73GCH1H0R5B | CHIP C 0.5PF B                | K3,K6,M3     | L19      |         |           | L92-0138-05  | FERRITE CHIP                   |                |
| C225     |         |           | CC73GCH1H101J | CHIP C 100PF J                |              | L20      |         |           | L40-1571-36  | SMALL FIXED INDUCTOR(15NH/8)   |                |
| C226     |         |           | CK73GB1H471K  | CHIP C 470PF K                |              | L21 ,22  |         |           | L39-1272-05  | TOROIDAL COIL                  |                |
| C227     |         |           | CC73GCH1H1R5B | CHIP C 1.5PF B                | K3,K6,M3     | L24      |         |           | L92-0138-05  | FERRITE CHIP                   |                |
| C230     |         |           | CC73GCH1H010B | CHIP C 1.0PF B                | K,K2,K4,K5,M | L25      |         |           | L40-2771-36  | SMALL FIXED INDUCTOR(27NH/8)   |                |
| C230     |         |           | CC73GCH1H1R5B | CHIP C 1.5PF B                | K3,K6,M3     | L26      |         |           | L92-0138-05  | FERRITE CHIP                   |                |
| C231     |         |           | CK73GB1H471K  | CHIP C 470PF K                |              | L27      |         |           | L40-3378-67  | SMALL FIXED INDUCTOR(33NH/8)   | K,K2,K4,K5,M   |
| C232     |         |           | CC73GCH1H470J | CHIP C 47PF J                 |              | L27      | *       |           | L40-4778-67  | SMALL FIXED INDUCTOR(47NH/8)   | K3,K6,M3       |
| C233     |         |           | CK73GB1H471K  | CHIP C 470PF K                |              | L28      |         |           | L92-0138-05  | FERRITE CHIP                   |                |
| C234     |         |           | CC73GCH1H100D | CHIP C 10PF D                 |              | L29      |         |           | L40-1578-67  | SMALL FIXED INDUCTOR(15NH/8)   | K,K4,M         |
| C236     |         |           | CC73GCH1H470J | CHIP C 47PF J                 |              | L29      | *       |           | L40-1278-67  | SMALL FIXED INDUCTOR(12NH/8)   | K2,K3,K5,K6,M3 |
| C237     |         |           | CC73GCH1H010B | CHIP C 1.0PF B                | K,K2,K4,K5,M | L30      |         |           | L92-0149-05  | FERRITE CHIP                   |                |
| C237     |         |           | CC73GCH1H1R5B | CHIP C 1.5PF B                | K3,K6,M3     | L31      |         |           | L40-1878-67  | SMALL FIXED INDUCTOR(18NH/8)   | K,K4,M         |
| C238     |         |           | CK73GB1E103K  | CHIP C 0.010UF K              |              | L31      |         |           | L40-1578-67  | SMALL FIXED INDUCTOR(15NH/8)   | K2,K3,K5,K6,M3 |
| C239     |         |           | CK73GB1H471K  | CHIP C 470PF K                |              | L32      |         |           | L34-4564-05  | AIR-CORE COIL (4T)             |                |
| C241     |         |           | CC73GCH1H130J | CHIP C 13PF J                 | K,K2,K4,K5,M | L33      |         |           | L40-2278-67  | SMALL FIXED INDUCTOR(22NH/8)   | K,K2,K4,K5,M   |
| C241     |         |           | CC73GCH1H120J | CHIP C 12PF J                 | K3,K6,M3     | L33      |         |           | L40-3978-67  | SMALL FIXED INDUCTOR(39NH/8)   | K3,K6,M3       |
| C242,243 |         |           | CK73GB1H471K  | CHIP C 470PF K                |              | L34      |         |           | L40-3378-67  | SMALL FIXED INDUCTOR(33NH/8)   | K,K2,K4,K5,M   |
| C245     |         |           | CC73GCH1H3R5B | CHIP C 3.5PF B                | K,K4,M       | L34      | *       |           | L40-4778-67  | SMALL FIXED INDUCTOR(47NH/8)   | K3,K6,M3       |
| C245     |         |           | CC73GCH1H030B | CHIP C 3.0PF B                | K2,K5        | L35      |         |           | L40-1085-34  | SMALL FIXED INDUCTOR(100NH/8)  |                |
| C245     |         |           | CC73GCH1H020B | CHIP C 2.0PF B                | K3,K6,M3     | L36      |         |           | L40-3378-67  | SMALL FIXED INDUCTOR(33NH/8)   | K,K2,K4,K5,M   |
| C247     |         |           | CK73GB1H471K  | CHIP C 470PF K                |              | L36      | *       |           | L40-5678-67  | SMALL FIXED INDUCTOR(56NH/8)   | K3,K6,M3       |
| C248     |         |           | CC73GCH1H1R5B | CHIP C 1.5PF B                | K,K2,K4,K5,M | L37      |         |           | L34-4564-05  | AIR-CORE COIL (4T)             |                |
| C248     |         |           | CC73GCH1H2R5B | CHIP C 2.5PF B                | K3,K6,M3     | L38      |         |           | L40-1878-67  | SMALL FIXED INDUCTOR(18NH/8)   | K,K4,M         |
| C249-253 |         |           | CK73GB1H471K  | CHIP C 470PF K                |              | L38      |         |           | L40-2278-67  | SMALL FIXED INDUCTOR(22NH/8)   | K2,K3,K5,K6,M3 |
| C254     |         |           | CC73GCH1H050B | CHIP C 5.0PF B                | K,K2,K4,K5,M | L39      |         |           | L40-1871-36  | SMALL FIXED INDUCTOR(18NH/8)   |                |
| C254     |         |           | CC73GCH1H060B | CHIP C 6.0PF B                | K3,K6,M3     | L40      |         |           | L34-4564-05  | AIR-CORE COIL (4T)             |                |
| C255     |         |           | CC73GCH1H020B | CHIP C 2.0PF B                |              | L41      |         |           | L40-1071-36  | SMALL FIXED INDUCTOR(10NH/8)   |                |
| C256     |         |           | CC73GCH1H050B | CHIP C 5.0PF B                | K,K2,K4,K5,M | L42 ,43  |         |           | L34-4564-05  | AIR-CORE COIL (4T)             |                |
| C256     |         |           | CC73GCH1H060B | CHIP C 6.0PF B                | K3,K6,M3     | L44      |         |           | L40-2278-67  | SMALL FIXED INDUCTOR(22NH/8)   | K,K4,M         |
| C257,258 |         |           | CK73GB1H471K  | CHIP C 470PF K                |              | L44      |         |           | L40-1878-67  | SMALL FIXED INDUCTOR(18NH/8)   | K2,K5          |
| C259     |         |           | CC73GCH1H101J | CHIP C 100PF J                |              | L44      | *       |           | L40-2778-67  | SMALL FIXED INDUCTOR(27NH/8)   | K3,K6,M3       |
| C261,262 |         |           | CK73HB1C103K  | CHIP C 0.010UF K              |              | L45      |         |           | L40-1092-81  | SMALL FIXED INDUCTOR           |                |
| C263     |         |           | CK73GB1H103K  | CHIP C 0.010UF K              |              | L46      |         |           | L40-6878-67  | SMALL FIXED INDUCTOR(68NH/8)   | K,K2,K4,K5,M   |
| C264     |         |           | CC73GCH1H150J | CHIP C 15PF J                 |              | L46      |         |           | L40-8278-67  | SMALL FIXED INDUCTOR(82NH/8)   | K3,K6,M3       |
| C265     |         |           | CK73GB1H103K  | CHIP C 0.010UF K              |              | L47      |         |           | L40-3378-67  | SMALL FIXED INDUCTOR(33NH/8)   | K,K4,M         |
| C269     |         |           | CC73GCH1H030B | CHIP C 3.0PF B                |              | L48 -52  |         |           | L34-4564-05  | AIR-CORE COIL (4T)             |                |
| C276     |         |           | CC73GCH1H2R5B | CHIP C 2.5PF B                | K,K4,M       | L53      |         |           | L92-0138-05  | FERRITE CHIP                   |                |
| C276     |         |           | CC73GCH1H070B | CHIP C 7.0PF B                | K2,K5        | L54 -56  |         |           | L40-2771-36  | SMALL FIXED INDUCTOR(27NH/8)   | K,K4,M         |
| C276     |         |           | CC73GCH1H050B | CHIP C 5.0PF B                | K3,K6,M3     | L54 -56  |         |           | L40-2771-36  | SMALL FIXED INDUCTOR(22NH/8)   | K2,K5          |
| CN1      |         |           | E40-5823-05   | FLAT CABLE CONNECTOR          |              | L54 -56  |         |           | L40-8271-36  | SMALL FIXED INDUCTOR(82NH/8)   | K3,K6,M3       |
| CN2      |         |           | E40-9517-05   | PIN ASSY SOCKET (4P)          |              | X1       |         |           | L77-1789-05  | TCXO (16.8MHZ/4P/16)           |                |
| CN3      |         |           | E40-5890-05   | FLAT CABLE CONNECTOR(24P)     |              |          |         |           |              |                                |                |
| CN4      |         |           | E23-0342-05   | TEST TERMINAL (2P)            |              | X2       |         |           | L77-1760-05  | CRYSTAL RESONATOR(44.395MHZ)   |                |
| CN5 -12  |         |           | E23-1081-05   | TERMINAL                      |              | X3       |         |           | L77-1708-05  | CRYSTAL RESONATOR(3.579545MHZ) |                |
| F1       |         |           | F53-0130-05   | FUSE (3A)                     |              | X4       |         |           | L78-0462-05  | RESONATOR (9.8304M/8*2.5)      |                |
| CD1      |         |           | L79-1072-05   | TUNING COIL                   |              | XF1      |         |           | L71-0530-05  | MCF (44.85MHZ/6P/1)            |                |
| CF1      |         |           | L72-0962-05   | CERAMIC FILTER                |              | CP1      |         |           | R90-0724-05  | MULTI-COMP 1K X4               |                |
| CF2      |         |           | L72-0963-05   | CERAMIC FILTER                |              | CP2      |         |           | R90-0718-05  | MULTI-COMP 4.7K X4             |                |
| L1       |         |           | L92-0149-05   | FERRITE CHIP                  |              | CP4 ,5   |         |           | R90-0743-05  | MULTIPLE RESISTOR 47K X2       |                |
| L2       |         |           | L92-0138-05   | FERRITE CHIP                  |              | CP6 -21  |         |           | R90-0741-05  | MULTIPLE RESISTOR 1K X2        |                |
| L3       |         |           | L40-4791-37   | SMALL FIXED INDUCTOR(4.700UH) |              | CP22-24  |         |           | R90-0743-05  | MULTIPLE RESISTOR 47K X2       |                |
| L4       |         |           | L40-1091-37   | SMALL FIXED INDUCTOR(1.000UH) |              | R1       |         |           | RK73GB1J103J | CHIP R 10K J 1/16W             |                |
| L5 ,6    |         |           | L92-0138-05   | FERRITE CHIP                  |              | R2       |         |           | RK73GB1J473J | CHIP R 47K J 1/16W             |                |
| L9       |         |           | L40-1271-36   | SMALL FIXED INDUCTOR(12NH/8)  |              | R3       |         |           | RK73GB1J154J | CHIP R 150K J 1/16W            |                |
| L10      |         |           | L40-3971-36   | SMALL FIXED INDUCTOR(39NH/8)  |              | R4       |         |           | RK73GB1J104J | CHIP R 100K J 1/16W            |                |
| L11 ,12  |         |           | L92-0138-05   | FERRITE CHIP                  |              | R5       |         |           | RK73GB1J103J | CHIP R 10K J 1/16W             |                |
|          |         |           |               |                               |              | R6 ,7    |         |           | RK73GB1J104J | CHIP R 100K J 1/16W            |                |

## PARTS LIST

TX-RX UNIT (X57-5750-XX)

| Ref. No. | Address | New parts | Parts No.    | Description         | Destination | Ref. No. | Address | New parts | Parts No.    | Description         | Destination |
|----------|---------|-----------|--------------|---------------------|-------------|----------|---------|-----------|--------------|---------------------|-------------|
| R8       |         |           | RK73GB1J472J | CHIP R 4.7K J 1/16W |             | R78      |         |           | RN73GH1J682D | CHIP R 6.8K D 1/16W |             |
| R9       |         |           | RK73GB1J474J | CHIP R 470K J 1/16W |             | R79      |         |           | RK73GB1J101J | CHIP R 100 J 1/16W  |             |
| R10      |         |           | RK73GB1J472J | CHIP R 4.7K J 1/16W |             | R80      |         |           | RK73GB1J152J | CHIP R 1.5K J 1/16W |             |
| R11      |         |           | RK73GB1J104J | CHIP R 100K J 1/16W |             | R81      |         |           | RK73GB1J220J | CHIP R 22 J 1/16W   |             |
| R12      |         |           | RK73GB1J184J | CHIP R 180K J 1/16W |             | R83      |         |           | RK73GB1J184J | CHIP R 180K J 1/16W |             |
| R13      |         |           | RK73GB1J104J | CHIP R 100K J 1/16W |             | R85      |         |           | RK73GB1J103J | CHIP R 10K J 1/16W  |             |
| R14      |         |           | R92-1252-05  | CHIP R 0 OHM        |             | R86      |         |           | RK73GB1J223J | CHIP R 22K J 1/16W  |             |
| R15      |         |           | RK73GB1J104J | CHIP R 100K J 1/16W |             | R89      |         |           | RK73GB1J102J | CHIP R 1.0K J 1/16W |             |
| R16,17   |         |           | RK73GB1J473J | CHIP R 47K J 1/16W  |             | R90      |         |           | RK73GB1J153J | CHIP R 15K J 1/16W  |             |
| R18      |         |           | RK73GB1J154J | CHIP R 150K J 1/16W |             | R91      |         |           | RK73GB1J473J | CHIP R 47K J 1/16W  |             |
| R19,20   |         |           | RK73GB1J104J | CHIP R 100K J 1/16W |             | R93      |         |           | RK73GB1J183J | CHIP R 18K J 1/16W  |             |
| R21      |         |           | RK73GB1J273J | CHIP R 27K J 1/16W  |             | R94      |         |           | RK73GB1J153J | CHIP R 15K J 1/16W  |             |
| R22,23   |         |           | RK73GB1J823J | CHIP R 82K J 1/16W  |             | R95      |         |           | RK73GB1J394J | CHIP R 390K J 1/16W |             |
| R24      |         |           | RK73GB1J473J | CHIP R 47K J 1/16W  |             | R96      |         |           | RK73GB1J222J | CHIP R 2.2K J 1/16W |             |
| R25      |         |           | RK73GB1J472J | CHIP R 4.7K J 1/16W |             | R97      |         |           | RK73GB1J151J | CHIP R 150 J 1/16W  |             |
| R26      |         |           | RK73GB1J473J | CHIP R 47K J 1/16W  |             | R100     |         |           | R92-1252-05  | CHIP R 0 OHM        |             |
| R27      |         |           | RK73GB1J332J | CHIP R 3.3K J 1/16W |             | R101     |         |           | RK73GB1J560J | CHIP R 56 J 1/16W   |             |
| R28      |         |           | RK73GB1J474J | CHIP R 470K J 1/16W |             | R102     |         |           | RK73GB1J333J | CHIP R 33K J 1/16W  |             |
| R29      |         |           | RK73GB1J184J | CHIP R 180K J 1/16W |             | R104     |         |           | RK73GB1J102J | CHIP R 1.0K J 1/16W |             |
| R30      |         |           | RK73GB1J334J | CHIP R 330K J 1/16W |             | R106     |         |           | RK73GB1J470J | CHIP R 47 J 1/16W   |             |
| R31      |         |           | RK73GB1J102J | CHIP R 1.0K J 1/16W |             | R107     |         |           | RK73GB1J473J | CHIP R 47K J 1/16W  |             |
| R32      |         |           | RK73GB1J104J | CHIP R 100K J 1/16W |             | R109     |         |           | R92-1252-05  | CHIP R 0 OHM        |             |
| R33      |         |           | RK73GB1J184J | CHIP R 180K J 1/16W |             | R110     |         |           | RK73GB1J220J | CHIP R 22 J 1/16W   |             |
| R34      |         |           | RK73GB1J683J | CHIP R 68K J 1/16W  |             | R112     |         |           | R92-1252-05  | CHIP R 0 OHM        |             |
| R35      |         |           | RK73GB1J220J | CHIP R 22 J 1/16W   |             | R114     |         |           | R92-1252-05  | CHIP R 0 OHM        |             |
| R36      |         |           | RK73GB1J154J | CHIP R 150K J 1/16W |             | R115     |         |           | RK73GB1J184J | CHIP R 180K J 1/16W |             |
| R37      |         |           | R92-1252-05  | CHIP R 0 OHM        |             | R116     |         |           | RK73GB1J103J | CHIP R 10K J 1/16W  |             |
| R38      |         |           | RK73GB1J101J | CHIP R 100 J 1/16W  |             | R117     |         |           | RK73GB1J184J | CHIP R 180K J 1/16W |             |
| R39      |         |           | RK73GB1J472J | CHIP R 4.7K J 1/16W |             | R118     |         |           | RK73GB1J221J | CHIP R 220 J 1/16W  |             |
| R40,41   |         |           | RK73GB1J334J | CHIP R 330K J 1/16W |             | R119     |         |           | RK73GB1J102J | CHIP R 1.0K J 1/16W |             |
| R42,43   |         |           | RK73GB1J223J | CHIP R 22K J 1/16W  |             | R120     |         |           | RK73GB1J104J | CHIP R 100K J 1/16W |             |
| R44      |         |           | RK73GB1J473J | CHIP R 47K J 1/16W  |             | R121     |         |           | RK73GB1J222J | CHIP R 2.2K J 1/16W |             |
| R45      |         |           | RK73GB1J472J | CHIP R 4.7K J 1/16W |             | R122     |         |           | RK73GB1J221J | CHIP R 220 J 1/16W  |             |
| R46,47   |         |           | RK73GB1J223J | CHIP R 22K J 1/16W  |             | R124     |         |           | R92-1252-05  | CHIP R 0 OHM        |             |
| R48      |         |           | R92-1252-05  | CHIP R 0 OHM        |             | R125     |         |           | RK73GB1J124J | CHIP R 120K J 1/16W |             |
| R49      |         |           | RK73GB1J223J | CHIP R 22K J 1/16W  |             | R126     |         |           | RK73GB1J470J | CHIP R 47 J 1/16W   |             |
| R50      |         |           | RN73GH1J913D | CHIP R 91K D 1/16W  |             | R127     |         |           | RK73GB1J103J | CHIP R 10K J 1/16W  |             |
| R51      |         |           | RN73GH1J683D | CHIP R 68K D 1/16W  |             | R128     |         |           | R92-1252-05  | CHIP R 0 OHM        |             |
| R52      |         |           | RN73GH1J913D | CHIP R 91K D 1/16W  |             | R129     |         |           | RK73HB1J104J | CHIP R 100K J 1/16W |             |
| R53      |         |           | RK73GB1J473J | CHIP R 47K J 1/16W  |             | R130     |         |           | R92-1252-05  | CHIP R 0 OHM        |             |
| R54      |         |           | RK73GB1J123J | CHIP R 12K J 1/16W  |             | R131     |         |           | RK73GB1J470J | CHIP R 47 J 1/16W   |             |
| R55      |         |           | RN73GH1J333D | CHIP R 33K D 1/16W  |             | R132     |         |           | RK73GB1J684J | CHIP R 680K J 1/16W |             |
| R56      |         |           | RK73GB1J472J | CHIP R 4.7K J 1/16W |             | R133,134 |         |           | R92-1368-05  | CHIP R 0 OHM        |             |
| R57      |         |           | RK73GB1J183J | CHIP R 18K J 1/16W  |             | R135     |         |           | RK73GB1J272J | CHIP R 2.7K J 1/16W |             |
| R58      |         |           | RK73GB1J184J | CHIP R 180K J 1/16W |             | R136     |         |           | RK73GB1J122J | CHIP R 1.2K J 1/16W |             |
| R59      |         |           | RK73GB1J564J | CHIP R 560K J 1/16W |             | R137     |         |           | RK73GB1J103J | CHIP R 10K J 1/16W  |             |
| R60      |         |           | RK73GB1J123J | CHIP R 12K J 1/16W  |             | R138     |         |           | RK73HB1J103J | CHIP R 10K J 1/16W  |             |
| R61      |         |           | RK73GB1J103J | CHIP R 10K J 1/16W  |             | R139     |         |           | R92-1252-05  | CHIP R 0 OHM        |             |
| R62      |         |           | RN73GH1J913D | CHIP R 91K D 1/16W  |             | R140,141 |         |           | RK73HB1J473J | CHIP R 47K J 1/16W  |             |
| R63      |         |           | RK73GB1J474J | CHIP R 470K J 1/16W |             | R142     |         |           | RK73HB1J102J | CHIP R 1.0K J 1/16W |             |
| R64      |         |           | RK73GB1J184J | CHIP R 180K J 1/16W |             | R143     |         |           | RK73HB1J474J | CHIP R 470K J 1/16W |             |
| R65      |         |           | RK73GB1J103J | CHIP R 10K J 1/16W  |             | R144     |         |           | R92-1252-05  | CHIP R 0 OHM        |             |
| R66      |         |           | R92-1252-05  | CHIP R 0 OHM        |             | R145-152 |         |           | RK73HB1J102J | CHIP R 1.0K J 1/16W |             |
| R67      |         |           | RN73GH1J274D | CHIP R 270K D 1/16W |             | R153     |         |           | R92-1252-05  | CHIP R 0 OHM        |             |
| R68      |         |           | RK73GB1J223J | CHIP R 22K J 1/16W  |             | R154     |         |           | RK73GB1J183J | CHIP R 18K J 1/16W  |             |
| R69      |         |           | R92-1252-05  | CHIP R 0 OHM        |             | R156     |         |           | RK73GB1J102J | CHIP R 1.0K J 1/16W |             |
| R70      |         |           | RN73GH1J682D | CHIP R 6.8K D 1/16W |             | R160     |         |           | RK73GB1J682J | CHIP R 6.8K J 1/16W |             |
| R71      |         |           | RK73GB1J183J | CHIP R 18K J 1/16W  |             | R162     |         |           | RK73GB1J103J | CHIP R 10K J 1/16W  |             |
| R72      |         |           | RK73GB1J155J | CHIP R 1.5M J 1/16W |             | R163     |         |           | RK73HB1J103J | CHIP R 10K J 1/16W  |             |
| R74      |         |           | RK73GB1J183J | CHIP R 18K J 1/16W  |             | R166     |         |           | RK73GB1J223J | CHIP R 22K J 1/16W  |             |
| R75      |         |           | RN73GH1J683D | CHIP R 68K D 1/16W  |             | R167     |         |           | R92-1252-05  | CHIP R 0 OHM        |             |
| R76      |         |           | RK73GB1J474J | CHIP R 470K J 1/16W |             | R168     |         |           | RK73GB1J680J | CHIP R 68 J 1/16W   |             |

## PARTS LIST

TX-RX UNIT (X57-5750-XX)  
SUB UNIT (X58-4590-XX)

| Ref. No. | Address | New parts | Parts No.    | Description         | Destination    | Ref. No.   | Address | New parts | Parts No.      | Description                   | Destination |
|----------|---------|-----------|--------------|---------------------|----------------|--|---------|-----------|----------------|-------------------------------|-------------|
| R177     |         |           | RK73GB1J101J | CHIP R 100 J 1/16W  |                | D10  |         |           | HZU5ALL        | DIODE                         |             |
| R180     |         |           | RK73GB1J473J | CHIP R 47K J 1/16W  |                | D12  |         |           | HVU131         | DIODE                         |             |
| R184     |         |           | RK73GB1J102J | CHIP R 1.0K J 1/16W |                | D14 ,15  |         |           | MA2S077        | DIODE                         |             |
| R185     |         |           | RK73GB1J220J | CHIP R 22 J 1/16W   |                | D16  |         |           | HSM88AS        | DIODE                         |             |
| R189     |         |           | RK73HB1J473J | CHIP R 47K J 1/16W  |                | D17 ,18  |         |           | DA221          | DIODE                         |             |
| R190     |         |           | RK73GB1J472J | CHIP R 4.7K J 1/16W |                | D20  |         |           | HVC372B        | VARIABLE CAPACITANCE DIODE    |             |
| R195     |         |           | RK73GB1J222J | CHIP R 2.2K J 1/16W |                | D22  |         |           | HVC372B        | VARIABLE CAPACITANCE DIODE    |             |
| R199     |         |           | RK73HB1J102J | CHIP R 1.0K J 1/16W |                | D23  |         |           | 1SS373         | DIODE                         |             |
| R202     |         |           | RK73GB1J271J | CHIP R 270 J 1/16W  |                | D24 ,25  |         |           | MA2S077        | DIODE                         |             |
| R210     |         |           | RK73GB1J561J | CHIP R 560 J 1/16W  |                | IC1  |         |           | TA75W01FU      | IC(OP AMP X2)                 |             |
| R216     |         |           | RK73GB1J152J | CHIP R 1.5K J 1/16W |                | IC2  |         |           | TC75W51FU      | IC(OP AMP X2)                 |             |
| R218     |         |           | RK73HB1J473J | CHIP R 47K J 1/16W  |                | IC3  |         |           | RN5VL42C       | IC(REGULATOR)                 |             |
| R219     |         |           | RK73GB1J180J | CHIP R 18 J 1/16W   | K,K4,M         | IC4  |         |           | TC75W51FU      | IC(OP AMP X2)                 |             |
| R219     |         |           | RK73GB1J330J | CHIP R 33 J 1/16W   | K2,K5          | IC5  |         |           | S-81350HG-KD   | IC(VOLTAGE REGULATOR)         |             |
| R219     |         |           | RK73GB1J220J | CHIP R 22 J 1/16W   | K3,K6,M3       | IC6  |         |           | NJU7201U50     | IC(VOLTAGE REGULATOR)         |             |
| R221     |         |           | RK73HB1J102J | CHIP R 1.0K J 1/16W |                | IC7  |         |           | TC75W51FU      | IC(OP AMP X2)                 |             |
| R241     |         |           | RK73GB1J331J | CHIP R 330 J 1/16W  |                | IC8  |         |           | M62364FP       | IC(D/A CONVERTER)             |             |
| R242     |         |           | R92-1252-05  | CHIP R 0 OHM        | K,K2,K4,K5,M   | IC9  |         |           | TK11250BM      | IC(VOLTAGE REGULATOR)         |             |
| R244     |         |           | R92-1252-05  | CHIP R 0 OHM        |                | IC10   |         |           | TA75S01F       | IC(OP AMP)                    |             |
| R245     |         |           | RK73EB2ER39K | CHIP R 0.39 K 1/4W  |                | IC11   |         |           | TA75W01FU      | IC(OP AMP X2)                 |             |
| R247     |         |           | RK73EB2ER39K | CHIP R 0.39 K 1/4W  |                | IC12   |         |           | TA31136FN      | IC(FM IF DETECTOR)            |             |
| R248     |         |           | R92-1252-05  | CHIP R 0 OHM        |                | IC13   |         |           | TC35453F       | IC(AUDIO PROCESSOR)           |             |
| R249     |         |           | RK73EB2ER39K | CHIP R 0.39 K 1/4W  |                | IC14   |         |           | SA7025DK       | IC(PLL SYSTEM)                |             |
| R250     |         |           | R92-1252-05  | CHIP R 0 OHM        |                | IC16   |         |           | LC73872M       | IC(DTMF RECEIVER)             |             |
| R251-253 |         |           | RN73GH1J154D | CHIP R 150K D 1/16W |                | IC17   |         |           | AT29C020-90TI  | IC                            |             |
| R254     |         |           | RK73GB1J271J | CHIP R 270 J 1/16W  | K,K4,M         | IC18   |         |           | GN2011(Q)      | IC                            |             |
| R254     |         |           | RK73GB1J221J | CHIP R 220 J 1/16W  | K2,K3,K5,K6,M3 | IC19   |         | *         | 30612M4A-407GP | IC(CPU)                       |             |
| R255-257 |         |           | RN73GH1J154D | CHIP R 150K D 1/16W |                | IC20   |         |           | AT2408N10SI2.5 | IC(8kbit SERIAL EEPROM)       |             |
| R258     |         |           | RK73GB1J271J | CHIP R 270 J 1/16W  | K,K4,M         | IC21,22  |         |           | BU4094BCFV     | IC(8bit SHIFT/STORE REGISTER) |             |
| R258     |         |           | RK73GB1J221J | CHIP R 220 J 1/16W  | K2,K3,K5,K6,M3 | IC23   |         |           | NJM2904V       | IC(APC)                       |             |
| R259,260 |         |           | R92-1252-05  | CHIP R 0 OHM        |                | IC24   |         |           | TC7S66FU       | IC(ANALOG SWITCH)             |             |
| R261     |         |           | RK73GB1J103J | CHIP R 10K J 1/16W  |                | Q1   |         |           | DTC144EE       | DIGITAL TRANSISTOR            |             |
| R262     |         |           | RK73GB1J470J | CHIP R 47 J 1/16W   |                | Q2   |         |           | 2SJ243         | FET                           |             |
| R263,264 |         |           | RK73GB1J104J | CHIP R 100K J 1/16W |                | Q3   |         |           | 2SA1745(6,7)   | TRANSISTOR                    |             |
| R265     |         |           | RK73GB1J473J | CHIP R 47K J 1/16W  |                | Q4   |         |           | 2SC4617(S)     | TRANSISTOR                    |             |
| R266     |         |           | R92-1252-05  | CHIP R 0 OHM        |                | Q5   |         |           | 2SJ243         | FET                           |             |
| R267     |         |           | RK73GB1J181J | CHIP R 180 J 1/16W  |                | Q6   |         |           | DTA144EE       | DIGITAL TRANSISTOR            |             |
| R268     |         |           | RK73GB1J105J | CHIP R 1.0M J 1/16W |                | Q7   |         |           | DTC144EE       | DIGITAL TRANSISTOR            |             |
| R269     |         |           | RK73GB1J223J | CHIP R 22K J 1/16W  |                | Q8   |         |           | 2SC4617(S)     | TRANSISTOR                    |             |
| R270     |         |           | R92-1252-05  | CHIP R 0 OHM        |                | Q9 ,10   |         |           | DTC144EE       | DIGITAL TRANSISTOR            |             |
| R271     |         |           | RK73GB1J222J | CHIP R 2.2K J 1/16W |                | Q11  |         |           | 2SK1824        | FET                           |             |
| R272     |         |           | R92-1252-05  | CHIP R 0 OHM        |                | Q12  |         |           | 2SC5108(Y)     | TRANSISTOR                    |             |
| R273     |         |           | RK73GB1J223J | CHIP R 22K J 1/16W  |                | Q13 -15  |         |           | 2SK1824        | FET                           |             |
| R274     |         |           | RK73GB1J392J | CHIP R 3.9K J 1/16W | K3,K6,M3       | Q16 -18  |         |           | 2SC5108(Y)     | TRANSISTOR                    |             |
| R276     |         |           | R92-1252-05  | CHIP R 0 OHM        |                | Q19  |         |           | 2SC4619        | TRANSISTOR                    |             |
| R277     |         |           | RK73GB1J223J | CHIP R 22K J 1/16W  |                | Q20  |         |           | 2SC4988        | TRANSISTOR                    |             |
| R279,280 |         |           | R92-1252-05  | CHIP R 0 OHM        |                | Q21  |         |           | 2SK1824        | FET                           |             |
| R282     |         |           | RK73GB1J223J | CHIP R 22K J 1/16W  |                | Q22  |         |           | DTC114EE       | DIGITAL TRANSISTOR            |             |
| R283     |         |           | RK73GB1J472J | CHIP R 4.7K J 1/16W |                | Q23  |         |           | 2SK1824        | FET                           |             |
| R284     |         |           | RK73GB1J221J | CHIP R 220 J 1/16W  |                | Q24  |         |           | 3SK239A        | FET                           |             |
| R285     |         |           | R92-1252-05  | CHIP R 0 OHM        |                | Q25  |         |           | DTA144EE       | DIGITAL TRANSISTOR            |             |
| R296     |         |           | RK73GB1J102J | CHIP R 1.0K J 1/16W |                | Q26  |         |           | 2SK1824        | FET                           |             |
| R297,298 |         |           | RK73HB1J473J | CHIP R 47K J 1/16W  |                | TH1  |         |           | 157-302-65801  | THERMISTOR                    |             |
| R299     |         |           | RK73GB1J101J | CHIP R 100 J 1/16W  |                | A1   |         |           | X58-4590-10    | SUB UNIT                      | K,K4,M      |
| D1       |         |           | 1SR154-400   | DIODE               |                | A1   |         | *         | X58-4590-11    | SUB UNIT                      | K2,K5       |
| D2 ,3    |         |           | MA2S111      | DIODE               |                | A1   |         | *         | X58-4590-12    | SUB UNIT                      | K3,K6,M3    |
| D4       |         |           | RB706F-40    | DIODE               |                | <b>A1:SUB UNIT (VCO) (X58-4590-XX) -10:K,K4,M -11:K2,K5 -12:K3,K6,M3</b>                   |         |           |                |                               |             |
| D5       |         |           | DAN222       | DIODE               |                | <b>The A1 is replaceable as a unit assembly so individual parts are not kept in stock.</b> |         |           |                |                               |             |
| D6       |         |           | MA2S111      | DIODE               |                | C50  |         |           | CC73HCH1H220J  | CHIP C 22PF J                 | K,K4,M      |
| D7       |         |           | DAN222       | DIODE               |                | C50  |         |           | CC73HCH1H470J  | CHIP C 47PF J                 | K2,K5       |
| D8       |         |           | RB706F-40    | DIODE               |                | C50  |         |           | CC73HCH1H270J  | CHIP C 27PF J                 | K3,K6,M3    |
| D9       |         |           | MA2S077      | DIODE               |                |  |         |           |                |                               |             |

## PARTS LIST

TX-RX UNIT (X57-5750-XX)  
SUB UNIT (X58-4590-XX)

| Ref. No. | Address | New parts | Parts No.     | Description                   | Destination     | Ref. No. | Address | New parts | Parts No.     | Description | Destination |
|----------|---------|-----------|---------------|-------------------------------|-----------------|----------|---------|-----------|---------------|-------------|-------------|
| C51      |         | *         | CC73HCH1H030B | CHIP C 3.0PF B                | K,K4,M          | Q52      |         |           | 2SK508NV(K52) | FET         |             |
| C51      |         |           | CC73HCH1H080B | CHIP C 8.0PF B                | K2,K5           | Q53      |         |           | UMC4          | TRANSISTOR  |             |
| C51      |         |           | CC73HCH1H050B | CHIP C 5.0PF B                | K3,K6,M3        | Q54      |         |           | 2SC5108(Y)    | TRANSISTOR  |             |
| C53      |         |           | CC73HCH1H0R5B | CHIP C 0.5PF B                |                 |          |         |           |               |             |             |
| C54      |         | *         | CC73HCH1H030B | CHIP C 3.0PF B                | K,K4,M          |          |         |           |               |             |             |
| C54      |         |           | CC73HCH1H020B | CHIP C 2.0PF B                | K2,K5           |          |         |           |               |             |             |
| C54      |         | *         | CC73HCH1H060B | CHIP C 6.0PF B                | K3,K6,M3        |          |         |           |               |             |             |
| C55      |         |           | CC73HCH1H040B | CHIP C 4.0PF B                | K,K4,M          |          |         |           |               |             |             |
| C55      |         | *         | CC73HCH1H060B | CHIP C 6.0PF B                | K2,K5           |          |         |           |               |             |             |
| C55      |         |           | CC73HCH1H050B | CHIP C 5.0PF B                | K3,K6,M3        |          |         |           |               |             |             |
| C56      |         | *         | CC73HCH1H060B | CHIP C 6.0PF B                | K,K3,K4,K6,M,M3 |          |         |           |               |             |             |
| C56      |         |           | CC73HCH1H070B | CHIP C 7.0PF B                | K2,K5           |          |         |           |               |             |             |
| C57      |         |           | CK73HB1H102K  | CHIP C 1000PF K               |                 |          |         |           |               |             |             |
| C58      |         |           | CC73HCH1H0R5B | CHIP C 0.5PF B                |                 |          |         |           |               |             |             |
| C59      |         |           | CK73HB1H471K  | CHIP C 470PF K                |                 |          |         |           |               |             |             |
| C60      |         | *         | CC73HCH1H060B | CHIP C 6.0PF B                |                 |          |         |           |               |             |             |
| C61,62   |         |           | CK73HB1H102K  | CHIP C 1000PF K               |                 |          |         |           |               |             |             |
| C63      |         |           | CK73HB1H471K  | CHIP C 470PF K                |                 |          |         |           |               |             |             |
| C64      |         |           | CC73HCH1H101J | CHIP C 100PF J                |                 |          |         |           |               |             |             |
| C65      |         |           | CK73HB1H102K  | CHIP C 1000PF K               |                 |          |         |           |               |             |             |
| C66      |         |           | CC73HCH1H470J | CHIP C 47PF J                 | K,K4,M          |          |         |           |               |             |             |
| C66      |         |           | CC73HCH1H220J | CHIP C 22PF J                 | K2,K5           |          |         |           |               |             |             |
| C66      |         | *         | CC73HCH1H560J | CHIP C 56PF J                 | K3,K6,M3        |          |         |           |               |             |             |
| C67      |         | *         | CC73HCH1H030B | CHIP C 3.0PF B                | K,K4,M          |          |         |           |               |             |             |
| C67      |         | *         | CC73HCH1H060B | CHIP C 6.0PF B                | K2,K3,K5,K6,M3  |          |         |           |               |             |             |
| C68      |         | *         | CC73HCH1H030B | CHIP C 3.0PF B                | K,K2,K4,K5,M    |          |         |           |               |             |             |
| C68      |         |           | CC73HCH1H050B | CHIP C 5.0PF B                | K3,K6,M3        |          |         |           |               |             |             |
| C69      |         |           | CC73HCH1H050B | CHIP C 5.0PF B                | K,K4,M          |          |         |           |               |             |             |
| C69      |         | *         | CC73HCH1H080B | CHIP C 8.0PF B                | K2,K5           |          |         |           |               |             |             |
| C69      |         | *         | CC73HCH1H090B | CHIP C 9.0PF B                | K3,K6,M3        |          |         |           |               |             |             |
| C70      |         | *         | CC73HCH1H100B | CHIP C 10PF B                 |                 |          |         |           |               |             |             |
| C71      |         |           | CC73HCH1H0R5B | CHIP C 0.5PF B                |                 |          |         |           |               |             |             |
| C72      |         | *         | CC73HCH1H030B | CHIP C 3.0PF B                | K2,K5           |          |         |           |               |             |             |
| C72      |         |           | CC73HCH1H010B | CHIP C 1.0PF B                | K3,K6,M3        |          |         |           |               |             |             |
| C73      |         |           | CC73HCH1H0R5B | CHIP C 0.5PF B                | K,K4,M          |          |         |           |               |             |             |
| C73      |         |           | CC73HCH1H010B | CHIP C 1.0PF B                | K2,K3,K5,K6,M3  |          |         |           |               |             |             |
| C74      |         |           | CC73HCH1H040B | CHIP C 4.0PF B                |                 |          |         |           |               |             |             |
| TC50,51  |         |           | C05-0384-05   | CERAMIC TRIMMER CAP(10P/8)    |                 |          |         |           |               |             |             |
| CN50,51  |         |           | E40-5622-05   | PIN ASSY                      |                 |          |         |           |               |             |             |
| L50-53   |         |           | L40-3391-37   | SMALL FIXED INDUCTOR(3.300UH) |                 |          |         |           |               |             |             |
| L56      |         | *         | L34-4573-05   | AIR-CORE COIL                 | K,K3,K4,K6,M,M3 |          |         |           |               |             |             |
| L56      |         | *         | L34-4572-05   | AIR-CORE COIL                 | K2,K5           |          |         |           |               |             |             |
| L57      |         | *         | L34-4574-05   | AIR-CORE COIL                 | K,K3,K4,K6,M,M3 |          |         |           |               |             |             |
| L57      |         | *         | L34-4573-05   | AIR-CORE COIL                 | K2,K5           |          |         |           |               |             |             |
| L58,59   |         |           | L40-1085-44   | SMALL FIXED INDUCTOR(100.0NH) |                 |          |         |           |               |             |             |
| L60,61   |         |           | L40-3391-37   | SMALL FIXED INDUCTOR(3.300UH) |                 |          |         |           |               |             |             |
| L62      |         |           | L92-0138-05   | FERRITE CHIP                  |                 |          |         |           |               |             |             |
| L63      |         |           | L40-1875-44   | SMALL FIXED INDUCTOR(18.0NH)  |                 |          |         |           |               |             |             |
| R50      |         |           | RK73HB1J473J  | CHIP R 47K J 1/16W            |                 |          |         |           |               |             |             |
| R51      |         |           | RK73HB1J103J  | CHIP R 10K J 1/16W            |                 |          |         |           |               |             |             |
| R52      |         |           | RK73HB1J473J  | CHIP R 47K J 1/16W            |                 |          |         |           |               |             |             |
| R53,54   |         |           | RK73HB1J101J  | CHIP R 100 J 1/16W            |                 |          |         |           |               |             |             |
| R55      |         |           | RK73HB1J104J  | CHIP R 100K J 1/16W           |                 |          |         |           |               |             |             |
| R56      |         |           | RK73HB1J181J  | CHIP R 180 J 1/16W            |                 |          |         |           |               |             |             |
| R57      |         |           | RK73HB1J151J  | CHIP R 150 J 1/16W            |                 |          |         |           |               |             |             |
| R58      |         |           | RK73HB1J224J  | CHIP R 220K J 1/16W           | K,K2,K4,K5,M    |          |         |           |               |             |             |
| R58      |         |           | RK73HB1J474J  | CHIP R 470K J 1/16W           | K3,K6,M3        |          |         |           |               |             |             |
| R59      |         |           | RK73HB1J101J  | CHIP R 100 J 1/16W            |                 |          |         |           |               |             |             |
| D50-57   |         |           | HVC350B       | VARIABLE CAPACITANCE DIODE    |                 |          |         |           |               |             |             |
| D58      |         |           | HVC351        | VARIABLE CAPACITANCE DIODE    |                 |          |         |           |               |             |             |
| Q50      |         |           | 2SK508NV(K52) | FET                           |                 |          |         |           |               |             |             |
| Q51      |         |           | 2SJ243        | FET                           |                 |          |         |           |               |             |             |