

9. EXPLODED VIEWS AND PARTS LIST

- NOTES :**
- Parts marked by "*" are generally unavailable because they are not in our Master Spare Parts List.
 - The ⚠ mark found on some component parts indicates the importance of the safety factor of the part. Therefore, when replacing, be sure to use parts of identical designation.
 - Screw adjacent to ∇ mark on the product are used for disassembly.
 - For the applying amount of lubricants or glue, follow the instructions in this manual.
(In the case of no amount instructions, apply as you think it appropriate.)

9.1 PACKING

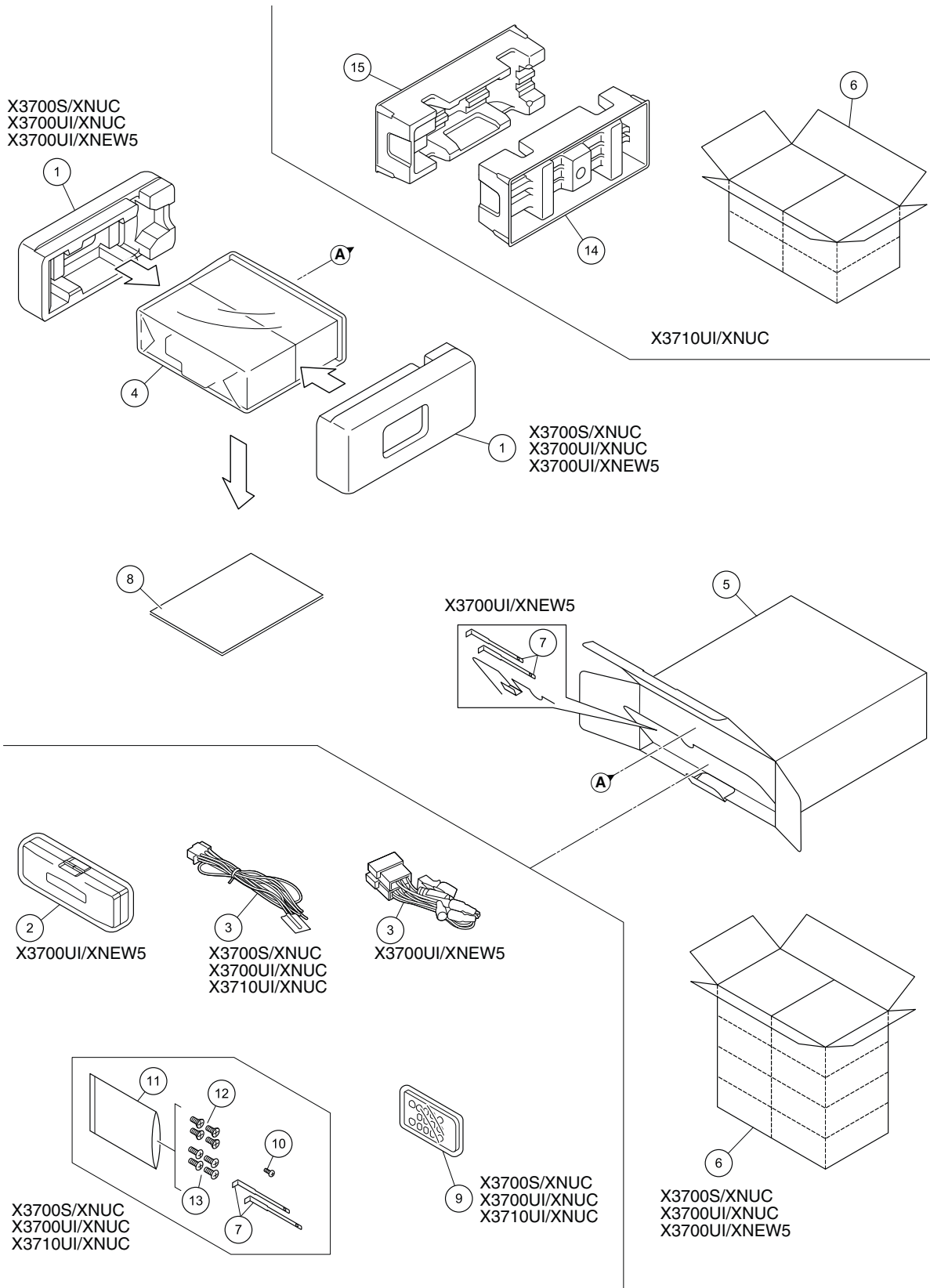

(1) PACKING SECTION PARTS LIST

<u>Mark No.</u>	<u>Description</u>	<u>Part No.</u>	<u>Mark No.</u>	<u>Description</u>	<u>Part No.</u>
1	Protector	See Contrast table (2)	9	Card Remote Control Unit	See Contrast table (2)
2	Case Assy	See Contrast table (2)	10	Screw	See Contrast table (2)
3	Cord Assy	See Contrast table (2)	11	Polyethylene Bag	See Contrast table (2)
4	Polyethylene Bag	See Contrast table (2)	12	Screw	See Contrast table (2)
5	Unit Box	See Contrast table (2)	13	Screw	See Contrast table (2)
6	Contain Box	See Contrast table (2)	14	Protector	See Contrast table (2)
7	Handle	QNC3021	15	Protector	See Contrast table (2)
8-1	Owner's Manual	See Contrast table (2)			
* 8-2	Warranty Card	See Contrast table (2)			

(2) CONTRAST TABLE

DEH-X3700S/XNUC, DEH-X3700UI/XNUC, DEH-X3710UI/XNUC and DEH-X3700UI/XNEW5 are constructed the same except for the following:

Mark	No.	Description	DEH-X3700S /XNUC	DEH-X3700UI /XNUC	DEH-X3710UI /XNUC	DEH-X3700UI /XNEW5
	1	Protector	CHP4594	CHP4594	Not used	CHP4594
	2	Case Assy	Not used	Not used	Not used	QXA3129
	3	Cord Assy	CDP1484	CDP1484	CDP1484	QDP3073
	4	Polyethylene Bag	CEG1173	CEG1173	CEG1173	QEG3001
	5	Unit Box	QHG3652	QHG3654	QHG3655	QHG3653
	6	Contain Box	QHL3652	QHL3654	QHL3655	QHL3653
	8-1	Owner's Manual	QRD3265	QRD3271	QRD3271	QRD3270
*	8-2	Warranty Card	QRY3001	QRY3001	QRY3001	CRY1376
	9	Card Remote Control Unit	QXE1047	QXE1047	QXE1047	Not used
	10	Screw	BPZ20P060FTC	BPZ20P060FTC	BPZ20P060FTC	Not used
	11	Polyethylene Bag	CEG1160	CEG1160	CEG1160	Not used
	12	Screw	CRZ50P090FTC	CRZ50P090FTC	CRZ50P090FTC	Not used
	13	Screw	TRZ50P080FTC	TRZ50P080FTC	TRZ50P080FTC	Not used
	14	Protector	Not used	Not used	CHP4103	Not used
	15	Protector	Not used	Not used	CHP4104	Not used

Owner's Manual, Installation Manual

Part No.	Language
QRD3265	English, French, Spanish(Espanol)
QRD3270	English, French, Italian, Spanish(Espanol), German, Dutch, Russian
QRD3271	English, French, Spanish(Espanol)

(1) EXTERIOR SECTION PARTS LIST

<u>Mark No.</u>	<u>Description</u>	<u>Part No.</u>	<u>Mark No.</u>	<u>Description</u>	<u>Part No.</u>
1	Screw	ASZ26P050FTC	24	Detachable Grille Assy	See Contrast table (2)
2	Screw	BSZ26P060FTC	25	Screw	BPZ20P100FTC
3	Screw	BSZ26P080FTC			
4	Screw	BSZ26P120FTC	26	Spring	CBH2210
5	CD Mechanism Module (S11.6VA)	CXK5805	27	Button (EJECT)	QAC3166
			28	Button (MIX)	QAC3173
6	FFC	QDE3029	29	Button (1-6)	QAC3197
7	Cord Assy	See Contrast table (2)	30	Button (DETACH)	QAC3171
8	Case	See Contrast table (2)			
9	Holder	QNC3020	31	Cover	QNS3701
10	Panel	QNS3576	32	Lighting Conductor	QNV3094
			33	Lighting Conductor	QNV3095
11	Tuner Amp Unit	See Contrast table (2)	34	Segment LCD (V1801)	CAW2041
12	Screw	BPZ26P080FTC	35	Holder	QNC3088
13	Screw	BSZ26P120FTC			
14	Holder	See Contrast table (2)	36	Lighting Conductor	QNV3093
15	Screw	See Contrast table (2)	37	Rubber Connector	QNV3079
			38	Knob Unit	CXE3692
16	Heat Sink	QNR3010	39	Grille Unit	See Contrast table (2)
17	Fuse (10 A)	YEK5001	40	Door	QAT3013
18	Panel Assy	See Contrast table (2)			
19	Spring	QBH3001	41	Card Remote Control Unit	See Contrast table (2)
20	Cover	QNM3029	42	Cover	See Contrast table (2)
			43	Sheet	QNM3123
21	Panel	QNS3126	44	Sheet	QNM3124
22	Arm	QNV3025	45	Cushion	QNM3131
23	Button	QNV3026	46	Sheet	QNM3130

(2) CONTRAST TABLE

DEH-X3700S/XNUC, DEH-X3700UI/XNUC, DEH-X3710UI/XNUC and DEH-X3700UI/XNEW5 are constructed the same except for the following:

Mark	No.	Description	DEH-X3700S /XNUC	DEH-X3700UI /XNUC	DEH-X3710UI /XNUC	DEH-X3700UI /XNEW5
	7	Cord Assy	CDP1484	CDP1484	CDP1484	QDP3073
	8	Case	QNB3020	QNB3021	QNB3021	QNB3021
	11	Tuner Amp Unit	QWM3871	QWM3873	QWM3873	QWM3872
	14	Holder	QNC3076	QNC3049	QNC3049	QNC3053
	15	Screw	Not used	BSZ26P060FTC	BSZ26P060FTC	BSZ26P060FTC
	18	Panel Assy	QXA3261	QXA3261	* CXE3802	QXA3261
	24	Detachable Grille Assy	QXA4163	QXA4165	QXA4166	QXA4164
	39	Grille Unit	QXA4136	QXA4138	QXA4139	QXA4137
	41	Card Remote Control Unit	QXE1047	QXE1047	QXE1047	Not used
	42	Cover	CNS7068	CNS7068	CNS7068	Not used

9.3 CD MECHANISM MODULE

A

B

C

D

E

F

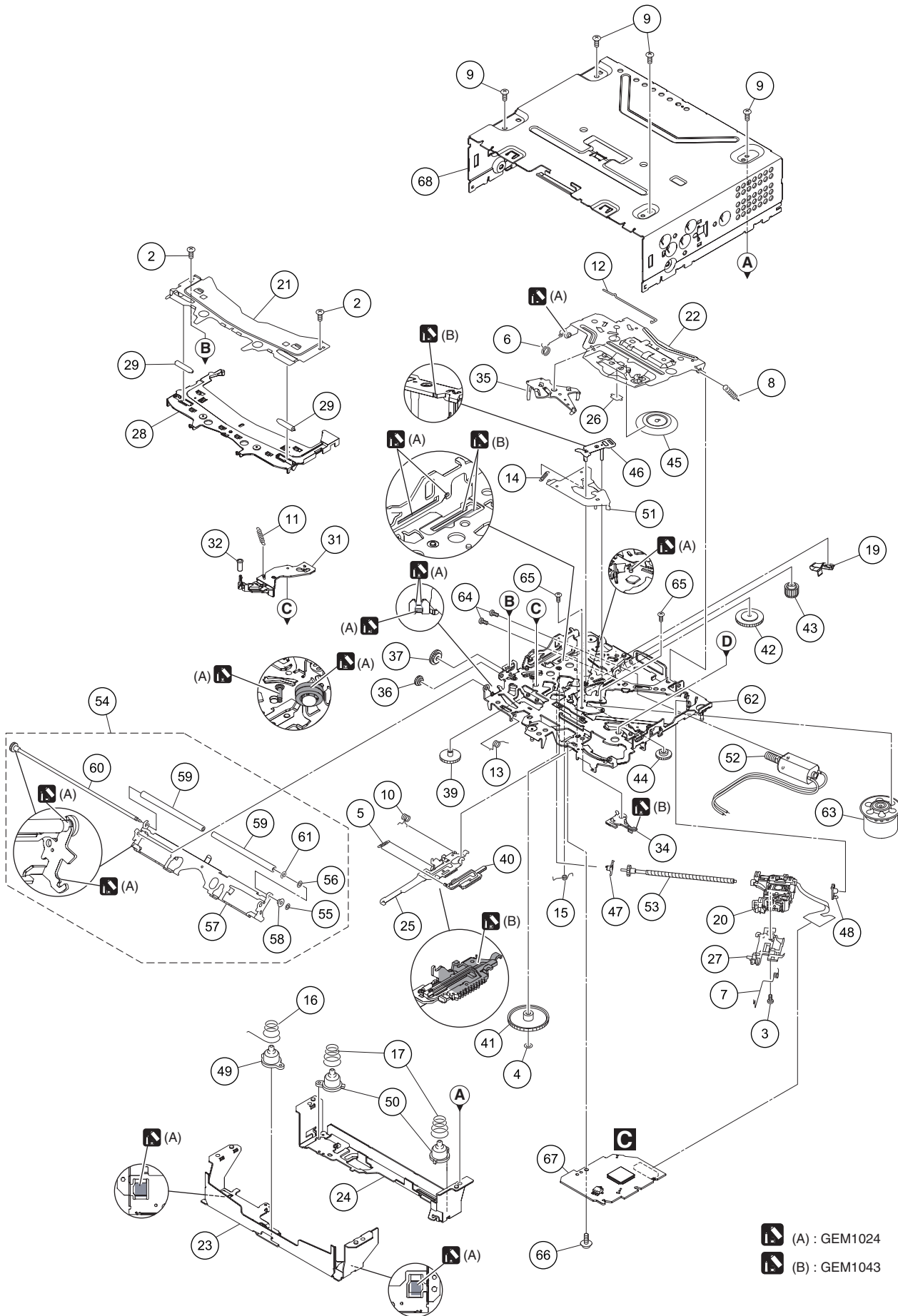

(A) : GEM1024
 (B) : GEM1043

CD MECHANISM MODULE SECTION PARTS LIST

<u>Mark No.</u>	<u>Description</u>	<u>Part No.</u>	<u>Mark No.</u>	<u>Description</u>	<u>Part No.</u>
1		50	Damper	CNW1198
2	Screw	BSZ20P040FTC	51	Arm	CNW1726
3	Screw(M2 x 4)	CBA1835	52	Motor Unit(M2)(LOAD/CRG)	CXC4026
4	Washer	CBF1038	53	Screw Unit	CXC8894
5	Spring	CBH3010	54	Arm Assy	CXE6232
6	Spring	CBH2855	55	Washer	CBF1037
7	Spring	CBH2856	56	Washer	CBF1038
8	Spring	CBH2860	57	Arm	CND6242
9	Screw	BSZ26P060FTC	58	Collar	CNW2444
10	Spring	CBH3011	59	Roller	CNW2500
11	Coil Spring	CBH3095	60	Gear Unit	CXE6225
12	Spring	CBH3014	61	Washer	YE15FTC
13	Spring	CBH3015	62	Chassis Unit	CXE4528
14	Spring	CBH3016	63	Motor Unit(M1)(SPDL)	CXE2273
15	Spring	CBH3017	64	Screw	JFZ20P025FTC
16	Spring	CBH3086	65	Screw	JGZ17P022FTC
17	Spring	CBH3019	66	Screw	EBA1028
18		67	CD Core Unit (S11.6VA)	CWX4269
19	Leaf Spring	CBL1824	68	Chassis	CNA3181
20	PU Unit(P11)(Service)	CXX4754			
21	Bracket	CND4553			
22	Arm	CND6406			
23	Bracket	CND6127			
24	Bracket	CND5710			
25	Lever	CND5398			
26	Sheet	CNN3678			
27	Rack	CNV8342			
28	Guide	CNW2240			
29	Roller	CNW1172			
30				
31	Arm	CNW2241			
32	Roller	CNW1175			
33				
34	Arm	CNW1177			
35	Arm	CNW1178			
36	Gear	CNW1180			
37	Gear	CNW1181			
38				
39	Gear	CNW1183			
40	Rack	CNW1184			
41	Gear	CNW1185			
42	Gear	CNW1186			
43	Gear	CNW1187			
44	Gear	CNW2287			
45	Clamper	CNW1190			
46	Arm	CNW1192			
47	Holder	CNW1193			
48	Holder	CNW1194			
49	Damper	CNW1197			

12. ELECTRICAL PARTS LIST

NOTE:

- Parts whose parts numbers are omitted are subject to being not supplied.
- The part numbers shown below indicate chip components.

Chip Resistor

RS1/○S○○○○J,RS1/○○S○○○○J

Chip Capacitor (except for CQS.....)

CKS....., CCS....., CSZS.....

- The \triangle mark found on some component parts indicates the importance of the safety factor of the part. Therefore, when replacing, be sure to use parts of identical designation.
- Meaning of the figures and others in the parentheses in the parts list.

Example) IC 301 is on the point (face A, 91 of x-axis, and 111 of y-axis) of the corresponding PC board.

IC 301 (A, 91, 111) IC NJM2068V

- The expression of the unit in this manual is shown by u instead of μ . Please do not make a mistake.

	<u>Circuit Symbol and No.</u>	<u>Part No.</u>	<u>Circuit Symbol and No.</u>	<u>Part No.</u>
A:	DEH-X3700S/XNUC		IC 671 (A,133,74) IC	S-80827CNMC-B8M
B:	DEH-X3700UI/XNUC		IC 681 (A,115,94) FLASHROM IC	* PEB149A8
	DEH-X3710UI/XNUC		IC 801 (A,105,18) L-MOS And Gate	TC7SET08FUS1
			IC 911 (A,145,28) IC	BA49183-V12
			Q 251 (A,20,129) Transistor	EMH53
C:	DEH-X3700UI/XNEW5		Q 253 (A,13,129) Transistor	EMH53
Unit Number:	QWM3871(A)		Q 301 (A,60,124) Transistor	EMD52
Unit Name :	Tuner Amp Unit		Q 531 (A,89,94) Transistor	LSAR523UB
Unit Number:	QWM3873(B)		Q 751 (A,14,102) Transistor	KTD2092
Unit Number:	QWM3872(C)		Q 752 (A,10,107) Transistor	EMD52
Unit Name :	Tuner Amp Unit		Q 871 (A,151,62) Transistor	2SAR502UB
Unit Number:	(A,B)		Q 872 (A,150,54) Transistor	LTC143EUB
Unit Name :	Keyboard Unit		Q 941 (A,128,108) Transistor	LSCR523UB
Unit Number:	CWX4269		Q 1011 (A,98,120) Transistor	LTC014EEB
Unit Name :	CD Core Unit(S11.6VA)		D 301 (A,87,128) Diode	CRG03
			D 302 (A,92,128) Diode	CRG03
			D 551 (A,24,118) Diode	CMS30I30A
			D 552 (A,44,105) Diode	RB056L-40
			D 601 (A,136,79) Diode	RB751SM-40
			D 602 (A,126,63) Diode	RB751SM-40
			D 751 (A,16,107) Diode	DZ2J082M0
			D 801 (A,108,12) Diode	DZ2S068C
			D 802 (A,93,16) Diode	DZ2S068C
			D 803 (A,125,15) Diode	DZ2S068C
			D 804 (A,119,13) Diode	DZ2S068C
			D 805 (A,121,13) Diode	DZ2S068C
			D 806 (A,117,13) Diode	DZ2S068C
			D 807 (A,114,13) Diode	DZ2S068C
			D 901 (A,138,127) Diode	D1F60-5053
			D 902 (A,135,127) Diode	D1F60-5053
			D 911 (A,159,66) Diode	CRG03
			D 912 (A,162,66) Diode	CRG03
			D 941 (A,129,112) Diode	DZ2J068M0
			D 1011 (A,101,124) Diode	CRG03
			L 202 (A,91,101) Inductor	CTF1793
			L 402 (A,142,93) Inductor	LCTAW150J2520
			L 404 (A,145,108) Inductor	CTF1389
			L 408 (A,154,104) Inductor	LCMAR27J1608
			L 551 (A,52,107) Inductor	CTH1584
			L 801 (A,115,16) Inductor	CTF1713

RESISTORS

IC 201 (A,99,106) E-VOL SYS LSI	PM9013A	D 911 (A,159,66) Diode	CRG03
IC 301 (A,79,141) IC	PAL013A	D 912 (A,162,66) Diode	CRG03
IC 401 (A,149,87) IC	TEF6686HN	D 941 (A,129,112) Diode	DZ2J068M0
IC 451 (A,164,75) IC	MM3571A33P	D 1011 (A,101,124) Diode	CRG03
IC 531 (A,93,86) IC	337S3959	L 202 (A,91,101) Inductor	CTF1793
IC 551 (A,42,112) IC	KBD9876EFJ	L 402 (A,142,93) Inductor	LCTAW150J2520
IC 552 (A,107,24) IC	BD2232G-G	L 404 (A,145,108) Inductor	CTF1389
IC 601 (A,112,74) FLASH BLANK UC	IC R5S726B0D216FP	L 408 (A,154,104) Inductor	LCMAR27J1608
IC 602 (A,131,68) IC	TC7SH126FU	L 551 (A,52,107) Inductor	CTH1584
IC 603 (A,137,66) L-MOS And Gate	TC7SET08FUS1	L 801 (A,115,16) Inductor	CTF1713

5		6		7		8	
<u>Circuit Symbol and No.</u>		<u>Part No.</u>		<u>Circuit Symbol and No.</u>		<u>Part No.</u>	
L 901	(A,112,141) Choke Coil 600 uH	CTH1432					
T 401	(A,151,99) Variable Coil	CTC1215		R 555	(A,64,103)	RS1/10SR471J	
X 401	(A,159,85) Resonator 9.216 MHz	CSS1864		R 609	(A,125,65)	RS1/16SS473J	
X 601	(A,128,74) Resonator 12.0 MHz	CSS1847		R 610	(A,125,67)	RS1/16SS473J	A
X 602	(A,120,89) Ceramic Resonator 16.934 MHz	CSS1603		R 611	(A,129,69)	RS1/16SS473J	
				R 613	(A,125,74)	RS1/16SS152J	
△ P251	(A,6,130) Fuse 3.0 A	CEK1386					
P 402	(A,159,110) Absorber	HSPC16701B02		R 614	(A,132,78)	RS1/16SS473J	
P 1002	(A,158,73) Poly Switch	FSMD110-24R		R 615	(A,135,77)	RS1/16SS473J	
VA801	(A,107,14) Varistor	MLV0402ES012V0010N		R 616	(A,124,76)	RS1/16SS473J	
VA802	(A,102,13) Varistor	MLV0402ES012V0010N		R 617	(A,138,79)	RS1/16SS103J	
				R 618	(A,127,81)	RS1/16SS473J	
CN701	(A,114,32) Connector	VKN1192					
CN801	(A,109,3) Connector	CKS6452		R 622	(A,122,85)	RS1/16SS473J	
JA251	(A,19,141) Jack	CKB1109		R 623	(A,129,93)	RAB4CQ473J	
JA401	(A,162,128) Jack	YKS5041		R 625	(A,116,89)	RS1/16SS221J	
JA891	(A,43,138) Jack	CKS6437		R 626	(A,115,89)	RS1/16SS221J	B
				R 627	(A,114,89)	RS1/16SS221J	
JA901	(A,114,141) Plug	CKM1624					
JA961	(A,142,143) Connector	CKS3806		R 628	(A,113,89)	RS1/16SS221J	
△	Fuse (10 A)	YEK5001		R 629	(A,110,91)	RS1/16SS221J	
				R 630	(A,109,91)	RS1/16SS221J	
				R 631	(A,107,92)	RS1/16SS473J	
				R 632	(A,108,87)	RS1/16SS473J	
RESISTORS							
R 251	(A,22,127)	RS1/16SS821J					
R 252	(A,20,124)	RS1/16SS821J		R 633	(A,106,92)	RS1/16SS101J	
R 253	(A,22,129)	RS1/16SS223J		R 634	(A,103,90)	RS1/16SS102J	
R 254	(A,18,125)	RS1/16SS223J		R 636	(A,100,91)	RS1/16SS473J	
R 260	(A,14,125)	RS1/16SS821J		R 637	(A,101,89)	RS1/16SS473J	
				R 638	(A,104,92)	RS1/16SS473J	C
R 261	(A,11,128)	RS1/16SS821J					
R 262	(A,15,126)	RS1/16SS223J		R 643	(A,98,81)	RS1/16SS104J	
R 263	(A,11,129)	RS1/16SS223J		R 644	(A,97,78)	RS1/16SS101J	
R 265	(A,17,127)	RS1/16SS0R0J		R 645	(A,94,79)	RS1/16SS101J	
R 267	(A,15,129)	RS1/16SS0R0J		R 646	(A,124,62)	RS1/16SS103J	
				R 647	(A,98,74)	RS1/16SS101J	
R 305	(A,59,121)	RS1/16SS103J					
R 306	(A,61,121)	RS1/16SS221J		R 648	(A,94,76)	RS1/16SS102J	
R 307	(A,61,122)	RS1/16SS223J		R 649	(A,94,75)	RS1/16SS102J	
R 309	(A,84,120)	RS1/16SS103J		R 650	(A,94,74)	RS1/16SS102J	
R 401	(A,151,94)	RS1/16SS0R0J		R 651	(A,91,72)	RS1/16SS473J	
				R 652	(A,95,68)	RS1/16SS222J	
R 402	(A,150,94)	RS1/16SS0R0J					
R 403	(A,140,94)	RS1/16SS391J		R 653	(A,97,65)	RS1/16SS103J	D
R 404	(A,151,109)	RS1/16SS105J		R 655	(A,116,60)	RS1/16SS0R0J	
R 405	(A,154,109)	RS1/16SS105J		R 656	(A,117,52)	RS1/16SS0R0J	
R 406	(A,152,81)	RS1/16SS101J		R 659	(A,125,61)	RS1/16SS153J	
				R 660	(A,124,60)	RS1/16SS153J	
R 407	(A,153,81)	RS1/16SS101J					
R 408	(A,156,81)	RS1/16SS103J		R 662	(A,129,66)	RS1/16SS473J	
R 410	(A,155,81)	RS1/16SS103J		R 663	(A,141,76)	RS1/16SS0R0J	
R 437	(A,153,79)	RS1/16SS472J		R 664	(A,92,68)	RS1/16SS103J	
R 438	(A,151,79)	RS1/16SS472J		R 665	(A,124,85)	RS1/16SS473J	
				R 667	(A,129,64)	RS1/16SS473J	
R 452	(A,165,89)	RS1/16SS0R0J					
R 454	(A,147,74)	RS1/16SS0R0J		R 669	(A,108,61)	RS1/16SS473J	E
R 455	(A,166,88)	RS1/16SS0R0J		R 671	(A,131,70)	RS1/16SS104J	
R 531	(A,90,90)	RS1/16SS473J		R 681	(A,110,96)	RS1/16SS473J	
R 532	(A,90,84)	RS1/16SS222J		R 682	(A,111,90)	RS1/16SS473J	
				R 683	(A,121,92)	RS1/16SS473J	
R 533	(A,91,84)	RS1/16SS222J					
R 534	(A,94,90)	RS1/16SS272J		R 684	(A,110,94)	RS1/16SS473J	
R 535	(A,95,89)	RS1/16SS472J		R 685	(A,121,96)	RS1/16SS473J	
R 536	(A,97,89)	RS1/16SS472J		R 701	(A,109,37)	RS1/16SS473J	
R 537	(A,95,85)	RS1/16SS101J		R 702	(A,115,37)	RS1/16SS104J	
				R 703	(A,118,27)	RAB4CQ472J	
R 538	(A,95,83)	RS1/16SS101J					
R 551	(A,48,112)	RS1/16SS682J		R 704	(A,110,40)	RS1/16SS104J	F
R 552	(A,53,113)	RS1/16SS0R0J		R 706	(A,108,36)	RS1/16SS221J	
R 553	(A,49,113)	RS1/16SS1803D		R 707	(A,108,37)	RS1/16SS221J	
R 554	(A,49,111)	RS1/16SS4302D		R 708	(A,110,37)	RS1/16SS101J	
				R 709	(A,111,37)	RS1/16SS221J	

1

2

3

4

Circuit Symbol and No.**Part No.****Circuit Symbol and No.****Part No.**

D 802	(A,91,16) Diode	DZ2S068C		
D 803	(A,125,14) Diode	DZ2S068C	R 410	(A,148,81) RS1/16SS103J
D 804	(A,118,12) Diode	DZ2S068C	R 437	(A,147,77) RS1/16SS472J
A D 805	(A,119,12) Diode	DZ2S068C	R 438	(A,146,77) RS1/16SS472J
D 806	(A,114,12) Diode	DZ2S068C	R 452	(A,159,85) RS1/16SS0R0J
			R 453	(A,143,73) (B) RS1/10SR0R0J
D 807	(A,112,12) Diode	DZ2S068C		
D 901	(A,139,126) Diode	D1F60-5053	R 455	(A,161,88) RS1/16SS0R0J
D 902	(A,136,126) Diode	D1F60-5053	R 531	(A,90,89) RS1/16SS473J
D 911	(A,156,66) Diode	CRG03	R 532	(A,90,86) RS1/16SS222J
D 912	(A,159,66) Diode	CRG03	R 533	(A,91,86) RS1/16SS222J
			R 534	(A,93,86) RS1/16SS272J
D 941	(A,92,124) Diode(C)	DZ2J068M0		
D 951	(A,120,112) Diode(C)	DAN202UM	R 535	(A,94,86) RS1/16SS472J
D 1011	(A,126,107) Diode	CRG03	R 536	(A,96,87) RS1/16SS472J
L 202	(A,93,101) Inductor	CTF1793	R 537	(A,94,83) RS1/16SS101J
B L 402	(A,137,91) Inductor	LCTAW150J2520	R 538	(A,94,82) RS1/16SS101J
			R 551	(A,24,110) RS1/16SS682J
L 404	(A,139,105) Inductor	CTF1389		
L 406	(A,143,77) Inductor	CTF1786	R 552	(A,29,111) RS1/16SS0R0J
L 408	(A,148,103) Inductor	LCMAR27J1608	R 553	(A,26,111) RS1/16SS1803D
L 551	(A,29,105) Inductor	CTH1584	R 554	(A,26,109) RS1/16SS4302D
L 801	(A,113,16) Inductor	CTF1713	R 555	(A,38,123) RS1/10SR471J
			R 601	(A,93,68) (C) RS1/16SS473J
L 901	(A,111,140) Choke Coil 600 uH	CTH1432		
L 951	(A,120,114) Chip Coil(C)	BTH1101	R 602	(A,120,68) RS1/16SS102J
T 401	(A,145,96) Variable Coil	CTC1215	R 604	(A,115,59) (C) RS1/16SS473J
X 401	(A,153,85) Resonator 9.216 MHz	CSS1864	R 609	(A,121,63) RS1/16SS473J
X 601	(A,125,74) Resonator 12.0 MHz	CSS1847	R 610	(A,121,65) RS1/16SS473J
C			R 611	(A,122,68) RS1/16SS473J
X 602	(A,116,89)Ceramic Resonator 16.934 MHz	CSS1603		
⚠ P251	(A,4,129) Fuse 3.0 A	CEK1386	R 613	(A,120,75) RS1/16SS152J
P 402	(A,154,108) Absorber	HSPC16701B02	R 614	(A,121,77) RS1/16SS473J
VA801	(A,106,12) Varistor	MLV0402ES012V0010N	R 615	(A,129,77) RS1/16SS473J
VA802	(A,100,12) Varistor	MLV0402ES012V0010N	R 616	(A,125,67) RS1/16SS473J
			R 617	(A,130,80) RS1/16SS103J
CN701	(A,112,31) Connector	VKN1192		
CN801	(A,108,3) Connector	CKS6452	R 618	(A,124,81) RS1/16SS473J
JA251	(A,17,137) Jack	CKB1109	R 619	(A,125,81) (C) RS1/16SS473J
JA401	(A,156,128) Jack	YKS5041	R 622	(A,124,86) RS1/16SS473J
JA891	(A,41,137) Jack(B)	CKS6437	R 623	(A,128,84) RAB4CQ473J
			R 625	(A,112,89) RS1/16SS221J
D JA892	(A,41,140) Jack(C)	YKS5001		
JA901	(A,112,140) Plug	CKM1624	R 626	(A,111,88) RS1/16SS221J
⚠	Fuse (10 A)	YEK5001	R 627	(A,110,87) RS1/16SS221J
			R 628	(A,110,89) RS1/16SS221J
			R 629	(A,107,90) RS1/16SS221J
			R 630	(A,108,88) RS1/16SS221J

RESISTORS

R 251	(A,16,130)	RS1/16SS821J		
R 252	(A,11,127)	RS1/16SS821J	R 631	(A,106,91) RS1/16SS473J
R 253	(A,14,130)	RS1/16SS223J	R 632	(A,104,90) RS1/16SS473J
R 254	(A,11,129)	RS1/16SS223J	R 633	(A,105,89) RS1/16SS101J
R 255	(A,28,131)	RS1/16SS821J	R 634	(A,101,87) RS1/16SS102J
			R 636	(A,98,90) RS1/16SS473J
R 256	(A,18,130)	RS1/16SS821J		
E R 257	(A,26,130)	RS1/16SS223J	R 637	(A,99,89) RS1/16SS473J
R 258	(A,20,130)	RS1/16SS223J	R 638	(A,102,91) RS1/16SS473J
R 305	(A,88,126)	RS1/16SS103J	R 643	(A,98,81) RS1/16SS104J
R 306	(A,88,128)	RS1/16SS221J	R 644	(A,97,78) RS1/16SS101J
			R 645	(A,94,78) RS1/16SS101J
R 307	(A,87,127)	RS1/16SS223J		
R 309	(A,88,124)	RS1/16SS103J	R 646	(A,132,72) RS1/16SS103J
R 401	(A,145,91)	RS1/16SS0R0J	R 647	(A,97,76) RS1/16SS101J
R 402	(A,143,91)	RS1/16SS0R0J	R 648	(A,94,75) RS1/16SS102J
R 403	(A,135,91)	RS1/16SS391J	R 649	(A,94,74) RS1/16SS102J
			R 650	(A,94,73) RS1/16SS102J
R 404	(A,142,108)	RS1/16SS105J		
F R 405	(A,147,108)	RS1/16SS105J	R 651	(A,96,70) RS1/16SS473J
R 406	(A,146,80)	RS1/16SS101J	R 652	(A,96,68) RS1/16SS222J
R 407	(A,147,80)	RS1/16SS101J	R 653	(A,98,65) RS1/16SS103J
R 408	(A,149,81)	RS1/16SS103J	R 655	(A,111,61) RS1/16SS0R0J
			R 656	(A,113,63) RS1/16SS0R0J

1

2

3

4

5
Circuit Symbol and No.

6
Part No.

7
Circuit Symbol and No.

8
Part No.

R 659 (A,122,60)
R 660 (A,122,59)
R 664 (A,132,61)
R 667 (A,101,59)
R 668 (A,101,58)

R 671 (A,128,68)
R 681 (A,107,96)
R 682 (A,109,90)
R 683 (A,118,91)
R 684 (A,107,92)

R 685 (A,118,95)
R 701 (A,107,37)
R 702 (A,112,37)
R 703 (A,116,27)
R 704 (A,109,39)

R 706 (A,106,35)
R 707 (A,108,37)
R 708 (A,109,37)
R 709 (A,110,37)
R 710 (A,111,37)

R 711 (A,112,38)
R 715 (A,115,35)
R 716 (A,116,35)
R 717 (A,117,35)
R 718 (A,121,35)

R 719 (A,120,35)
R 752 (A,142,133)
R 753 (A,126,90)
R 754 (A,126,91)
R 801 (A,123,20)

R 803 (A,119,17)
R 804 (A,117,17)
R 805 (A,119,18)
R 806 (A,117,19)
R 807 (A,118,19)

R 808 (A,122,19)
R 809 (A,114,20)
R 810 (A,112,20)
R 813 (A,106,15)
R 814 (A,100,18)

R 815 (A,98,18)
R 816 (A,95,18)
R 817 (A,93,18)
R 851 (A,91,19)
R 871 (A,141,64)

R 872 (A,141,61)
R 878 (A,122,25)
R 891 (A,56,136)
R 892 (A,56,135)
R 894 (A,89,74) (C)

R 895 (A,89,75) (C)
R 896 (A,88,73) (C)
R 897 (A,88,71) (C)
R 898 (A,89,73) (C)
R 911 (A,144,39)

R 912 (A,139,40)
R 913 (A,152,40)
R 914 (A,129,39)
R 915 (A,138,120)
R 941 (A,92,121)

RS1/16SS153J
RS1/16SS153J
RS1/16SS103J
RS1/16SS473J
RS1/16SS473J

RS1/16SS104J
RS1/16SS473J
RS1/16SS473J
RS1/16SS473J
RS1/16SS473J

RS1/16SS473J
RS1/16SS473J
RS1/16SS104J
RAB4CQ472J
RS1/16SS104J

RS1/16SS221J
RS1/16SS221J
RS1/16SS101J
RS1/16SS221J
RS1/16SS101J

RS1/16SS102J
RS1/16SS151J
RS1/16SS151J
RS1/16SS151J
RS1/16SS221J

RS1/16SS104J
RS1/4SA391J
RS1/16SS473J
RS1/16SS103J
RS1/10SR222J

RS1/16SS223J
RS1/16SS223J
RS1/10SR101J
RS1/10SR101J
RS1/10SR101J

RS1/10SR222J
RS1/10SR220J
RS1/10SR220J
RS1/10SR222J
RS1/10SR222J

RS1/16SS822J
RS1/10SR222J
RS1/10SR222J
RS1/16SS472J
RS1/10SR332J

RS1/16SS103J
RS1/10SR473J
RS1/16SS102J
RS1/16SS102J
RS1/16SS223J

RS1/16SS101J
RS1/16SS223J
RS1/16SS101J
RS1/16SS101J
RS1/10SR1R0J

RS1/10SR1R0J
RS1/16SS223J
RS1/16SS223J
RS1/10SR0R0J
RS1/16SS223J

R 942 (A,93,121)
R 943 (A,93,124) (B)
(A,93,124) (C)
R 944 (A,97,123) (B)
(A,97,123) (C)
R 951 (A,124,107)
R 952 (A,118,109) (C)

R 953 (A,123,113) (C)
R 1011 (A,130,107)
R 1013 (A,126,114)

CAPACITORS

C 201 (A,99,116)
C 202 (A,103,115)
C 203 (A,91,115)
C 204 (A,106,114)
C 205 (A,92,115)

C 206 (A,106,111)
C 207 (A,93,107)
C 208 (A,93,105)
C 209 (A,92,103) 10 uF
C 210 (A,94,105)

C 211 (A,108,106)
C 212 (A,106,108) 10 uF
C 213 (A,107,105)
C 214 (A,107,103)
C 215 (A,107,101)

C 216 (A,91,100) 10 uF
C 217 (A,93,99)
C 218 (A,113,108)
C 219 (A,111,102) 10 uF
C 220 (A,104,97) 10 uF

C 221 (A,94,103)
C 223 (A,90,100) 1 uF
C 224 (A,113,102)
C 227 (A,90,108) (C)
C 229 (A,109,111) 1 uF

C 236 (A,108,103)
C 237 (A,106,116) (C)
C 238 (A,108,112) (C)
C 239 (A,94,115) (C)
C 240 (A,97,115) (C)

C 251 (A,33,127) 10 uF
C 252 (A,15,126) 10 uF
C 253 (A,15,129)
C 254 (A,10,129)
C 255 (A,33,131) 10 uF

C 256 (A,29,129) 10 uF
C 257 (A,25,130)
C 258 (A,19,130)
C 260 (A,32,136)
C 261 (A,4,132)

C 301 (A,68,128)
C 303 (A,78,128)
C 305 (A,72,129)
C 307 (A,76,128)
C 313 (A,82,129) 2.2 uF

C 314 (A,134,125)
C 318 (A,63,129) 10 uF/16 V

RS1/16SS473J
RS1/16SS682J
RS1/16SS333J
RS1/4SA102J
RS1/4SA122J
RS1/16SS102J
RS1/16SS223J

RS1/16SS153J
RS1/16SS103J
RS1/4SA102J

CKSRYB105K10
CKSRYB105K10
CKSRYB105K10
CKSRYB105K10
CKSRYB105K10

CKSRYB105K10
CKSSYB104K10
CKSSYB104K10
CCG1192
CCSSCH151J50

CCSSCH151J50
CCG1192
CKSSYB104K10
CKSSYB104K10
CKSSYB104K10
CKSSYB104K10

CCG1192
CKSSYB104K10
XCEVW470M16
CCG1192
CCG1192

CKSSYB102K50
DCH1246
CKSSYB104K10
CKSSYB102K50
DCH1246

CKSRYB105K10
CKSRYB105K10
CKSRYB105K10
CKSRYB105K10
CKSRYB105K10

DCH1201
DCH1201
CCSSCH101J50
CCSSCH101J50
DCH1201

DCH1201
CCSSCH101J50
CCSSCH101J50
CKSSYB104K10
CKSSYB103K16

CKSRYB474K10
CKSRYB474K10
CKSRYB474K10
CKSRYB474K10
CCG1205

CKSRYB104K16
DCH1263

	1	2	3	4
	<u>Circuit Symbol and No.</u>	<u>Part No.</u>	<u>Circuit Symbol and No.</u>	<u>Part No.</u>
	C 322 (A,104,125)	CKSRYB104K16	C 672 (A,122,72) 1 uF	DCH1246
	C 327 (A,86,128)	CKSRYB105K10	C 683 (A,119,93)	CCSSCJ3R0C50
	C 328 (A,51,129) 2.2 uF	CCG1205	C 687 (A,121,96)	CKSRYB105K10
A	C 407 (A,151,91)	CKSSYB104K10	C 701 (A,110,39)	CKSSYB103K16
	C 409 (A,147,90)	CKSSYB224K6R3	C 704 (A,118,38)	CCSSCH100D50
	C 410 (A,146,103)	CCSSCH220J50	C 705 (A,117,38)	CCSSCH100D50
	C 411 (A,144,103)	CCSSCH331J50	C 706 (A,115,37)	CCSSCH100D50
	C 414 (A,138,88)	CKSSYB102K50	C 710 (A,122,47)	CKSRYB104K16
			C 752 (A,138,135)	CKSSYB104K10
	C 420 (A,145,107)	CCSSCH471J50	C 753 (A,146,129) 10 uF	DCH1201
	C 422 (A,139,85)	CKSSYB152K50	C 754 (A,136,112) (C)	CKSSYB102K50
	C 425 (A,148,88)	CCSSCH390J50	C 801 (A,122,5)	CCSRCH102J50
	C 428 (A,141,89)	CKSSYB104K10	C 806 (A,123,7)	CKSRYB104K16
	C 430 (A,147,91)	CKSSYB102K50	C 807 (A,120,13)	CKSRYB105K10
B	C 434 (A,152,103)	CCSSCH100D50	C 808 (A,107,18)	CKSRYB104K16
	C 442 (A,143,79) 10 uF	DCH1201	C 809 (A,95,15)	CCSRCH221J50
	C 452 (A,154,78)	CKSRYB104K16	C 810 (A,95,12)	CCSRCH221J50
	C 453 (A,158,71)	CKSRYB105K10	C 811 (A,102,20)	CKSSYB104K10
	C 455 (A,143,74) (B)	CKSSYB102K50	C 872 (A,122,26)	CKSRYB105K16
	C 456 (A,143,75) 1 uF	DCH1246	C 873 (A,122,23)	CKSRYB105K16
	C 458 (A,138,80)	CKSSYB102K50	C 891 (A,51,137)	CKSRYB104K16
	C 459 (A,149,105)	CKSRYB104K16	C 892 (A,32,138)	CKSRYB104K16
	C 531 (A,90,88)	CKSSYB104K10	C 893 (A,32,134) (C)	CKSRYB102K50
	C 532 (A,92,87)	CKSSYB104K10	C 894 (A,51,133) (C)	CKSRYB102K50
C	C 551 (A,11,120)	XCEVW221M16	C 901 (A,131,123) 2 200 uF	CCH2040
	C 552 (A,11,106)	CKSRYB105K16	C 911 (A,137,116)	CKSRYB104K16
	C 553 (A,13,109)	CKSSYB103K16	C 912 (A,150,39)	CKSSYB102K50
	C 555 (A,23,111)	CKSSYB682K25	C 913 (A,129,42)	CKSSYB102K50
	C 556 (A,30,119)	CEVQW221M6R3	C 914 (A,155,55)	XCEAT102M16
	C 557 (A,31,115)	CKSRYB105K10	C 915 (A,131,41)	CKSRYB104K16
	C 560 (A,107,20)	CKSRYB105K10	C 916 (A,146,42) 10 uF	DCH1201
	C 561 (A,101,23)	CKSRYB105K10	C 917 (A,144,45)	CKSSYB102K50
	C 564 (A,31,113) 4.7 uF	CCG1201	C 919 (A,149,40) 10 uF	DCH1201
	C 565 (A,13,105) 4.7 uF	CCG1222	C 921 (A,133,41) 10 uF	DCH1201
	C 601 (A,103,64)	CKSSYB104K10	C 923 (A,158,40) 10 uF	DCH1201
	C 602 (A,107,64)	CKSSYB104K10	C 926 (A,138,43) 10 uF	DCH1201
D	C 603 (A,110,64)	CKSSYB104K10	C 927 (A,138,41)	CKSSYB102K50
	C 604 (A,111,64)	CKSSYB104K10	C 941 (A,95,124)	CKSRYB104K16
	C 605 (A,115,64)	CKSSYB104K10	C 1011 (A,132,108)	CKSRYB105K16
	C 606 (A,120,70)	CKSSYB104K10	C 1013 (A,136,76)	CKSRYB104K16
	C 607 (A,125,72)	CCSSCH120J50		
	C 608 (A,125,77)	CCSSCH120J50		
	C 609 (A,120,72)	CKSSYB104K10		
	C 610 (A,120,74)	CKSSYB104K10		
	C 611 (A,120,76)	CKSSYB102K50		
	C 612 (A,121,81)	CKSSYB104K10		
E	C 613 (A,122,81)	CKSSYB104K10		
	C 620 (A,112,87)	CKSSYB104K10		
	C 621 (A,107,87)	CKSSYB104K10		
	C 622 (A,104,92)	CCSSCH220J50		
	C 623 (A,105,87)	CKSSYB104K10		
	C 624 (A,104,87)	CKSSYB104K10		
	C 625 (A,102,89)	CKSSYB104K10		
	C 626 (A,98,79)	CKSSYB104K10		
	C 627 (A,95,80)	CCSSCH220J50		
	C 628 (A,94,79)	CCSSCH220J50		
	C 629 (A,98,74)	CKSSYB104K10		
F	C 630 (A,97,72)	CKSSYB103K16		
	C 631 (A,95,76)	CCSSCH220J50		
	C 635 (A,111,98) (C)	CKSSYB104K10		
	C 641 (A,95,88)	CCSRCH330J50		

B
Unit Number : (A,B)
Unit Number : (C)
Unit Name : Keyboard Unit

MISCELLANEOUS

IC 1801 (B,81,19) IC	PDC205A
IC 1951 (A,154,37) IR RC REC Module	PNJ4833M
Q 1841 (B,27,8) Transistor	LSCR523UB
Q 1842 (B,19,8) Transistor	LSCR523UB
Q 1843 (B,8,16) Transistor	LSCR523UB
Q 1847 (B,107,22) Transistor	LSCR523UB
Q 1848 (B,117,24) Transistor	LSCR523UB
Q 1849 (B,127,26) Transistor	LSCR523UB
D 1841 (A,3,17) LED	SMLVN6RGB2UK(B)
D 1842 (A,38,17) LED	SMLVN6RGB2UK(B)

5		6	
<u>Circuit Symbol and No.</u>		<u>Part No.</u>	
D 1843	(A,160,23) LED	SMLVN6RGB2UK(B)	
D 1844	(A,145,20) LED	SMLVN6RGB2UK(B)	
D 1845	(A,45,20) LED	SMLVN6RGB2UK(B)	
X 1801	(B,66,20) Ceramic Resonator 5.00 MHz	CSG1155	
S 1821	(A,50,3) Push Switch	CSG1155	
S 1822	(A,9,39) Push Switch	CSG1155	
S 1823	(A,64,3) Push Switch	CSG1155	
S 1824	(A,6,6) Push Switch	CSG1155	
S 1825	(A,5,22) Push Switch	CSG1155	
S 1826	(A,38,27) Push Switch	CSG1155	
S 1827	(A,38,8) Push Switch	CSG1155	
S 1828	(A,73,3) Push Switch	CSG1155	
S 1829	(A,143,3) Push Switch	CSG1155	
S 1830	(A,120,3) Push Switch	CSG1155	
S 1831	(A,129,3) Push Switch	CSG1155	
S 1832	(A,97,3) Push Switch	CSG1155	
S 1833	(A,105,3) Push Switch	CSG1155	
S 1834	(A,82,3) Push Switch	CSG1155	
S 1835	(A,7,29) Push Switch	CSG1155	
S 1836	(A,21,17) Encoder(MULTI-CONTROL)	CSD1193	
CN1941	(B,107,7) Connector	CKS6451	
JA 1901	(A,153,23) Connector	CKS6443	
JA 1921	(A,154,8) Jack(A,B)	CKN1108	
	(A,154,8) Jack(C)	CKN1090	
V 1801	(A,51,30) LCD	CAW2041	

RESISTORS

R 1801	(B,61,20)	RS1/16SS103J
R 1821	(B,33,25)	RS1/16SS273J
R 1841	(B,32,7)	RS1/16SS222J
R 1842	(B,32,5)	RS1/16SS102J
R 1843	(B,23,7)	RS1/16SS222J
R 1844	(B,23,5)	RS1/16SS102J
R 1845	(B,14,7)	RS1/16SS222J
R 1846	(B,12,7)	RS1/16SS102J
R 1847	(B,24,7)	RS1/16SS470J
R 1849	(B,14,6)	RS1/16SS470J
R 1851	(B,10,7)	RS1/16SS470J
R 1865	(B,102,23)	RS1/16SS222J
R 1866	(B,111,26)	RS1/16SS102J
R 1867	(B,114,23)	RS1/16SS222J
R 1868	(B,114,25)	RS1/16SS102J
R 1869	(B,123,26)	RS1/16SS222J
R 1870	(B,123,28)	RS1/16SS102J
R 1871	(B,112,23)	RS1/16SS470J
R 1873	(B,122,26)	RS1/16SS470J
R 1875	(B,132,25)	RS1/16SS470J
R 1884	(B,46,23)	RS1/10SR221J
R 1887	(B,47,22)	RS1/16SS101J
R 1888	(B,38,22)	RS1/16SS101J
R 1921	(B,133,8)	RS1/10SR0R0J
R 1922	(B,130,5)	RS1/10SR0R0J
R 1923	(B,138,5)	RS1/10SR0R0J
R 1941	(B,77,4)	RS1/10SR222J
R 1942	(B,74,5)	RS1/10SR222J
R 1953	(B,141,24)	RS1/10SR101J

CAPACITORS

C 1801	(B,70,19) 4.7 uF	CCG1212
--------	------------------	---------

7		8	
<u>Circuit Symbol and No.</u>		<u>Part No.</u>	
C 1802	(B,70,21)	CKSSYB104K10	
C 1803	(B,75,9)	CKSSYB104K10	
C 1804	(B,76,9)	CKSSYB104K10	
C 1805	(B,77,9)	CKSSYB104K10	
C 1856	(B,48,25)	CKSRYB105K16	
C 1901	(B,160,31)	CKSRYB104K16	
C 1902	(B,138,13)	CKSRYB102K50	
C 1904	(B,137,26)	CKSRYB105K10	
C 1905	(B,46,20)	CKSRYB105K10	
C 1923	(B,136,8)	CCSRCH221J50	
C 1951	(B,142,27) 10 uF	CCG1192	



Unit Number : CWX4269

Unit Name : CD Core Unit(S11.6VA)

MISCELLANEOUS

IC 201	(B,24,38) IC	PEQ094A
IC 301	(A,37,12) IC	BD8223EFV
Q 101	(B,12,54) Transistor	2SA1577
Q 102	(B,16,55) Chip Digital Transistor	LTA123JUB
X 201	(B,25,50) Ceramic Resonator 16.934 MHz	CSS1603
S 901	(A,43,54) Spring Switch(HOME)	CSN1080
S 903	(B,22,13) Spring Switch(DSCSNS)	CSN1081
CN101	(A,17,58) Connector	CKS4808
CN701	(A,26,30) Connector	CKS6146

RESISTORS

R 101	(B,7,59)	RS1/10SR2R4J
R 102	(B,8,59)	RS1/10SR2R4J
R 103	(B,10,59)	RS1/10SR2R7J
R 108	(B,14,58)	RS1/16SS105J
R 109	(B,15,50)	RS1/16SS152J
R 214	(B,18,28)	RS1/16SS103J
R 215	(B,17,28)	RS1/16SS393J
R 216	(B,13,36)	RS1/16SS102J
R 217	(B,10,33)	RS1/16SS562J
R 218	(B,10,36)	RS1/16SS472J
R 229	(B,13,35)	RS1/16SS471J
R 232	(A,31,55)	RS1/16SS0R0J
R 237	(B,34,45)	RS1/16SS221J
R 240	(B,35,40)	RS1/16SS473J
R 245	(A,34,46)	RS1/16SS104J
R 254	(A,37,56)	RS1/16SS104J
R 260	(B,30,27)	RS1/16SS103J
R 264	(A,22,9)	RS1/16SS102J
R 281	(B,34,38)	RS1/16SS560J
R 282	(B,34,39)	RS1/16SS560J
R 291	(B,34,35)	RS1/16SS560J
R 294	(B,28,49)	RS1/16SS471J
R 303	(A,28,12)	RS1/16SS123J
R 304	(A,29,11)	RS1/16SS123J
R 305	(A,27,9)	RS1/16SS102J
R 306	(A,27,12)	RS1/16SS472J
R 307	(A,26,9)	RS1/16SS102J
R 308	(A,26,12)	RS1/16SS472J
R 309	(A,35,7)	RS1/16SS473J
R 310	(B,31,9)	RS1/16SS472J

Circuit Symbol and No.**Part No.**

R 311	(B,31,10)	RS1/16SS472J
R 312	(B,31,11)	RS1/16SS472J
R 313	(B,31,12)	RS1/16SS472J
R 701	(A,22,38)	RS1/16SS101J
R 702	(A,24,38)	RS1/16SS101J
R 706	(A,33,42)	RS1/16SS221J

CAPACITORS

C 104	(B,15,52)	CKSQYB475K6R3
C 110	(B,11,44)	CKSSYB104K10
C 111	(B,12,44)	CKSSYB103K16
C 203	(B,22,47)	CKSSYB104K10
C 205	(A,17,41)	CKSRYB105K10

C 209	(B,29,48)	CKSRYB104K16
C 210	(B,33,44)	CKSSYB104K10
C 211	(B,34,42)	CKSSYB104K10
C 212	(B,23,29)	CKSSYB104K10
C 213	(B,18,26)	CKSSYB332K50

C 214	(B,17,26)	CKSSYB473K16
C 215	(B,19,29)	CKSSYB104K10
C 216	(B,13,33)	CKSSYB152K50
C 217	(B,10,35)	CCSSCH390J50
C 218	(B,10,37)	CCSSCH5R0C50

C 219	(B,14,35)	CKSSYB104K10
C 220	(A,18,39)	CKSSYB104K10
C 221	(B,14,32)	CKSSYB104K10
C 222	(B,14,37)	CKSSYB104K10
C 223	(B,13,42)	CCSSCH680J50

C 224	(B,14,45)	CCSSCH470J50
C 225	(B,14,47)	CKSSYB103K16
C 228	(B,10,34)	CCSSCH180J50
C 229	(B,9,41)	CKSSYB104K10
C 233	(B,33,46)	CKSSYB103K16

C 236	(B,8,41)	CKSSYB104K10
C 238	(A,26,45)	CKSRYB104K16
C 299	(A,26,43)	CKSSYB104K10
C 302	(B,29,12)	CKSSYB102K50
C 303	(B,30,12)	CKSSYB102K50

C 304	(B,28,12)	CKSSYB223K16
C 305	(B,27,12)	CKSSYB104K10
C 306	(A,32,7)	CKSSYB104K10
C 307	(A,42,19)	CKSRYB105K10
C 308	(A,32,16)	CKSRYB105K10

C 710	(A,34,43)	CKSSYB102K50
-------	-----------	--------------