

# EXPLODED VIEW (CD MECHANISM)

- A : N09-6108-15
- B : N09-6426-15
- C : N09-6735-05
- D : N09-6737-15
- E : N09-6738-15
- F : N19-2335-14
- G : N35-2003-48
- H : N39-1720-48

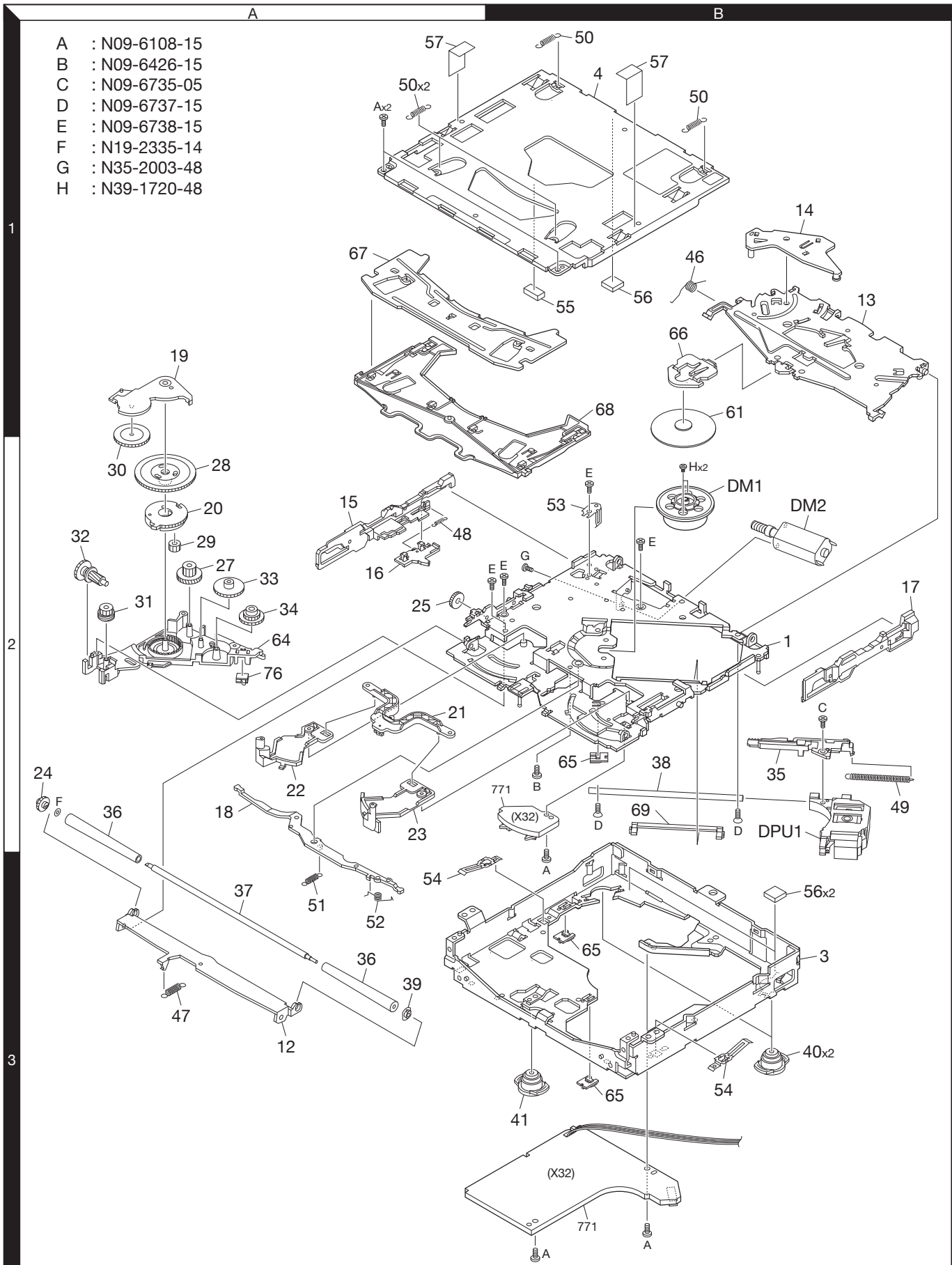

Parts with the exploded numbers larger than 700 are not supplied.

# EXPLODED VIEW (UNIT)

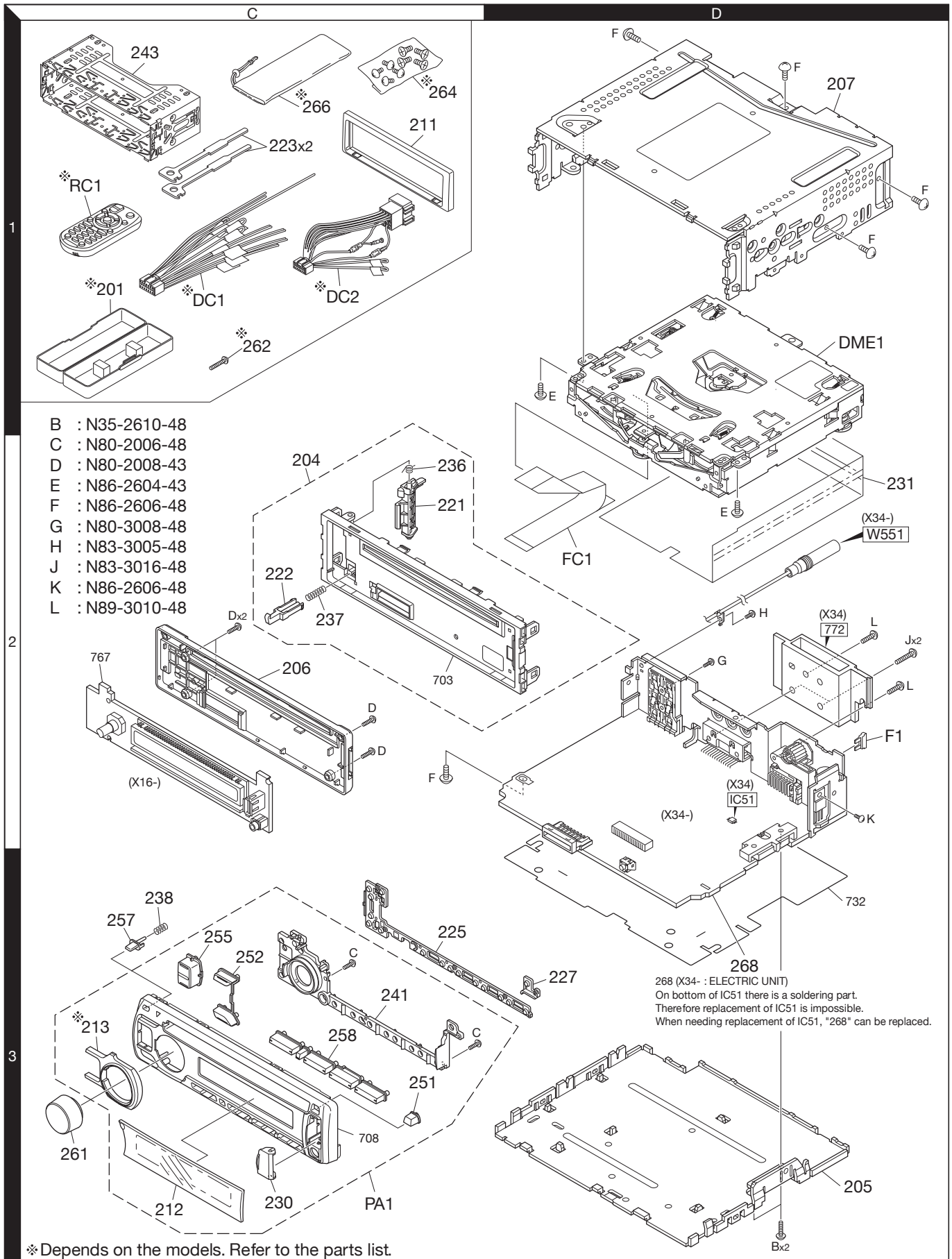

Parts with the exploded numbers larger than 700 are not supplied.

# PARTS LIST

\* New parts

Parts without **Parts No.** are not supplied.

Les articles non mentionnés dans le **Parts No.** ne sont pas fournis.

Teile ohne **Parts No.** werden nicht geliefert.

Ref. No.	A d d	N e w	Parts No.	Description	Desti- nation
<b>KDC-4047Ux/414Ux/MP245U/U3046/U346/U4046</b>					
201	1C		A02-2755-23	PLASTIC CABINET ASSY	M2M3
204	2C	*	A22-3260-13	SUB PANEL ASSY	
205	3D	*	A40-1371-11	BOTTOM PLATE	
206	2C	*	A46-1901-01	REAR COVER	
207	1D	*	A52-1126-01	TOP COVER	
PA1	3C	*	A64-5001-12	PANEL ASSY	K1
PA1	3C	*	A64-5002-12	PANEL ASSY	E2E3
PA1	3C	*	A64-5003-12	PANEL ASSY	E4
PA1	3C	*	A64-5004-12	PANEL ASSY	E5
PA1	3C	*	A64-5008-12	PANEL ASSY	M2
PA1	3C	*	A64-5009-12	PANEL ASSY	M3
PA1	3C	*	A64-5016-12	PANEL ASSY	C2
PA1	3C	*	A64-5131-12	PANEL ASSY	M4
PA1	3C	*	A64-5132-12	PANEL ASSY	M5
RC1	1C	*	A70-2104-05	REMOTE CONTROLLER ASSY (RC-405)	K1M2M3
-		*	B64-4526-00	INST. MANUAL (ENGLISH)	E3E4E5
-		*	B64-4526-00	INST. MANUAL (ENGLISH)	M4M5E2
-		*	B64-4527-00	INST. MANUAL (FRE.GER.DUT.)	E2E3E4
-		*	B64-4528-00	INST. MANUAL (ITA.SPA.POR.)	E2E3E4
-		*	B64-4529-00	INST. MANUAL (ENG.FRE.SPA.)	K1
-		*	B64-4530-00	INST. MANUAL (UKRAINIAN)	E2E3E4
-		*	B64-4530-00	INST. MANUAL (UKRAINIAN)	E5
-		*	B64-4531-00	INST. MANUAL (ENG.ARA.)	M2M3
-		*	B64-4532-00	INST. MANUAL (S-CHINESE)	C2
211	1C		B07-3270-01	ESCUTCHEON	
212	3C	*	B10-5324-01	FRONT GLASS	K1
212	3C	*	B10-5325-01	FRONT GLASS	E2E3
212	3C	*	B10-5326-01	FRONT GLASS	E4
212	3C	*	B10-5327-01	FRONT GLASS	E5
212	3C	*	B10-5331-01	FRONT GLASS	M2
212	3C	*	B10-5332-01	FRONT GLASS	M3
212	3C	*	B10-5339-01	FRONT GLASS	C2
212	3C	*	B10-5380-01	FRONT GLASS	M4
212	3C	*	B10-5381-01	FRONT GLASS	M5
213	3C	*	B07-3327-03	ESCUTCHEON	M3C2
213	3C	*	B07-3328-03	ESCUTCHEON	M5E4
221	2C	*	D10-7099-03	LEVER	
222	2C	*	D10-7098-03	LEVER	
223	1C	*	D10-7106-04	LEVER	
225	3C	*	E29-2153-02	CONDUCTIVE RUBBER	
227	3D	*	E29-2154-04	CONDUCTIVE RUBBER	
DC1	1C		E30-6798-05	DC CORD	K1M2
DC1	1C	*	E30-6933-05	DC CORD	M3C2
DC2	1C		E30-6800-05	DC CORD	E5
DC2	1C	*	E30-6934-05	DC CORD	E3E4
DC2	1C	*	E30-6934-05	DC CORD	M4M5E2
FC1	2D	*	E39-1077-05	FLAT CABLE	
230	3C	*	F07-2219-03	COVER	
231	2D	*	F11-1874-03	SHIELDING COVER	
F1	2D		F52-0023-05	FUSE (MINI BLADE TYPE) (10A)	
236	2C	*	G01-4750-04	TORSION COIL SPRING	

Ref. No.	A d d	N e w	Parts No.	Description	Desti- nation
237	2C	*	G01-4749-04	COMPRESSION SPRING	
238	3C	*	G01-3244-04	COMPRESSION SPRING	
-		*	H54-4724-03	ITEM CARTON CASE	K1
-		*	H54-4727-03	ITEM CARTON CASE	E2
-		*	H54-4728-03	ITEM CARTON CASE	E3
-		*	H54-4729-03	ITEM CARTON CASE	E4
-		*	H54-4730-03	ITEM CARTON CASE	E5
-		*	H54-4734-03	ITEM CARTON CASE	M2
-		*	H54-4735-03	ITEM CARTON CASE	M3
-		*	H54-4759-03	ITEM CARTON CASE	M4
-		*	H54-4760-03	ITEM CARTON CASE	M5
-		*	H54-4822-03	ITEM CARTON CASE	C2
241	3C	*	J19-7287-11	HOLDER	
243	1C		J22-0789-03	MOUNTING HARDWARE ASSY	
251	3C	*	K24-5041-04	PUSH KNOB (EJECT)	
252	3C	*	K25-1983-03	PUSH KNOB (SRC/BAND)	
255	3C	*	K24-5043-03	PUSH KNOB (SEARCH)	
257	3C	*	K24-5042-04	PUSH KNOB (RELEASE)	
258	3C	*	K25-1982-02	PUSH KNOB (PRESET)	
261	3C		K28-0337-04	KNOB ASSY (VOL)	E3E4
261	3C		K28-0337-04	KNOB ASSY (VOL)	K1M3M4
261	3C		K28-0337-04	KNOB ASSY (VOL)	M5C2E2
261	3C	*	K28-0395-04	KNOB ASSY (VOL)	M2E5
262	1C		N84-4016-48	PAN HEAD TAPTITE SCREW	C2
262	1C		N84-4016-48	PAN HEAD TAPTITE SCREW	K1M2M3
264	1C		N99-1757-15	SCREW SET	C2
264	1C		N99-1757-15	SCREW SET	K1M2M3
B	3D		N35-2610-48	BINDING HEAD MACHINE SCREW	
C	3C		N80-2006-48	PAN HEAD TAPTITE SCREW	
D	2C		N80-2008-43	PAN HEAD TAPTITE SCREW	
E	2D		N86-2604-43	BINDING HEAD TAPTITE SCREW	
F	1D		N86-2606-48	BINDING HEAD TAPTITE SCREW	
266	1C		W01-1710-05	CARRYING CASE	E2E3E4
266	1C		W01-1710-05	CARRYING CASE	E5
266	1C		W01-1710-05	CARRYING CASE	K1M4M5
268	3D	*	X34-6600-11	ELECTRIC UNIT (for IC51)	K1
268	3D	*	X34-6600-22	ELECTRIC UNIT (for IC51)	M2
268	3D	*	X34-6600-23	ELECTRIC UNIT (for IC51)	M3C2
268	3D	*	X34-6602-72	ELECTRIC UNIT (for IC51)	E3E4
268	3D	*	X34-6602-72	ELECTRIC UNIT (for IC51)	M4M5E2
268	3D	*	X34-6602-73	ELECTRIC UNIT (for IC51)	E5
DME1	1D		X92-6370-00	MECHANISM ASSY (DXM-9B20W)	
<b>SWITCH UNIT (X16-675x-xx)</b>					
D51			B30-1566-05	LED (1608,RED)	
D52			B30-1780-05	LED (1608,PG)	E5
D52			B30-1780-05	LED (1608,PG)	M2C2E3
D55 ,56			B30-1780-05	LED (1608,PG)	E5
D55 ,56			B30-1780-05	LED (1608,PG)	M2C2E3
D56 -62			B30-1779-05	LED (1608,SR)	K1M3M4
D56 -62			B30-1779-05	LED (1608,SR)	M5E2E4
D58			B30-1780-05	LED (1608,PG)	E5
D58			B30-1780-05	LED (1608,PG)	M2C2E3
D62 -75			B30-1780-05	LED (1608,PG)	E5

**K1** : KDC-MP245U    **M2** : KDC-U3046    **M3** : KDC-U346    **M4** : KDC-4047UM    **M5** : KDC-414UM  
**C2** : KDC-U4046    **E2** : KDC-4047UA    **E3** : KDC-4047UG    **E4** : KDC-414UA    **E5** : KDC-4047UGY

△ Indicates safety critical components.

# PARTS LIST

## SWITCH UNIT (X16-675x-xx)

Ref. No.	Add	New	Parts No.	Description	Destination
D62 -75			B30-1780-05	LED (1608,PG)	M2C2E3
D65			B30-1779-05	LED (1608,SR)	K1M3M4
D65			B30-1779-05	LED (1608,SR)	M5E2E4
D91 -93			B30-1779-05	LED (1608,SR)	K1M3M4
D91 -93			B30-1779-05	LED (1608,SR)	M5E2E4
D92			B30-1780-05	LED (1608,PG)	E5
D92			B30-1780-05	LED (1608,PG)	M2C2E3
C11			CK73GB0J105K	CHIP C 1.0UF K	
C12			CK73HB1A104K	CHIP C 0.10UF K	
C13 -16			CC73GCH1H471J	CHIP C 470PF J	
C21			CK73GB0J105K	CHIP C 1.0UF K	K1M2M3
C21			CK73GB0J105K	CHIP C 1.0UF K	M4M5C2
C41 ,42			CK73HB1E103K	CHIP C 0.010UF K	
C81 ,82			CC73GCH1H330J	CHIP C 33PF J	
C83			CK73GB1H472K	CHIP C 4700PF K	
C84			CK73GB1H103K	CHIP C 0.010UF K	
J1	*		E59-0860-05	RECTANGULAR PLUG	
J2	*		E11-0669-05	3.5D PHONE JACK	
J3	*		E58-1129-05	RECTANGULAR RECEPTACLE	
CP11			RK74GA1J101J	CHIP-COM 100 J 1/16W	
R11			RK73HB1J473J	CHIP R 47K J 1/16W	
R12			RK73HB1J221J	CHIP R 220 J 1/16W	
R14			RK73HB1J472J	CHIP R 4.7K J 1/16W	
R15			RK73GB2A4R7J	CHIP R 4.7 J 1/10W	
R16			RK73HB1J102J	CHIP R 1.0K J 1/16W	
R21			RK73HB1J104J	CHIP R 100K J 1/16W	K1M2M3
R21			RK73HB1J104J	CHIP R 100K J 1/16W	M4M5C2
R22			RK73GB2A101J	CHIP R 100 J 1/10W	K1M2M3
R22			RK73GB2A101J	CHIP R 100 J 1/10W	M4M5C2
R23			RK73HB1J104J	CHIP R 100K J 1/16W	E2E3E4
R23			RK73HB1J104J	CHIP R 100K J 1/16W	E5
R24			RK73HB1J000J	CHIP R 0.0 J 1/16W	
R31			RK73PB2H120J	CHIP R 12 J 1/2W	
R51			RK73EB2E821J	CHIP R 820 J 1/4W	
R52			RK73FB2B621J	CHIP R 620 J 1/8W	K1M3M4
R52			RK73FB2B621J	CHIP R 620 J 1/8W	M5E2E4
R52 ,53			RK73FB2B621J	CHIP R 620 J 1/8W	E5
R52 ,53			RK73FB2B621J	CHIP R 620 J 1/8W	M2C2E3
R53			RK73FB2B561J	CHIP R 560 J 1/8W	K1M3M4
R53			RK73FB2B561J	CHIP R 560 J 1/8W	M5E2E4
R54 -56			RK73FB2B391J	CHIP R 390 J 1/8W	E5
R54 -56			RK73FB2B391J	CHIP R 390 J 1/8W	M2C2E3
R54 -57			RK73FB2B621J	CHIP R 620 J 1/8W	K1M3M4
R54 -57			RK73FB2B621J	CHIP R 620 J 1/8W	M5E2E4
R58			RK73FB2B391J	CHIP R 390 J 1/8W	E5
R58			RK73FB2B391J	CHIP R 390 J 1/8W	M2C2E3
R61			RK73FB2B391J	CHIP R 390 J 1/8W	E5
R61			RK73FB2B391J	CHIP R 390 J 1/8W	M2C2E3
R75			RK73GB2A271J	CHIP R 270 J 1/10W	K1M3M4
R75			RK73GB2A271J	CHIP R 270 J 1/10W	M5E2E4
R81 ,82			RK73GB2A220J	CHIP R 22 J 1/10W	
S1			T99-0484-05	ROTARY ENCODER	

Ref. No.	Add	New	Parts No.	Description	Destination
D81		*	HZM6.8ZMWA-E	ZENER DIODE	
D82			DA204U	DIODE	
ED1		*	3-BT-267N	FLUORESCENT INDICATOR TUBE	
IC1			BU9754KV-E2	MOS-IC	K1M2M3
IC2			PIC95603	ANALOGUE IC	
IC2			PIC95603	ANALOGUE IC	M4M5C2
<b>CD PLAYER UNIT (X32-6250-00) IN CD MECHA</b>					
C1			CK73FB0J106K	CHIP C 10UF K	
C3			CC73GCH1H680J	CHIP C 68PF J	
C4			CK73GB1A105K	CHIP C 1.0UF K	
C6			CK73FB1C105K	CHIP C 1.0UF K	
C8			CK73GB1H222K	CHIP C 2200PF K	
C9 ,10			CK73GB1C104K	CHIP C 0.10UF K	
C11			CK73GB1H153K	CHIP C 0.015UF K	
C12			CK73GB1C104K	CHIP C 0.10UF K	
C13			CK73GB1H332K	CHIP C 3300PF K	
C14			CK73GB1H103K	CHIP C 0.010UF K	
C15			CK73GB1C333K	CHIP C 0.033UF K	
C16			CK73GB1C104K	CHIP C 0.10UF K	
C18			CK73GB1H153K	CHIP C 0.015UF K	
C19			CK73GB1H103K	CHIP C 0.010UF K	
C20			CK73GB1C104K	CHIP C 0.10UF K	
C22			CK73GB1H103K	CHIP C 0.010UF K	
C23			CK73GB1H153K	CHIP C 0.015UF K	
C24			CC73GCH1H470J	CHIP C 47PF J	
C25			CK73GB1C104K	CHIP C 0.10UF K	
C26			CK73GB1A105K	CHIP C 1.0UF K	
C27			CK73GB1C104K	CHIP C 0.10UF K	
C29 ,30			CK73GB1C104K	CHIP C 0.10UF K	
C31			CK73GB1A105K	CHIP C 1.0UF K	
C36			CK73GB1A105K	CHIP C 1.0UF K	
C41 ,42			CK73GB1C104K	CHIP C 0.10UF K	
C43 ,44			CK73GB1H102K	CHIP C 1000PF K	
C45			CK73GB1H103K	CHIP C 0.010UF K	
C46			CK73GB1A105K	CHIP C 1.0UF K	
C47			CC73GCH1H560J	CHIP C 56PF J	
C48			CC73GCH1H101J	CHIP C 100PF J	
C49			CK73GB1A105K	CHIP C 1.0UF K	
C50			CK73FB1A225K	CHIP C 2.2UF K	
C51			CK73FB0J106K	CHIP C 10UF K	
C54			CK73FB0J106K	CHIP C 10UF K	
C57			CK73GB1C104K	CHIP C 0.10UF K	
C59			CK73GB1H472K	CHIP C 4700PF K	
C61			CK73GB1C104K	CHIP C 0.10UF K	
C101			CK73GB1A105K	CHIP C 1.0UF K	
C103			CK73GB1C104K	CHIP C 0.10UF K	
CN1			E41-2954-05	FLAT CABLE CONNECTOR	
CN2			E41-2630-05	FLAT CABLE CONNECTOR	
X1			L78-1221-05	RESONATOR (16.93MHZ)	
CP7			RK74GB1J103J	CHIP-COM 10K J 1/16W	
R1			RK73GB2A560J	CHIP R 56 J 1/10W	
R2			RK73GB2A472J	CHIP R 4.7K J 1/10W	
R3			RK73GB2A4R7J	CHIP R 4.7 J 1/10W	

**K1** : KDC-MP245U **M2** : KDC-U3046 **M3** : KDC-U346 **M4** : KDC-4047UM **M5** : KDC-414UM  
**C2** : KDC-U4046 **E2** : KDC-4047UA **E3** : KDC-4047UG **E4** : KDC-414UA **E5** : KDC-4047UGY

△ Indicates safety critical components.

# PARTS LIST

## CD PLAYER UNIT (X32-6250-00) IN CD MECHA

Ref. No.	A d d	N e w	Parts No.	Description	Desti- nation
R4			RK73GB2A104J	CHIP R 100K J 1/10W	
R5			RK73GB2A225J	CHIP R 2.2M J 1/10W	
R6			RK73GB2A102J	CHIP R 1.0K J 1/10W	
R7			RK73GB2A221J	CHIP R 220 J 1/10W	
R8			RK73GB2A622J	CHIP R 6.2K J 1/10W	
R9			RK73GB2A913J	CHIP R 91K J 1/10W	
R10			RK73GB2A334J	CHIP R 330K J 1/10W	
R11			RK73GB2A153J	CHIP R 15K J 1/10W	
R13			RK73GB2A104J	CHIP R 100K J 1/10W	
R14			RK73GB2A103J	CHIP R 10K J 1/10W	
R15			RK73GB2A101J	CHIP R 100 J 1/10W	
R17 ,18			RK73GB2A103J	CHIP R 10K J 1/10W	
R25			RK73GB2A103J	CHIP R 10K J 1/10W	
R27			RK73EB2E4R7J	CHIP R 4.7 J 1/4W	
R39			RK73GB2A105J	CHIP R 1.0M J 1/10W	
R40			RK73GB2A681J	CHIP R 680 J 1/10W	
R43 ,44			RK73GB2A4R7J	CHIP R 4.7 J 1/10W	
R49			RK73GB2A393J	CHIP R 39K J 1/10W	
R50			RK73GB2A363J	CHIP R 36K J 1/10W	
R51			RK73GB2A102J	CHIP R 1.0K J 1/10W	
R52 -58			RK73GB2A101J	CHIP R 100 J 1/10W	
R59			RK73GB2A204J	CHIP R 200K J 1/10W	
R64			RK73GB2A223J	CHIP R 22K J 1/10W	
R65			RK73GB2A333J	CHIP R 33K J 1/10W	
R69 -73			RK73GB2A101J	CHIP R 100 J 1/10W	
R74 ,75			RK73GB2A103J	CHIP R 10K J 1/10W	
R76			RK73GB2A202J	CHIP R 2.0K J 1/10W	
R102			RK73GB2A102J	CHIP R 1.0K J 1/10W	
S1 ,2			S68-0924-05	PUSH SWITCH	
D2			DAP202U	DIODE	
D3 ,4			DA204U	DIODE	
IC3			BD8222EFV	ANALOGUE IC	
IC4			TC94A92FG-301	MOS-IC	
IC5			XC6415S001P1	MOS-IC	
Q1			2SB0970	TRANSISTOR	
Q14			RUE003N02	FET	
<b>ELECTRIC UNIT (X34-660x-xx)</b>					
C1		*	C90-6906-05	ELECTRO 3300UF 16WV	
C2			CD04AV1C220M	ELECTRO 22UF 16WV	
C3			CK73GB1H104K	CHIP C 0.10UF K	E2E3E4
C3			CK73GB1H104K	CHIP C 0.10UF K	E5
C3			CK73GB1H104K	CHIP C 0.10UF K	K1M4M5
C3 ,4			CK73GB1H104K	CHIP C 0.10UF K	M2M3C2
C5			CD04BN1C221M	ELECTRO 220UF 16WV	
C7			CD04AV0J101M	ELECTRO 100UF 6.3WV	
C9			CK73GB1C104K	CHIP C 0.10UF K	
C11			CK73FB1A225K	CHIP C 2.2UF K	
C14			CK73GB1C104K	CHIP C 0.10UF K	
C17			CK73GB1C104K	CHIP C 0.10UF K	
C55			CK73FB0J106K	CHIP C 10UF K	
C56			CK73GB1H102K	CHIP C 1000PF K	
C57			CK73GB1A474K	CHIP C 0.47UF K	
C58			CK73FB0J106K	CHIP C 10UF K	

Ref. No.	A d d	N e w	Parts No.	Description	Desti- nation
C59 ,60			CK73GB1C104K	CHIP C 0.10UF K	
C64			CD04BK1A221M	ELECTRO 220UF 10WV	
C65			CK73GB1H103K	CHIP C 0.010UF K	
C66 ,67			CK73GB1A105K	CHIP C 1.0UF K	
C68			CD04AV0J470M	ELECTRO 47UF 6.3WV	
C69			CK73GB1C104K	CHIP C 0.10UF K	
C73			CK73EB1H475K	CHIP C 4.7UF K	
C75			CC73GCH1H390J	CHIP C 39PF J	
C101,102			CK73GB1H103K	CHIP C 0.010UF K	
C201			CK73GB1A105K	CHIP C 1.0UF K	
C202			CC73GCH1H270J	CHIP C 27PF J	
C203			CC73GCH1H220J	CHIP C 22PF J	
C204			CK73GB1C104K	CHIP C 0.10UF K	
C207,208			CK73GB1C104K	CHIP C 0.10UF K	
C301,302			CD04AV1HR47M	ELECTRO 0.47UF 50WV	
C303			CC73GCH1H150J	CHIP C 15PF J	
C306,307			CK73GB1C104K	CHIP C 0.10UF K	
C308			CD04AV0J470M	ELECTRO 47UF 6.3WV	
C309			CK73GB1H103K	CHIP C 0.010UF K	
C310,311			CK73GB1H102K	CHIP C 1000PF K	
C315,316			CC73GCH1H100D	CHIP C 10PF D	
C401			CD04AV1C470M	ELECTRO 47UF 16WV	
C403			CD04AV1H010M	ELECTRO 1UF 50WV	
C404-407			CK73GB1A105K	CHIP C 1.0UF K	
C501			CK73GB1H102K	CHIP C 1000PF K	
C502			CK73GB1A105K	CHIP C 1.0UF K	
C505			CK73GB1A224K	CHIP C 0.22UF K	
C506			CK73GB1C104K	CHIP C 0.10UF K	
C507			CC73GCH1H090D	CHIP C 9.0PF D	
C509-511			CK73GB1A105K	CHIP C 1.0UF K	
C512-514			CK73GB1H103K	CHIP C 0.010UF K	
C515			CK73GB1C104K	CHIP C 0.10UF K	
C516			CK73GB1H103K	CHIP C 0.010UF K	
C517			CK73GB1C104K	CHIP C 0.10UF K	
C518			CK73GB1H102K	CHIP C 1000PF K	
C519			CD04AV1C470M	ELECTRO 47UF 16WV	
C520			CK73GB1C104K	CHIP C 0.10UF K	
C523			CK73GB1H102K	CHIP C 1000PF K	
C524			CK73GB1A224K	CHIP C 0.22UF K	
C525			CC73GCH1H270J	CHIP C 27PF J	
C527			CC73GCH1H150J	CHIP C 15PF J	
C528			CC73GCH1H471J	CHIP C 470PF J	E2E3E4
C528			CC73GCH1H471J	CHIP C 470PF J	E5
C528			CC73GCH1H471J	CHIP C 470PF J	K1M4M5
C530			CK73GB1H102K	CHIP C 1000PF K	
C531			CC73GCH1H070D	CHIP C 7.0PF D	E2E3E4
C531			CC73GCH1H070D	CHIP C 7.0PF D	E5
C531			CC73GCH1H070D	CHIP C 7.0PF D	K1M4M5
C531,532			CC73GCH1H040C	CHIP C 4.0PF C	M2M3C2
C532			CC73GCH1H060D	CHIP C 6.0PF D	E2E3E4
C532			CC73GCH1H060D	CHIP C 6.0PF D	E5
C532			CC73GCH1H060D	CHIP C 6.0PF D	K1M4M5
C533			CC73GCH1H020C	CHIP C 2.0PF C	E2E3E4
C533			CC73GCH1H020C	CHIP C 2.0PF C	E5
C533			CC73GCH1H020C	CHIP C 2.0PF C	K1M4M5

**K1** : KDC-MP245U    **M2** : KDC-U3046    **M3** : KDC-U346    **M4** : KDC-4047UM    **M5** : KDC-414UM  
**C2** : KDC-U4046    **E2** : KDC-4047UA    **E3** : KDC-4047UG    **E4** : KDC-414UA    **E5** : KDC-4047UGY

△Indicates safety critical components.

# PARTS LIST

## ELECTRIC UNIT (X34-660x-xx)

Ref. No.	Add	New	Parts No.	Description	Destination	Ref. No.	Add	New	Parts No.	Description	Destination
C534			CC73GCH1H471J	CHIP C 470PF J	M2M3C2	L507		*	L40-1891-58	SMALL FIXED INDUCTOR (1.8UH)	E2E3E4
C535			CC73GCH1H221J	CHIP C 220PF J		L507		*	L40-1891-58	SMALL FIXED INDUCTOR (1.8UH)	E5
C542			CK73GB1H103K	CHIP C 0.010UF K	E3E4E5	L507		*	L40-1891-58	SMALL FIXED INDUCTOR (1.8UH)	K1M4M5
C542			CK73GB1H103K	CHIP C 0.010UF K	M4M5E2	L507		*	L40-3391-58	SMALL FIXED INDUCTOR (3.3UH)	M2M3C2
C544			CC73GCH1H331J	CHIP C 330PF J	E3E4E5	L508		*	L40-4781-58	SMALL FIXED INDUCTOR	
C544			CC73GCH1H331J	CHIP C 330PF J	M4M5E2	L551		*	L31-0993-05	FM-RF COIL	
C545,546			CC73GCH1H120J	CHIP C 12PF J	E3E4E5	X1		*	L78-1235-05	RESONATOR (16.0MHZ)	
C545,546			CC73GCH1H120J	CHIP C 12PF J	M4M5E2	X2		*	L77-2920-05	CRYSTAL RESONATOR	
C548			CK73GB0J225K	CHIP C 2.2UF K	E3E4E5	X3		*	L77-3825-05	CRYSTAL RESONATOR (4.332MHZ)	E3E4E5
C548			CK73GB0J225K	CHIP C 2.2UF K	M4M5E2	X3		*	L77-3825-05	CRYSTAL RESONATOR (4.332MHZ)	M4M5E2
C549			CK73GB1H103K	CHIP C 0.010UF K		X501		*	L77-3824-05	CRYSTAL RESONATOR (4.000MHZ)	
C703,704			CD04AV1V100M	ELECTRO 10UF 35WV	E2E3E4	X900		*	L77-2921-15	CRYSTAL RESONATOR (32.768KHZ)	
C703,704			CD04AV1V100M	ELECTRO 10UF 35WV	K1M2M3	X901		*	L77-3826-05	CRYSTAL RESONATOR (9.00MHZ)	
C703,704			CD04AV1V100M	ELECTRO 10UF 35WV	M4M5C2						
C801-804			CK73GB1A224K	CHIP C 0.22UF K		G	2D		N80-3008-48	PAN HEAD TAPTITE SCREW	E2E3E4
C805			CD04AV1V100M	ELECTRO 10UF 35WV		G	2D		N80-3008-48	PAN HEAD TAPTITE SCREW	K1M2M3
C806,807			CK73GB1A105K	CHIP C 1.0UF K		G	2D		N80-3008-48	PAN HEAD TAPTITE SCREW	M4M5C2
C809			CK73GB1A105K	CHIP C 1.0UF K		H	2D		N83-3005-48	PAN HEAD TAPTITE SCREW	
C851-858			CK73GB1H472K	CHIP C 4700PF K		J	2D		N83-3016-48	PAN HEAD TAPTITE SCREW	
C859			CK73GB1H104K	CHIP C 0.10UF K		K	2D		N86-2606-48	BINDING HEAD TAPTITE SCREW	
C901			CK73GB1H103K	CHIP C 0.010UF K		L	2D		N89-3010-48	BINDING HEAD TAPTITE SCREW	
C902			CC73GCH1H180J	CHIP C 18PF J		R1			RD14BB2C102J	RD 1.0K J 1/6W	
C903			CC73GCH1H220J	CHIP C 22PF J		R2 ,3			RK73GB2A103J	CHIP R 10K J 1/10W	
C904-906			CK73GB1H103K	CHIP C 0.010UF K		R5			RK73GB2A103J	CHIP R 10K J 1/10W	
C908,909			CK73GB1H103K	CHIP C 0.010UF K		R15			RD14DB2H7R5J	SMALL-RD 7.5 J 1/2W	
C911,912			CC73GCH1H100D	CHIP C 10PF D		R19			RK73GB2A100J	CHIP R 10 J 1/10W	
C914			CK73GB1H103K	CHIP C 0.010UF K		R53			RK73GH2A153D	CHIP R 15K D 1/10W	
C915			CK73GB1A105K	CHIP C 1.0UF K		R54			RK73GH2A823D	CHIP R 82K D 1/10W	
C916,917			CK73FB0J106K	CHIP C 10UF K		R55			RK73GB2A103J	CHIP R 10K J 1/10W	
C918			CK73GB1A105K	CHIP C 1.0UF K		R56			RK73GH2A223D	CHIP R 22K D 1/10W	
C922			CK73FB0J106K	CHIP C 10UF K		R57			RK73GH2A333D	CHIP R 33K D 1/10W	
C955			CC73GCH1H070D	CHIP C 7.0PF D		R58			RK73GB2A473J	CHIP R 47K J 1/10W	
CN2			E41-1828-05	FLAT CABLE CONNECTOR		R59			RK73GB2A203J	CHIP R 20K J 1/10W	
△ J1			E58-0991-05	RECTANGULAR RECEPTACLE		R62			RK73GB2A223J	CHIP R 22K J 1/10W	
J3			E58-1060-15	RECTANGULAR RECEPTACLE		R101			RD14BB2C472J	RD 4.7K J 1/6W	K1
J5		*	E63-0974-05	PIN JACK	E2E3E4	R101,102			RD14BB2C472J	RD 4.7K J 1/6W	E3E4E5
J5		*	E63-0974-05	PIN JACK	K1M2M3	R101,102			RD14BB2C472J	RD 4.7K J 1/6W	M2M3M4
J5		*	E63-0974-05	PIN JACK	M4M5C2	R106			RD14BB2C332J	RD 3.3K J 1/6W	M5C2E2
W551	2D		E30-6803-05	CORD WITH PLUG		R107			RD14BB2C333J	RD 33K J 1/6W	
△ L1			L33-2459-05	CHOKE COIL ASSY		R108			RK73GB2A103J	CHIP R 10K J 1/10W	
L51			L33-2462-05	SMALL FIXED INDUCTOR (22UH)		R109			RK73GB2A223J	CHIP R 22K J 1/10W	
L71			L92-0639-05	CHIP FERRITE		R110			RK73FB2B683J	CHIP R 68K J 1/8W	
L73			L92-0639-05	CHIP FERRITE		R111			RK73GB2A473J	CHIP R 47K J 1/10W	
L401			L40-4791-58	SMALL FIXED INDUCTOR		R112			RD14BB2C203J	RD 20K J 1/6W	
L501			L40-4791-58	SMALL FIXED INDUCTOR		R113			RK73GB2A104J	CHIP R 100K J 1/10W	
L502,503			L33-1031-05	SMALL FIXED INDUCTOR		R114,115			RK73GB2A103J	CHIP R 10K J 1/10W	
L504		*	L40-2781-58	SMALL FIXED INDUCTOR (0.27UH)		R116,117			RK73GB2A682J	CHIP R 6.8K J 1/10W	
L505		*	L40-4791-58	SMALL FIXED INDUCTOR	E2E3E4	R118			RD14BB2C103J	RD 10K J 1/6W	
L505		*	L40-4791-58	SMALL FIXED INDUCTOR	E5	R119			RK73GB2A473J	CHIP R 47K J 1/10W	
L505			L40-4791-58	SMALL FIXED INDUCTOR	K1M4M5	R120			RK73GB2A104J	CHIP R 100K J 1/10W	
L506			L40-1091-58	SMALL FIXED INDUCTOR (1.0UH)	M2M3C2	R151			RK73GB2A000J	CHIP R 0.0 J 1/10W	M2M3C2
L506		*	L40-4781-58	SMALL FIXED INDUCTOR	E2E3E4	R152			RK73GB2A000J	CHIP R 0.0 J 1/10W	E3E4E5
L506		*	L40-4781-58	SMALL FIXED INDUCTOR	E5	R152			RK73GB2A000J	CHIP R 0.0 J 1/10W	M4M5E2
L506		*	L40-4781-58	SMALL FIXED INDUCTOR	K1M4M5	R203,204			RK73GB2A103J	CHIP R 10K J 1/10W	

K1 : KDC-MP245U M2 : KDC-U3046 M3 : KDC-U346 M4 : KDC-4047UM M5 : KDC-414UM  
C2 : KDC-U4046 E2 : KDC-4047UA E3 : KDC-4047UG E4 : KDC-414UA E5 : KDC-4047UGY

△ Indicates safety critical components.

# PARTS LIST

## ELECTRIC UNIT (X34-660x-xx)

Ref. No.	Ad	New	Parts No.	Description	Desti- nation	Ref. No.	Ad	New	Parts No.	Description	Desti- nation
R205			RK73GB2A473J	CHIP R 47K J 1/10W		R527			RK73GB2A4R7J	CHIP R 4.7 J 1/10W	
R207			RK73GB2A473J	CHIP R 47K J 1/10W		R541			RD14BB2C222J	RD 2.2K J 1/6W	E3E4E5
R208			RD14BB2C473J	RD 47K J 1/6W		R541			RD14BB2C222J	RD 2.2K J 1/6W	M4M5E2
R209-212			RK73GB2A471J	CHIP R 470 J 1/10W		R542,543			RK73GB2A222J	CHIP R 2.2K J 1/10W	E3E4E5
R218			RK73GB2A223J	CHIP R 22K J 1/10W		R542,543			RK73GB2A222J	CHIP R 2.2K J 1/10W	M4M5E2
R225			RK73GB2A223J	CHIP R 22K J 1/10W	E5	R544			RK73GB2A512J	CHIP R 5.1K J 1/10W	E3E4E5
R225			RK73GB2A473J	CHIP R 47K J 1/10W	E3E4	R544			RK73GB2A512J	CHIP R 5.1K J 1/10W	M4M5E2
R225			RK73GB2A473J	CHIP R 47K J 1/10W	M2M3M4	R545			RK73GB2A102J	CHIP R 1.0K J 1/10W	E3E4E5
R225			RK73GB2A473J	CHIP R 47K J 1/10W	M5C2E2	R545			RK73GB2A102J	CHIP R 1.0K J 1/10W	M4M5E2
R226			RK73GB2A223J	CHIP R 22K J 1/10W	M2M3C2	R650			RK73EB2E471J	CHIP R 470 J 1/4W	C2E2E3
R226			RK73GB2A473J	CHIP R 47K J 1/10W	K1E5	R650			RK73EB2E471J	CHIP R 470 J 1/4W	E4
R228			RK73GB2A473J	CHIP R 47K J 1/10W		R650			RK73GB2A331J	CHIP R 330 J 1/10W	M3M4M5
R231,232			RK73GB2A472J	CHIP R 4.7K J 1/10W		R713,714			RK73GB2A331J	CHIP R 330 J 1/10W	E2E3E4
R251,252			RK73GB2A101J	CHIP R 100 J 1/10W		R713,714			RK73GB2A331J	CHIP R 330 J 1/10W	K1M2M3
R253,254			RK73GB2A223J	CHIP R 22K J 1/10W		R713,714			RK73GB2A331J	CHIP R 330 J 1/10W	M4M5C2
R255-257			RK73GB2A101J	CHIP R 100 J 1/10W		R715,716			RK73GB2A223J	CHIP R 22K J 1/10W	E2E3E4
R258			RK73GB2A223J	CHIP R 22K J 1/10W		R715,716			RK73GB2A223J	CHIP R 22K J 1/10W	K1M2M3
R259			RK73GB2A101J	CHIP R 100 J 1/10W		R715,716			RK73GB2A223J	CHIP R 22K J 1/10W	M4M5C2
R260			RK73GB2A223J	CHIP R 22K J 1/10W		R717,718			RK73FB2B181J	CHIP R 180 J 1/8W	E2E3E4
R261-267			RK73GB2A101J	CHIP R 100 J 1/10W		R717,718			RK73FB2B181J	CHIP R 180 J 1/8W	K1M2M3
R268-271			RK73GB2A473J	CHIP R 47K J 1/10W		R717,718			RK73FB2B181J	CHIP R 180 J 1/8W	M4M5C2
R301			RK73GB2A222J	CHIP R 2.2K J 1/10W		R754			RK73EB2E000J	CHIP R 0.0 J 1/4W	
R302			RD14BB2C101J	RD 100 J 1/6W		R755,756			RK73GB2A000J	CHIP R 0.0 J 1/10W	
R306,307			RK73GB2A222J	CHIP R 2.2K J 1/10W		R802			RK73GB2A473J	CHIP R 47K J 1/10W	
R308			RK73GB2A100J	CHIP R 10 J 1/10W		R804			RK73GB2A331J	CHIP R 330 J 1/10W	
R317			RK73GB2A222J	CHIP R 2.2K J 1/10W		R805			RK73GB2A473J	CHIP R 47K J 1/10W	
R318			RK73GB2A472J	CHIP R 4.7K J 1/10W		R806			RK73GB2A512J	CHIP R 5.1K J 1/10W	
R319			RK73GB2A222J	CHIP R 2.2K J 1/10W		R808			RK73GB2A100J	CHIP R 10 J 1/10W	
R320			RK73GB2A472J	CHIP R 4.7K J 1/10W		R809			RD14BB2C102J	RD 1.0K J 1/6W	
R330			RD14BB2C101J	RD 100 J 1/6W		R811			RK73GB2A473J	CHIP R 47K J 1/10W	
R331			RK73GB2A392J	CHIP R 3.9K J 1/10W		R812			RK73GB2A432J	CHIP R 4.3K J 1/10W	
R332			RD14BB2C101J	RD 100 J 1/6W		R813			RK73EB2E000J	CHIP R 0.0 J 1/4W	
R333,334			RD14BB2C102J	RD 1.0K J 1/6W		R814			RK73GB2A000J	CHIP R 0.0 J 1/10W	
R335			RK73GB2A473J	CHIP R 47K J 1/10W		R900			RK73GB2A102J	CHIP R 1.0K J 1/10W	
R336-339			RK73GB2A222J	CHIP R 2.2K J 1/10W		R904			RK73GB2A223J	CHIP R 22K J 1/10W	
R340			RK73GB2A225J	CHIP R 2.2M J 1/10W		R905			RK73GB2A101J	CHIP R 100 J 1/10W	
R341			RK73GB2A222J	CHIP R 2.2K J 1/10W		R906			RK73GB2A223J	CHIP R 22K J 1/10W	
R342			RK73GB2A392J	CHIP R 3.9K J 1/10W		R907			RK73GB2A104J	CHIP R 100K J 1/10W	
R343			RD14BB2C102J	RD 1.0K J 1/6W		R908			RK73GB2A101J	CHIP R 100 J 1/10W	
R344,345			RD14BB2C4R7J	RD 4.7 J 1/6W		R909,910			RK73GB2A102J	CHIP R 1.0K J 1/10W	
R346			RD14BB2C2R2J	RD 2.2 J 1/6W		R911			RK73GB2A223J	CHIP R 22K J 1/10W	
R347			RK73GB2A102J	CHIP R 1.0K J 1/10W		R913			RK73GB2A101J	CHIP R 100 J 1/10W	
R348,349			RK73GB2A103J	CHIP R 10K J 1/10W		R914			RK73GB2A223J	CHIP R 22K J 1/10W	
R352,353			RD14BB2C100J	RD 10 J 1/6W		R915			RK73GB2A102J	CHIP R 1.0K J 1/10W	
R401			RK73GB2A103J	CHIP R 10K J 1/10W		R916			RK73GB2A101J	CHIP R 100 J 1/10W	
R402,403			RK73GB2A471J	CHIP R 470 J 1/10W		R917,918			RK73GB2A102J	CHIP R 1.0K J 1/10W	
R505			RK73GB2A472J	CHIP R 4.7K J 1/10W		R919			RK73GB2A101J	CHIP R 100 J 1/10W	
R506			RK73EB2E220J	CHIP R 22 J 1/4W		R920			RK73GB2A223J	CHIP R 22K J 1/10W	
R507,508			RK73GB2A221J	CHIP R 220 J 1/10W		R921			RK73GB2A101J	CHIP R 100 J 1/10W	
R513,514			RK73GB2A474J	CHIP R 470K J 1/10W	M2M3C2	R924			RK73GB2A101J	CHIP R 100 J 1/10W	
R513,514			RK73GB2A684J	CHIP R 680K J 1/10W	E2E3E4	R926			RK73GB2A000J	CHIP R 0.0 J 1/10W	
R513,514			RK73GB2A684J	CHIP R 680K J 1/10W	E5	R927			RK73GB2A105J	CHIP R 1.0M J 1/10W	
R515,516			RK73GB2A392J	CHIP R 3.9K J 1/10W	K1M4M5	R928			RK73GB2A223J	CHIP R 22K J 1/10W	
R525			RK73GB2A101J	CHIP R 100 J 1/10W	M2M3C2	R929			RK73GB2A100J	CHIP R 10 J 1/10W	
						R930			RK73GB2A153J	CHIP R 15K J 1/10W	

**K1** : KDC-MP245U    **M2** : KDC-U3046    **M3** : KDC-U346    **M4** : KDC-4047UM    **M5** : KDC-414UM  
**C2** : KDC-U4046    **E2** : KDC-4047UA    **E3** : KDC-4047UG    **E4** : KDC-414UA    **E5** : KDC-4047UGY

△Indicates safety critical components.

# PARTS LIST

## ELECTRIC UNIT (X34-660x-xx)

Ref. No.	Add	New	Parts No.	Description	Destination	Ref. No.	Add	New	Parts No.	Description	Destination
R931			RK73GB2A100J	CHIP R 10 J 1/10W		IC501		*	TEF6606T/V5S3	ANALOGUE IC	M4M5E2
R932			RK73GB2A153J	CHIP R 15K J 1/10W		IC900		*	92CD28AFG7EG0	MICROCONTROLLER IC	
R934-937			RK73GB2A101J	CHIP R 100 J 1/10W		Q2			KTA1046-P	TRANSISTOR	
R938			RK73GB2A223J	CHIP R 22K J 1/10W		Q3		*	2SC4154T1 (E,F)	TRANSISTOR	
R939,940			RK73GB2A101J	CHIP R 100 J 1/10W		Q11		*	RT1N241M-T111	TRANSISTOR	
R941			RK73GB2A332J	CHIP R 3.3K J 1/10W		Q12		*	RT1P241M-T111	TRANSISTOR	
R942			RK73GB2A101J	CHIP R 100 J 1/10W		Q13		*	RT1N241M-T111	TRANSISTOR	M2M3C2
R943			RK73GB2A332J	CHIP R 3.3K J 1/10W		Q14		*	RT1P241M-T111	TRANSISTOR	M2M3C2
R944-946			RK73GB2A101J	CHIP R 100 J 1/10W		Q53		*	RT1N441M-T111	TRANSISTOR	
R947			RK73GB2A223J	CHIP R 22K J 1/10W		Q101-103			2SC4081	TRANSISTOR	
R955			RK73GB2A101J	CHIP R 100 J 1/10W		Q104,105		*	RT1N441M-T111	TRANSISTOR	
R967			RK73GB2A223J	CHIP R 22K J 1/10W		Q301		*	RT1P144M-T111	TRANSISTOR	
R969			RK73FB2B2R2J	CHIP R 2.2 J 1/8W		Q705,706		*	RT1N430M-T111	TRANSISTOR	E2E3E4
R970			RK73GB2A000J	CHIP R 0.0 J 1/10W		Q705,706		*	RT1N430M-T111	TRANSISTOR	K1M2M3
R972			RK73GB2A102J	CHIP R 1.0K J 1/10W		Q705,706		*	RT1N430M-T111	TRANSISTOR	M4M5C2
R974			RK73GB2A000J	CHIP R 0.0 J 1/10W		Q707		*	RT1P241M-T111	TRANSISTOR	E2E3E4
S3	*		S70-0959-05	TACT SWITCH		Q707		*	RT1P241M-T111	TRANSISTOR	K1M2M3
D1			S2V60-5009F46	DIODE		Q707		*	RT1P241M-T111	TRANSISTOR	M4M5C2
D2			HZS9-E (A1)	ZENER DIODE		Q902		*	RT1N144M-T111	TRANSISTOR	
D3			D1F60-5063	DIODE		Q903		*	2SA1577	TRANSISTOR	
D4 ,5	*		HSS4148	DIODE	M2M3C2	Q905		*	RT1N441M-T111	TRANSISTOR	
D51			CMS14	DIODE		TH1			PRF18BE471QS2	POSITIVE RESISTOR	
D101-104			D1F60-5063	DIODE	E3E4E5	<b>MECHANISM ASSY (X92-6370-00) DXM-9B20W</b>					
D101-104			D1F60-5063	DIODE	M2M3M4	1	2B	*	A10-5450-63	CHASSIS ASSY	
D101-104			D1F60-5063	DIODE	M5C2E2	3	3B		A10-5452-41	CHASSIS	
D101,102			D1F60-5063	DIODE	K1	4	1B		A10-5453-32	CHASSIS	
D106-108			MTZJ6.8 (B)	ZENER DIODE		12	3A		D10-4993-52	LEVER	
D109			HZS5-E (B1)	ZENER DIODE		13	1B		D10-4991-22	ARM	
D110	*		MC2848-T111	DIODE		14	1B		D10-4992-13	ARM	
D304-306			HZS7-E (A3)	ZENER DIODE		15	2A		D10-4994-02	SLIDER	
D311,312			LVS10C270S030	VARIATOR		16	2A		D10-4995-03	SLIDER	
D313	*		HZM6.8ZMWA-E	ZENER DIODE		17	2B		D10-4996-02	SLIDER	
D401	*		HSS4148	DIODE		18	2A		D10-4997-03	LEVER	
D501			IMSA-6802-E	SURGE ABSORBER		19	1A		D10-4998-03	ARM	
D650			HZS7-E (A3)	ZENER DIODE	C2E2E3	20	2A		D10-4999-03	ARM	
D650			HZS7-E (A3)	ZENER DIODE	E4	21	2A		D10-7001-03	ARM	
D650			HZS7-E (A3)	ZENER DIODE	M3M4M5	22	2A		D10-7002-03	ARM	
D801,802	*		HSS4148	DIODE		23	2A		D10-7003-03	ARM	
IC1	*		W05-1544-00	MICROCONTROLLER IC		24	2A		D13-2445-04	GEAR	
IC2	*		E-TDA7718N	ANALOGUE IC		25	2A		D13-2446-04	GEAR	
IC4	*		BD49131-V4	ANALOGUE IC		27	2A		D13-2448-04	GEAR	
IC6	*		TB2926HQ	ANALOGUE IC		28	2A		D13-2449-04	GEAR	
IC7			E-TDA7478AD	ANALOGUE IC	E3E4E5	29	2A		D13-2450-04	GEAR	
IC7			E-TDA7478AD	ANALOGUE IC	M4M5E2	30	2A		D13-2451-04	GEAR	
IC8	*		XC6120N362N-G	MOS-IC		31	2A		D13-2452-04	GEAR	
IC51	2D		Impossible to repair	ANALOGUE IC (See exploded view)		32	2A		D13-2453-04	GEAR	
IC52	*		BD2224G	MOS-IC		33	2A		D13-2454-04	GEAR	
IC53			R1114N331B-TR	ANALOGUE IC		34	2A		D13-2455-04	GEAR	
IC251			TC74VHCT08AFT	MOS-IC		35	2B		D13-2456-03	RACK (GEAR)	
IC252			74LVC08APW	MOS-IC		36	2A		D14-1028-04	ROLLER	
IC501	*		TEF6606T/V5	ANALOGUE IC	C2	37	3A		D21-2507-04	SHAFT	
IC501	*		TEF6606T/V5	ANALOGUE IC	K1M2M3	38	2B		D21-2508-04	SHAFT	
IC501	*		TEF6606T/V5S3	ANALOGUE IC	E3E4E5	39	3A		D23-0963-04	RETAINER	
						40	3B		D39-0277-15	DAMPER	

K1 : KDC-MP245U M2 : KDC-U3046 M3 : KDC-U346 M4 : KDC-4047UM M5 : KDC-414UM  
C2 : KDC-U4046 E2 : KDC-4047UA E3 : KDC-4047UG E4 : KDC-414UA E5 : KDC-4047UGY

△ Indicates safety critical components.

# PARTS LIST

## MECHANISM ASSY (X92-6370-00) DXM-9B20W

Ref. No.	A d d	N e w	Parts No.	Description	Desti- nation	Ref. No.	A d d	N e w	Parts No.	Description	Desti- nation
41		3B	D39-0278-15	DAMPER							
46		1B	G01-4682-34	TORSION COIL SPRING							
47		3A	G01-4683-24	EXTENSION SPRING							
48		2A	G01-4684-04	EXTENSION SPRING							
49		2B	G01-4685-04	EXTENSION SPRING							
50		1B	G01-4686-14	EXTENSION SPRING							
51		3A	G01-4688-14	EXTENSION SPRING							
52		3A	G01-4692-24	TORSION COIL SPRING							
53		2B	G02-1587-04	FLAT SPRING							
54		3A	G02-1588-04	FLAT SPRING							
55		1B	G13-1297-04	CUSHION							
56		1B	G13-1299-14	CUSHION							
57		1A	G16-1715-04	SHEET							
61		1B	J11-0675-03	CLAMPER							
64		2A	J19-7210-21	HOLDER							
65		2B	J19-7225-04	HOLDER							
66		1B	J22-0706-03	MOUNTING HARDWARE							
67		1A	J22-0707-12	MOUNTING HARDWARE							
68		1B	J90-1166-11	GUIDE							
69		2B	J90-1168-03	RAIL							
A		1A	N09-6108-15	TAPTITE SCREW (M2X3.5)							
B		2B	N09-6426-15	MACHINE SCREW							
C		2B	N09-6735-05	TAPTITE SCREW							
D		2B	N09-6737-15	MACHINE SCREW							
E		2B	N09-6738-15	TAPTITE SCREW							
F		2A	N19-2335-14	FLAT WASHER							
G		2B	N35-2003-48	BINDING HEAD MACHINE SCREW							
H		2B	N39-1720-48	PAN HEAD MACHINE SCREW							
76		2A	S68-0921-05	PUSH SWITCH							
DM1		2B	X94-2090-00	SPINDLE MOTOR ASSY							
DM2		2B	X94-2100-00	FEED MOTOR ASSY (LOAD/SLED)							
DPU1		2B	X93-2280-00	OPTICAL PICKUP ASSY							